

# INSTALLATION INSTRUCTIONS



## **1666 - TO SUIT VW GOLF 10/98-ON**

### **PLEASE READ INSTRUCTIONS THROUGH BEFORE YOU BEGIN**

**WARNING :** 1. Do not drill, cut weld or otherwise modify the towbar.

2. If you are using electric welding on a motor vehicle, always check that the vehicle is not equipped with electronic engine or instrument management equipment. Failure to do so could destroy any onboard computers. If in doubt, check with the vehicle's manufacturer.

1. Ensure all hardware items have been included.
2. Remove spare wheel cover and spare wheel.
3. Remove items from first aid compartment.
4. Remove rear panel trim.
5. Remove partially passenger=s side 3 panel trim to get access for removal of tail light. Both tail lights to be removed.
6. Remove rear bumper cover by removing three torque screws on each side of rear wheel arches, two torque screws mid point under bumper bar one side under tail lights and two buttons under tail lights as well. Unplug number plate loom.
7. Remove bumper cover and impact beam and discard impact beam.
8. See diagram for bumper cut out.
9. On driver=s side chassis rail, using large slot, as guide measure 96mm from rear most of large slot and 36mm in from side of spare wheel well mark and drill 10mm hole. (See diagram)
10. Remove adhesive tapes to expose mounting points on chassis one on each side. These can be pushed outwards from end of chassis rail.
11. Insert towbar into chassis rail and insert all bolts and nuts loosely.
12. Passenger=s side plate most forward wired bolt / nut is to be torqued up by universal joint when all bolts are in loosely.
13. Using saddle tail as guide, drill two 12mm holes and insert coach bolt with loose plates and tighten to torque listings, then tighten all other bolts to torque listing.
12. Refit bumper cover, tail lights, trims and spare wheel and floor mat.
13. Towbar rating sticker to be conspicuously located on the inside of the driver=s door. (See diagram below)

### **RECOMMENDED ASSEMBLY TORQUE LISTING**

<b>Diameter</b>	<b>Grade 4.6 Bolt</b>	<b>Grade 8.8 Bolt</b>
	<b>Nm</b>	<b>Nm</b>
M6	3.5	9.5
M8	8.6	21.7
M10	16.9	43.4
M12	29.8	77.3
M16	74.0	189.8

#### **FOR TOWING PURPOSES ONLY**

For towing capacity details please refer to vehicle owner's manual or to the manufacturer. Overloading can void your warranties.

**PLEASE NOTE:** You must remove the lug unless you are actually towing if it obscures your number plate. Failure to do so may result in a fine.

**IMPORTANT:** Please see over for safety chain hook-up procedure.

10.03.2000

## **1666 - TO SUIT VW GOLF 10/98-ON**

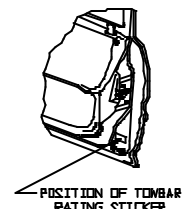

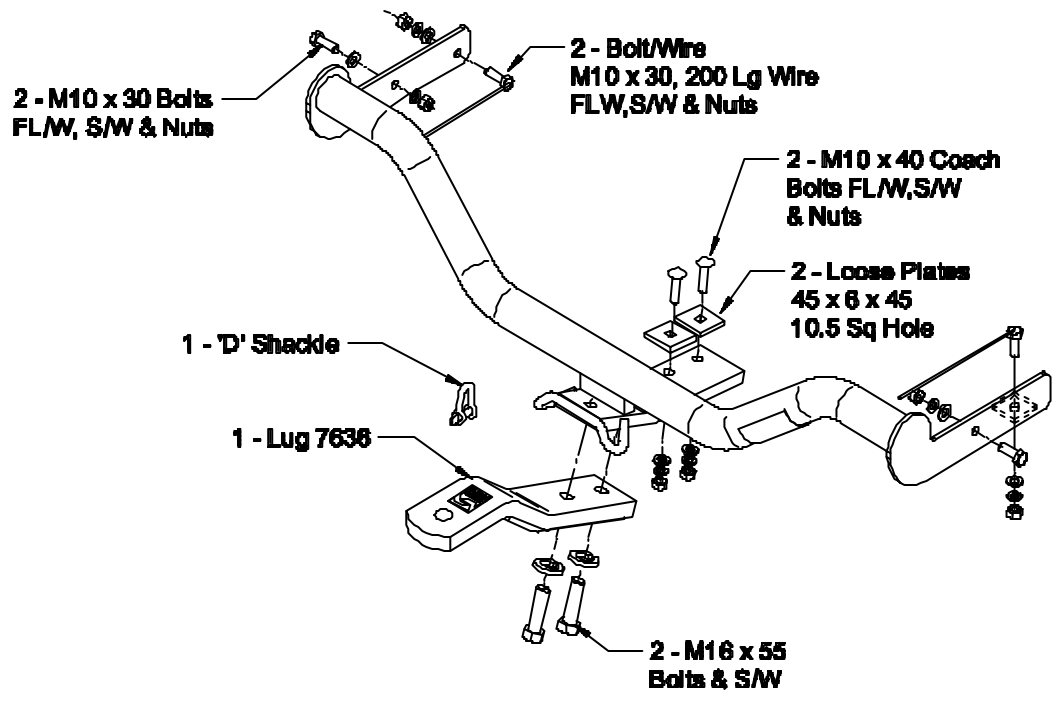

**Bumper Cutting Diagram**

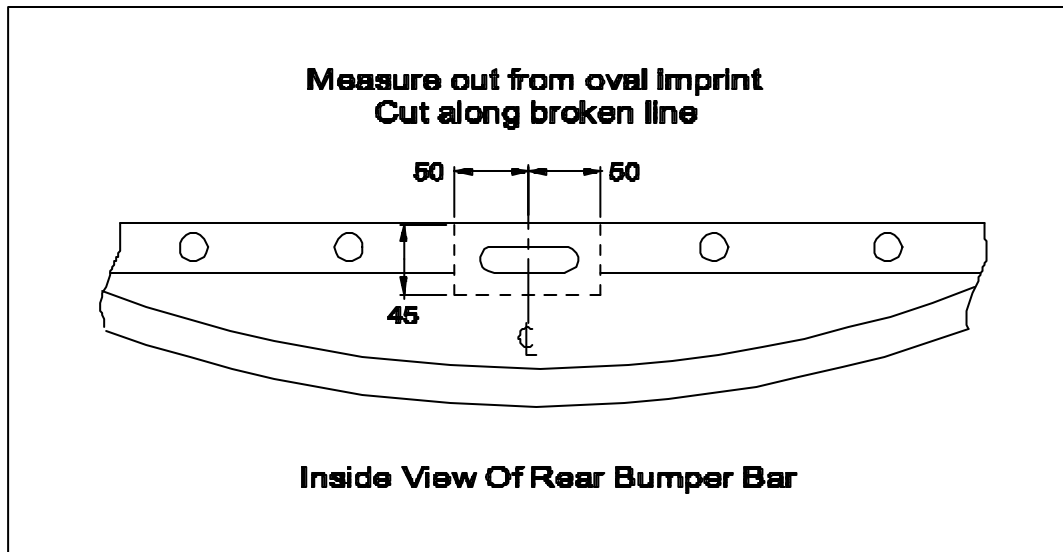

**Hole Drilling Diagram**

