



HAYMAN REESE
LEADING THE WAY

PART No: 2534
Mercedes Benz W204 (C Class)

PLEASE ENSURE THAT INSTRUCTIONS UNDERSTOOD PRIOR TO FITMENT



Installation Time: Approx 90 Mins

Towbar Installation Instructions

Towbar capacity

Part Number 2534

Max Towing Braked 1250Kg
Max Static Ball Load 75Kg



HAYMAN REESE
LEADING THE WAY

PART No: 2534
Mercedes Benz W204 (C Class)

PLEASE ENSURE THAT INSTRUCTIONS UNDERSTOOD PRIOR TO FITMENT

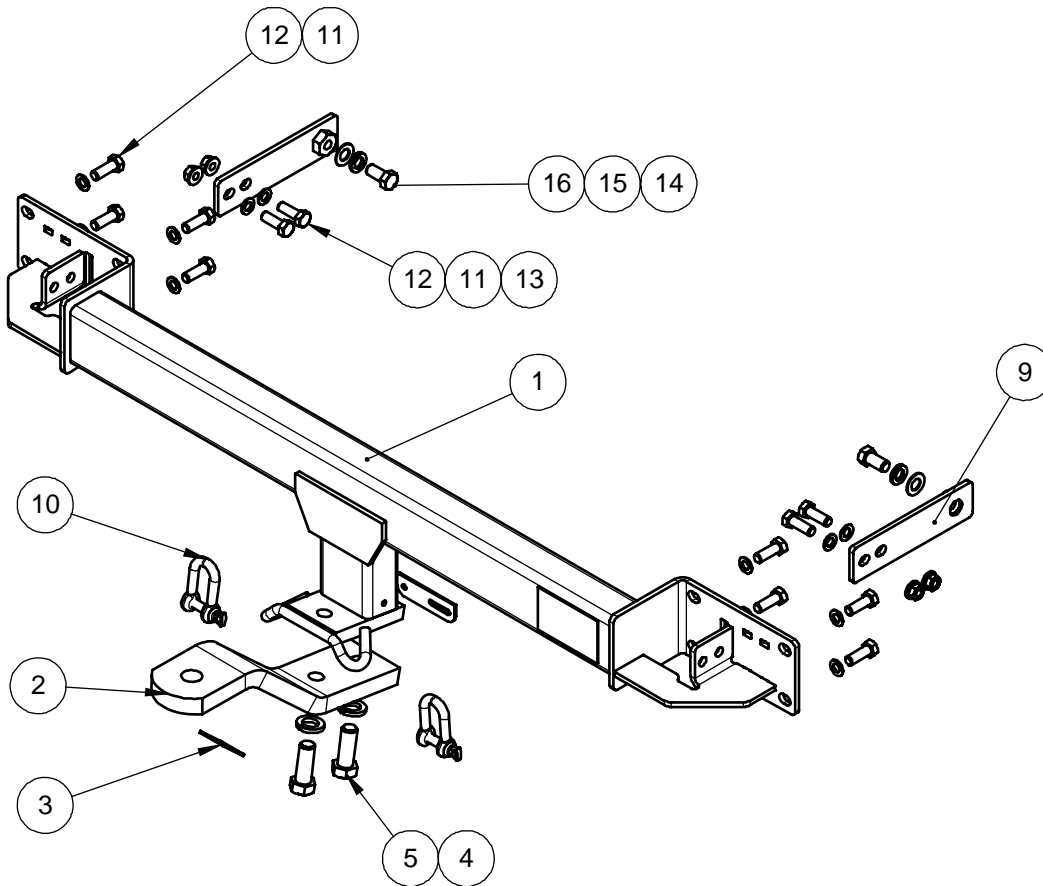

ITEM NO.	DESCRIPTION	QTY.
1	M-B W204 WELD ASSY.	1
2	LUG	1
3	H.R STICKER	1
4	M16 SPRING WASHER	2
5	M16 x 45 2.0P BOLT	2
6	Fitting Instruction	1
7	HR LIFETIME WARRANTY	1
8	DOOR RATING STICKER	1
9	CHASSIS BRACKET ASSY.	2
10	'D' SHACKLE	2
11	3/8" FLAT WASHER	12
12	M10 x 30 1.5P BOLT	12
13	M10 WHIZ NUT	4
14	Wshr ft 1/2" x 1-1/8" x 16 z/p	2
15	M12 SPRING WASHER	2
16	M12 X 25 1.75P BOLT	2



PLEASE ENSURE THAT INSTRUCTIONS UNDERSTOOD PRIOR TO FITMENT

Warning:

1. Do not, drill, cut, weld or otherwise modify the towbar.
2. If you are using electric welding on a motor vehicle, **always** check that the vehicle is not equipped with electronic engine or instrument management equipment. Failure to do so could **destroy** any onboard computers. If in doubt, check with the vehicle's manufacturer.

1. **General:** Ensure all hardware items have been included refer to assembly diagram.
2. It is recommended that the instructions are read through and completely understood before making any attempt to fit this product.
3. Be wary of any changes to vehicle designs or other accessories that may conflict with the installation of this product.
4. Before drilling ensure that the area is clear of fuel, electrical & other components.
5. All holes drilled into the body panels shall have all burrs & swarf removed then coated with a suitable rust preventative paint.
6. The high tensile fasteners supplied with this product were used to achieve the specified rating. If replacement is required ensure that fasteners of the same rating & quality are used. Contact an authorised **Hayman Reese** dealer if further information is required.
7. Ensure that all hardware is fastened to torque list below check fasteners on regular basis.
8. Towbar load rating sticker provided with this product shall be conspicuously located on inside rear end of the driver's door. **(See diagram below).**
9. Hayman Reese recommends that you check your tow ball to ensure that it complies with the Australian standards **AS 4177.2**.
10. **PLEASE NOTE:** It is advised to remove your lug or tbm when not actually towing so as to produce a clear view of the vehicles registration plate if obscured, and to also provide maximum available departure angle.

Tow bar Maintenance and Care.

Hayman Reese recommends that bolt torque's, as listed below, are routinely and regularly inspected and checked for correct tension. Replace any worn or defective parts.

We recommended to remove Tow Ball Mounts (TBM's, tongues or lugs) when not being used for any considerable length of time.

So as to avoid injury, when not towing it is suggested that the tongue, Pull Pin and R-clip are removed then stored in a safe, clean and dry place, away from excessive moisture.

Hitch Pull Pins and spring "R" clips are regularly checked for proper installation. Replace any worn or defective parts.

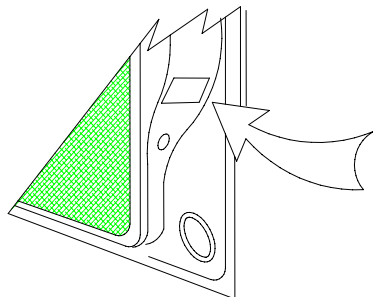

Place load rating sticker inside driver's door here

RECOMMENDED ASSEMBLY TORQUE LISTING

<u>Diameter</u>	<u>Grade 8.8 Bolt</u>
M6	9.5 Nm
M8	21.7 Nm
M10	43.4 Nm
M12	77.3 Nm
M14	146 Nm
M16	189.8 Nm

FOR TOWING PURPOSES ONLY
For towing capacity details please refer to vehicle owner's manual or to the manufacturer. **Overloading can void your warranties.**



HAYMAN REESE
LEADING THE WAY

PART No: 2534
Mercedes Benz W204 (C Class)

PLEASE ENSURE THAT INSTRUCTIONS UNDERSTOOD PRIOR TO FITMENT



1) Remove one vertical screw, two skrivets and one plastic nut inside rear wheel arch on both sides.



2) Remove two torx screws along the under side bumper skin on both sides. Remove two hex screws from the rear of the bumper.



3) From inside spare wheel well, loosen two plastic screws and remove rear plastic trim by lifting vertically.



4) Remove two nuts behind rear plastic trim holding bumper skin.



PLEASE ENSURE THAT INSTRUCTIONS UNDERSTOOD PRIOR TO FITMENT



5) Remove reverse sensor wiring then separate the bumper skin from the vehicle.

6) Remove eight nuts securing impact beam and discard the impact beam, retain the nuts for reuse.



7) Insert sidearm bracket into chassis rail with side nut inward, loosely secure sidearm bracket with M12 bolt, flat washer and spring washer on both sides.

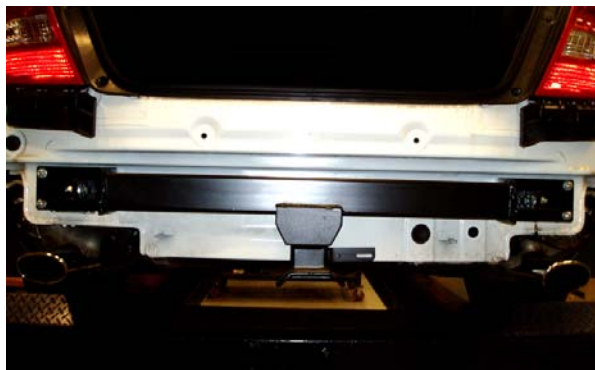

8) Offer the main towbar to the vehicle, insert sidearm bracket into the slot of the main towbar. Secure the towbar with eight M10 bolts, flat washers. Use the nuts obtain from the impact beam to secure the bolts.



9) Secure sidearm bracket to towbar using two M10 bolts, flat washers and whiz nuts.

10) Torque all fasteners to specification, refit bumper skin in reverse order.

11) Secure lug to towbar using M16 bolts and spring washers. Torque bolts to specification.

12) Attach D-shackles to towbar.