



HAYMAN REESE
LEADING THE WAY

PART No: RL2546
HYUNDAI i30CW WAGON

PLEASE ENSURE THAT INSTRUCTIONS UNDERSTOOD PRIOR TO FITMENT



Hyundai i30CW wagon

Installation Time: Approx 30 Mins

Towbar Installation Instructions

Towbar capacity

Part Number RL2546

Max Towing Braked 1200Kg
Max Static Ball Load 75Kg



HAYMAN REESE
LEADING THE WAY

PART No: RL2546
HYUNDAI i30CW WAGON

PLEASE ENSURE THAT INSTRUCTIONS UNDERSTOOD PRIOR TO FITMENT

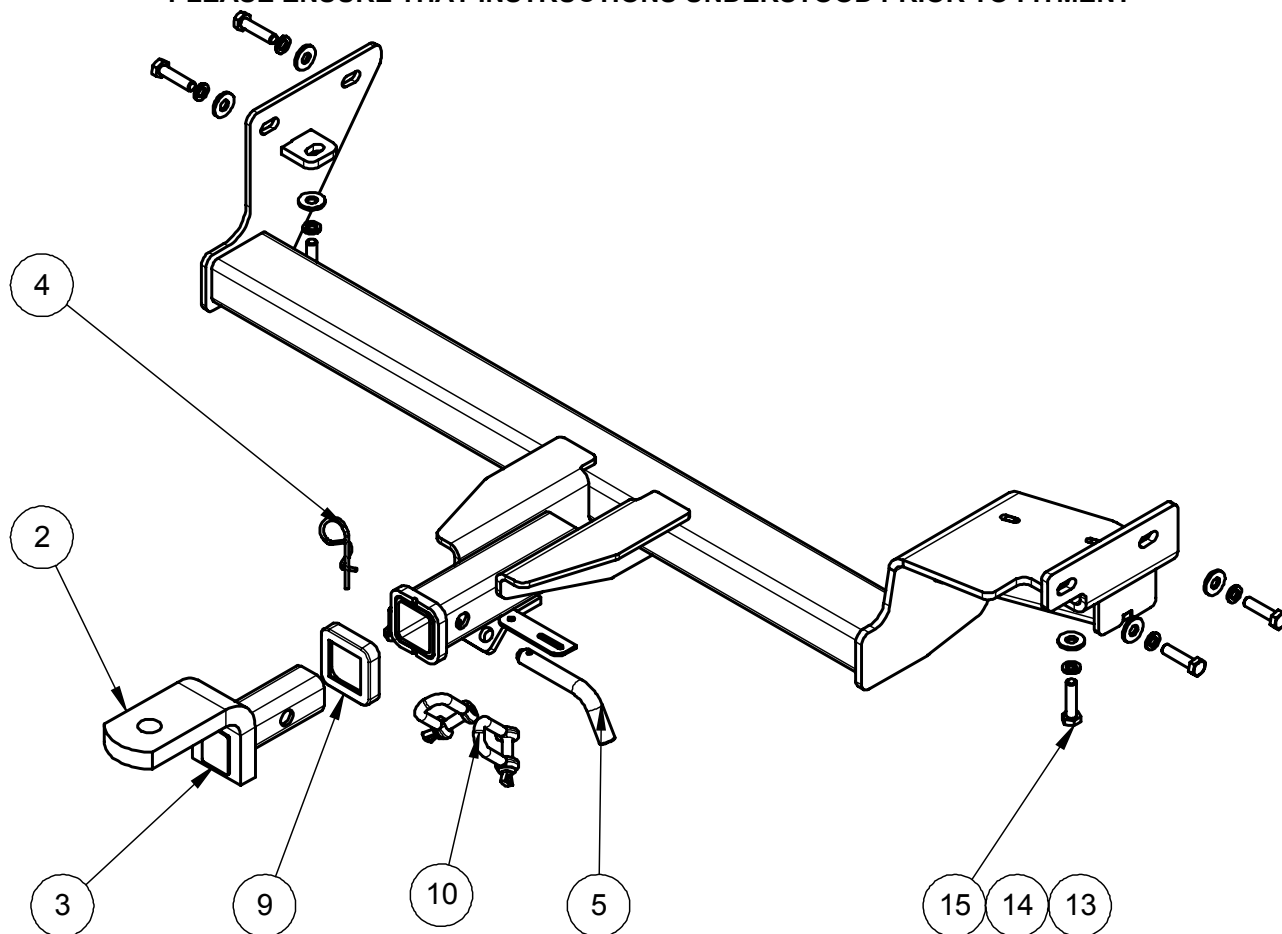

ITEM NO.	DESCRIPTION	QTY.
1	i30 WAGON WELDED ASSY	1
2	TRAILER BALL MOUNT	1
3	H.R STICKER	1
4	SPRING COTTER PIN	1
5	PULL PIN	1
6	Warranty Card	1
7	FITTING INSTRUCTION	1
8	DOOR RATING STICKER	1
9	RL H/BOX C/COVER BLANK	1
10	'D' SHACKLE	2
11	BOLT M10-1.50 x 25	1
12	NUT M10 x 1.5 Z/P HX NUTS	1
13	WSHR FT M10 X 25.4 X 3	6
14	M10 X 3.5 X 2.2 SPRING WSHR	6
15	Bolt M10x1.25x40 GR10.9	6



HAYMAN REESE
LEADING THE WAY

PART No: RL2546
HYUNDAI i30CW WAGON

PLEASE ENSURE THAT INSTRUCTIONS UNDERSTOOD PRIOR TO FITMENT

Warning:

1. Do not, drill, cut, weld or otherwise modify the towbar.
 2. If you are using electric welding on a motor vehicle, **always** check that the vehicle is not equipped with electronic engine or instrument management equipment. Failure to do so could **destroy** any onboard computers. If in doubt, check with the vehicle's manufacturer.
-
1. **General:** Ensure all hardware items have been included refer to assembly diagram.
 2. It is recommended that the instructions are read through and completely understood before making any attempt to fit this product.
 3. Be wary of any changes to vehicle designs or other accessories that may conflict with the installation of this product.
 4. Before drilling ensure that the area is clear of fuel, electrical & other components.
 5. All holes drilled into the body panels shall have all burrs & swarf removed then coated with a suitable rust preventative paint.
 6. The high tensile fasteners supplied with this product were used to achieve the specified rating. If replacement is required ensure that fasteners of the same rating & quality are used. Contact an authorised **Hayman Reese** dealer if further information is required.
 7. Ensure that all hardware is fastened to torque list below check fasteners on regular basis.
 8. Towbar load rating sticker provided with this product shall be conspicuously located on inside rear end of the driver's door. **(See diagram below).**
 9. Hayman Reese recommends that you check your tow ball to ensure that it complies with the Australian standards **AS 4177.2**.
 10. **PLEASE NOTE:** It is advised to remove your lug or tbn when not actually towing so as to produce a clear view of the vehicles registration plate if obscured, and to also provide maximum available departure angle.

Tow bar Maintenance and Care.

Hayman Reese recommends that bolt torque's, as listed below, are routinely and regularly inspected and checked for correct tension. Replace any worn or defective parts.

We recommended to remove Tow Ball Mounts (TBM's, tongues or lugs) when not being used for any considerable length of time.

So as to avoid injury, when not towing it is suggested that the tongue, Pull Pin and R-clip are removed then stored in a safe, clean and dry place, away from excessive moisture.

Hitch Pull Pins and spring "R" clips are regularly checked for proper installation. Replace any worn or defective parts.

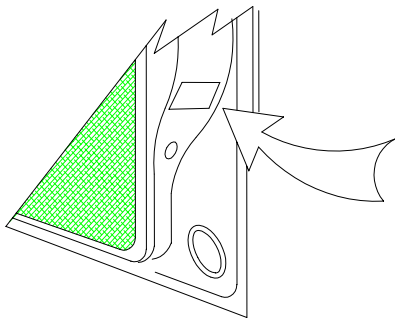

Place load rating sticker inside driver's door here

RECOMMENDED ASSEMBLY TORQUE LISTING	
Diameter	Grade 8.8 Bolt
M6	9.5 Nm
M8	21.7 Nm
M10	43.4 Nm
M12	77.3 Nm
M14	146 Nm
M16	189.8 Nm

FOR TOWING PURPOSES ONLY
For towing capacity details please refer to vehicle owner's manual or to the manufacturer. **Overloading can void your warranties.**



HAYMAN REESE
LEADING THE WAY

PART No: RL2546
HYUNDAI i30CW WAGON

PLEASE ENSURE THAT INSTRUCTIONS UNDERSTOOD PRIOR TO FITMENT



1. REMOVE PLASTIC UNDER TRAY VIA 8 SCRIVETS AND THREE 10mm NUTS.

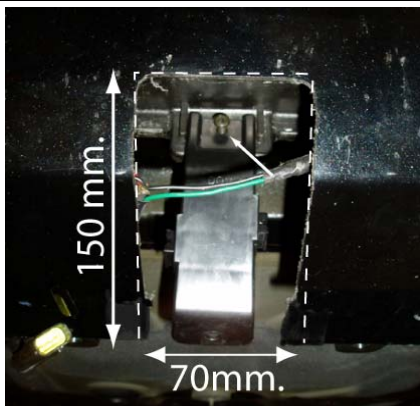

2. LOCATE CENTRE LINE OF THE BUMPER BETWEEN MOUNTING HOLES, CUT BUMPER 70mm. WIDE AND 150mm. LONG FROM THE BOTTOM OF THE BUMPER. FILE ANY ROUGH EDGES.
3. REMOVE CENTRE BUMPER BRACKET AND DISCARD.



4. REMOVE MUFFLER HANGER BOTH FRONT AND REAR OF THE MUFFLER CANISTER. LOWER THE MUFFLER FOR EASE OF INSTALLATION.



DRIVER
SIDE

PASSENGER
SIDE



5. OFFER TOW BAR TO THE VEHICLE AND LOOSELY TIGHTEN IT TO THE CHASSIS USING SIX M10x40x1.25 BOLT, SPRING WASHER AND FLAT WASHER. TORQUE ALL BOLTS TO 52Nm.
6. REFIT MUFFLER HANGERS.



HAYMAN REESE
LEADING THE WAY

PART No: RL2546
HYUNDAI i30CW WAGON

PLEASE ENSURE THAT INSTRUCTIONS UNDERSTOOD PRIOR TO FITMENT



7. LOCATE CENTRE LINE OF PLASITIC UNDER TRAY BETWEEN MOUNTING HOLES, CUT BUMPER 200mm. WIDE AND 50mm. LONG PIECE FROM THE BOTTOM OF THE TRAY. ATTACH CUT OUT PIECE TO THE BUMPER SKIN WITH TWO SCRIVETS.

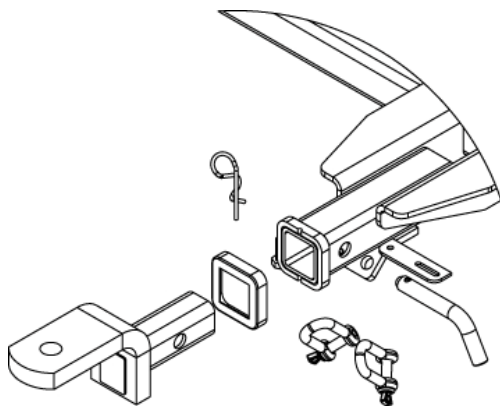

8. APPLY FIRM PRESSURE TO ATTACH HITCH BOX COLLAR. INSERT TBM INTO THE HITCH BOX AND SECURE WITH PULL PIN AND R CLIP. ATTACH ANTI RATTLE BOLT & NUT. ATTACH D SHACKLES TO CHAIN CONNECTION.

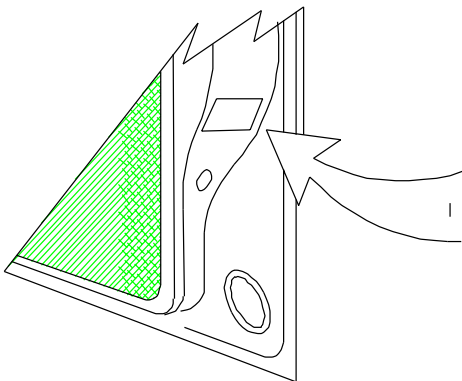

9. ATTACH LOAD RATING STICKER INSIDE OF THE DRIVERS SIDE DOOR.