

HAYMAN REESE
PART No: **02729RLW**
SKODA OCTAVIA WAGON 2010-On

INSTALLATION INSTRUCTIONS

PLEASE ENSURE THAT INSTRUCTIONS UNDERSTOOD PRIOR TO FITMENT



Installation Time: Approx **45 Mins**

Towbar Installation Instructions
SKODA OCTAVIA WAGON 2010-ON

Towbar capacity

Part Number **02729RLW**

Max Towing Braked 1300kg
Max Static Ball Load 75kg

Hayman Reese (Cequent)
PO Box 4050, Dandenong South VIC 3164
Phone 1800 812 017 Email info@haymanreese.com.au

HAYMAN REESE

PART No: 02729RLW

SKODA OCTAVIA 2010-ON

INSTALLATION INSTRUCTIONS

PLEASE ENSURE THAT INSTRUCTIONS UNDERSTOOD PRIOR TO FITMENT

Warning:

1. Do not, drill, cut, weld or otherwise modify the towbar.
2. If you are using electric welding on a motor vehicle, **always** check that the vehicle is not equipped with electronic engine or instrument management equipment. Failure to do so could **destroy** any onboard computers. If in doubt, check with the vehicle's manufacturer.

1. **General:** Ensure all hardware items have been included refer to assembly diagram.
2. It is recommended that the instructions are read through and completely understood before making any attempt to fit this product.
3. Be wary of any changes to vehicle designs or other accessories that may conflict with the installation of this product.
4. Before drilling ensure that the area is clear of fuel, electrical & other components.
5. All holes drilled into the body panels shall have all burrs & swarf removed then coated with a suitable rust preventative paint.
6. The high tensile fasteners supplied with this product were used to achieve the specified rating. If replacement is required ensure that fasteners of the same rating & quality are used. Contact an authorised **Hayman Reese** dealer if further information is required.
7. Ensure that all hardware is fastened to torque list below check fasteners on regular basis.
8. Towbar load rating sticker provided with this product shall be conspicuously located on inside rear end of the driver's door. **(See diagram below).**
9. Hayman Reese recommends that you check your tow ball to ensure that it complies with the Australian standards **AS 4177.2**.
10. **PLEASE NOTE:** It is advised to remove your lug or tbn when not actually towing so as to produce a clear view of the vehicles registration plate if obscured, and to also provide maximum available departure angle.

Tow bar Maintenance and Care.

Hayman Reese recommends that bolt torque's, as listed below, are routinely and regularly inspected and checked for correct tension. Replace any worn or defective parts.

We recommended to remove Tow Ball Mounts (TBM's, tongues or lugs) when not being used for any considerable length of time.

So as to avoid injury, when not towing it is suggested that the tongue, Pull Pin and R-clip are removed then stored in a safe, clean and dry place, away from excessive moisture.

Hitch Pull Pins and spring "R" clips are regularly checked for proper installation. Replace any worn or defective parts.

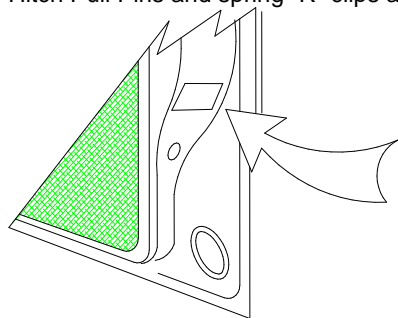

Place load rating sticker
inside driver's door here

RECOMMENDED ASSEMBLY TORQUE LISTING

Diameter Grade 8.8 Bolt

M6	9.5 Nm
M8	21.7 Nm
M10	43.4 Nm
M12	77.3 Nm
M14	146 Nm
M16	189.8 Nm

FOR TOWING PURPOSES ONLY

For towing capacity details please refer to vehicle owner's manual or to the manufacturer. Overloading can void your warranties.

Issue Date 23/9/10

Page 2

Part No: 02729RLW

HAYMAN REESE
PART No: 02729RLW
SKODA OCTAVIA 2010-ON

INSTALLATION INSTRUCTIONS

PLEASE ENSURE THAT INSTRUCTIONS UNDERSTOOD PRIOR TO FITMENT

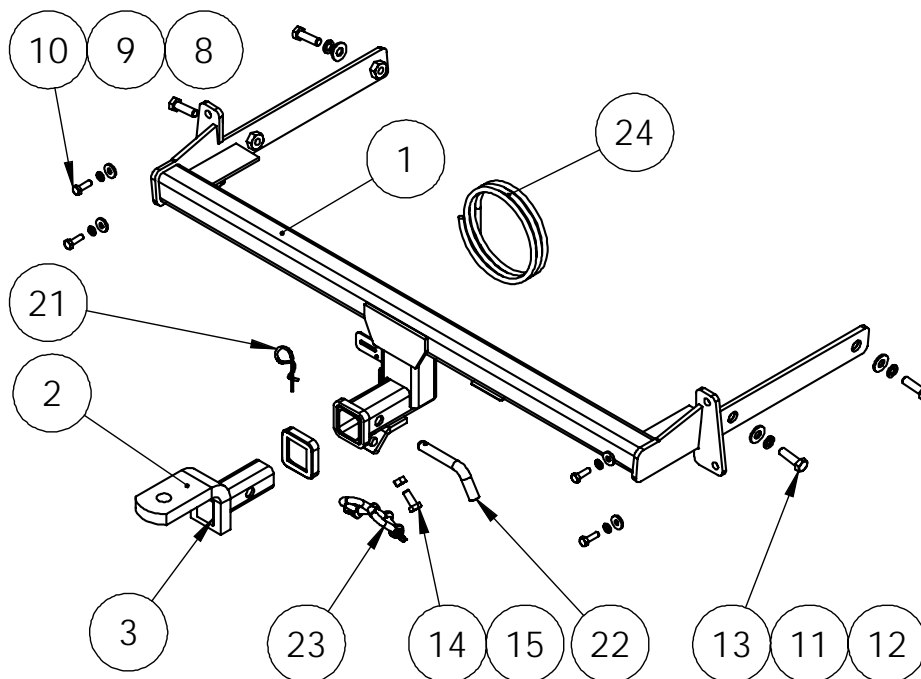





QTY.	DESCRIPTION	ITEM NO.
1	WELDED ASSY.	1
1	TRAILER BALL MOUNT	2
1	H.R STICKER	3
1	RL H/BOX C/COVER BLANK	4
1	CP LABEL	5
1	BOLT PACK	6
1	PLASTIC SHEET BAG	7
4	M8 x 22 x 3.3mm FLAT WASHER	8
4	WSHR SPRING FT SEC M8x3.0x2.0mm z/p	9
4	Bolt M8 x 25 Gr 8.8	10
4	WASHER M12x28.8x3mm	11
4	M12 X 4.0 X 2.5 SPRING WASHER	12
4	BOLT M12-1.75x40 GR8.8	13
1	M10 x 25 1.5P BOLT	14
1	NUT M10 x 1.5P	15
1	BRAND BAG	16
1	PLASTIC SHEET BAG	17
1	Fitting Instruction	18
1	Load Rating Label	19
1	Warranty Card	20
1	SPRING COTTER PIN ASSY	21
1	PULL PIN	22
2	'D' SHACKLE	23
1	WIRING LOOM	24

HAYMAN REESE
PART No: **02729RLW**
SKODA OCTAVIA 2010-ON

INSTALLATION INSTRUCTIONS

PLEASE ENSURE THAT INSTRUCTIONS UNDERSTOOD PRIOR TO FITMENT

	<ol style="list-style-type: none">1. Remove 6 screws under the bumper.2. Remove 4 screws inside wheel arch on both sides.
	<ol style="list-style-type: none">3. Remove taillights assembly4. Remove 2 plastic skrivets holding the bumper bar inside taillight cavity on both sides.
	<ol style="list-style-type: none">5. Lift liner to remove 2 screws holding bumper bar from inside vehicle on both sides.6. Remove bumper bar.
	<ol style="list-style-type: none">7. Remove impact beam and discard.8. Fit towbar in replace of impact beam using M8x25 bolts, spring washers & flat washers on 2 impact beam mounts.9. Fit M10x40 bolts, spring washers & flat washers on the side of chassis rails (may require lowering muffler).

HAYMAN REESE
PART No: 02729RLW
SKODA OCTAVIA 2010-ON

INSTALLATION INSTRUCTIONS

PLEASE ENSURE THAT INSTRUCTIONS UNDERSTOOD PRIOR TO FITMENT

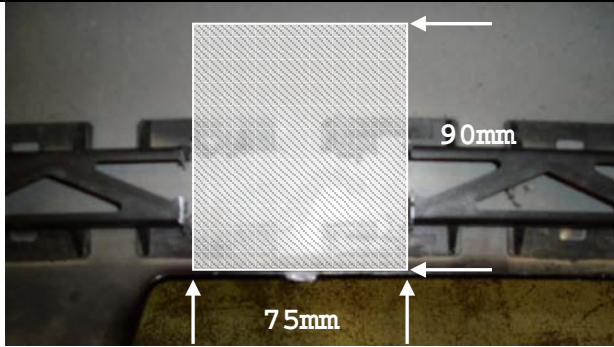

10. Torque all fasteners to specifications.
11. On inside bumper, from centre cut 75mm wide and 90mm long from the bottom of the bumper bar.
12. Refit bumper bar.



HAYMAN REESE
PART No: 100495-WL
SKODA OCTAVIA WAGON, RS WAGON & SCOUT WAGON
INSTALLATION INSTRUCTIONS

PLEASE ENSURE THAT INSTRUCTIONS ARE UNDERSTOOD PRIOR TO FITMENT

Wiring Loom Installation Instructions

**SKODA OCTAVIA WAGON, RS WAGON
& SCOUT WAGON
Part No: 100495-WL
ECU: 04828**

**Tail Harness Length Required: 1200mm
RPA Override Switch Part No: 04848 (If Fitted)**

Note: If factory OEM RPA is fitted, Trouble Code will be logged if disabled.

Wiring Loom Installation Time: Approx 30 Mins

Issue Date 13-10-11

Page 1

Part No: 100495-WL

Hayman Reese (Cequent)
PO Box 4050, Dandenong South VIC 3164
Phone 1800 812 017 Email info@haymanreese.com.au

www.haymanreese.com.au



HAYMAN REESE
PART No: 100495-WL
SKODA OCTAVIA WAGON, RS WAGON & SCOUT WAGON
INSTALLATION INSTRUCTIONS

PLEASE ENSURE THAT INSTRUCTIONS ARE UNDERSTOOD PRIOR TO FITMENT

1. In the luggage compartment, remove the floor cover carpet (1).
2. Remove the parcel shelf (2).
3. Fold the rear seats (3) forward.

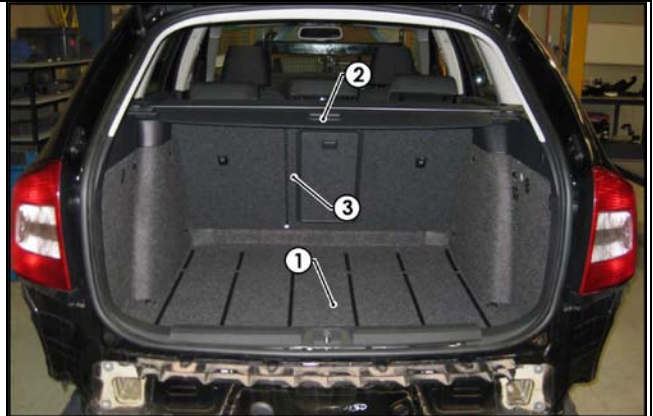

4. Remove the rear trim (1) by first removing the two fasteners (2).

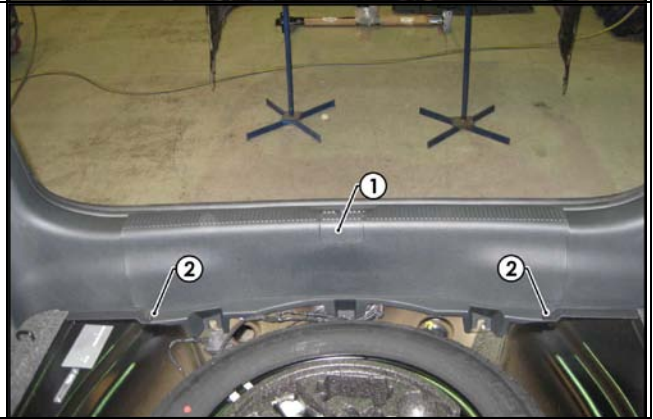

5. Remove the LHS storage cover (1) by first unlocking the two panel locks (2).
6. Repeat for the RHS.



Issue Date 13-10-11

Page 2

Part No: 100495-WL

Hayman Reese (Cequent)
PO Box 4050, Dandenong South VIC 3164
Phone 1800 812 017 Email info@haymanreese.com.au

www.haymanreese.com.au



HAYMAN REESE
PART No: 100495-WL
SKODA OCTAVIA WAGON, RS WAGON & SCOUT WAGON
INSTALLATION INSTRUCTIONS

PLEASE ENSURE THAT INSTRUCTIONS ARE UNDERSTOOD PRIOR TO FITMENT

7. Remove the LHS rear side trim (1) by first removing the fastener located behind the plastic cover (2).
 8. Repeat for the RHS.
-
9. Remove the fastener (1) located behind the LHS and pull down the hook.
 10. Remove the LHS upper side trim (2) by first removing any remaining clips and fasteners.
 11. Dislodge the LHS side trim (3) by first removing the fasteners (4).
-
12. From outside the vehicle, dislodge the RHS of the rear bumper.
 13. Remove the RHS rear quarter grommet (1).
 14. Drill out the grommet hole to Ø31mm.
 15. File any rough or sharp edges and spray on rust inhibitor.



Issue Date 13-10-11

Page 3

Part No: 100495-WL

Hayman Reese (Cequent)
PO Box 4050, Dandenong South VIC 3164
Phone 1800 812 017 Email info@haymanreese.com.au

www.haymanreese.com.au



HAYMAN REESE

PART No: 100495-WL

SKODA OCTAVIA WAGON, RS WAGON & SCOUT WAGON

INSTALLATION INSTRUCTIONS

PLEASE ENSURE THAT INSTRUCTIONS ARE UNDERSTOOD PRIOR TO FITMENT

16. In the LHS of the luggage compartment and following the table below, connect the ezy tap (1) to the vehicle wire (2), then connect the trailer patch harness terminal (3) to the ezy tap (1).
17. Connect the trailer patch harness ground ring terminal (4) to the vehicle grounding point (5).

Function	Trailer Patch	Vehicle Connector
L.IND	YELLOW / BLACK	BLACK / WHITE

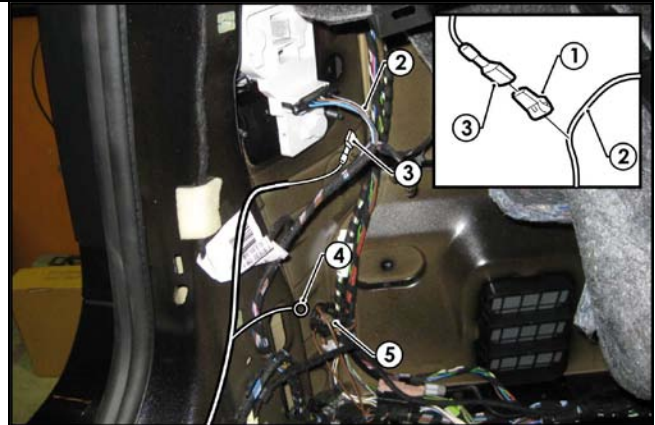

18. Route the trailer patch harness (1) across the rear of the luggage compartment and towards the RHS of the vehicle.

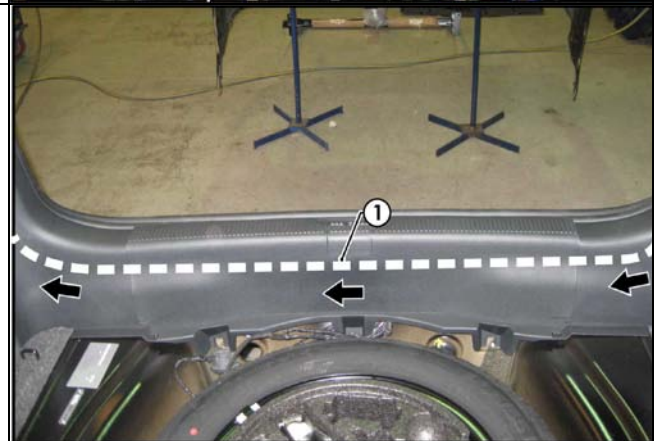

19. Route the trailer patch harness (1) towards the RHS tail light assembly.
20. Following the table below, connect the ezy taps (2) to the vehicle wires (3), then connect the trailer patch harness terminals (4) to the ezy taps (2).

Function	Trailer Patch	Vehicle Connector
R.IND	GREEN / BLACK	GREEN / BLUE
REVERSE	BLACK / WHITE	BLACK / YELLOW
TAIL / BRAKE	BROWN / BLACK	BLUE / YELLOW OR BLUE / WHITE

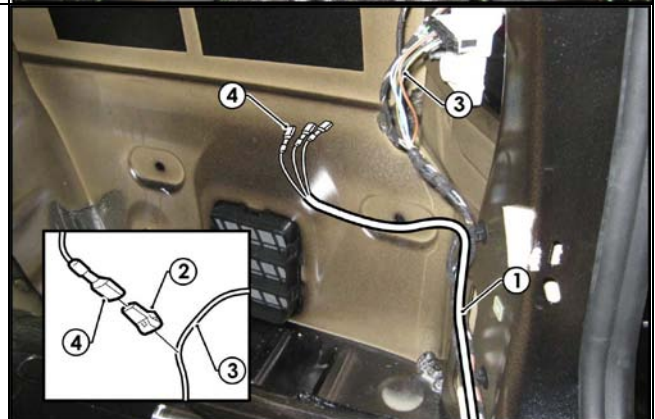

Issue Date 13-10-11

Page 4

Part No: 100495-WL

Hayman Reese (Cequent)
 PO Box 4050, Dandenong South VIC 3164
 Phone 1800 812 017 Email info@haymanreese.com.au

www.haymanreese.com.au



HAYMAN REESE
PART No: 100495-WL
SKODA OCTAVIA WAGON, RS WAGON & SCOUT WAGON
INSTALLATION INSTRUCTIONS

PLEASE ENSURE THAT INSTRUCTIONS ARE UNDERSTOOD PRIOR TO FITMENT

21. Apply double sided tape to the ECU and adhere it to the vehicle sheet metal (1) on the RHS of the luggage compartment, next to the vent.



22. Connect the trailer patch harness 12-way connector (1) to the ECU (04828) (2).

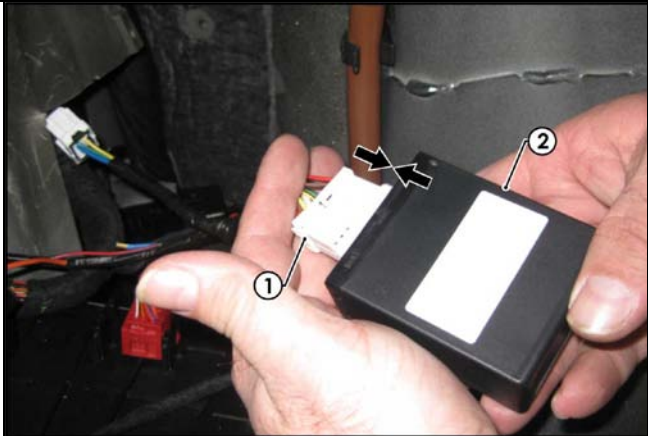

23. Route the 'ORANGE' power wire (1) along the RHS and towards the front of the vehicle.

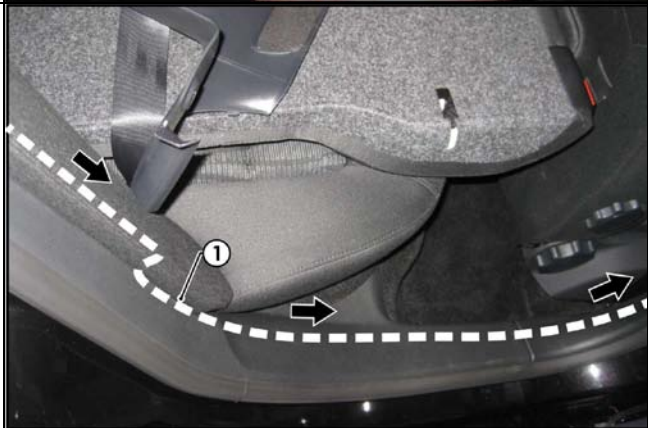

Issue Date 13-10-11

Page 5

Part No: 100495-WL

Hayman Reese (Cequent)
PO Box 4050, Dandenong South VIC 3164
Phone 1800 812 017 Email info@haymanreese.com.au

www.haymanreese.com.au



HAYMAN REESE

PART No: 100495-WL

SKODA OCTAVIA WAGON, RS WAGON & SCOUT WAGON

INSTALLATION INSTRUCTIONS

PLEASE ENSURE THAT INSTRUCTIONS ARE UNDERSTOOD PRIOR TO FITMENT

24. Continue to route the 'ORANGE' power wire (1) along the RHS of the vehicle, towards the RHS of the dash.
25. Remove the RHS side dash panel (2).

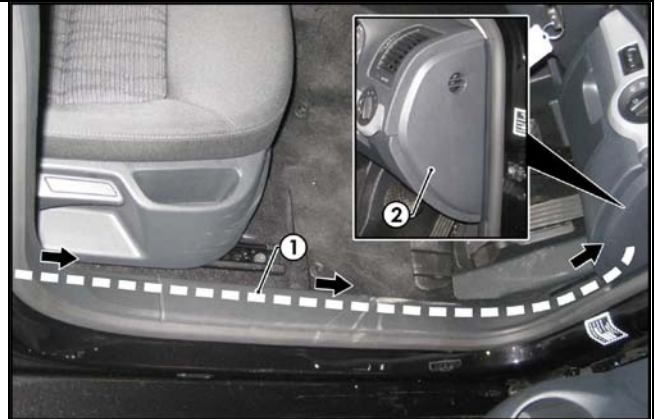

26. Locate the vacant fuse slot (1) (**fuse location 36**).
27. Insert the supplied 20-amp fuse (2) into the upper slot of the add-a-fuse harness (3).
28. Plug the add-a-fuse harness (3) into the vacant fuse slot (1) on the fuse panel.
29. Connect the 'ORANGE' power wire 1-way connector (4) into the add-a-fuse harness (3) mating connector.

Note: If the fuse location is occupied, remove the vehicle fuse and insert it in the lower slot of the add-a-fuse harness (3).

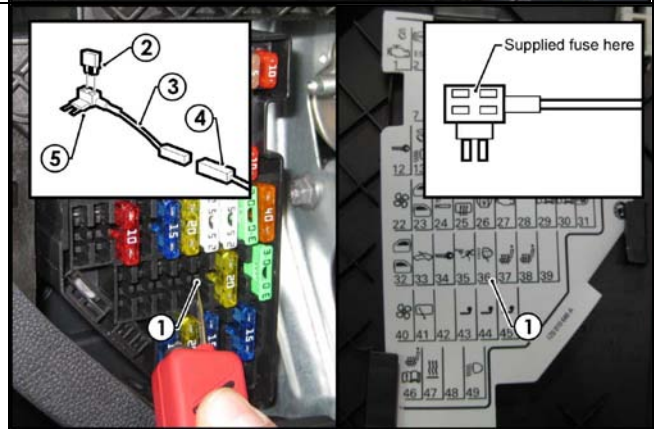

30. Mount the trailer socket (1) to the towbar mounting bracket using M4 fasteners (not supplied).
31. Route the tail harness (2) across the towbar towards the RHS of the vehicle and up through the previously drilled out hole.
32. Ensure the tail harness grommet is seated correctly and secure in place using a cable tie (not supplied).



Issue Date 13-10-11

Page 6

Part No: 100495-WL

Hayman Reese (Cequent)
 PO Box 4050, Dandenong South VIC 3164
 Phone 1800 812 017 Email info@haymanreese.com.au

www.haymanreese.com.au



HAYMAN REESE
PART No: 100495-WL
SKODA OCTAVIA WAGON, RS WAGON & SCOUT WAGON
INSTALLATION INSTRUCTIONS

PLEASE ENSURE THAT INSTRUCTIONS ARE UNDERSTOOD PRIOR TO FITMENT

33. Connect the tail harness (tail length 1200mm) 8-way connector (1) to the trailer patch harness mating 8-way connector (2).

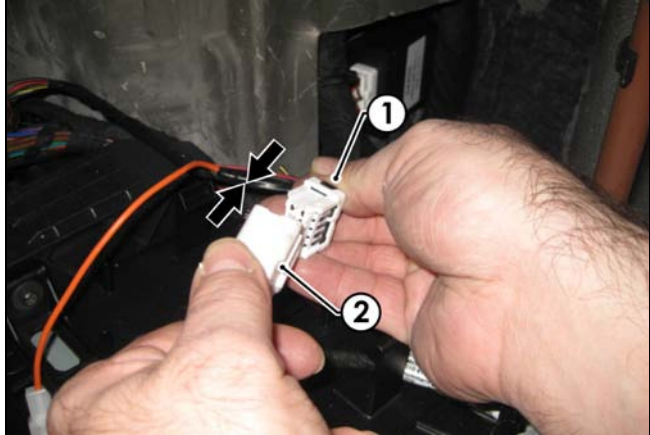

34. Test the trailer patch harness function using a light board or multimeter.
35. Secure all harness using cable ties (not supplied).
36. Re-fit all removed parts and secure all fasteners, ensuring there are no squeaks or rattles.
37. Place instructions in glove box after fitment.

Issue Date 13-10-11

Page 7

Part No: 100495-WL

Hayman Reese (Cequent)
PO Box 4050, Dandenong South VIC 3164
Phone 1800 812 017 Email info@haymanreese.com.au

www.haymanreese.com.au

