

**HAYMAN REESE**  
**PART No: 02761RW**  
**MERCEDES BENZ SPRINTER VAN 06-09 on**

**INSTALLATION INSTRUCTIONS**

PLEASE ENSURE THAT INSTRUCTIONS ARE UNDERSTOOD PRIOR TO FITMENT



**Installation Time: Approx 60 Mins**

**Towbar Installation Instructions**      **Towbar capacity**  
**MERCEDES BENZ SPRINTER VAN 06-09 on**

**Part Number 02761RW**

**Max Towing Braked 2000 kg**  
**Max Static Ball Load 200 kg**

Hayman Reese (Cequent)  
PO Box 4050, Dandenong South VIC 3164  
Phone 1800 812 017 Email [info@haymanreese.com.au](mailto:info@haymanreese.com.au)

**HAYMAN REESE**  
PART No: 02761RW  
MERCEDES BENZ SPRINTER VAN 06-09 on

**INSTALLATION INSTRUCTIONS**

PLEASE ENSURE THAT INSTRUCTIONS ARE UNDERSTOOD PRIOR TO FITMENT

**Warning:**

1. Do not, drill, cut, weld or otherwise modify the towbar.
2. If you are using electric welding on a motor vehicle, **always** check that the vehicle is not equipped with electronic engine or instrument management equipment. Failure to do so could **destroy** any onboard computers. If in doubt, check with the vehicle's manufacturer.
  
1. **General:** Ensure all hardware items have been included refer to assembly diagram.
2. It is recommended that the instructions are read through and completely understood before making any attempt to fit this product.
3. Be wary of any changes to vehicle designs or other accessories that may conflict with the installation of this product.
4. Before drilling ensure that the area is clear of fuel, electrical & other components.
5. All holes drilled into the body panels shall have all burrs & swarf removed then coated with a suitable rust preventative paint.
6. The high tensile fasteners supplied with this product were used to achieve the specified rating. If replacement is required ensure that fasteners of the same rating & quality are used. Contact an authorised **Hayman Reese** dealer if further information is required.
7. Ensure that all hardware is fastened to torque list below check fasteners on regular basis.
8. Towbar load rating sticker provided with this product shall be conspicuously located on inside rear end of the driver's door. **(See diagram below).**
9. Hayman Reese recommends that you check your tow ball to ensure that it complies with the Australian standards **AS 4177.2**.
10. **PLEASE NOTE:** It is advised to remove your lug or tbn when not actually towing so as to produce a clear view of the vehicles registration plate if obscured, and to also provide maximum available departure angle.

**Tow bar Maintenance and Care.**

Hayman Reese recommends that bolt torque's, as listed below, are routinely and regularly inspected and checked for correct tension. Replace any worn or defective parts.

We recommended to remove Tow Ball Mounts (TBM's, tongues or lugs) when not being used for any considerable length of time.

So as to avoid injury, when not towing it is suggested that the tongue, Pull Pin and R-clip are removed then stored in a safe, clean and dry place, away from excessive moisture.

Hitch Pull Pins and spring "R" clips are regularly checked for proper installation. Replace any worn or defective parts.

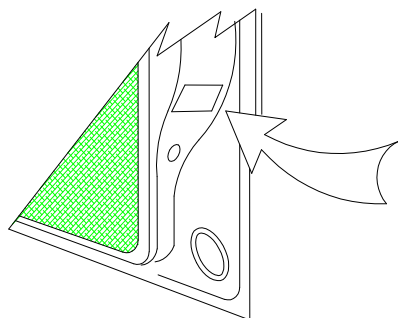

Place load rating sticker  
inside driver's door here

**RECOMMENDED ASSEMBLY TORQUE LISTING**

**Diameter Grade 8.8 Bolt**

M6	9.5 Nm
M8	21.7 Nm
M10	43.4 Nm
M12	77.3 Nm
M14	146 Nm
M16	189.8 Nm

**FOR TOWING PURPOSES ONLY**

For towing capacity details please refer to vehicle owner's manual or to the manufacturer. Overloading can void your warranties.

**HAYMAN REESE**  
**PART No: 02761RW**  
**MERCEDES BENZ SPRINTER VAN 06-09 on**

**INSTALLATION INSTRUCTIONS**

PLEASE ENSURE THAT INSTRUCTIONS ARE UNDERSTOOD PRIOR TO FITMENT

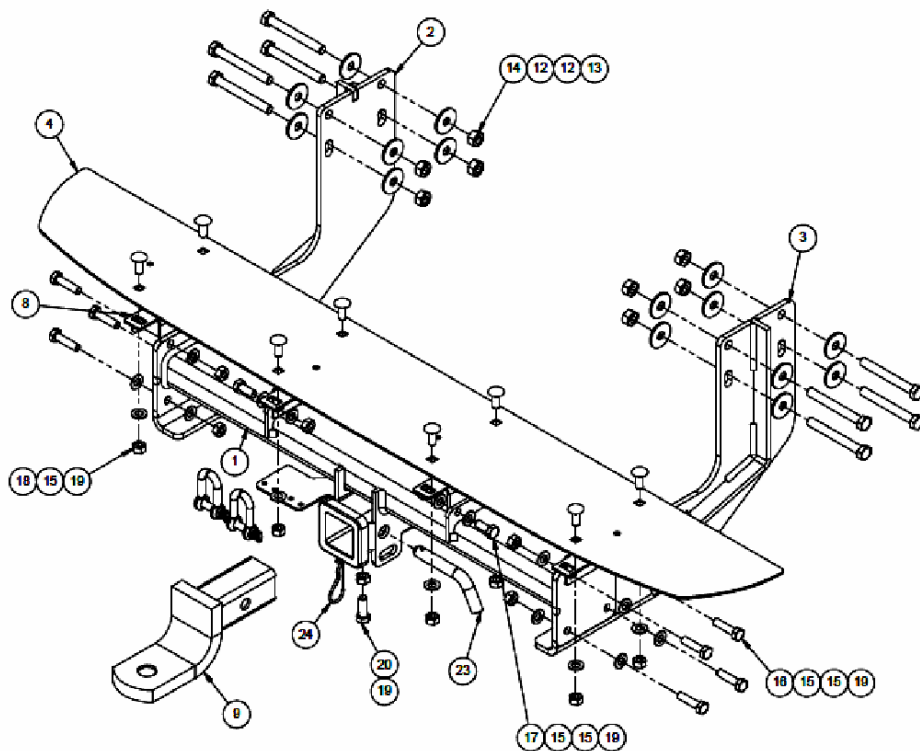

ITEM NO.	DESCRIPTION	QTY.
1	Towbar	1
2	LHS Chassis Plate	1
3	RHS Chassis Plate	1
4	Rear Step Plate	1
5	Hitch Box Collar Cover	1
6	Step Mount Bracket	4
7	TBM	1
8	WASHER FT M12 x 37 x 3mm	16
9	BOLT M12 - 1.25 x 100mm GR 8.8	8
10	NUT HX M12 - 1.25 Z/P	8
11	M10 FLAT WASHER 21 x 1.6mm	32
12	BOLT M10 - 1.5 x 40mm GR 8.8	8
13	BOLT M10-1.50 x 25	4
14	M10 x 25 1.5P COACH BOLT	8
15	NUT HX M10 - 1.5 Z/P	21
16	M10 - 1.5 x 30mm BOLT	1
17	PULL PIN	1
18	R CLIP	1
19	'D' SHACKLE	2

Issue Date 23-02-11

Page 3

Part No: 02761RW

**HAYMAN REESE**  
PART No: 02761RW  
MERCEDES BENZ SPRINTER VAN 06-09 on

**INSTALLATION INSTRUCTIONS**

PLEASE ENSURE THAT INSTRUCTIONS ARE UNDERSTOOD PRIOR TO FITMENT

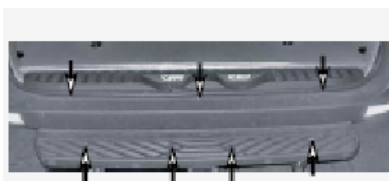

Diagram 1: Remove rear step facia.

Check contents of kit before commencing fitment.

1. Remove four scrivenets and three torx screws from the rear plastic step facia.
2. Release self locking tabs from under the facia on both sides.
3. Remove rear step facia and keep in a safe place.



Diagram 2: Remove three bolts from each side to remove rear step.

4. Lower the spare wheel to allow easy access to the chassis rails.
5. Remove three bolts from each chassis rail to remove the rear step assembly.
6. Using a suitable tool, remove any body insulation material from both sides of both chassis rails.



Diagram 3: Attach Chassis Plates.

7. Attach RHS Chassis Plate (Item 2) to the outside of the RHS chassis rail with M12 x 100 Bolts, M12 Washers and M12 Nuts (Items 9, 8 & 10).
8. Repeat for LHS with LHS Chassis Plate (Item 3)

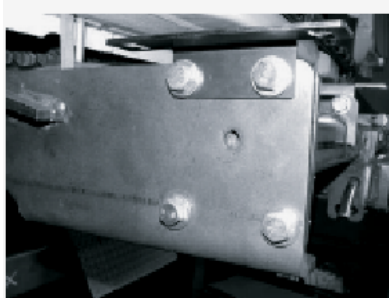

Diagram 4: Secure Towbar to vehicle.

9. Loosely attach Towbar (Item 1) to LHS and RHS Chassis Plates with M10 Bolts, M10 Washers and M10 Nuts (Items 12, 11 & 15) via the lower holes.
10. Attach Step Mount Bracket (Item 4) to the Chassis Plate/Towbar assembly via the upper holes with M10 Bolts, M10 Washers and M10 Nuts (Items 12, 11 & 15). Refer to Diagrams 4 and 5 for orientation of the Step Mount Bracket.

**HAYMAN REESE**  
**PART No: 02761RW**  
**MERCEDES BENZ SPRINTER VAN 06-09 on**

**INSTALLATION INSTRUCTIONS**

PLEASE ENSURE THAT INSTRUCTIONS ARE UNDERSTOOD PRIOR TO FITMENT

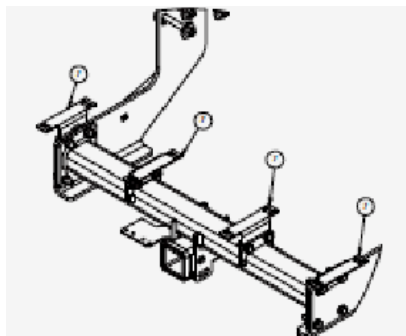

Diagram 5: Attach Step Mount Brackets.

11. Attach two remaining Step Mount Brackets to the Towbar (mounting points on the cross tube) with M10 x 25mm Bolts, M10 Washers and M10 Nuts (Items 13, 11 & 15). Refer to Diagram 5 for mount orientation.

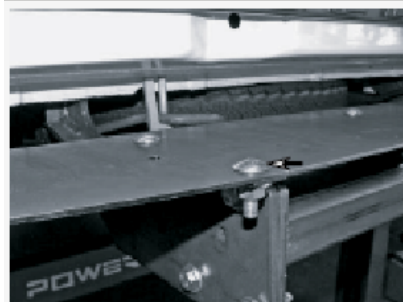

Diagram 6: Attach Rear Step Plate.

12. Attach Rear Step Plate (Item 6) to the Step Mount Brackets with M10 Coach Bolts, M10 Washers and M10 Nuts (Items 14, 11 & 15). Refer to Diagram 6 and the Layout Diagram on Page 1.

Bolt	Torque Nm
M10 x 1.5 Gr 8.8	49
M12 x 1.25 Gr 8.8	93

Diagram 7: Torque Bolts.

13. Place the plastic rear step facia removed on Step 3 on the Towbar/Rear Step assembly and check the fitment. Adjust the Rear Step Plate so that all the mounting points of the step facia aligns.
14. Remove the plastic facia and tighten all the bolts on the Towbar-Rear Step assembly to the specified torque setting. Refer to table on the left.

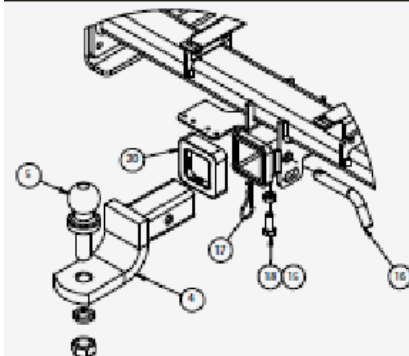

Diagram 8: Attach Tongue.

15. Re-attach rear step facia with the original fasteners.
16. Apply firm even pressure and attach the Hitch Box Collar Cover (Item 20) to the Towbar.
17. Attach Towball (Item 5) to Tongue (Item 4) with the 7/8" Spring Washer and the 7/8" Nut supplied with kit.
18. Attach Tongue to Towbar using Pull Pin and R-Clip (Items 16 & 17).
19. Use M10 x 30mm Bolt and M10 Nut (Items 18 & 15) to tighten Tongue.

**HAYMAN REESE**  
PART No: 02761RW  
MERCEDES BENZ SPRINTER VAN 06-09 on

**INSTALLATION INSTRUCTIONS**

PLEASE ENSURE THAT INSTRUCTIONS ARE UNDERSTOOD PRIOR TO FITMENT

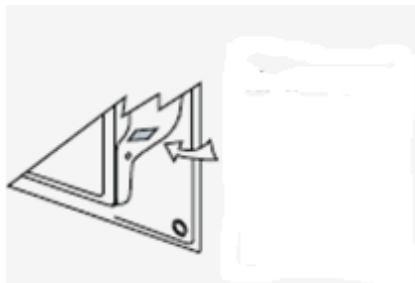

Diagram 9: Attach Load Rating Label.

20. Attach Load Rating Label (Item 19) on the Driver's door.



**IMPORTANT INFORMATION**

The Towbar is to be used solely for the purpose of towing. Other uses may damage the Towbar and/or vehicle. The Tongue, Item 4, is attached before towing using Items 16 and 17. These items are removed after towing. Attach Item 21 when Tongue is removed.

When not towing, ensure the Tongue is securely stored in a closed compartment within the vehicle. Injury may occur if the Tongue moves about within the vehicle.

**HAYMAN REESE**  
**PART No: 100513-WL**  
**MERCEDES SPRINTER / VW CRAFTER**  
**INSTALLATION INSTRUCTIONS**

PLEASE ENSURE THAT INSTRUCTIONS ARE UNDERSTOOD PRIOR TO FITMENT

**Wiring Loom Installation Instructions**

**MERCEDES SPRINTER / VW CRAFTER**  
**Part No: 100513-WL**

**Tail Harness Length Required: 1200mm**  
**Kit Includes Power Harness Part No: 04825**

**ECU Required Part No: 04826**  
**RPA Override Switch Part No: 04848 (if fitted)**

**Wiring Loom Installation Time: Approx 40 Mins**

Issue Date 25-10-10

Page 1

Part No: 100513-WL

Hayman Reese (Cequent)  
PO Box 4050, Dandenong South VIC 3164  
Phone 1800 812 017 Email [info@haymanreese.com.au](mailto:info@haymanreese.com.au)

[www.haymanreese.com.au](http://www.haymanreese.com.au)



**HAYMAN REESE**  
**PART No: 100513-WL**  
**MERCEDES SPRINTER / VW CRAFTER**  
**INSTALLATION INSTRUCTIONS**

**PLEASE ENSURE THAT INSTRUCTIONS ARE UNDERSTOOD PRIOR TO FITMENT**

**Note:** This trailer patch harness is designed to fit the Mercedes Sprinter and the Volkswagen Crafter. Please ensure the correct trailer patch tail light connectors are used. Always refer to labels on the trailer patch tail light connector when fitting this kit.

1. Underneath the rear LHS of the vehicle drill out a Ø31mm hole in the area indicated (1).
2. File down any rough or sharp edges and spray on rust inhibitor.



3. Inside the LHS of the cargo area, remove the LHS trim cover (1) and the rear pillar caps (2).

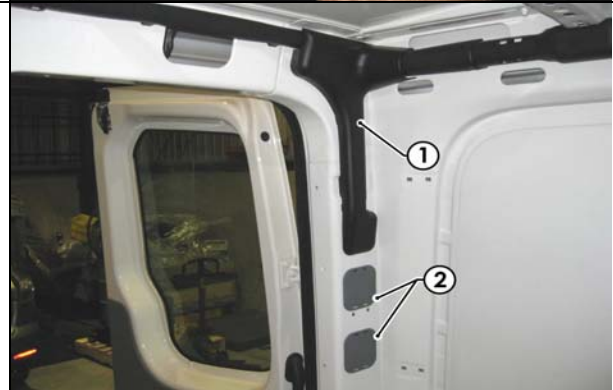

4. Remove the LHS lower rear pillar caps (1).

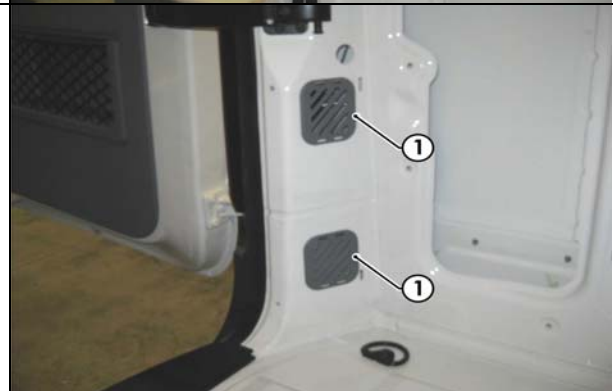

Issue Date 25-10-10

Page 2

Part No: 100513-WL

Hayman Reese (Cequent)  
PO Box 4050, Dandenong South VIC 3164  
Phone 1800 812 017 Email [info@haymanreese.com.au](mailto:info@haymanreese.com.au)

[www.haymanreese.com.au](http://www.haymanreese.com.au)





# HAYMAN REESE

## PART No: 100513-WL

### MERCEDES SPRINTER / VW CRAFTER

# INSTALLATION INSTRUCTIONS

**PLEASE ENSURE THAT INSTRUCTIONS ARE UNDERSTOOD PRIOR TO FITMENT**

5. Inside the LHS rear pillar cavity, disconnect the LHS tail light connector (1) and patch the trailer patch harness (2) (P/No: 100513-WL) in between. **Ensure the correct trailer patch tail light 12-way female connectors are used.**
6. Connect the trailer patch harness ECU connector (3) to the ECU (P/No: 04826) (4). Secure the ECU into the rear pillar cavity using double sided tape.
7. Feed in the guide wire and tape it to the trailer patch harness wires pull the trailer patch harness through the drilled out grommet hole (5).
8. From underneath the vehicle, ensure the trailer patch harness grommet is seated correctly and secure it in place using a cable tie (not supplied)

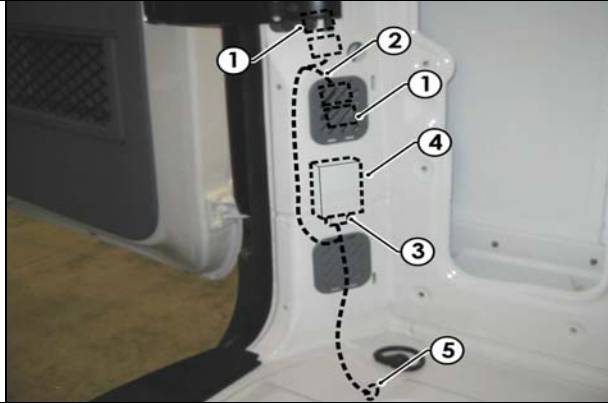

9. Route the trailer patch harness up the rear pillar and out the highest pillar cavity opening, towards the top LHS corner vehicle ring terminal and the vehicle harness wire.
10. Secure the trailer patch harness earth terminal (1) to the vehicle grounding point (2).
11. Secure the supplied ezy tap (3) onto the vehicle harness right indicator GREEN/BLACK wire (4).
12. Insert the trailer patch harness 'GREEN/BLACK terminal wire (5) onto the ezy tap (3).

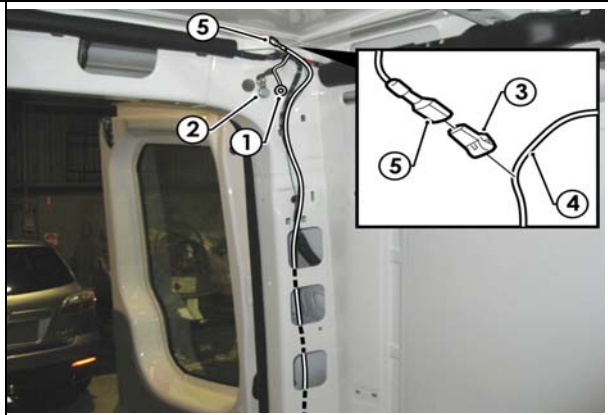

Function	Trailer Patch	Vehicle Connector
R.IND	GREEN / BLACK	GREEN / BLACK

13. In the vehicle cabin on the passenger side, gain access to the battery by removing the jack (1) and floor covers (2).



Issue Date 25-10-10

Page 3

Part No: 100513-WL

Hayman Reese (Cequent)  
 PO Box 4050, Dandenong South VIC 3164  
 Phone 1800 812 017 Email [info@haymanreese.com.au](mailto:info@haymanreese.com.au)

[www.haymanreese.com.au](http://www.haymanreese.com.au)



**HAYMAN REESE**  
**PART No: 100513-WL**  
**MERCEDES SPRINTER / VW CRAFTER**  
**INSTALLATION INSTRUCTIONS**

**PLEASE ENSURE THAT INSTRUCTIONS ARE UNDERSTOOD PRIOR TO FITMENT**

14. Remove the tool tray (1) and remove the battery cover (2).

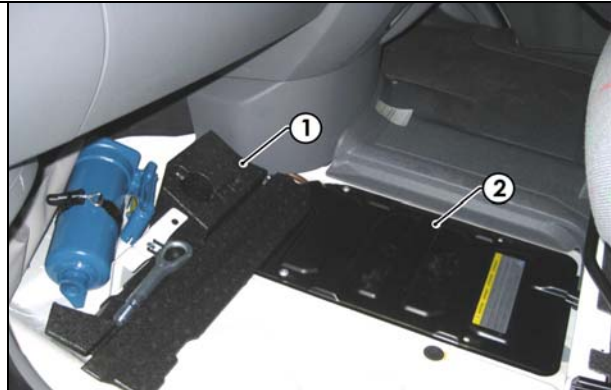

15. Remove the black starter power cable (1).



16. Underneath the vehicle, locate the battery box and dislodge the battery box grommet.  
17. Route the power harness (04825) (1) ring terminals up into the battery box cavity (2).  
18. Route the other end of the power harness (1) down through the battery box grommet.

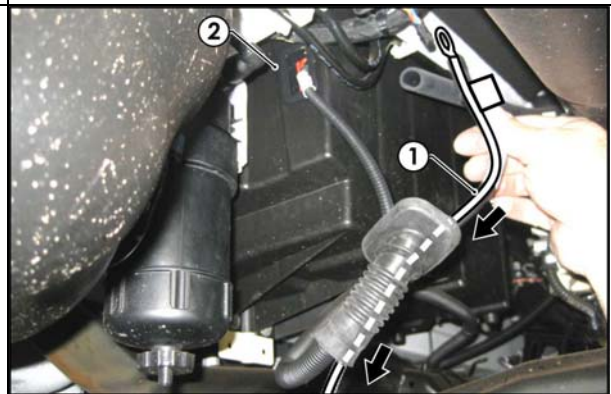

Issue Date 25-10-10

Page 4

Part No: 100513-WL

Hayman Reese (Cequent)  
PO Box 4050, Dandenong South VIC 3164  
Phone 1800 812 017 Email [info@haymanreese.com.au](mailto:info@haymanreese.com.au)

[www.haymanreese.com.au](http://www.haymanreese.com.au)



**HAYMAN REESE**  
**PART No: 100513-WL**  
**MERCEDES SPRINTER / VW CRAFTER**  
**INSTALLATION INSTRUCTIONS**

**PLEASE ENSURE THAT INSTRUCTIONS ARE UNDERSTOOD PRIOR TO FITMENT**

19. Following the existing vehicle harness, route the power harness along the LHS of the vehicle towards the rear.

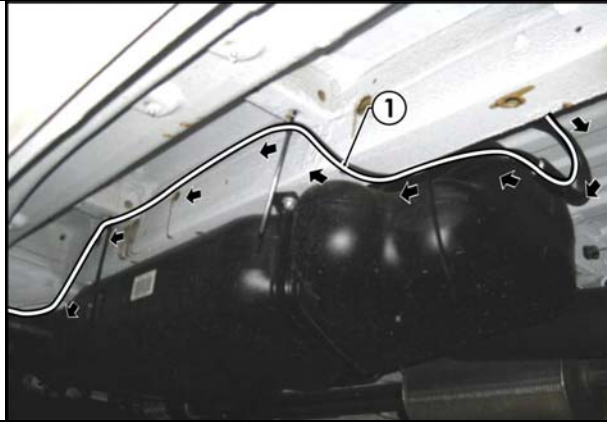

20. Continue routing the harness (1) towards the rear of the vehicle.

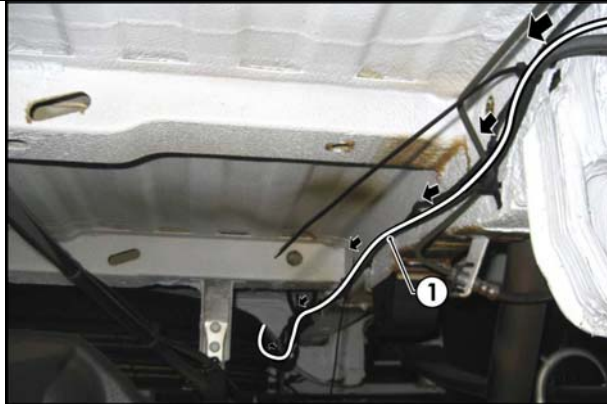

21. Underneath the rear of the vehicle, secure the tail harness (tail length 1200mm) trailer socket (1) to the towbar mounting bracket using M4 fasteners (not supplied).

22. Using electrical grease or silicone, water proof the back of the tail harness and trailer patch harness 8-way connectors (2) (3).

23. Connect the tail harness connector (2) to the trailer patch harness mating connector (3).

24. Connect the trailer patch harness 1-way connector (4) to the power harness (5).

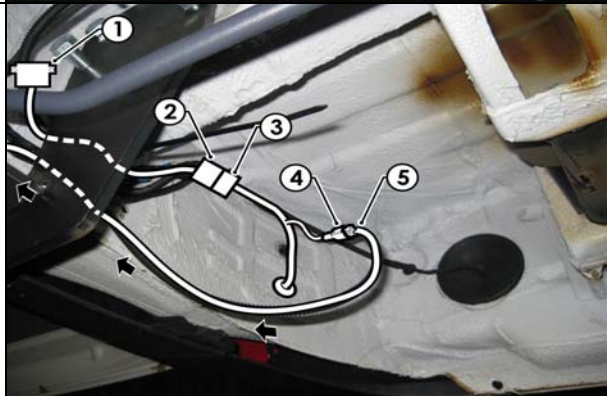

Issue Date 25-10-10

Page 5

Part No: 100513-WL

Hayman Reese (Cequent)  
PO Box 4050, Dandenong South VIC 3164  
Phone 1800 812 017 Email [info@haymanreese.com.au](mailto:info@haymanreese.com.au)

[www.haymanreese.com.au](http://www.haymanreese.com.au)



**HAYMAN REESE**  
**PART No: 100513-WL**  
**MERCEDES SPRINTER / VW CRAFTER**  
**INSTALLATION INSTRUCTIONS**

**PLEASE ENSURE THAT INSTRUCTIONS ARE UNDERSTOOD PRIOR TO FITMENT**

25. Inside the passenger cabin, retrieve the power harness terminal (1). Secure the 'ORANGE' wire terminal (1) to the positive battery terminal (2).



26. Test the Trailer Patch Harness function using a Light Board or multimeter.  
27. Secure the Trailer Patch Harness using cables ties (not supplied).  
28. Re-fit all removed parts and secure all fasteners ensuring there are no squeaks or rattles.  
29. Place instructions in glove box after fitment.

Issue Date 25-10-10

Page 6

Part No: 100513-WL

Hayman Reese (Cequent)  
PO Box 4050, Dandenong South VIC 3164  
Phone 1800 812 017 Email [info@haymanreese.com.au](mailto:info@haymanreese.com.au)

[www.haymanreese.com.au](http://www.haymanreese.com.au)

