

HAYMAN REESE
PART No: 02769RW
LEXUS RX350 (02/2009-ON)

INSTALLATION INSTRUCTIONS

PLEASE ENSURE THAT ALL INSTRUCTIONS ARE UNDERSTOOD PRIOR TO FITMENT



Installation Time: Approx **45 Mins**

Towbar Installation Instructions
LEXUS RX350 (02/2009-ON)

Towbar capacity

Part Number 02769RW

Max Towing Braked 1500kg
Max Static Ball Load 150kg

Hayman Reese (Cequent)
PO Box 4050, Dandenong South VIC 3164
Phone 1800 812 017 Email info@haymanreese.com.au

HAYMAN REESE

PART No: 02769RW

LEXUS RX350

INSTALLATION INSTRUCTIONS

PLEASE ENSURE THAT ALL INSTRUCTIONS ARE UNDERSTOOD PRIOR TO FITMENT

Warning:

1. Do not, drill, cut, weld or otherwise modify the towbar.
2. If you are using electric welding on a motor vehicle, **always** check that the vehicle is not equipped with electronic engine or instrument management equipment. Failure to do so could **destroy** any onboard computers. If in doubt, check with the vehicle's manufacturer.
1. **General:** Ensure all hardware items have been included refer to assembly diagram.
2. It is recommended that the instructions are read through and completely understood before making any attempt to fit this product.
3. Be wary of any changes to vehicle designs or other accessories that may conflict with the installation of this product.
4. Before drilling ensure that the area is clear of fuel, electrical & other components.
5. All holes drilled into the body panels shall have all burrs & swarf removed then coated with a suitable rust preventative paint.
6. The high tensile fasteners supplied with this product were used to achieve the specified rating. If replacement is required ensure that fasteners of the same rating & quality are used. Contact an authorised **Hayman Reese** dealer if further information is required.
7. Ensure that all hardware is fastened to torque list below check fasteners on regular basis.
8. Towbar load rating sticker provided with this product shall be conspicuously located on inside rear end of the driver's door. **(See diagram below).**
9. Hayman Reese recommends that you check your tow ball to ensure that it complies with the Australian standards **AS 4177.2**.
10. **PLEASE NOTE:** It is advised to remove your lug or tbn when not actually towing so as to produce a clear view of the vehicles registration plate if obscured, and to also provide maximum available departure angle.
11. Pull Pin must be fit in down position.

Tow bar Maintenance and Care.

Hayman Reese recommends that bolt torque's, as listed below, are routinely and regularly inspected and checked for correct tension. Replace any worn or defective parts.

We recommended to remove Tow Ball Mounts (TBM's, tongues or lugs) when not being used for any considerable length of time.

So as to avoid injury, when not towing it is suggested that the tongue, Pull Pin and R-clip are removed then stored in a safe, clean and dry place, away from excessive moisture.

Hitch Pull Pins and spring "R" clips are regularly checked for proper installation. Replace any worn or defective parts.

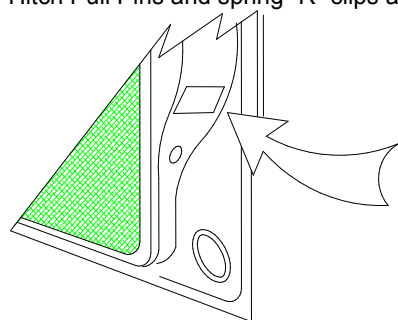

Place load rating sticker
inside driver's door here

RECOMMENDED ASSEMBLY TORQUE LISTING

Diameter Grade 8.8 Bolt

M6	9.5 Nm
M8	21.7 Nm
M10	43.4 Nm
M12	77.3 Nm
M14	146 Nm
M16	189.8 Nm

FOR TOWING PURPOSES ONLY

For towing capacity details please refer to vehicle owner's manual or to the manufacturer. Overloading can void your warranties.

Issue Date 29/01/13

Page 2

Part No: 02769RW

HAYMAN REESE

PART No: 02769RW

LEXUS RX350

INSTALLATION INSTRUCTIONS

PLEASE ENSURE THAT ALL INSTRUCTIONS ARE UNDERSTOOD PRIOR TO FITMENT

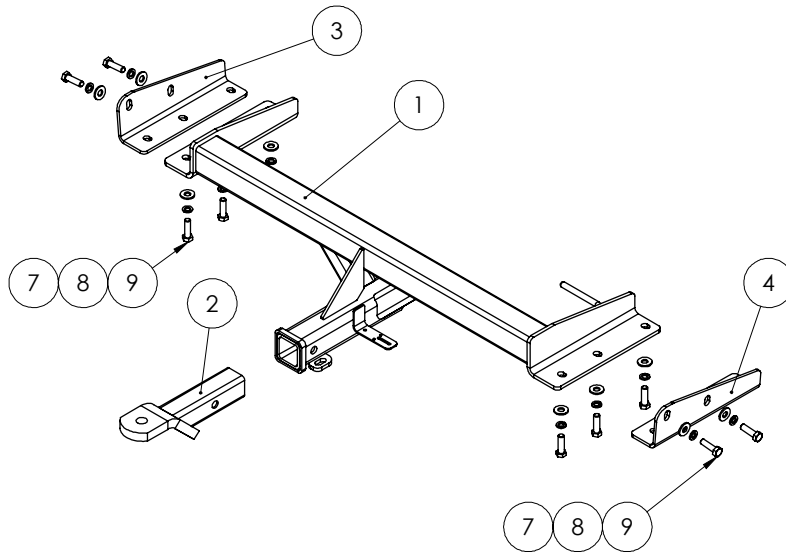

QTY.	DESCRIPTION	ITEM NO.
1	LEXUS RX350 (2009-On)	1
1	T.B.MOUNT 21161	2
1	SIDEARM PASS.	3
1	SIDEARM DRIVER	4
1	BOLT M10-1.50 x 25	5
1	NUT HX M10 - 1.5 Z/P	6
10	WASHER M12x28.8x3mm	7
10	Wshr spring ft sec M12x4.0x2.5mm z/p	8
10	BOLT M12 - 1.25 x 40mm GR 8.8 Z/P	9

ADDITIONAL ITEMS

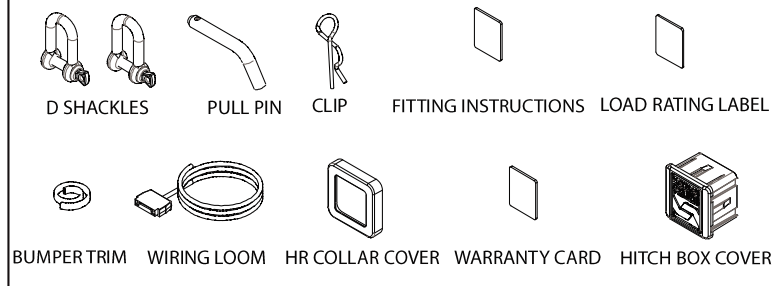



HAYMAN REESE

PART No: 02769RW

LEXUS RX350

INSTALLATION INSTRUCTIONS

PLEASE ENSURE THAT ALL INSTRUCTIONS ARE UNDERSTOOD PRIOR TO FITMENT

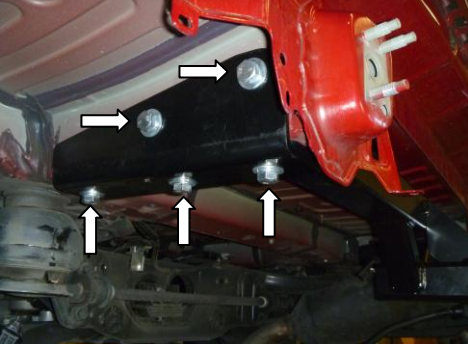
	<ol style="list-style-type: none">1. Remove 12 screws and plastic rivet attaching centre under tray. Remove under tray.
	<ol style="list-style-type: none">2. Remove plastic plugs from under and each side of chassis.3. Remove rear muffler hook bracket and discard.
	<ol style="list-style-type: none">4. Remove towing hooks and discard.5. If fitted also remove gas strut that is bolted between the towing hooks and discard.
	<ol style="list-style-type: none">6. Fit towbar under chassis rails with sidearm brackets using M12x40-1.25P set screws, M12 spring washers and M12 flat washers' supplied.7. Torque all fasteners to specification.

HAYMAN REESE

PART No: 02769RW

LEXUS RX350

INSTALLATION INSTRUCTIONS

PLEASE ENSURE THAT ALL INSTRUCTIONS ARE UNDERSTOOD PRIOR TO FITMENT

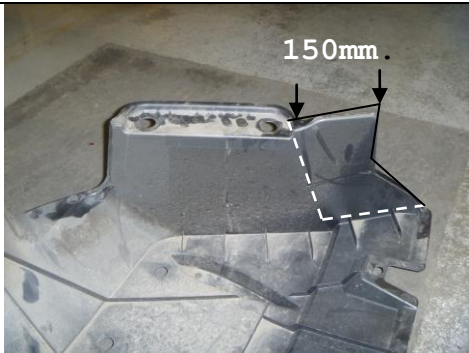
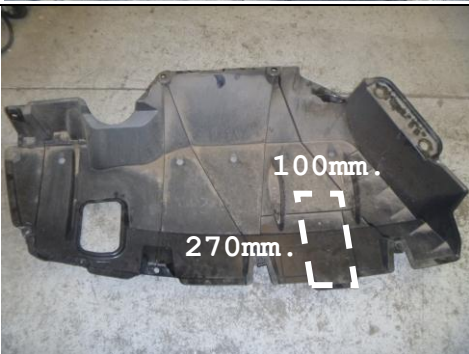
	<p>8. Cut the side of plastic under tray 115mm wide all the way down to ribbing to allow clearing to tow bar.</p>
	<p>9. Using 100mm wide section factory cut out, cut 270mm. 10. Refit plastic under tray.</p>

HAYMAN REESE
PART No: 100481-WL
LEXUS RX350 / RX450H
(FEB '09 ONWARDS)

INSTALLATION INSTRUCTIONS

PLEASE ENSURE THAT INSTRUCTIONS ARE UNDERSTOOD PRIOR TO FITMENT

Wiring Loom Installation Instructions

LEXUS RX350 / RX450H
(FEB '09 ONWARDS)
Part No: 100481-WL

ECU Required: 04826
Tail Harness Length Required: 1800mm
RPA Override Switch Part No: 04848 (If Fitted)

Wiring Loom Installation Time: Approx 60 Mins

1. In the luggage compartment, remove the parcel shelf and the floor carpet cover.
2. Remove the spare wheel cover and then remove the spare wheel.

Issue Date 07-12-10

Page 1

Part No: 100481-WL

Hayman Reese (Cequent)
PO Box 4050, Dandenong South VIC 3164
Phone 1800 812 017 Email info@haymanreese.com.au

www.haymanreese.com.au



HAYMAN REESE
PART No: 100481-WL
LEXUS RX350 / RX450H
(FEB '09 ONWARDS)

INSTALLATION INSTRUCTIONS

PLEASE ENSURE THAT INSTRUCTIONS ARE UNDERSTOOD PRIOR TO FITMENT

3. Remove the LHS tool tray.
4. Remove the centre storage compartment by first removing the three clips.
5. Remove the rear battery cover.

Note: This Step is for RX450H vehicles only. For RX350 vehicles please proceed to Step 7.

6. Disconnect and remove the rear battery.
7. Remove the LHS storage compartment cover.
8. Remove the LHS storage compartment by first removing the three fasteners.
9. Remove the rear trim.
10. Remove the LHS rear trim by first removing any fasteners.
11. Remove the LHS cargo hook.
12. Dislodge the LHS side trim by first removing any clips or fasteners.
13. Disconnect the LHS luggage compartment two light connector wires and the 12v accessory 2-way connector.
14. Remove the LHS side trim.
15. Remove the LHS support bar by first removing the three fasteners.
16. Remove the subwoofer bracket by first removing the two fasteners.
17. Disconnect the subwoofer connector and remove the subwoofer by first removing the three fasteners.

Issue Date 07-12-10

Page 2

Part No: 100481-WL

Hayman Reese (Cequent)
PO Box 4050, Dandenong South VIC 3164
Phone 1800 812 017 Email info@haymanreese.com.au

www.haymanreese.com.au



HAYMAN REESE
PART No: 100481-WL
LEXUS RX350 / RX450H
(FEB '09 ONWARDS)

INSTALLATION INSTRUCTIONS

PLEASE ENSURE THAT INSTRUCTIONS ARE UNDERSTOOD PRIOR TO FITMENT

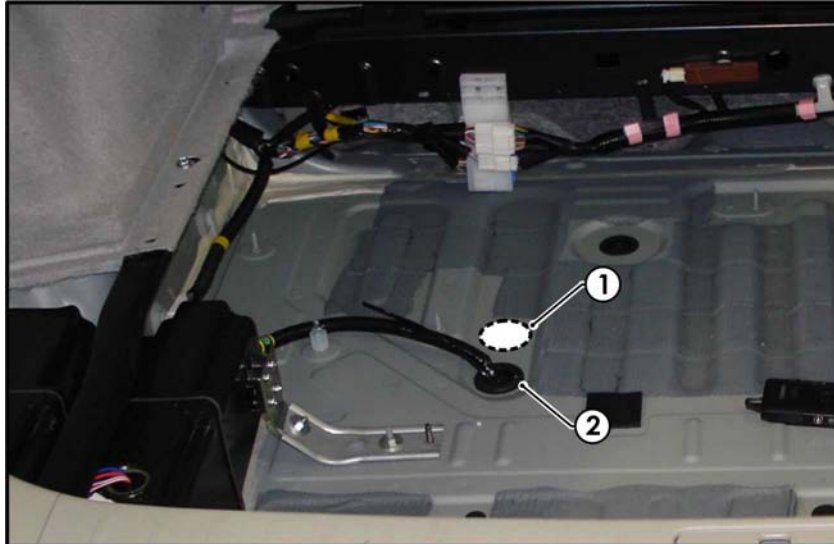

18. Drill a Ø31mm hole (1) just behind the luggage compartment grommet (2).
19. File any rough or sharp edges and spray on rust inhibitor.
20. Locate the vehicle 12-way breakout male connector.
21. Connect the Trailer Harness (P/No: 100481-WL) mating 12-way connector to the vehicle 12-way connector.
22. Connect the Trailer Harness 12-way ECU connector to the ECU (04826).
23. Apply double sided tape to the ECU and adhere it to the flat surface of the LHS luggage compartment floor.
24. Connect the Trailer Harness ground ring terminal to the vehicle earthing point located on the rear LHS of the luggage compartment.
25. Mount the Trailer Socket to the towbar mounting bracket using M4 fasteners (not supplied).
26. Route the Tail Harness (tail length 1800mm) across the towbar towards the RHS of the vehicle and up through the previously drilled out hole.

Issue Date 07-12-10

Page 3

Part No: 100481-WL

Hayman Reese (Cequent)
PO Box 4050, Dandenong South VIC 3164
Phone 1800 812 017 Email info@haymanreese.com.au

www.haymanreese.com.au



HAYMAN REESE
PART No: 100481-WL
LEXUS RX350 / RX450H
(FEB '09 ONWARDS)

INSTALLATION INSTRUCTIONS

PLEASE ENSURE THAT INSTRUCTIONS ARE UNDERSTOOD PRIOR TO FITMENT

27. Ensure the Tail Harness grommet is seated correctly and secure in place using a cable tie (not supplied).
28. Connect the tail harness 8-way connector to the trailer harness mating 8-way connector.
29. Test the Trailer Harness function using a Light Board or multimeter.
30. Secure all Harnesses using cables ties (not supplied).
31. Re-fit all removed parts and secure all fasteners, ensuring there are no squeaks or rattles.
32. Place the instructions in the glove box after fitment.

Issue Date 07-12-10

Page 4

Part No: 100481-WL

Hayman Reese (Cequent)
PO Box 4050, Dandenong South VIC 3164
Phone 1800 812 017 Email info@haymanreese.com.au

www.haymanreese.com.au

