

HAYMAN REESE
PART No: 2900RLW
TOYOTA CAMRY ATARA October-2011 ON

INSTALLATION INSTRUCTIONS

PLEASE ENSURE THAT INSTRUCTIONS ARE UNDERSTOOD PRIOR TO FITMENT



Installation Time: Approx 70 mins

Towbar Installation Instructions
Toyota Camry ATARA

Towbar capacity

Part Number 2900RLW

Max Towing Braked 1600kg
Max Static Ball Load 160kg

Page 1 of 13

Issue 1

21-10-11

www.haymanreese.com.au



HAYMAN REESE
PART No: 2900RLW
TOYOTA CAMRY ATARA October-2011 ON

INSTALLATION INSTRUCTIONS

PLEASE ENSURE THAT INSTRUCTIONS ARE UNDERSTOOD PRIOR TO FITMENT

Warning:

- | | | |
|---|-----------------------------|----------------|
| 1. Do not, drill, cut, weld or otherwise modify the towbar. | Rating Braked | 1600 Kg |
| 2. If you are using electric welding on a motor vehicle, <u>always</u> check that the vehicle is not equipped with electronic engine or instrument management equipment. Failure to do so could <u>destroy</u> any onboard computers. If in doubt, check with the vehicle's manufacturer. | Rating Unbraked | 750 Kg |
| | Max Static Ball Load | 160 Kg |

General:

1. Ensure all hardware items have been included
2. It is recommended that the instructions are read through and completely understood before making any attempt to fit this product.
3. Be wary of any changes to vehicle designs or other accessories that may conflict with the installation of this product.
4. Before drilling ensure that the area is clear of fuel, electrical & other components.
5. All holes drilled into the body panels shall have all burrs & swarf removed then coated with a suitable rust preventative paint.
6. The high tensile fasteners supplied with this product were used to achieve the specified rating. If replacement is required ensure that fasteners of the same rating & quality are used. Contact an authorised **Hayman Reese** dealer if further information is required.
7. Ensure that all hardware is fastened to torque list below check fasteners on regular basis.
8. Towbar load rating sticker provided with this product shall be conspicuously located on inside rear end of the driver's door. **(See diagram below).**
9. Hayman Reese recommends that you check your tow ball to ensure that it complies with the Australian standards **AS 4177.2**.
10. **PLEASE NOTE:** It is advised to remove your lug or tbn when not actually towing so as to produce a clear view of the vehicles registration plate if obscured, and to also provide maximum available departure angle.

Tow bar Maintenance and Care.

Hayman Reese recommends that bolt torque's, as listed below, are routinely and regularly inspected and checked for correct tension. Replace any worn or defective parts.

We recommended to remove Tow Ball Mounts (TBM's, tongues or lugs) when not being used for any considerable length of time.

So as to avoid injury, when not towing it is suggested that the tongue, Pull Pin and R-clip are removed then stored in a safe, clean and dry place, away from excessive moisture.

Hitch Pull Pins and spring "R" clips are regularly checked for proper installation. Replace any worn or defective parts.



HAYMAN REESE

PART No: 2900RLW

TOYOTA CAMRY ATARA October-2011 ON

INSTALLATION INSTRUCTIONS

PLEASE ENSURE THAT INSTRUCTIONS ARE UNDERSTOOD PRIOR TO FITMENT

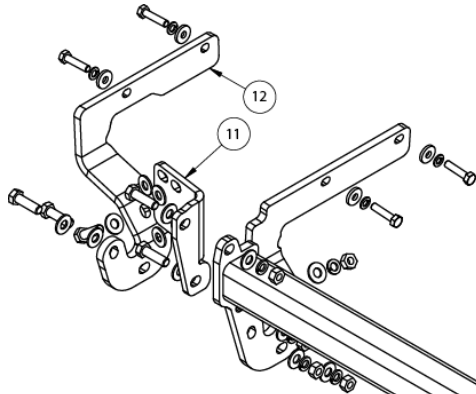

RECOMMENDED ASSEMBLY TORQUE LISTING

Diameter Grade 8.8 Bolt

M6 9.5 Nm

M8 21.7 Nm

M10 43.4 Nm

M12 77.3 Nm

M16 189.8 Nm

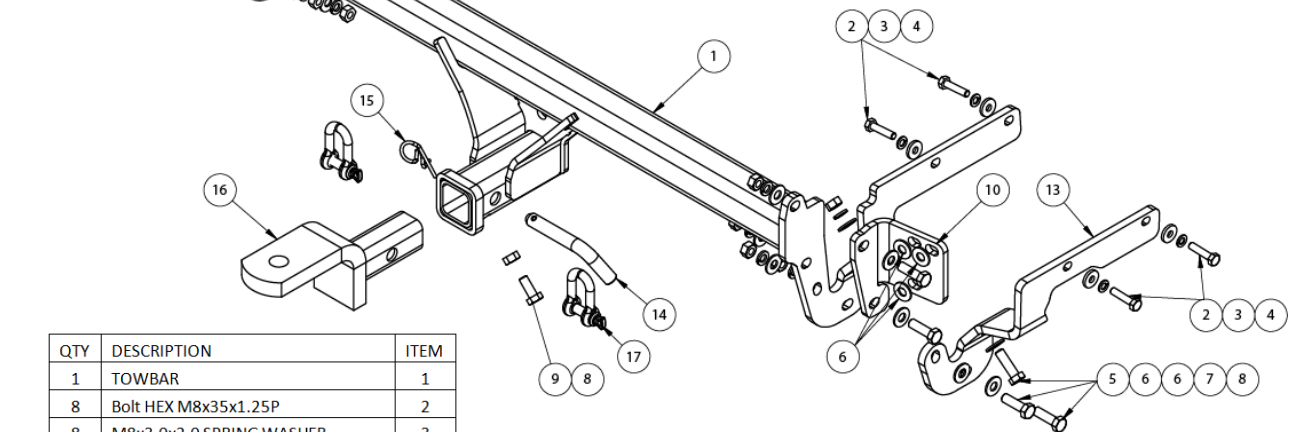

QTY	DESCRIPTION	ITEM
1	TOWBAR	1
8	Bolt HEX M8x35x1.25P	2
8	M8x3.0x2.0 SPRING WASHER	3
8	M8 x 22 x 3.3mm FLAT WASHER	4
10	M10 - 1.5 x 35mm BOLT	5
26	Washer Flat M10 x 23 x 2 z/p	6
10	M10 X 3.5 X 2.2 SPRING WASHER	7
11	HEX NUT M10x1.5	8
1	BOLT M10-1.50 x 25	9
1	DRIVER REAR PLATE	10
1	PASSENGER REAR PLATE	11
1	PASSENGER BOLT ON BRACKET	12
1	DRIVER BOLT ON BRACKET	13
1	PULL PIN	14
1	COTTER PIN	15
1	TOWALL MOUNT	16
2	D' SHACKLE	17
1	LOAD RATING STICKER	18
1	WIRING LOOM	19

Item 19 - Wiring Loom not shown.

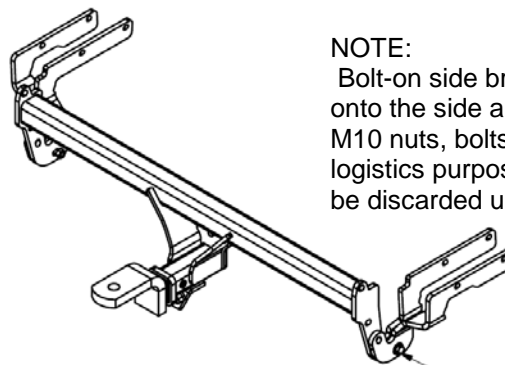

NOTE:

Bolt-on side brackets are bolted onto the side arm as shown. These M10 nuts, bolts and washers are for logistics purposes only and should be discarded upon fitment.

2 OF M10 X 45 BOLTS
4 OF M10 FLAT WASHERS
2 OF M10 NUTS

HAYMAN REESE
PART No: 2900RLW
TOYOTA CAMRY ATARA October-2011 ON

INSTALLATION INSTRUCTIONS

PLEASE ENSURE THAT INSTRUCTIONS ARE UNDERSTOOD PRIOR TO FITMENT

- 1 Remove the rear bumper of the vehicle by following the steps described below.
 - a) If fitted, remove the mudflaps from the vehicle on both driver & passenger sides (3 fasteners each).
 - b) Remove bolts located on the underside of rear bumper & inside the rear wheel arch on both driver and passenger sides.
 - c) If fitted, remove the undercover.
 - d) Remove the two clips securing the bumper to the body.
 - e) Remove the panels on the rear bumper to access the bolts securing the bumper to the body on both driver & passenger sides as shown in figure 1.

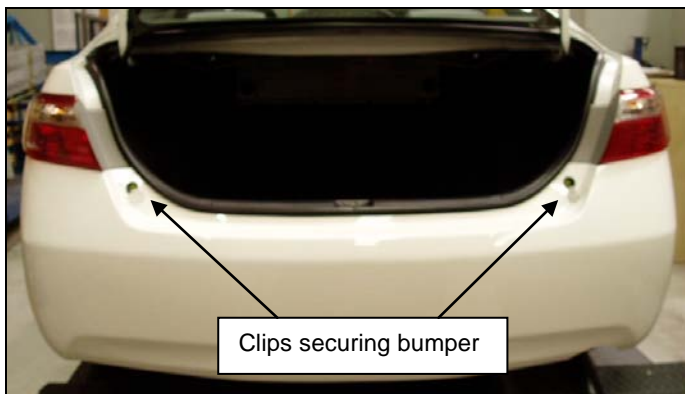

HAYMAN REESE
PART No: 2900RLW
TOYOTA CAMRY ATARA October-2011 ON

INSTALLATION INSTRUCTIONS

PLEASE ENSURE THAT INSTRUCTIONS ARE UNDERSTOOD PRIOR TO FITMENT

- 2 Remove & discard the impact beam.
NOTE: Please retain the nuts used to mount the impact beam as they are to be used to fit the Rear Panel bracket as shown in drawing of Towbar.



- 3 Lower the exhaust/s off the rubber mounts (3 places). Remove the 2 bolts holding the exhaust in place and remove the exhaust/s.



- 4 Remove any exhaust hanger brackets shown.

- 5 Remove heat shield (3 bolts) from the vehicle.

- 6 Trial fit inner and outer chassis brackets (items 2 and 3). If they cannot fit, remove body sealer shown opposite. Coat any bare metal exposed with metal primer.

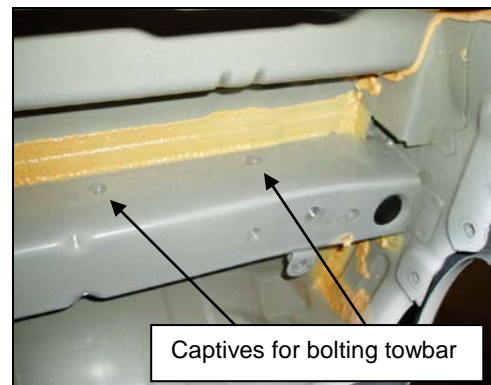

HAYMAN REESE
PART No: 2900RLW
TOYOTA CAMRY ATARA October-2011 ON

INSTALLATION INSTRUCTIONS

PLEASE ENSURE THAT INSTRUCTIONS ARE UNDERSTOOD PRIOR TO FITMENT

- 7 Manoeuvre the main towbar to the vehicle. Loosely secure towbar assembly mounts to the inner side of the chassis shown on both the driver & passenger sides.
- 8 Secure both the chassis brackets on the outer side of the chassis rail loosely using m8 bolts.
- 9 Refit any exhaust hangers.
NOTE: Brackets to be tightened only after the exhaust hanger is fitted back on.
- 10 Tighten the brackets to the chassis as shown in figures and also bolt it to the main towbar assembly on both driver & passenger sides using M10 bolts (3 places) on both sides.
- 11 Offer rear plate bracket to vehicle. These brackets are bolted onto the rear panel using the nuts from the impact beam.
- 12 Fasten all hardware loosely then tighten to torque listing.

- 13 Secure all heat shields using original fasteners.
- 14 Refit exhaust as per step 4.



HAYMAN REESE
PART No: 2900RLW
TOYOTA CAMRY ATARA October-2011 ON

INSTALLATION INSTRUCTIONS

PLEASE ENSURE THAT INSTRUCTIONS ARE UNDERSTOOD PRIOR TO FITMENT

- 15 Temporarily refit the bumper to the vehicle and mark the location of the towbar side arms. Cut the bumper at two places allowing 3-5mm each side as per figure 1.
- 16 Trim the bumper center as per figure 2.
- 17 If fitted, trim the undercover as per figure 3.
- 18 Refit bumper in reverse of step 1.
- 19 Towbar sticker to be consciously located on inside of drivers door (see diagram page 3).

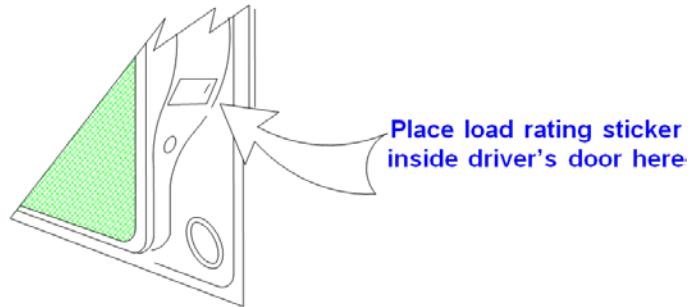

FOR TOWING PURPOSES ONLY
For towing capacity details please refer to vehicle owner's manual or to the manufacturer. Overloading can void your warranties.

PLEASE NOTE: It is advised to remove lug when not actually towing as to produce a clear view of the vehicles registration plate and to improve departure angle.

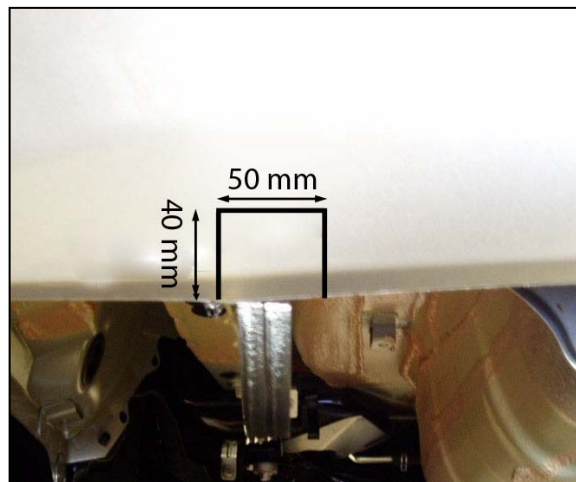

Figure 1 - Bumper cut for side arm

HAYMAN REESE
PART No: 2900RLW
TOYOTA CAMRY ATARA October-2011 ON

INSTALLATION INSTRUCTIONS

PLEASE ENSURE THAT INSTRUCTIONS ARE UNDERSTOOD PRIOR TO FITMENT

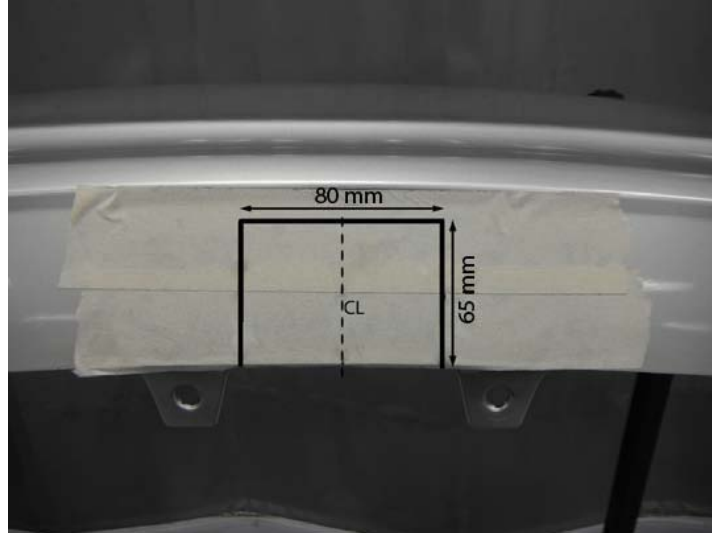

Figure 2 - Bumper cut



Figure 3 - Undercover cut

HAYMAN REESE
PART No: 2900RLW
TOYOTA CAMRY ATARA October-2011 ON

INSTALLATION INSTRUCTIONS

PLEASE ENSURE THAT INSTRUCTIONS ARE UNDERSTOOD PRIOR TO FITMENT

Trailer Harness Installation Instructions

TOYOTA CAMRY / AURION
(2011 – Onwards)
Part No: 100759-WL

Tail Harness Length Required: 1800mm
RPA Override Switch Part No: 04826 (If Fitted)

Wiring Loom Installation time: Approx. 30 Mins



HAYMAN REESE
PART No: 2900RLW
TOYOTA CAMRY ATARA October-2011 ON

INSTALLATION INSTRUCTIONS

PLEASE ENSURE THAT INSTRUCTIONS ARE UNDERSTOOD PRIOR TO FITMENT

1. In the luggage compartment, remove the floor carpet cover (1).



2. Remove the LHS and RHS tool storage compartment (1) and the centre wheel cover (2).

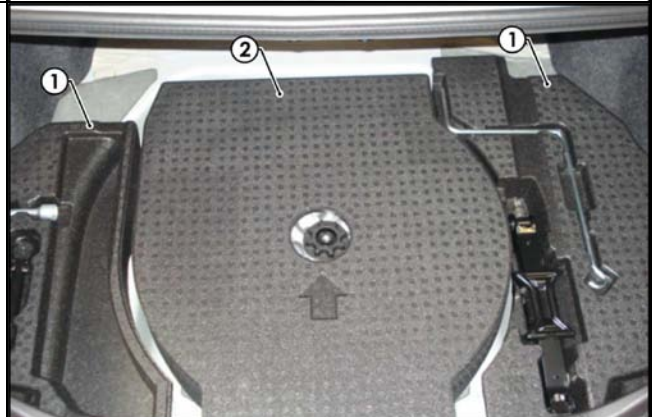

3. On the LHS of the luggage compartment, remove the luggage compartment trim (1) by removing the two scrivenets (2) and the cargo hook (3).

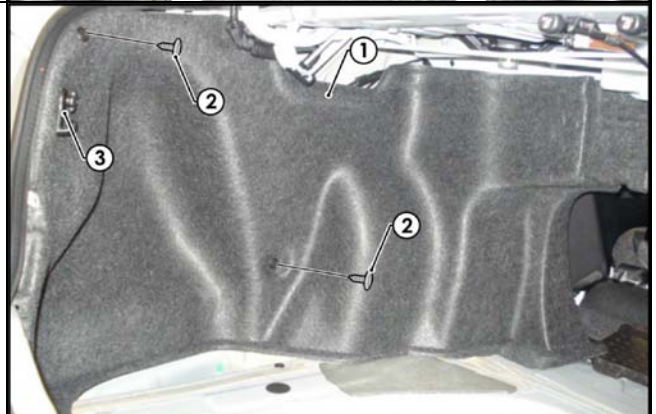

HAYMAN REESE
PART No: 2900RLW
TOYOTA CAMRY ATARA October-2011 ON

INSTALLATION INSTRUCTIONS

PLEASE ENSURE THAT INSTRUCTIONS ARE UNDERSTOOD PRIOR TO FITMENT

4. On the LHS rear quarter panel, below the air vent, drill out the existing grommet hole (1) to Ø30mm.
5. File any rough or sharp edges and then spray on rust inhibitor.

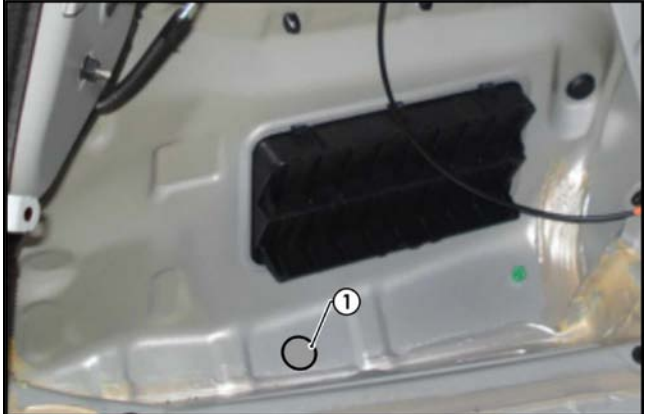

6. On the LHS of the luggage compartment, disconnect the 8-way vehicle connectors (1) and connect the trailer harness (100759-WL) connectors (2) in between.

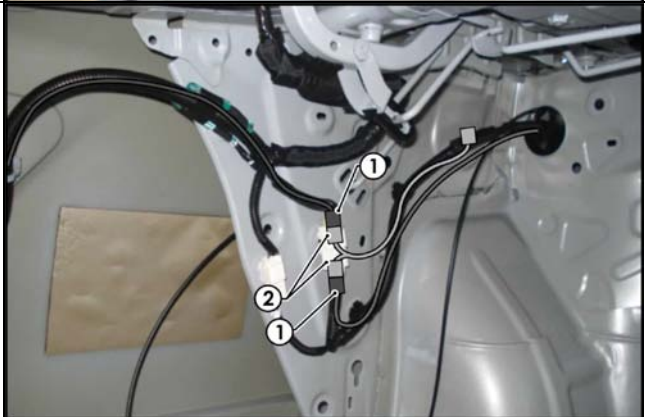

7. Apply double sided tape to the ECU (1) and adhere it to the vehicle sheet metal on the LHS of the luggage compartment.
8. Connect the trailer patch 12-way Female connector (2) to the ECU (1).

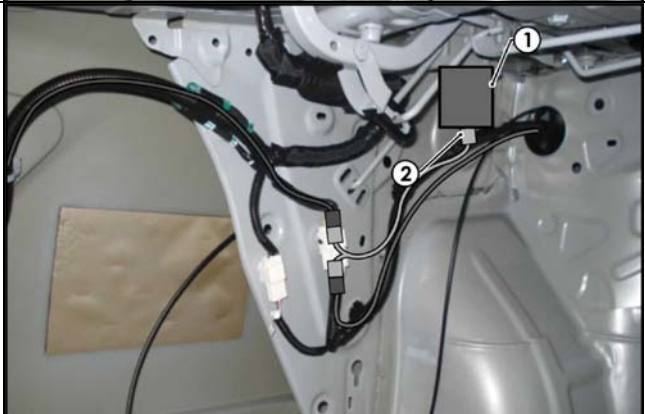

HAYMAN REESE
PART No: 2900RLW
TOYOTA CAMRY ATARA October-2011 ON

INSTALLATION INSTRUCTIONS

PLEASE ENSURE THAT INSTRUCTIONS ARE UNDERSTOOD PRIOR TO FITMENT

9. Route the trailer harness (1) along the existing vehicle harness towards the rear of the luggage compartment.
10. Connect the trailer patch ground ring terminal (2) to the vehicle grounding point (3).

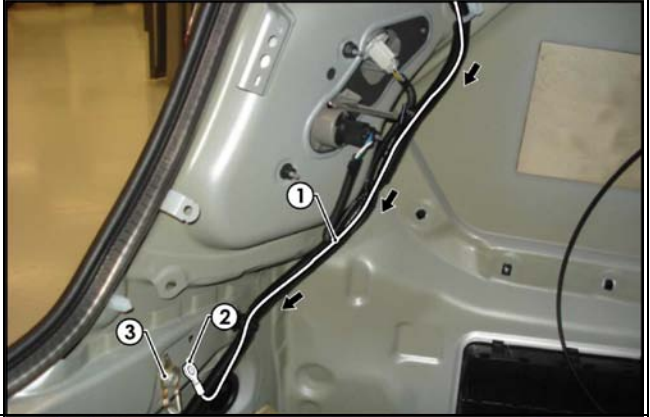

11. Mount the trailer socket (1) to the towbar mounting bracket using M4 fasteners (not supplied).
12. Route the tail harness (tail length 1800mm) (2) towards the LHS of the vehicle and up through the previously drilled out hole.
13. Ensure the tail harness grommet is seated correctly and makes a good seal.
14. Secure the grommet in place using a cable tie (not supplied).



15. Connect the trailer harness 8-way connector (1) to the tail harness mating connector (2).

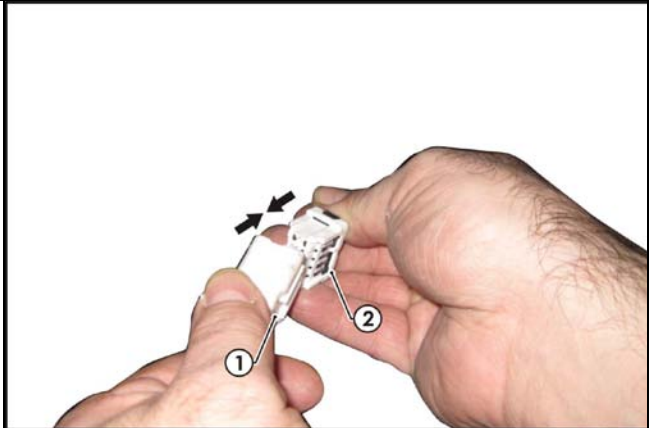

HAYMAN REESE
PART No: 2900RLW
TOYOTA CAMRY ATARA October-2011 ON

INSTALLATION INSTRUCTIONS

PLEASE ENSURE THAT INSTRUCTIONS ARE UNDERSTOOD PRIOR TO FITMENT

- | | |
|--|--|
| <ol style="list-style-type: none">16. Test the Trailer Harness function using a light board or multimeter.17. Secure all harnesses using cable ties (not supplied).18. Re-fit all removed parts and secure all fasteners, ensuring there are no squeaks or rattles.19. Place the instructions in the glove box after fitment. | |
|--|--|

