

HAYMAN REESE
PART No: 02970RW
MERCEDES B CLASS HATCH 03/2012 - ON

INSTALLATION INSTRUCTIONS

PLEASE ENSURE THAT ALL INSTRUCTIONS ARE UNDERSTOOD PRIOR TO FITMENT
PLACE THESE INSTRUCTIONS IN THE VEHICLE'S GLOVEBOX AFTER INSTALLATION IS COMPLETE



Installation Time: Approx **45** Mins

Towbar Installation Instructions

Towbar capacity

MERCEDES B CLASS HATCH 03/2012 - ON

Part Number 02970RW

Max Towing Braked

1500 kg

Max Static Ball Load

75 kg

Hayman Reese (Cequent)
PO Box 4050, Dandenong South VIC 3164
Phone 1800 812 017 Email info@haymanreese.com.au

HAYMAN REESE

PART No: 02970RW

MERCEDES B CLASS HATCH 03/2012 - ON

INSTALLATION INSTRUCTIONS

PLEASE ENSURE THAT ALL INSTRUCTIONS ARE UNDERSTOOD PRIOR TO FITMENT
PLACE THESE INSTRUCTIONS IN THE VEHICLES'S GLOVEBOX AFTER INSTALLATION IS COMPLETE

Warning:

1. Do not, drill, cut, weld or otherwise modify the towbar.
2. If you are using electric welding on a motor vehicle, **always** check that the vehicle is not equipped with electronic engine or instrument management equipment. Failure to do so could **destroy** any onboard computers. If in doubt, check with the vehicle's manufacturer.

General:

1. Ensure all hardware items have been included refer to assembly diagram.
2. It is recommended that the instructions are read through and completely understood before making any attempt to fit this product.
3. Be wary of any changes to vehicle designs or other accessories that may conflict with the installation of this product.
4. Before drilling ensure that the area is clear of fuel, electrical & other components.
5. All holes drilled into the body panels shall have all burrs & swarf removed then coated with a suitable rust preventative paint.
6. The high tensile fasteners supplied with this product were used to achieve the specified rating. If replacement is required ensure that fasteners of the same rating & quality are used. Contact an authorised **Hayman Reese** dealer if further information is required.
7. Ensure that all hardware is fastened to torque list below check fasteners on regular basis.
8. Towbar load rating sticker provided with this product shall be conspicuously located on inside rear end of the driver's door. **(See diagram below).**
9. Hayman Reese recommends that you check your tow ball to ensure that it complies with the Australian standards **AS 4177.2**.
10. **PLEASE NOTE:** It is advised to remove your lug or tbn when not actually towing so as to produce a clear view of the vehicles registration plate if obscured, and to also provide maximum available departure angle.
11. Pull Pin must be fit in down position.

Tow bar Maintenance and Care.

Hayman Reese recommends that bolt torque's, as listed below, are routinely and regularly inspected and checked for correct tension. Replace any worn or defective parts.

We recommended to remove Tow Ball Mounts (TBM's, tongues or lugs) when not being used for any considerable length of time.

So as to avoid injury, when not towing it is suggested that the tongue, Pull Pin and R-clip are removed then stored in a safe, clean and dry place, away from excessive moisture.

Hitch Pull Pins and spring "R" clips are regularly checked for proper installation. Replace any worn or defective parts.

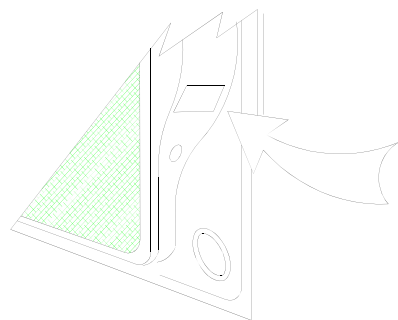

Place load rating sticker
inside driver's door here

RECOMMENDED ASSEMBLY TORQUE LISTING

Diameter Grade 8.8 Bolt

M6	9.5 Nm
M8	21.7 Nm
M10	43.4 Nm
M12	77.3 Nm
M14	146 Nm
M16	189.8 Nm

FOR TOWING PURPOSES ONLY

For towing capacity details please refer to vehicle owner's manual or to the manufacturer. Overloading can void your warranties.

HAYMAN REESE

PART No: 02970RW

MERCEDES B CLASS HATCH 03/2012 - ON

INSTALLATION INSTRUCTIONS

PLEASE ENSURE THAT ALL INSTRUCTIONS ARE UNDERSTOOD PRIOR TO FITMENT
PLACE THESE INSTRUCTIONS IN THE VEHICLE'S GLOVEBOX AFTER INSTALLATION IS COMPLETE

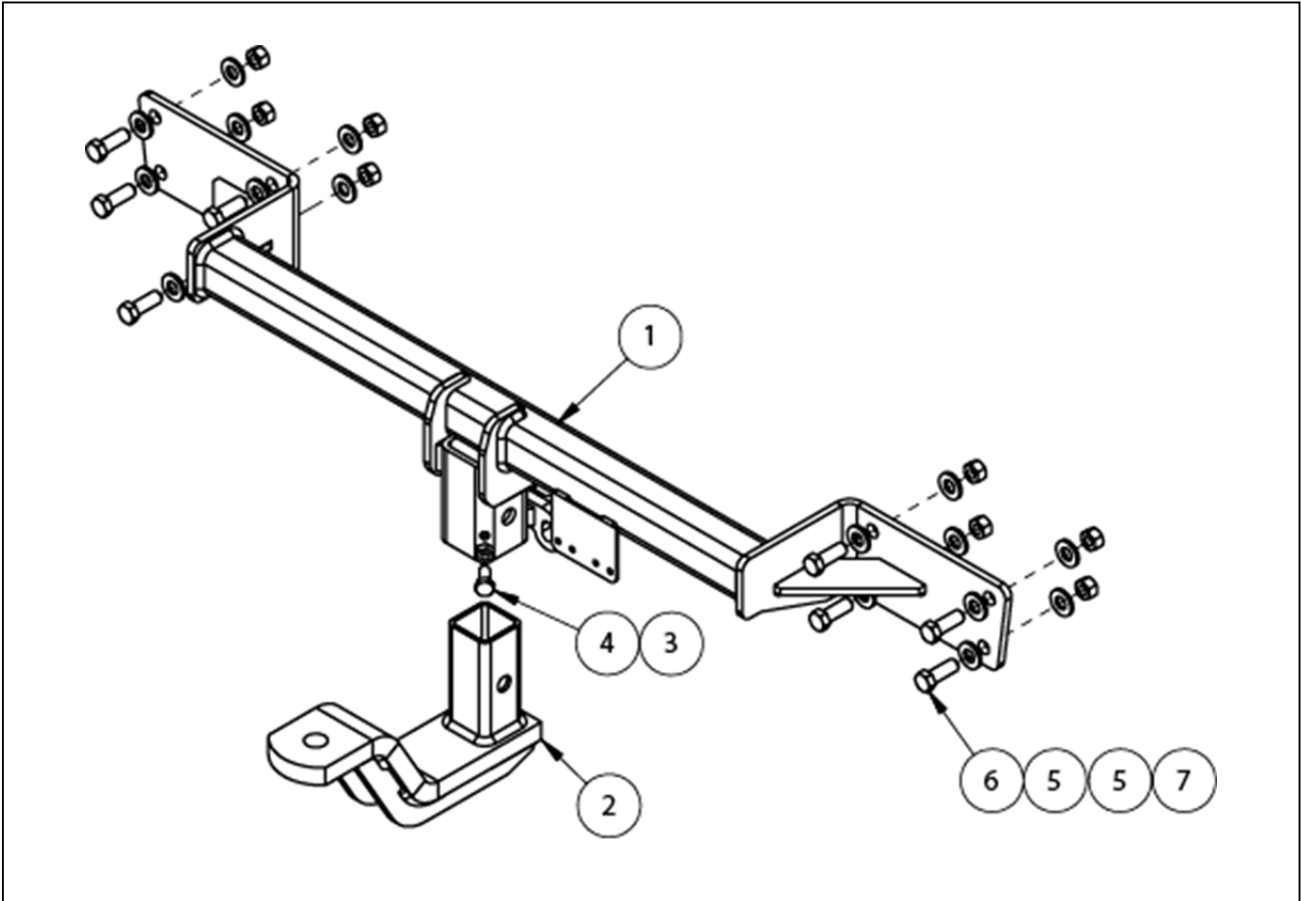

QTY	DESCRIPTION	ITEM NO.
1	WELDED TOWBAR	1
1	TBM ASSY	2
1	HEX NUT M10x1.5	3
1	BOLT M10-1.50 x 25	4
16	WASHER FLAT 1/2" x1 1/8"x 1/8"	5
8	M12x35 1.75P BOLT	6
8	M12x1.75 HEX NUT PC8	7

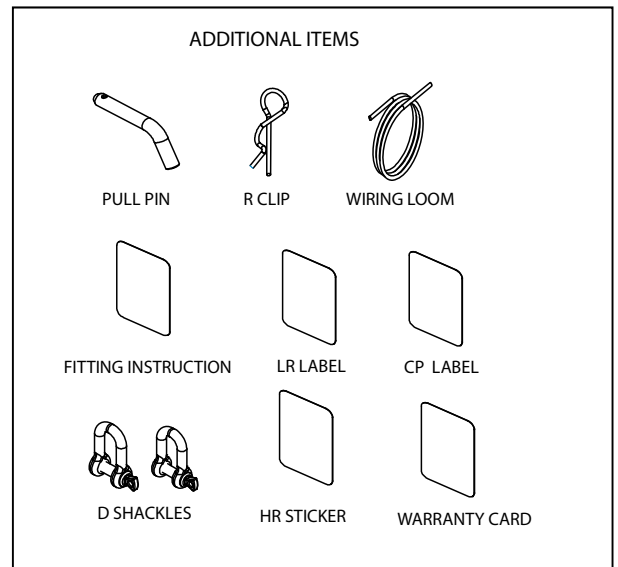

HAYMAN REESE

PART No: 02970RW

MERCEDES B CLASS HATCH 03/2012 - ON

INSTALLATION INSTRUCTIONS

PLEASE ENSURE THAT ALL INSTRUCTIONS ARE UNDERSTOOD PRIOR TO FITMENT

PLACE THESE INSTRUCTIONS IN THE VEHICLE'S GLOVEBOX AFTER INSTALLATION IS COMPLETE

1. Open Boot and remove Boot Side Trim from the LHS. Remove 3 Nuts and Wiring Connector as shown and dislodge the Tail Light assembly.

Repeat for RHS.

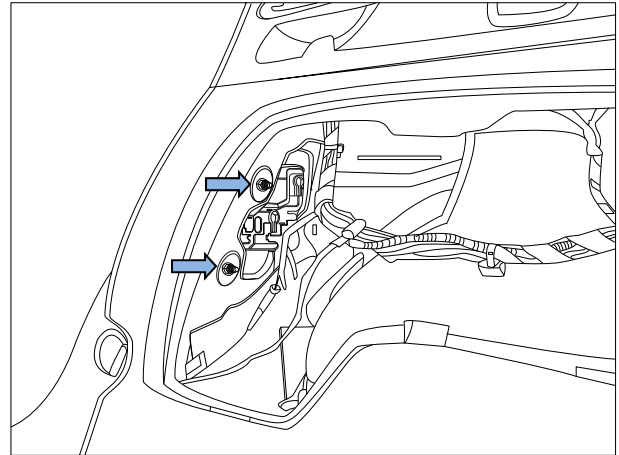

2. Remove 1 Scrivet from inside of Rear Wheel Arch and underneath Bumper on both sides of vehicle.

3. Force Wheel Arch Trim away from Bumper to expose 2 Nuts fastening the Bumper to Rear Quarter Panel. Remove the 2 Screws on the LHS side of Bumper as shown.

Repeat for RHS.

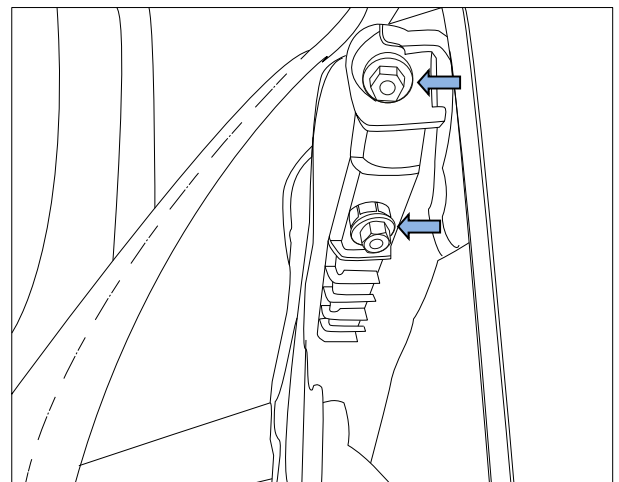

HAYMAN REESE

PART No: 02970RW

MERCEDES B CLASS HATCH 03/2012 - ON

INSTALLATION INSTRUCTIONS

PLEASE ENSURE THAT ALL INSTRUCTIONS ARE UNDERSTOOD PRIOR TO FITMENT

PLACE THESE INSTRUCTIONS IN THE VEHICLE'S GLOVEBOX AFTER INSTALLATION IS COMPLETE

- Carefully remove Bumper and disconnect any wiring Harness Connectors fitted.

- Remove Nuts on exhaust Heat Shield and loosen to gain better access to Rear Impact Beam Bolts.

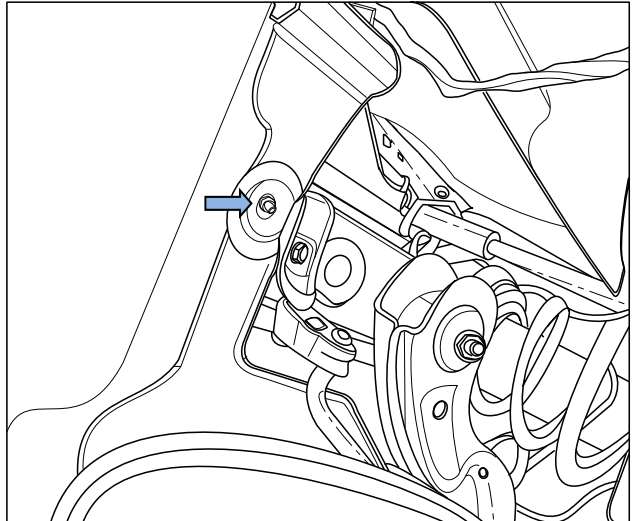

- Remove 4 Bolts on LHS Rear Chassis Panel fastening Impact Beam to Chassis.

Repeat for RHS.

Remove and discard Impact Beam and fasteners.

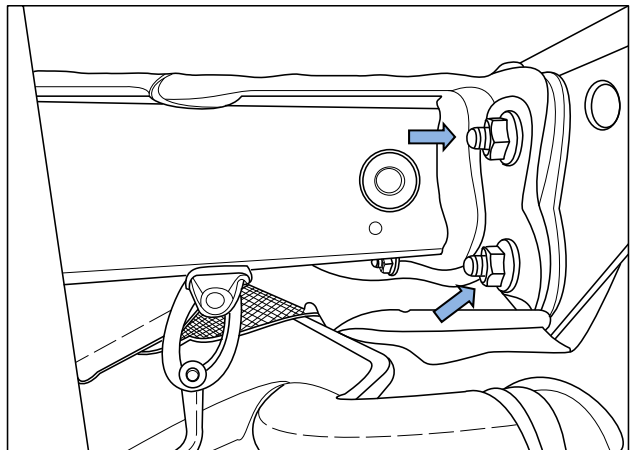

HAYMAN REESE

PART No: 02970RW

MERCEDES B CLASS HATCH 03/2012 - ON

INSTALLATION INSTRUCTIONS

PLEASE ENSURE THAT ALL INSTRUCTIONS ARE UNDERSTOOD PRIOR TO FITMENT

PLACE THESE INSTRUCTIONS IN THE VEHICLE'S GLOVEBOX AFTER INSTALLATION IS COMPLETE

7. Offer Towbar to vehicle and fasten using M12 Bolts, Washers and Nuts as shown on Page 3.

Fasten all Bolts to torque specification on Page 2.

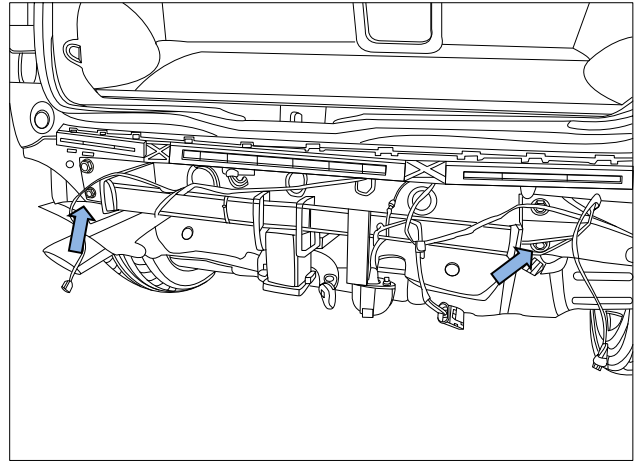

8. Reattach Bumper using steps 1-6 in reverse.

HAYMAN REESE
PART No: 100869-WL
MERCEDES B-CLASS

INSTALLATION INSTRUCTIONS

PLEASE ENSURE THAT INSTRUCTIONS ARE UNDERSTOOD PRIOR TO FITMENT

Wiring Loom Installation Instructions

MERCEDES B-CLASS

Part No: 100869-WL
ECU: 04831

Mercedes B-Class Tail Harness Length Required: 1200mm

Wiring Loom Installation Time: Approx.20 minutes

Issue Date 04/12/12

Page 1

Part No: 100869-WL

Hayman Reese (Cequent)
PO Box 4050, Dandenong South VIC 3164
Phone 1800 812 017 Email info@haymanreese.com.au

www.haymanreese.com.au



HAYMAN REESE
PART No: 100869-WL
MERCEDES B-CLASS

INSTALLATION INSTRUCTIONS

PLEASE ENSURE THAT INSTRUCTIONS ARE UNDERSTOOD PRIOR TO FITMENT

1. In the luggage compartment, remove the rubber floor cover (1).
2. Remove the six star screws (2) underneath the plastic trim cover (1) and dislodge.

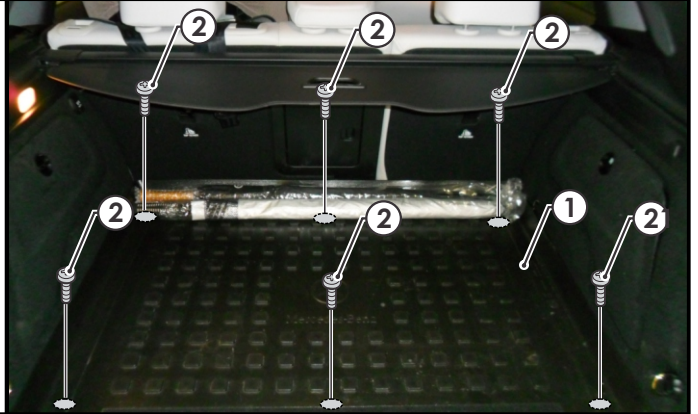

3. Dislodge both the LHS & RHS luggage compartment trims (1) by removing the four fasteners (2), the two cargo hooks (3) and the two access panels (4).

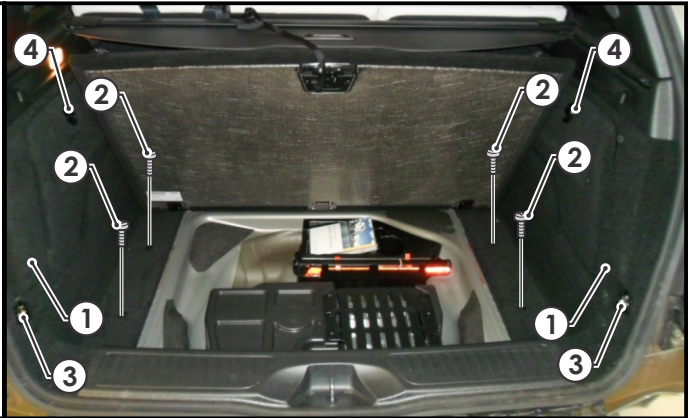

4. Following the table below, connect the ezy-taps (1) to the corresponding vehicle wires (2), then connect the trailer patch terminals (3) to the ezy-taps (1).

Function	Trailer Patch	Vehicle Connector
L.IND	YELLOW / BLACK	BLACK / YELLOW
REV	BLACK / WHITE	GREY / YELLOW

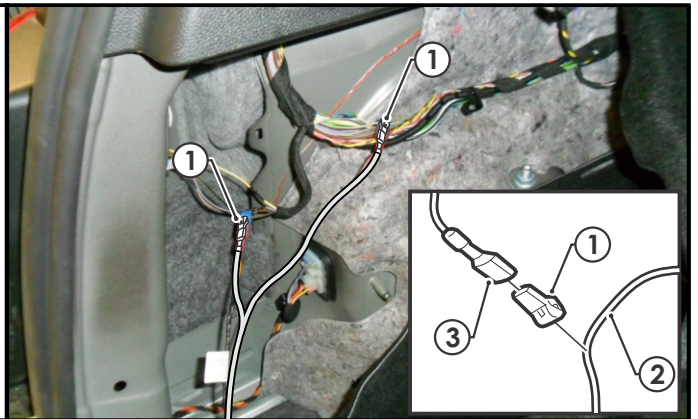

Issue Date 04/12/12

Page 2

Part No: 100869-WL

Hayman Reese (Cequent)
 PO Box 4050, Dandenong South VIC 3164
 Phone 1800 812 017 Email info@haymanreese.com.au



HAYMAN REESE
PART No: 100869-WL
MERCEDES B-CLASS

INSTALLATION INSTRUCTIONS

PLEASE ENSURE THAT INSTRUCTIONS ARE UNDERSTOOD PRIOR TO FITMENT

5. Route the trailer harness (1) (100869-WL) along the rear luggage compartment towards the RHS.



6. On the RHS rear quarter panel, connect the trailer patch ground ring terminal (1) to the vehicle grounding point (2).
7. Following the table below, connect the ezy-tap (3) 'ORANGE' power wire to the vehicle 'YELLOW / RED' +12V wire (4), then connect the trailer patch terminal (5) to the ezy-tap (3).

Function	Trailer Patch	Vehicle Connector
+12V	ORANGE	YELLOW / RED

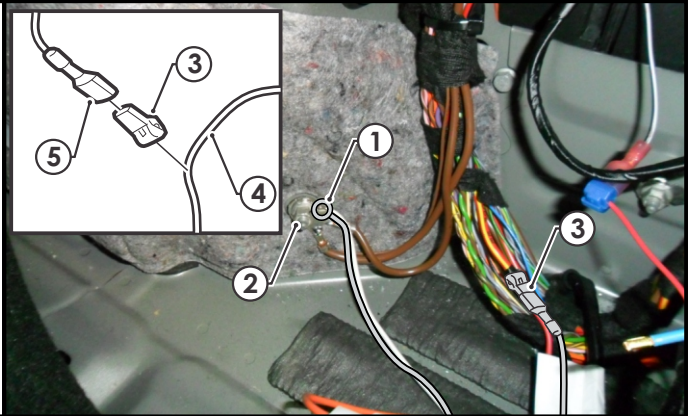

8. On the RHS rear quarter of the vehicle, drill a Ø30mm hole (1).
9. File any rough or sharp edges and spray on rust inhibitor.



Issue Date 04/12/12

Page 3

Part No: 100869-WL

Hayman Reese (Cequent)
 PO Box 4050, Dandenong South VIC 3164
 Phone 1800 812 017 Email info@haymanreese.com.au



HAYMAN REESE
PART No: 100869-WL
MERCEDES B-CLASS

INSTALLATION INSTRUCTIONS

PLEASE ENSURE THAT INSTRUCTIONS ARE UNDERSTOOD PRIOR TO FITMENT

10. In the RHS of luggage compartment, following the table below, connect the ezy-taps (1) to the corresponding vehicle wires (2), then connect the trailer patch terminals (3) to the ezy-taps (1).

Function	Trailer Patch	Vehicle Connector
R.IND	GREEN / BLACK	GREEN / BLACK
BRAKES	RED / BLACK	GREY / RED
TAIL	BROWN / BLACK	GREY / ORANGE

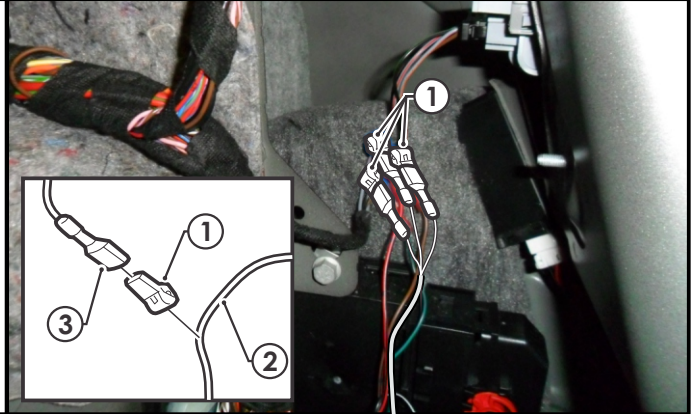

11. Apply double sided tape to the ECU (04831) (1) and adhere it to the vehicle sheet metal (2) on the RHS of the luggage compartment.
 12. Connect the trailer patch 12-way connector (3) to the ECU (1).

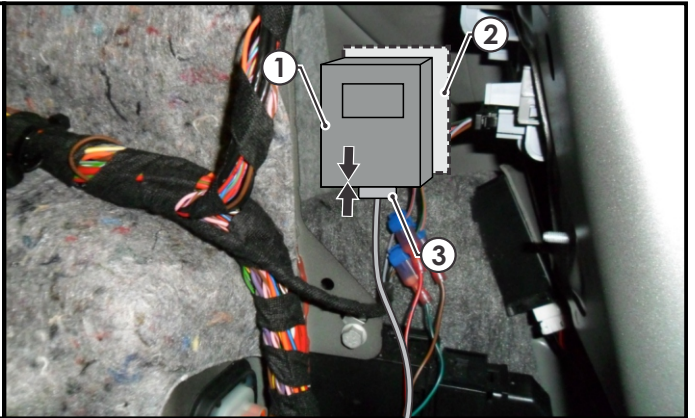

13. Mount the trailer socket (1) to the tow bar mounting bracket using M4 fasteners (not supplied).
 14. Route the tail harness (2) across the tow bar towards the RHS of the vehicle and up through the previously drilled out hole.
 15. Ensure the tail harness grommet is seated correctly and secure in place using a cable tie (not supplied).



Issue Date 04/12/12

Page 4

Part No: 100869-WL

Hayman Reese (Cequent)
 PO Box 4050, Dandenong South VIC 3164
 Phone 1800 812 017 Email info@haymanreese.com.au



HAYMAN REESE
PART No: 100869-WL
MERCEDES B-CLASS

INSTALLATION INSTRUCTIONS

PLEASE ENSURE THAT INSTRUCTIONS ARE UNDERSTOOD PRIOR TO FITMENT

16. Connect the tail harness (tail length 1200mm) 8-way connector (1) to the trailer patch mating 8-way connector (2).

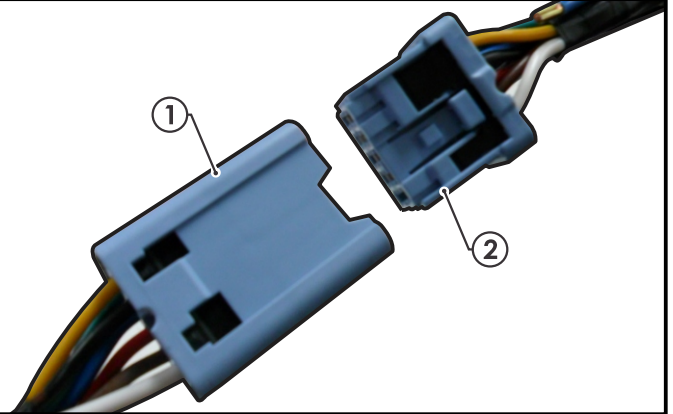

17. Test the trailer patch function using a light board or multi meter.
18. Secure all harnesses using cable ties (not supplied).
19. Re-fit all removed parts and secure all fasteners, ensuring there are no squeaks or rattles.
20. Place the fitting instructions in the glove box after fitment.

Issue Date 04/12/12

Page 5

Part No: 100869-WL

Hayman Reese (Cequent)
PO Box 4050, Dandenong South VIC 3164
Phone 1800 812 017 Email info@haymanreese.com.au

www.haymanreese.com.au

