

HAYMAN REESE
PART No: 03037RW
HOLDEN VF COMMODORE SEDAN 2013 ON

INSTALLATION INSTRUCTIONS

PLEASE ENSURE THAT ALL INSTRUCTIONS ARE UNDERSTOOD PRIOR TO FITMENT
PLACE THESE INSTRUCTIONS IN THE VEHICLE'S GLOVEBOX AFTER INSTALLATION IS COMPLETED



Installation Time: Approx **60** Mins

Towbar Installation Instructions

Towbar capacity

HOLDEN VF COMMODORE SEDAN 2013 ON

Part Number 03037RW

Max Towing Braked 2100 kg

Max Towing Unbraked 210 kg

Hayman Reese (Cequent)
PO Box 4050, Dandenong South VIC 3164
Phone 1800 812 017 Email info@haymanreese.com.au

HAYMAN REESE

PART No: 03037RW

HOLDEN VF COMMODORE SEDAN 2013 ON

INSTALLATION INSTRUCTIONS

PLEASE ENSURE THAT ALL INSTRUCTIONS ARE UNDERSTOOD PRIOR TO FITMENT
PLACE THESE INSTRUCTIONS IN THE VEHICLE'S GLOVEBOX AFTER INSTALLATION IS COMPLETED

Warning:

1. Do not, drill, cut, weld or otherwise modify the towbar.
2. If you are using electric welding on a motor vehicle, **always** check that the vehicle is not equipped with electronic engine or instrument management equipment. Failure to do so could **destroy** any onboard computers. If in doubt, check with the vehicle's manufacturer.

General:

1. Ensure all hardware items have been included refer to assembly diagram.
2. It is recommended that the instructions are read through and completely understood before making any attempt to fit this product.
3. Be wary of any changes to vehicle designs or other accessories that may conflict with the installation of this product.
4. Before drilling ensure that the area is clear of fuel, electrical & other components.
5. All holes drilled into the body panels shall have all burrs & swarf removed then coated with a suitable rust preventative paint.
6. The high tensile fasteners supplied with this product were used to achieve the specified rating. If replacement is required ensure that fasteners of the same rating & quality are used. Contact an authorised **Hayman Reese** dealer if further information is required.
7. Ensure that all hardware is fastened to torque list below check fasteners on regular basis.
8. Towbar load rating sticker provided with this product shall be conspicuously located on inside rear end of the driver's door. **(See diagram below)**.
9. Hayman Reese recommends that you check your tow ball to ensure that it complies with the Australian standards **AS 4177.2**.
10. **PLEASE NOTE:** It is advised to remove your lug or tbn when not actually towing so as to produce a clear view of the vehicles registration plate if obscured, and to also provide maximum available departure angle.
11. Pull Pin must be fit in down position.

Tow bar Maintenance and Care.

Hayman Reese recommends that bolt torque's, as listed below, are routinely and regularly inspected and checked for correct tension. Replace any worn or defective parts.

We recommended to remove Tow Ball Mounts (TBM's, tongues or lugs) when not being used for any considerable length of time.

So as to avoid injury, when not towing it is suggested that the tongue, Pull Pin and R-clip are removed then stored in a safe, clean and dry place, away from excessive moisture.

Hitch Pull Pins and spring "R" clips are regularly checked for proper installation. Replace any worn or defective parts.

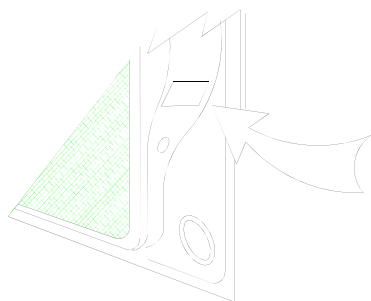

Place load rating sticker
inside driver's door here

RECOMMENDED ASSEMBLY TORQUE LISTING

Diameter Grade 8.8 Bolt

M6	9.5 Nm
M8	21.7 Nm
M10	43.4 Nm
M12	77.3 Nm
M14	146 Nm
M16	189.8 Nm

FOR TOWING PURPOSES ONLY

For towing capacity details please refer to vehicle owner's manual or to the manufacturer. Overloading can void your warranties.

HAYMAN REESE

PART No: 03037RW

HOLDEN VF COMMODORE SEDAN 2013 ON

INSTALLATION INSTRUCTIONS

PLEASE ENSURE THAT ALL INSTRUCTIONS ARE UNDERSTOOD PRIOR TO FITMENT
PLACE THESE INSTRUCTIONS IN THE VEHICLES'S GLOVEBOX AFTER INSTALLATION IS COMPLETED

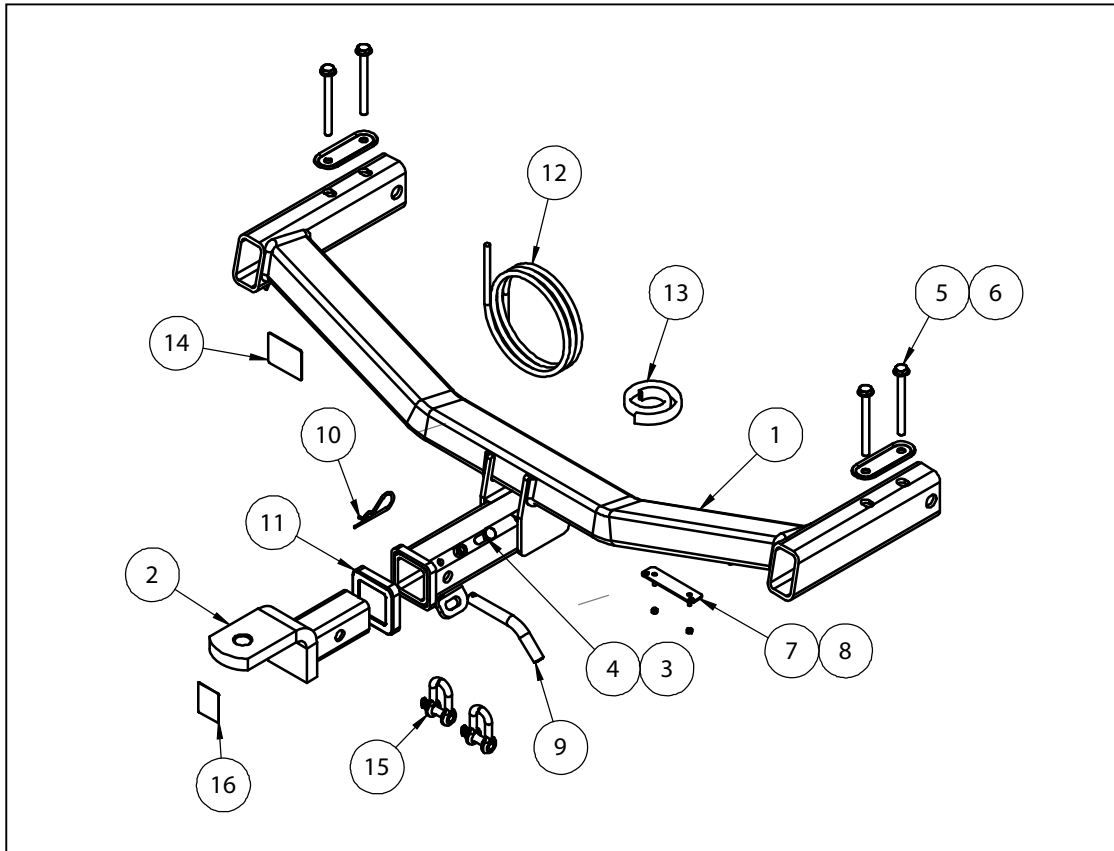

QTY	DESCRIPTION	ITEM NO
1	WELDED ASSEMBLY	1
2	TBM ASSEMBLY	2
1	HEX NUT M10X1.5	3
1	SET SCREW HEX HD M10X30X1.5P	4
4	BOLT SP. M10X105X1.5P (11589345)	5
2	FORMED BOOT PLATE	6
1	PLUG BRACKET	7
2	NUT NYLOC M4-0.7 Z/P	8
1	PULL PIN	9
1	SPRING COTTER PIN ASSY	10
1	HITCH BOX COLLAR COVER	11
1	WIRING LOOM	12
1	ACRYLIC COMPLIANCE PLATE	13
1	BUMPER TRIM PINCH WELD 580mm	14
2	D' SHACKLE	15
1	H.R STICKER	16

INSTALLATION INSTRUCTIONS

PLEASE ENSURE THAT ALL INSTRUCTIONS ARE UNDERSTOOD PRIOR TO FITMENT

PLACE THESE INSTRUCTIONS IN THE VEHICLES'S GLOVEBOX AFTER INSTALLATION IS COMPLETED

1. In the Passenger side Wheel Well, remove 5x Screws connecting the Rear Bumper to the wheel Well Cover.

Repeat for passenger side

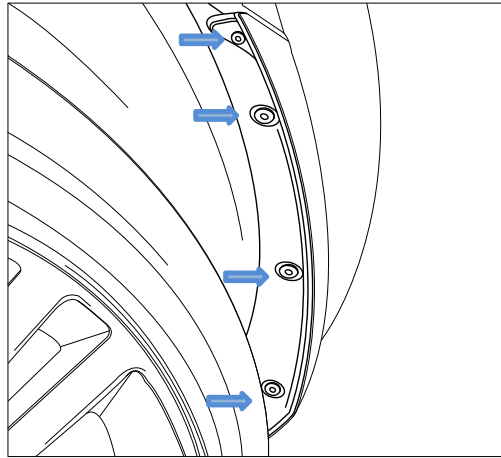

2. Remove 3x Scrivets from underneath the Bumper tab, securing the Bumper to the Wheel Well.

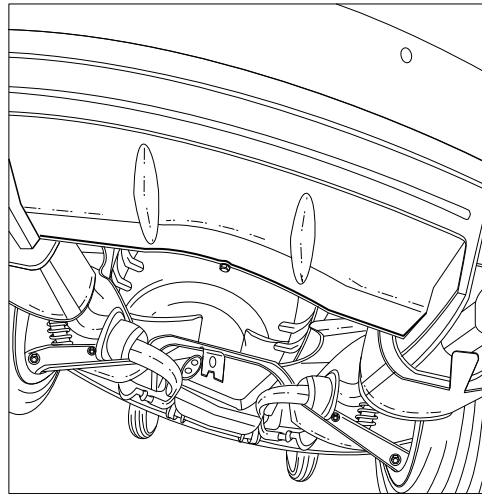

3. Ensure that sensor cables are unplugged, and then carefully peel away Bumper and place to the side in a safe area.

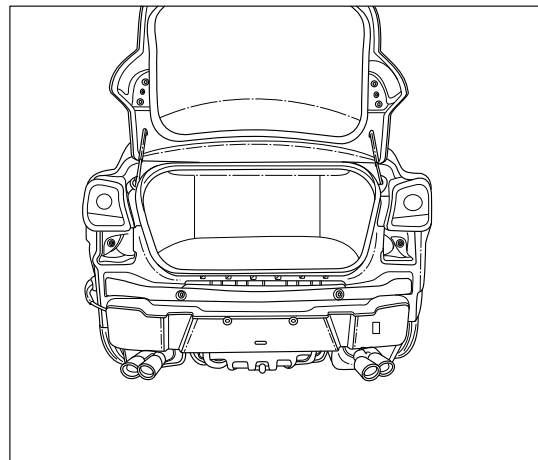

HAYMAN REESE

PART No: 03037RW

HOLDEN VF COMMODORE SEDAN 2013 ON

INSTALLATION INSTRUCTIONS

PLEASE ENSURE THAT ALL INSTRUCTIONS ARE UNDERSTOOD PRIOR TO FITMENT
PLACE THESE INSTRUCTIONS IN THE VEHICLES'S GLOVEBOX AFTER INSTALLATION IS COMPLETED

4. Remove polystyrene insert from rear of vehicle and dispose.

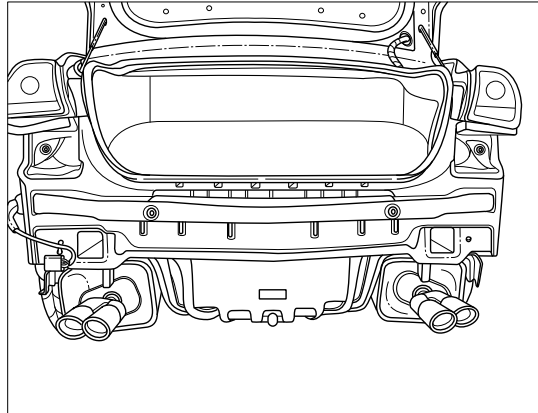

5. From inside the Boot, remove 4x screws (2 per side) that secure the rear inside plastic trim to the inside rear Chassis.

Remove the trim by lifting upwards and place to the side.

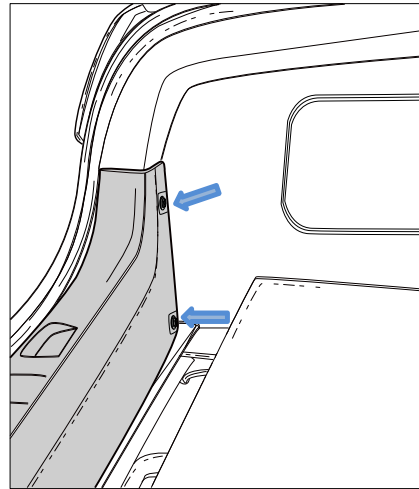

6. Lift spare tire cover to gain access underneath.
Remove the silver tape covering the 2 Bolt holes. Repeat for opposite side of vehicle.

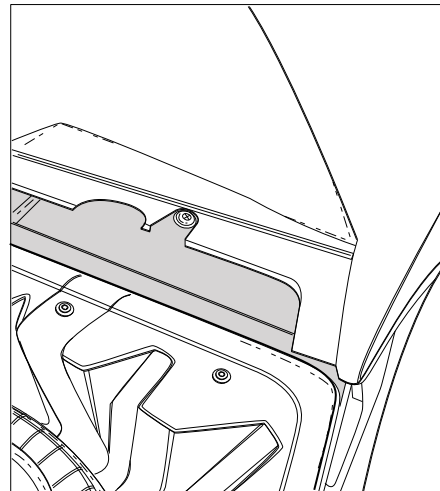

HAYMAN REESE

PART No: 03037RW

HOLDEN VF COMMODORE SEDAN 2013 ON

INSTALLATION INSTRUCTIONS

PLEASE ENSURE THAT ALL INSTRUCTIONS ARE UNDERSTOOD PRIOR TO FITMENT
PLACE THESE INSTRUCTIONS IN THE VEHICLES'S GLOVEBOX AFTER INSTALLATION IS COMPLETED

7. Offer Towbar to vehicle, inserting the Towbar side arms into the existing Chassis Rail holes.

Force may be required to slide inside Chassis Rail.

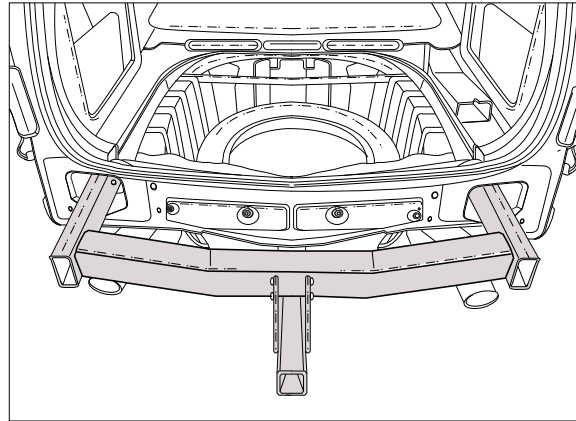

8. Fit loose Plates and Bolts inside cavity in newly exposed bolt holes.

Repeat for opposite side of vehicle.

Tighten all bolts to torques specified on page 2.

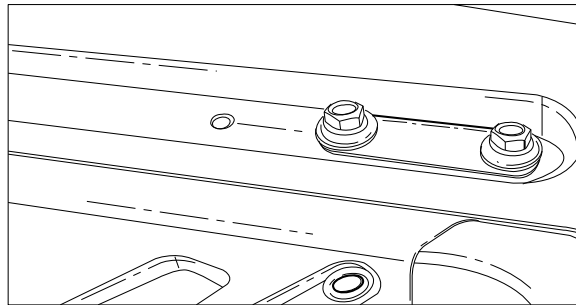

9. Cut rear bumper skin by following the Holden original factory bumper indent.

Use a small pilot drill to pierce the skin to allow a small saw or similar device to cut.

Clean any raw edges with a file

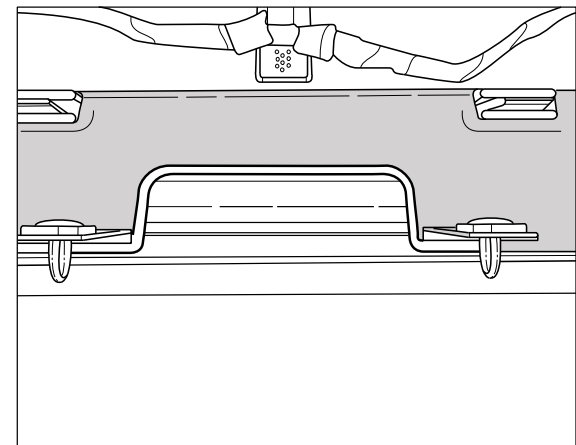

HAYMAN REESE

PART No: 03037RW

HOLDEN VF COMMODORE SEDAN 2013 ON

INSTALLATION INSTRUCTIONS

PLEASE ENSURE THAT ALL INSTRUCTIONS ARE UNDERSTOOD PRIOR TO FITMENT

PLACE THESE INSTRUCTIONS IN THE VEHICLE'S GLOVEBOX AFTER INSTALLATION IS COMPLETED

10. Install plug bracket to bumper skin, drilling 2x 5mm holes at 69mm apart.

Locate plug bracket position at a location close to the towbar centre.

Feed bracket threads through drilled holes to the outside face of bumper skin

Refit the bumper following steps 1 to 6 in reverse

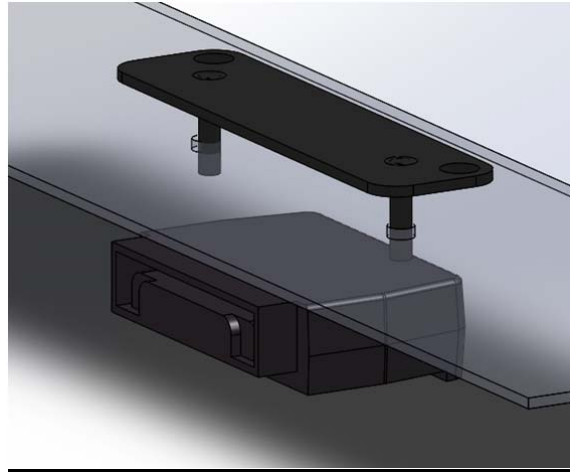

HAYMAN REESE
PART No: 100971-WL
HOLDEN COMMODORE VF - Sedan / Wagon

INSTALLATION INSTRUCTIONS

PLEASE ENSURE THAT INSTRUCTIONS ARE UNDERSTOOD PRIOR TO FITMENT

Wiring Loom Installation Instructions

HOLDEN COMMODORE VF
SEDAN / WAGON

Part No: 100971-WL

Tail Harness Length Required: 1200mm

ECU Required: 04839

Wiring Loom Installation Time: Approx. 20 minutes

Issue Date 10-12-14

Page 1

Part No: 100971-WL

Hayman Reese (Cequent)
PO Box 4050, Dandenong South VIC 3164
Phone 1800 812 017 Email info@haymanreese.com.au

www.haymanreese.com.au



HAYMAN REESE
PART No: 100971-WL
HOLDEN COMMODORE VF - Sedan / Wagon
INSTALLATION INSTRUCTIONS

PLEASE ENSURE THAT INSTRUCTIONS ARE UNDERSTOOD PRIOR TO FITMENT

For VF Wagon models, go to Page 5, for VF sedan models continue below.

1. Remove the four screws (two on each side) (1) and then remove the rear trim (2).
2. Remove the luggage compartment floor carpet (3).

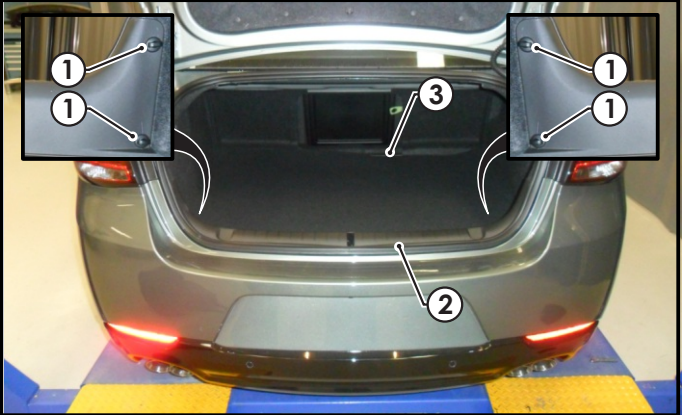

3. Remove the three fasteners (1) and dislodge the LHS trim (2).

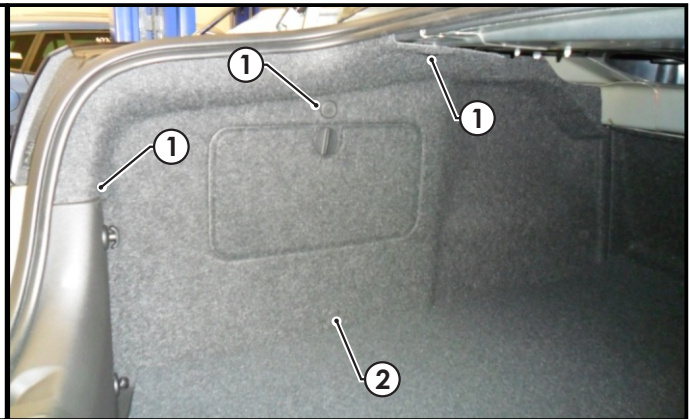

4. Drill a 30mm hole (1) in the spare wheel plastic tub lining LHS rear area.

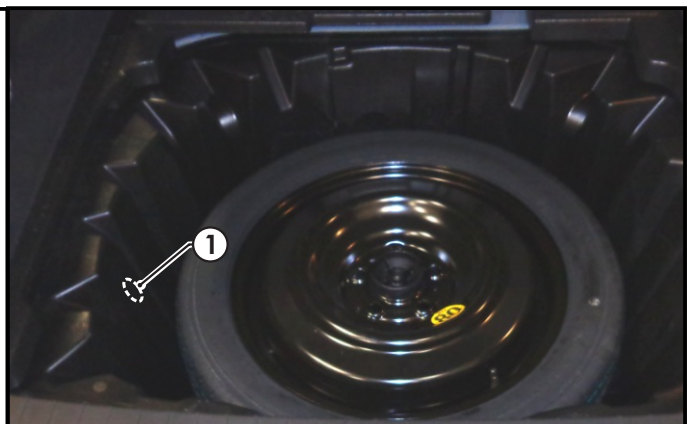

Issue Date 10-12-14

Page 2

Part No: 100971-WL

Hayman Reese (Cequent)
PO Box 4050, Dandenong South VIC 3164
Phone 1800 812 017 Email info@haymanreese.com.au

www.haymanreese.com.au



HAYMAN REESE
PART No: 100971-WL
HOLDEN COMMODORE VF - Sedan / Wagon
INSTALLATION INSTRUCTIONS

PLEASE ENSURE THAT INSTRUCTIONS ARE UNDERSTOOD PRIOR TO FITMENT

5. In the LHS luggage compartment rear quarter area, locate and connect the (grey) 6-way break-out connector (1) to the trailer patch (P/No: 100971-WL) mating connector (2).
6. Connect the trailer patch ECU connector (3) to the ECU (4) and then mount ECU to the rear quarter panel using double sided adhesive tape **ensuring the connector end is pointing down**.
7. Route the trailer patch harness towards the spare wheel well.

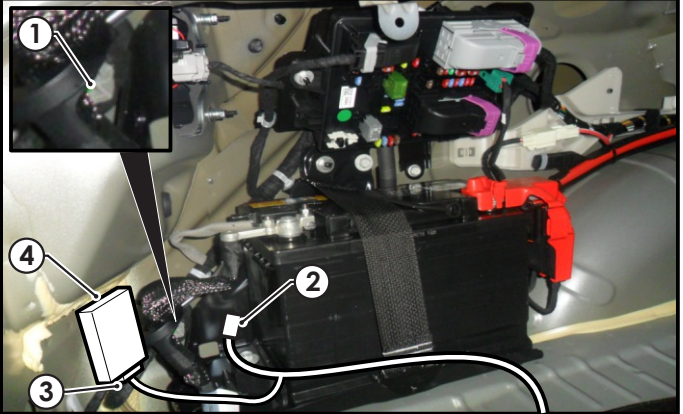

8. Route the tail harness (tail length 1200mm) (1) up through the drilled out 30mm hole and into the vehicle, ensuring the grommet is seated correctly.
9. Secure the trailer patch harness socket head to the towbar mounting plate using the supplied M4 fasteners.



10. In the luggage compartment spare wheel well, connect the trailer harness 8-way connector (1) to the trailer patch mating connector (2).

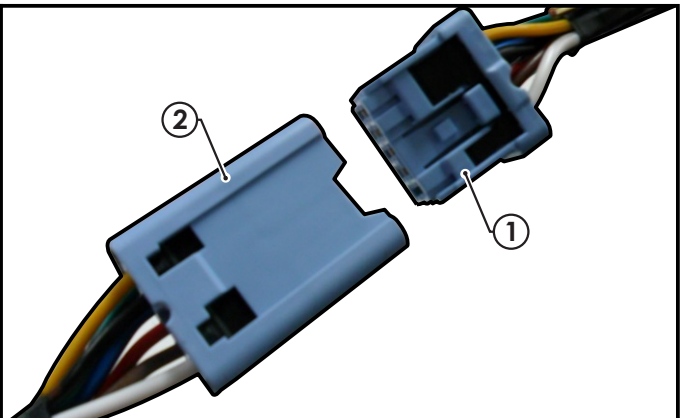

Issue Date 10-12-14

Page 3

Part No: 100971-WL

Hayman Reese (Cequent)
PO Box 4050, Dandenong South VIC 3164
Phone 1800 812 017 Email info@haymanreese.com.au

www.haymanreese.com.au



HAYMAN REESE
PART No: 100971-WL
HOLDEN COMMODORE VF - Sedan / Wagon

INSTALLATION INSTRUCTIONS

PLEASE ENSURE THAT INSTRUCTIONS ARE UNDERSTOOD PRIOR TO FITMENT

11. Test the trailer wiring harness function using a light board or multimeter.
12. Secure all harnessses using cable ties (not supplied).
13. Re-fit all removed parts and secure all fasteners, ensuring there are no squeaks or rattles.
14. Place the fitting instructions in the glove box after fitment.

Issue Date 10-12-14

Page 4

Part No: 100971-WL

Hayman Reese (Cequent)
PO Box 4050, Dandenong South VIC 3164
Phone 1800 812 017 Email info@haymanreese.com.au

www.haymanreese.com.au



HAYMAN REESE
PART No: 100971-WL
HOLDEN COMMODORE VF - Sedan / Wagon
INSTALLATION INSTRUCTIONS

PLEASE ENSURE THAT INSTRUCTIONS ARE UNDERSTOOD PRIOR TO FITMENT

For VF Sedan models, go to Page 2, for VF Wagon models continue below.

1. At the rear of the vehicle, remove the luggage compartment floor cover (1).
2. Remove the screws and tow hooks (2).
3. Remove the LHS access panel (3).

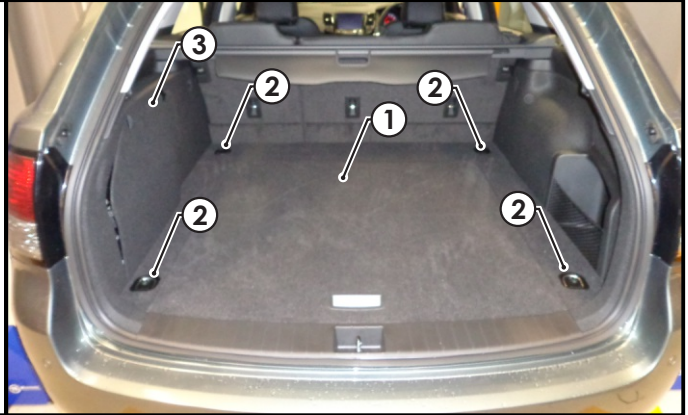

4. Drill a 30mm hole (1) in the spare wheel plastic tub lining LHS rear area.

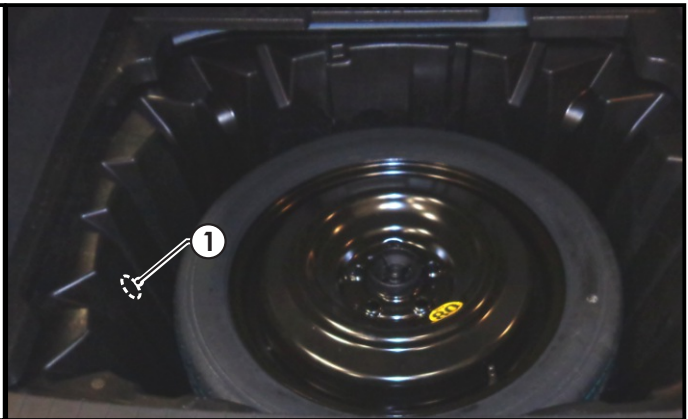

5. In the LHS luggage compartment rear quarter area, locate and connect the (grey) 6-way break-out connector (1) to the trailer patch (P/No: 100971-WL) mating connector (2).
6. Connect the trailer patch ECU connector (3) to the ECU (4) and then mount ECU to the rear quarter sheet metal panel using double sided adhesive tape ensuring the connector end if pointing down.
7. Route the trailer patch harness towards the spare wheel well.

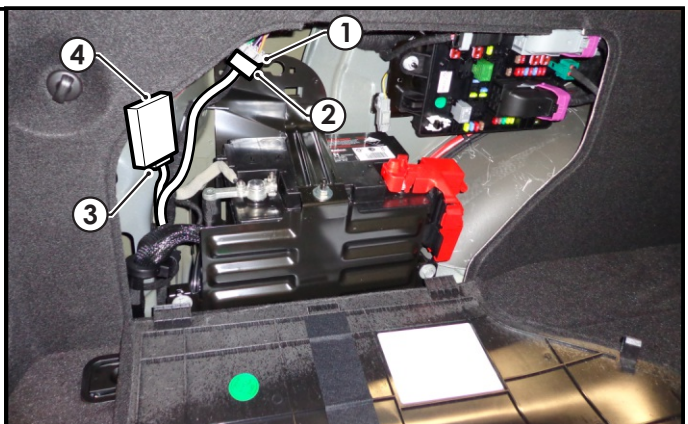

Issue Date 10-12-14

Page 5

Part No: 100971-WL

Hayman Reese (Cequent)
PO Box 4050, Dandenong South VIC 3164
Phone 1800 812 017 Email info@haymanreese.com.au

www.haymanreese.com.au



HAYMAN REESE
PART No: 100971-WL
HOLDEN COMMODORE VF - Sedan / Wagon
INSTALLATION INSTRUCTIONS

PLEASE ENSURE THAT INSTRUCTIONS ARE UNDERSTOOD PRIOR TO FITMENT

8. Route the tail harness (tail length 1200mm) (1) up through the drilled out 30mm hole and into the vehicle, ensuring the grommet is seated correctly.
9. Secure the trailer patch harness socket head to the towbar mounting plate using the supplied M4 fasteners.



10. In the luggage compartment spare wheel well, connect the trailer harness 8-way connector (1) to the trailer patch mating connector (2).

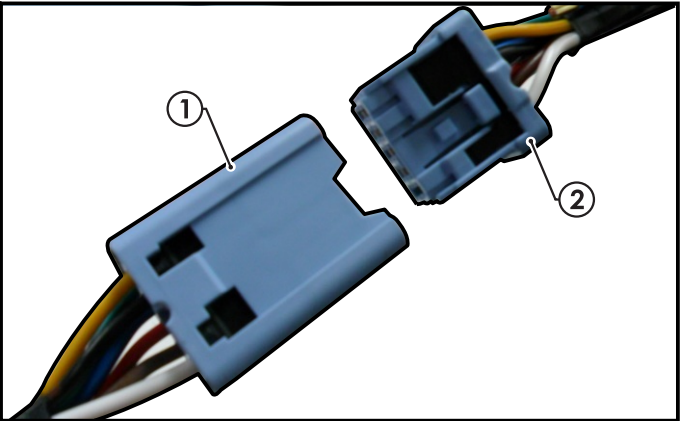

11. Test the trailer wiring harness function using a light board or multimeter.
12. Secure all harnessses using cable ties (not supplied).
13. Re-fit all removed parts and secure all fasteners, ensuring there are no squeaks or rattles.
14. Place the fitting instructions in the glove box after fitment.

Issue Date 10-12-14

Page 6

Part No: 100971-WL

Hayman Reese (Cequent)
PO Box 4050, Dandenong South VIC 3164
Phone 1800 812 017 Email info@haymanreese.com.au

www.haymanreese.com.au





FITTING INSTRUCTIONS

Smart Pin (55070BL)

• These fitting instructions are supplied to ensure understanding of how the SMART PIN should be fitted and used correctly.

• Once installed, we recommend **ALL** instructions are kept and placed in the vehicle glove box.

NOTE: Routine maintenance and inspection of the towbar & SMART PIN is required. Regularly inspect for wear and check the tightness of the SMART PIN NUT. Follow instructions below to retighten the nut when necessary.

***Do not tow with your vehicle if the R CLIP or the SMART PIN NUT is loose or missing. Replacement parts are available from your Hayman Reese Distributor.**

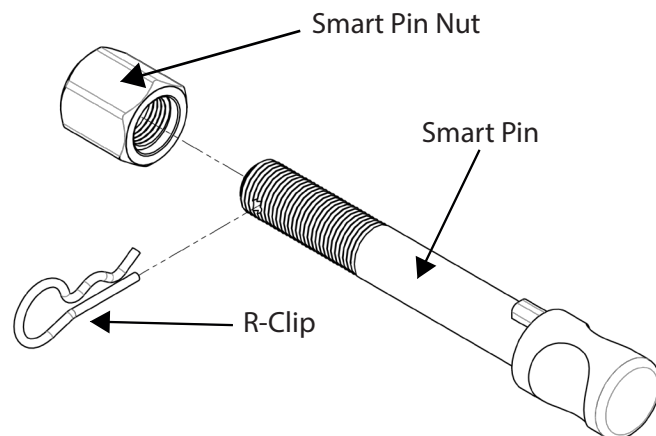
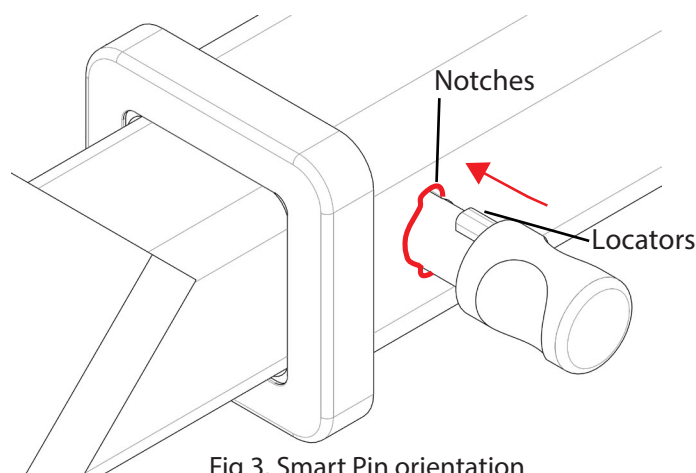
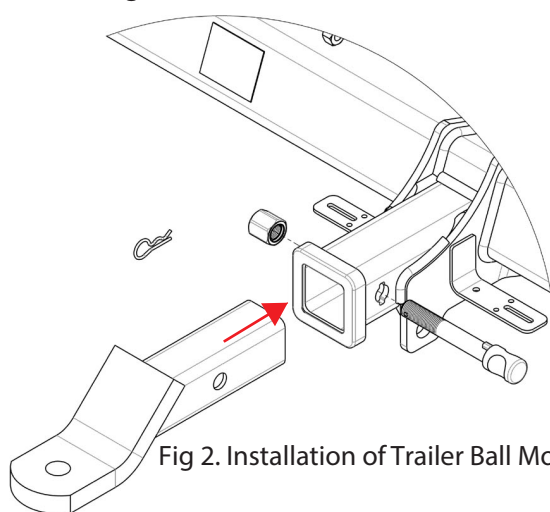

Fig 1. Smart Pin assembly

STEP 1 Insert Trailer Ball Mount (TBM) into towbar HITCHBOX, aligning hole in TBM SHANK with hole in HITCHBOX (Fig. 2).



STEP 2 Insert SMART PIN through hole in HITCHBOX and hole in TBM SHANK; ensure the LOCATORS are inserted into the NOTCHES in the HITCHBOX (Fig. 3).

STEP 3 Screw SMART PIN NUT onto SMART PIN; tighten SMART PIN NUT until finger tight, ensuring TBM is restrained from movement.

STEP 4 Tighten SMART PIN NUT by turning nut a further 1/8th of a turn in the clockwise direction using a 24mm spanner (Fig 4).

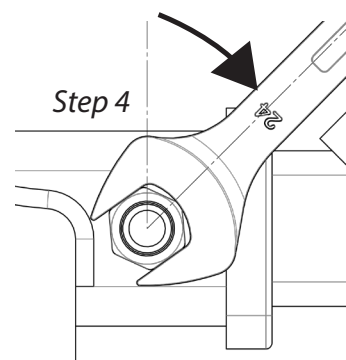

STEP 5 Install SMART PIN R CLIP through the hole on the SMART PIN (Fig. 1).

