

HAYMAN REESE
PART No: 03047RLW
PEUGEOT 3008 2013 - ON

INSTALLATION INSTRUCTIONS

PLEASE ENSURE THAT ALL INSTRUCTIONS ARE UNDERSTOOD PRIOR TO FITMENT
PLACE THESE INSTRUCTIONS IN THE VEHICLE'S GLOVEBOX AFTER INSTALLATION IS COMPLETED



Installation Time: Approx 60 Mins

Towbar Installation Instructions

Towbar capacity

PEUGEOT 3008 2103 - ON

Part Number 03047RLW

Max Towing Braked 1500 kg

Max Towing Unbraked 750 kg

Max Static Ball Load 75 kg

Hayman Reese (Cequent)
PO Box 4050, Dandenong South VIC 3164
Phone 1800 812 017 Email info@haymanreese.com.au

INSTALLATION INSTRUCTIONS

PLEASE ENSURE THAT ALL INSTRUCTIONS ARE UNDERSTOOD PRIOR TO FITMENT
PLACE THESE INSTRUCTIONS IN THE VEHICLES'S GLOVEBOX AFTER INSTRALLATION IS COMPLETED

Warning:

1. Do not, drill, cut, weld or otherwise modify the towbar.
2. If you are using electric welding on a motor vehicle, **always** check that the vehicle is not equipped with electronic engine or instrument management equipment. Failure to do so could **destroy** any onboard computers. If in doubt, check with the vehicle's manufacturer.
3. If TBM is used in inverted position tow ball may make contact with rear tailgate when lowered, which could cause damage.

General:

1. Ensure all hardware items have been included refer to assembly diagram.
2. It is recommended that the instructions are read through and completely understood before making any attempt to fit this product.
3. Be wary of any changes to vehicle designs or other accessories that may conflict with the installation of this product.
4. Before drilling ensure that the area is clear of fuel, electrical & other components.
5. All holes drilled into the body panels shall have all burrs & swarf removed then coated with a suitable rust preventative paint.
6. The high tensile fasteners supplied with this product were used to achieve the specified rating. If replacement is required ensure that fasteners of the same rating & quality are used. Contact an authorised **Hayman Reese** dealer if further information is required.
7. Ensure that all hardware is fastened to torque list below check fasteners on regular basis.
8. Towbar load rating sticker provided with this product shall be conspicuously located on inside rear end of the driver's door. **(See diagram below)**.
9. Hayman Reese recommends that you check your tow ball to ensure that it complies with the Australian standards **AS 4177.2**.
10. **PLEASE NOTE:** It is advised to remove your LUG or TBM when not actually towing so as to produce a clear view of the vehicles registration plate if obscured, and to also provide maximum available departure angle.
11. Pull Pin must be fit in down position.

Tow bar Maintenance and Care.

Hayman Reese recommends that bolt torque's, as listed below, are routinely and regularly inspected and checked for correct tension. Replace any worn or defective parts.

We recommended to remove Tow Ball Mounts (TBM's, tongues or lugs) when not being used for any considerable length of time.

So as to avoid injury, when not towing it is suggested that the tongue, Pull Pin and R-clip are removed then stored in a safe, clean and dry place, away from excessive moisture.

Hitch Pull Pins and spring "R" clips are regularly checked for proper installation. Replace any worn or defective parts.

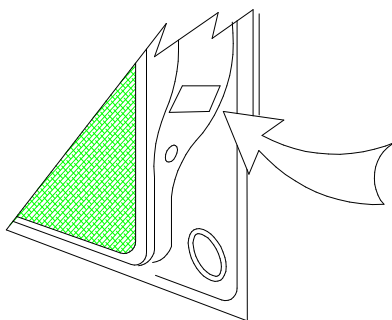

Place load rating sticker
inside driver's door here

RECOMMENDED ASSEMBLY TORQUE LISTING

Diameter Grade 8.8 Bolt

M6	9.5 Nm
M8	21.7 Nm
M10	43.4 Nm
M12	77.3 Nm
M14	146 Nm
M16	189.8 Nm

FOR TOWING PURPOSES ONLY

For towing capacity details please refer to vehicle owner's manual or to the manufacturer. Overloading can void your warranties.

HAYMAN REESE
PART No: 03047RLW
PEUGEOT 3008 2013 - ON

INSTALLATION INSTRUCTIONS

PLEASE ENSURE THAT ALL INSTRUCTIONS ARE UNDERSTOOD PRIOR TO FITMENT
 PLACE THESE INSTRUCTIONS IN THE VEHICLES'S GLOVEBOX AFTER INSRALLATION IS COMPLETED

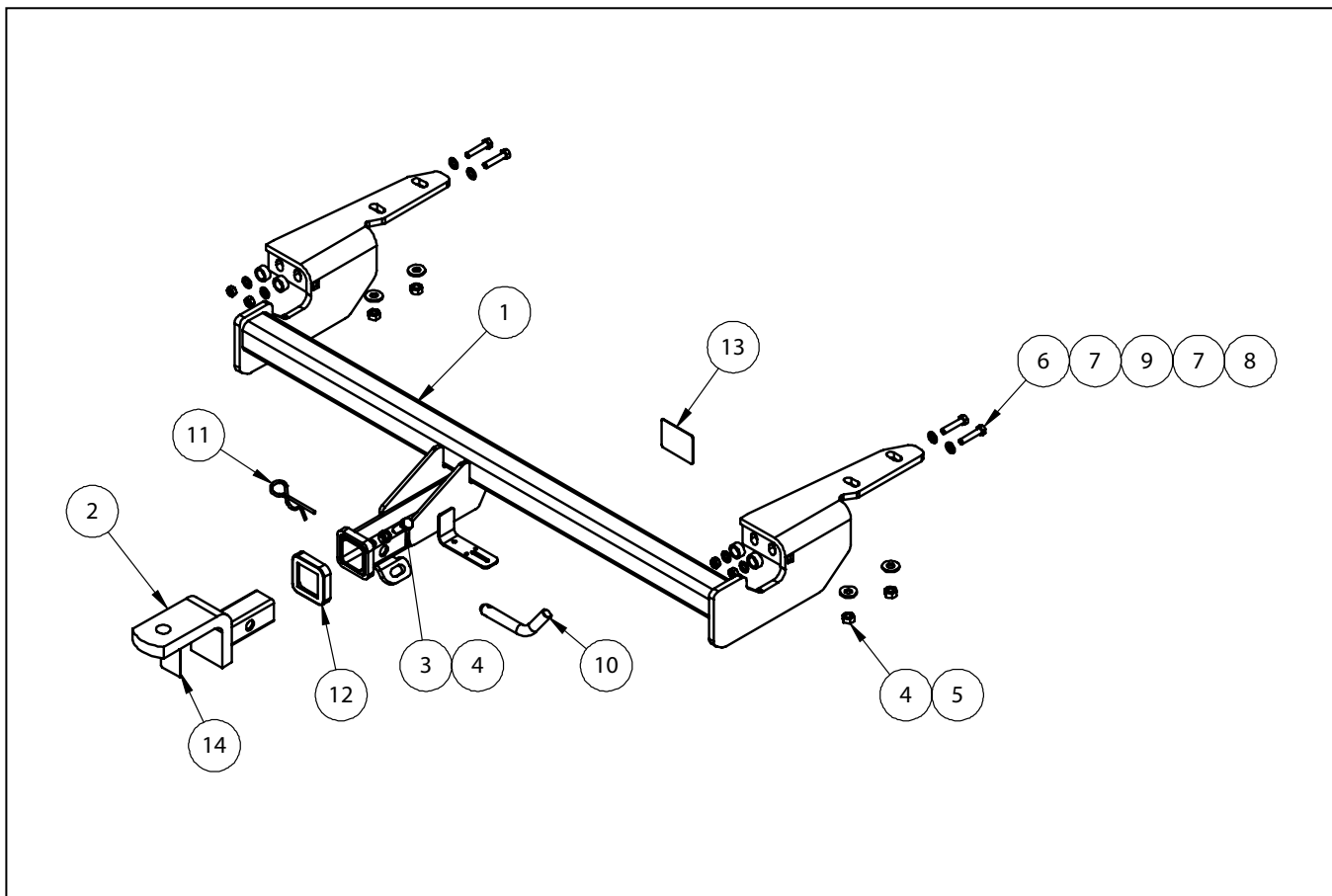

QTY.	DESCRIPTION	ITEM NO.
1	TOWBAR ASSEMBLY	1
1	TBM ASSEMBLY	2
1	SET SCREW M10x30x1.5P	3
5	HEX NUT M10x1.5	4
4	WSHR FT M10x25.4x3	5
4	M8x40 BOLT	6
8	M8 FLAT WASHER	7
4	M8x1.25P NUT	8
4	SPACER TUBE 21.3x3.2x10mm	9
1	PULL PIN	10
1	R CLIP	11
1	H/BOX C/COVER RL	12
1	ACRYLIC COMPLIANCE PLATE	13
1	H.R STICKER	14

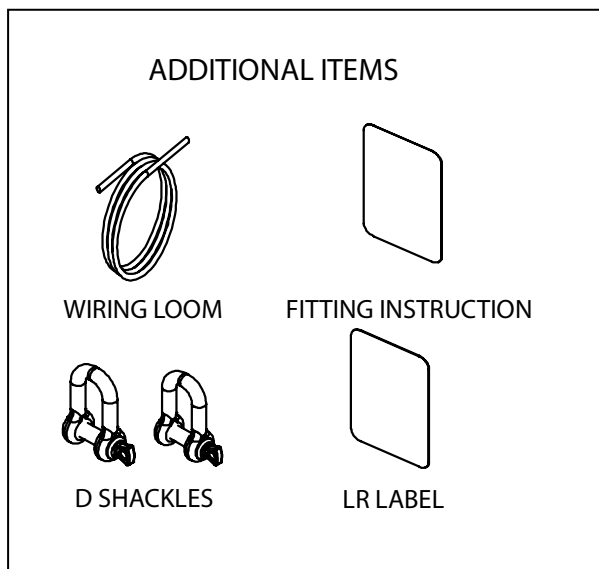

INSTALLATION INSTRUCTIONS

PLEASE ENSURE THAT ALL INSTRUCTIONS ARE UNDERSTOOD PRIOR TO FITMENT
PLACE THESE INSTRUCTIONS IN THE VEHICLES'S GLOVEBOX AFTER INSRALLATION IS COMPLETED

1. In Drivers side wheel well Remove 1x Torx Screw securing rear Bumper facia to wheel well trim

Repeat for Drivers side

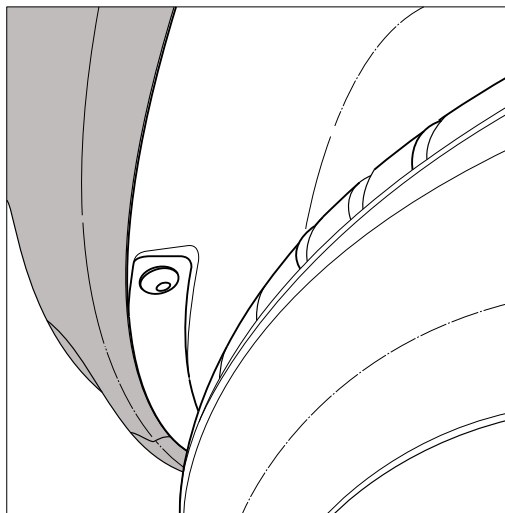

2. Move away Wheel well trim from Passenger side of vehicle.

Loosen newly exposed Set Screw securing Bumper facia to main vehicle

Repeat for opposite side of vehicle

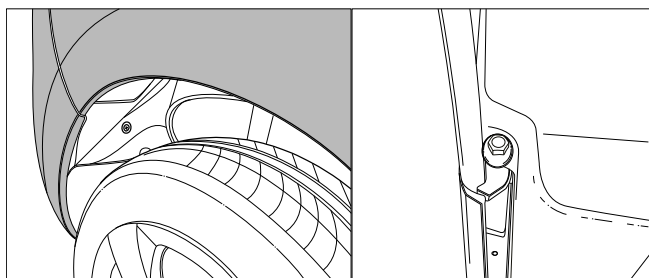

3. Remove small Plastic Plug located in tailgate cavity, repeat for Drivers side of vehicle

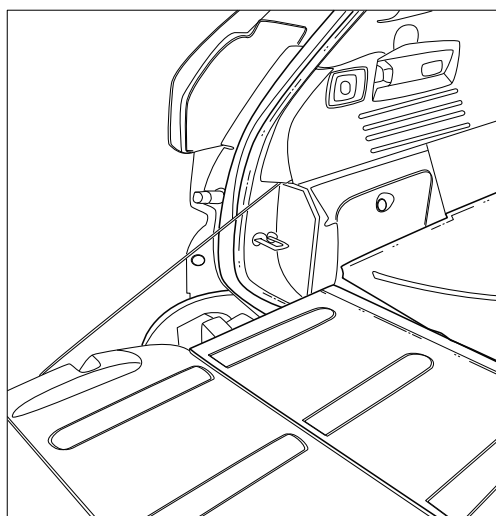

INSTALLATION INSTRUCTIONS

PLEASE ENSURE THAT ALL INSTRUCTIONS ARE UNDERSTOOD PRIOR TO FITMENT
PLACE THESE INSTRUCTIONS IN THE VEHICLES'S GLOVEBOX AFTER INSTRALLATION IS COMPLETED

4. Use a small tool to remove Tail light plastic cover from tail light assembly

Remove tail light by removing 2x Nuts from newly exposed section of tail light.

Disconnect tail light plug from light and store tail light in safe place to the side

Repeat for opposite side of vehicle

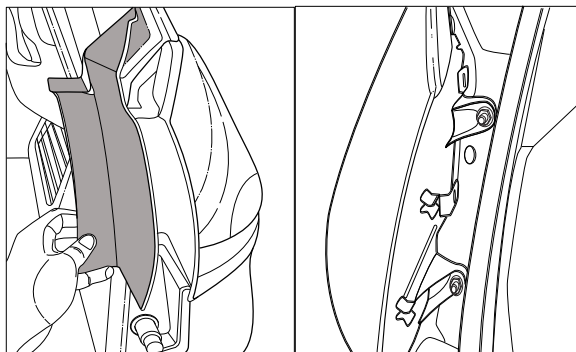

5. Remove 2x Hex fasteners securing lower Bumper trim to main Chassis

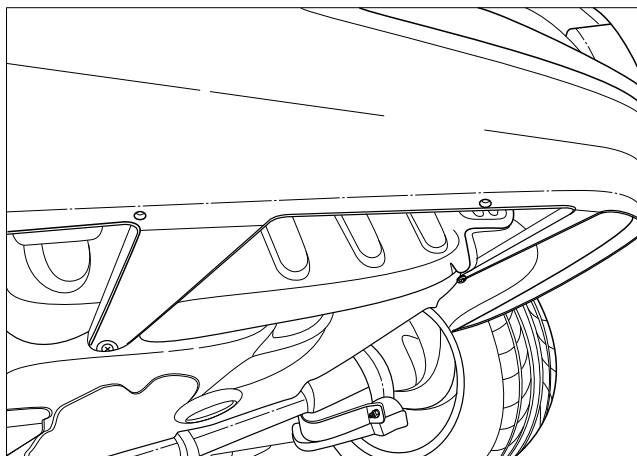

6. Remove 3x Scrivets securing Bumper trim to lower mudguard on Passenger side of vehicle.

Repeat for opposite side of vehicle

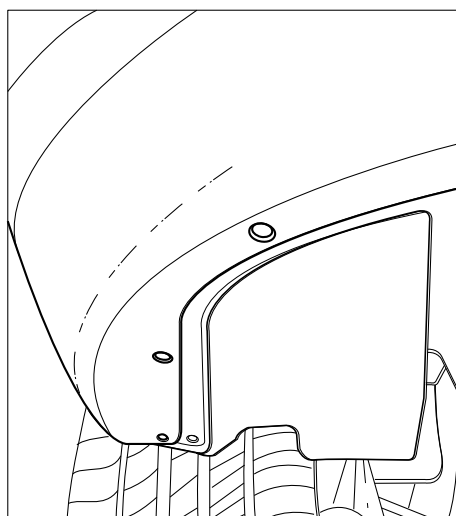

INSTALLATION INSTRUCTIONS

PLEASE ENSURE THAT ALL INSTRUCTIONS ARE UNDERSTOOD PRIOR TO FITMENT
PLACE THESE INSTRUCTIONS IN THE VEHICLE'S GLOVEBOX AFTER INSTALLATION IS COMPLETED

7. Peel away Bumper fascia from rear vehicle, disconnecting any rear parking sensor Plugs

Place Bumper to side in a safe place

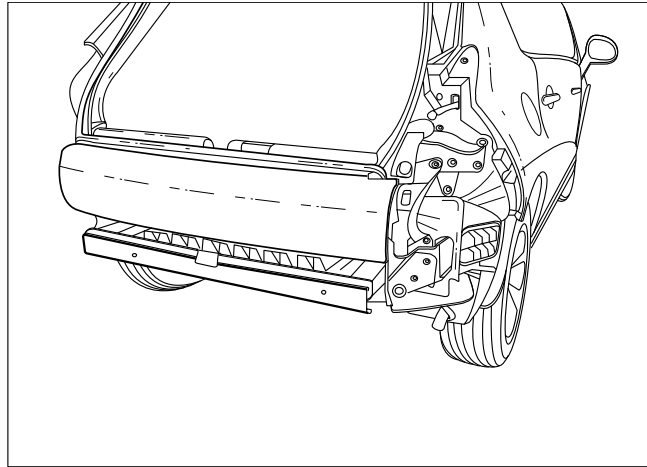

8. Remove Nuts securing rear towing hooks from vehicle, and remove and dispose of towing Hook Brackets

Offer Towbar to vehicle body by aligning rail mount bolts to Towbar slots

Secure Towbar to recommended torques outlined on page 2

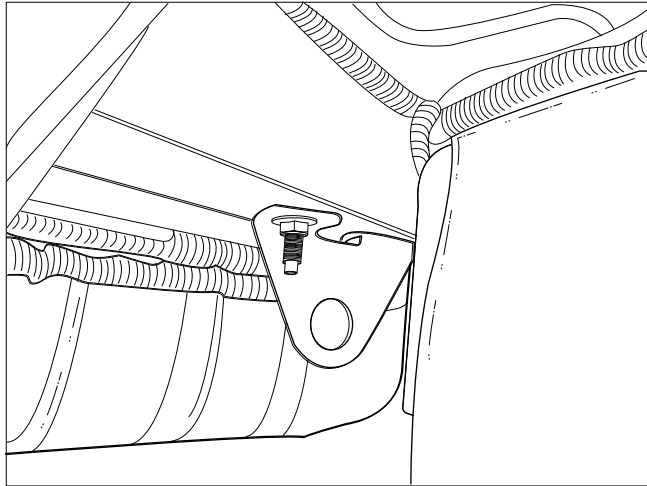

9. Starting from bottom of Bumper Trim, use a hacksaw or similar cutting item to cut Bumper trim to allow for fitment of the Towbar

Trim from the center of the Bumper a length 85mm long and 70mm wide

Reassemble Bumper trim following steps 1 to 7 in reverse

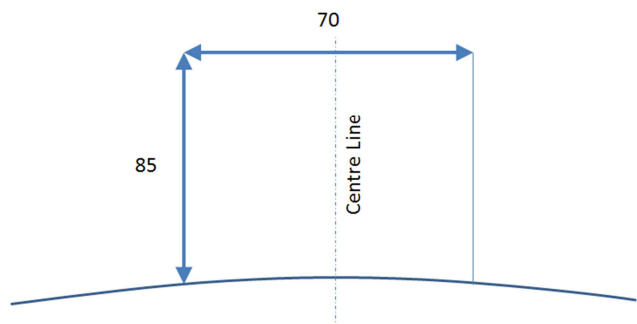

HAYMAN REESE
PART No: 100996-WL
PEUGEOT 3008

INSTALLATION INSTRUCTIONS

PLEASE ENSURE THAT INSTRUCTIONS ARE UNDERSTOOD PRIOR TO FITMENT

Wiring Loom Installation Instructions

PEUGEOT 3008

Part No: 100996-WL
ECU Required: 04826

Tail Harness Length Required: 1200mm

Wiring Loom Installation Time: Approx. 30 minutes

Issue Date 28-10-13

Page 1

Part No: 100996-WL

Hayman Reese (Cequent)
PO Box 4050, Dandenong South VIC 3164
Phone 1800 812 017 Email info@haymanreese.com.au

www.haymanreese.com.au



HAYMAN REESE
PART No: 100996-WL
PEUGEOT 3008

INSTALLATION INSTRUCTIONS

PLEASE ENSURE THAT INSTRUCTIONS ARE UNDERSTOOD PRIOR TO FITMENT

1. In the luggage compartment, fold down the rear seats (1), remove the rear shelf (2) and then remove the floor carpet cover and rear trim (3) by removing the three fasteners (4).

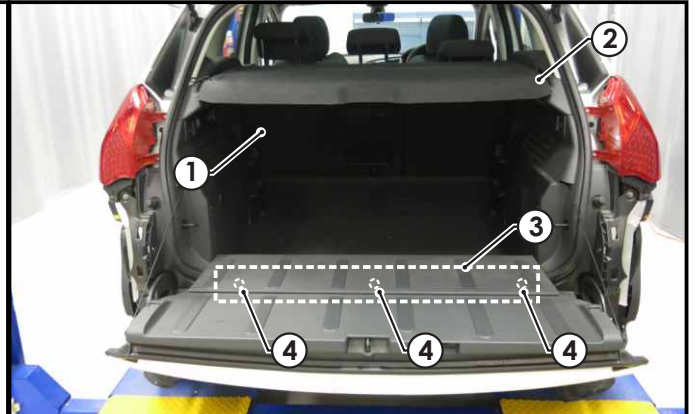

2. Remove the RHS luggage compartment trim (1) by removing the eight fasteners (2) and then disconnect the luggage trim light (3) from behind. Repeat for the LHS (LHS does not contain luggage trim light).

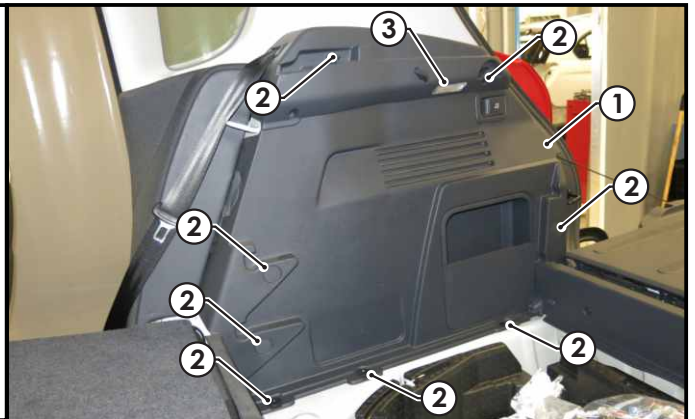

3. Remove the LHS rear passenger door sill trim (1).



Issue Date 28-10-13

Page 2

Part No: 100996-WL

Hayman Reese (Cequent)
PO Box 4050, Dandenong South VIC 3164
Phone 1800 812 017 Email info@haymanreese.com.au

www.haymanreese.com.au



HAYMAN REESE
PART No: 100996-WL
PEUGEOT 3008

INSTALLATION INSTRUCTIONS

PLEASE ENSURE THAT INSTRUCTIONS ARE UNDERSTOOD PRIOR TO FITMENT

4. Remove the LHS front passenger door sill trim (1) and then dislodge the lower section of the 'B' pillar trim (2).



5. Inside the glove compartment, remove the access panel and expose the fuse panel.



6. At the LHS rear quarter area next to the wheel arch, pull aside the foam padding and then drill a 30mm hole into the sheet metal area indicated (1) spray on rust inhibitor after drilling (not supplied).



Issue Date 28-10-13

Page 3

Part No: 100996-WL

Hayman Reese (Cequent)
PO Box 4050, Dandenong South VIC 3164
Phone 1800 812 017 Email info@haymanreese.com.au

www.haymanreese.com.au



HAYMAN REESE
PART No: 100996-WL
PEUGEOT 3008

INSTALLATION INSTRUCTIONS

PLEASE ENSURE THAT INSTRUCTIONS ARE UNDERSTOOD PRIOR TO FITMENT

7. On the LHS rear exterior, remove and disconnect the LHS tail light assembly (1) by removing the two fasteners (2).

Repeat for RHS.

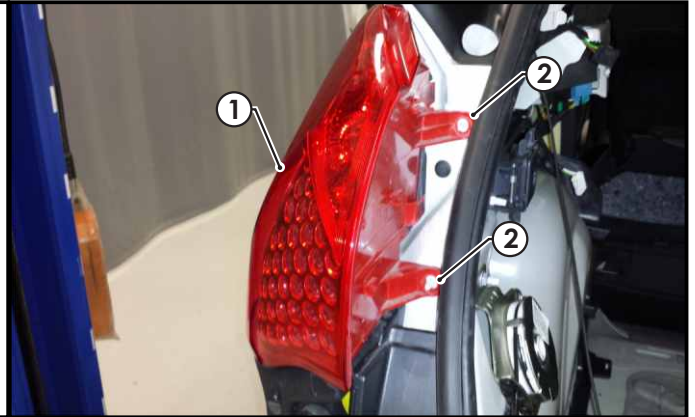

8. Connect the trailer patch (P/No: 100996-WL) tail light connector (1) into the vehicle harness tail light connector.
9. Clean the vehicle sheet metal area (3) where the ECU will be mounted using an alcohol wipe (supplied). Connect the ECU connector (2) to the ECU (3) and then mount the ECU (3) to the sheet metal area as shown using double sided tape.
10. Secure the trailer patch ground terminal (4) to the vehicle grounding point (5).
11. Route the trailer patch orange power wire (6) along the vehicle harness, towards the front LHS fuse panel area.

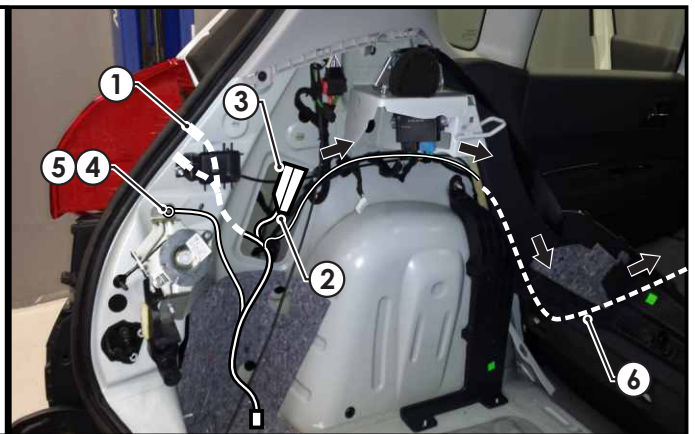

12. In the luggage compartment area, route the trailer patch harness (1) towards the RHS vehicle tail light connector and patch in-between RHS.



Issue Date 28-10-13

Page 4

Part No: 100996-WL

Hayman Reese (Cequent)
PO Box 4050, Dandenong South VIC 3164
Phone 1800 812 017 Email info@haymanreese.com.au

www.haymanreese.com.au



HAYMAN REESE
PART No: 100996-WL
PEUGEOT 3008

INSTALLATION INSTRUCTIONS

PLEASE ENSURE THAT INSTRUCTIONS ARE UNDERSTOOD PRIOR TO FITMENT

13. Remove the existing vehicle 30A fuse (1) from the location shown (2). Place the vehicle 30A fuse (1) into the lower slot of the add-a-fuse harness (3) and the supplied 20A fuse (4) into the upper slot of the harness.

14. Connect the add-a-fuse harness 1-way connector (3) to the trailer patch orange wire 1-way connector (4) and insert the add-a-fuse terminals (5) into the previously removed 30A fuse location (2) (ensure the add-a-fuse harness is in the same orientation as shown).

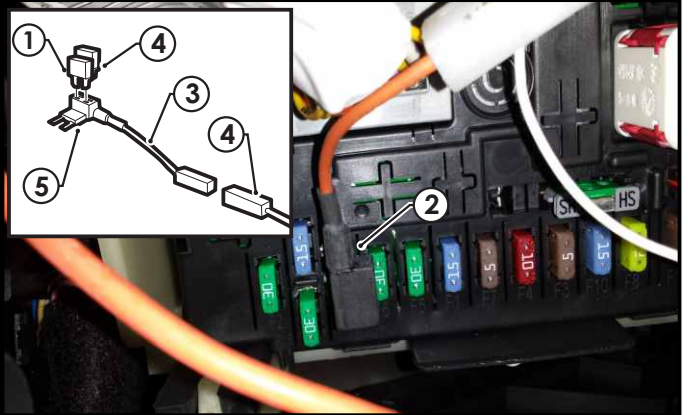

15. At the rear exterior of the vehicle, secure the tail harness (tail length: 1200mm) (1) to the mounting point using the supplied M4 fasteners.

16. Route the tail harness (1) underneath the bumper, across the LHS towards the previously drilled out hole (2).

17. Route the tail harness connector (3) into the drilled out hole ensuring the tail harness grommet is seated correctly.

18. Connect the tail harness connector (3) to the trailer patch mating connector (4).

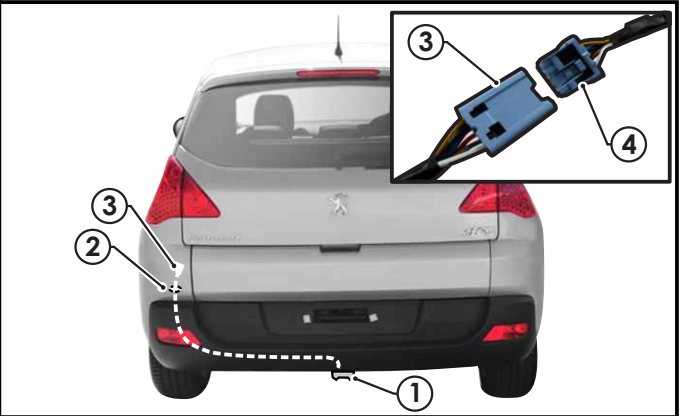

19. Refit and reconnect the rear tail light assemblies to the trailer patch harness connectors.

20. Test the trailer wiring harness function using a light board or multimeter.

21. Secure all harnesses using cable ties (not supplied).

22. Re-fit all removed parts and secure all fasteners, ensuring there are no squeaks or rattles.

23. Place the fitting instructions in the glove box after fitment.

Issue Date 28-10-13

Page 5

Part No: 100996-WL

Hayman Reese (Cequent)
PO Box 4050, Dandenong South VIC 3164
Phone 1800 812 017 Email info@haymanreese.com.au

www.haymanreese.com.au

