

**HAYMAN REESE**

**PART No: 03049W**

**HONDA ODYSSEY 2014 - ON**

## **INSTALLATION INSTRUCTIONS**

PLEASE ENSURE THAT ALL INSTRUCTIONS ARE UNDERSTOOD PRIOR TO FITMENT  
PLACE THESE INSTRUCTIONS IN THE VEHICLE'S GLOVEBOX AFTER INSTALLATION IS COMPLETED



**Installation Time: Approx 120 Mins**

**Towbar Installation Instructions**

**Towbar capacity**

**HONDA ODYSSEY 2014 – ON**

**Part Number 03049W**

<b>Max Towing Braked</b>	<b>1000 kg</b>
<b>Max Towing Unbraked</b>	<b>750 kg</b>
<b>Max Static Ball Load</b>	<b>100 kg</b>

Hayman Reese (Cequent)  
PO Box 4050, Dandenong South VIC 3164  
Phone 1800 812 017 Email [info@haymanreese.com.au](mailto:info@haymanreese.com.au)

# HAYMAN REESE

PART No: 03049W

HONDA ODYSSEY 2014 - ON

## INSTALLATION INSTRUCTIONS

PLEASE ENSURE THAT ALL INSTRUCTIONS ARE UNDERSTOOD PRIOR TO FITMENT  
PLACE THESE INSTRUCTIONS IN THE VEHICLES'S GLOVEBOX AFTER INSTALLATION IS COMPLETED

### Warning:

1. Do not, drill, cut, weld or otherwise modify the towbar.
2. If you are using electric welding on a motor vehicle, **always** check that the vehicle is not equipped with electronic engine or instrument management equipment. Failure to do so could **destroy** any onboard computers. If in doubt, check with the vehicle's manufacturer.
3. If TBM is used in inverted position tow ball may make contact with rear tailgate when lowered, which could cause damage.

### General:

1. Ensure all hardware items have been included refer to assembly diagram.
2. It is recommended that the instructions are read through and completely understood before making any attempt to fit this product.
3. Be wary of any changes to vehicle designs or other accessories that may conflict with the installation of this product.
4. Before drilling ensure that the area is clear of fuel, electrical & other components.
5. All holes drilled into the body panels shall have all burrs & swarf removed then coated with a suitable rust preventative paint.
6. The high tensile fasteners supplied with this product were used to achieve the specified rating. If replacement is required ensure that fasteners of the same rating & quality are used. Contact an authorised **Hayman Reese** dealer if further information is required.
7. Ensure that all hardware is fastened to torque list below check fasteners on regular basis.
8. Towbar load rating sticker provided with this product shall be conspicuously located on inside rear end of the driver's door. **(See diagram below).**
9. Hayman Reese recommends that you check your tow ball to ensure that it complies with the Australian standards **AS 4177.2**.
10. **PLEASE NOTE:** It is advised to remove your lug or tbn when not actually towing so as to produce a clear view of the vehicles registration plate if obscured, and to also provide maximum available departure angle.
11. Pull Pin must be fit in down position.

### Tow bar Maintenance and Care.

Hayman Reese recommends that bolt torque's, as listed below, are routinely and regularly inspected and checked for correct tension. Replace any worn or defective parts.

We recommended to remove Tow Ball Mounts (TBM's, tongues or lugs) when not being used for any considerable length of time.

So as to avoid injury, when not towing it is suggested that the tongue, Pull Pin and R-clip are removed then stored in a safe, clean and dry place, away from excessive moisture.

Hitch Pull Pins and spring "R" clips are regularly checked for proper installation. Replace any worn or defective parts.

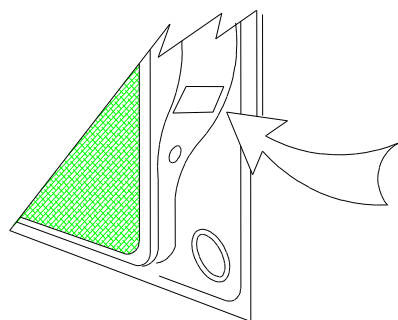

Place load rating sticker  
inside driver's door here

### **RECOMMENDED ASSEMBLY TORQUE LISTING**

#### Diameter Grade 8.8 Bolt

M6	9.5 Nm
M8	21.7 Nm
M10	43.4 Nm
M12	77.3 Nm
M14	146 Nm
M16	189.8 Nm

### **FOR TOWING PURPOSES ONLY**

For towing capacity details please refer to vehicle owner's manual or to the manufacturer. Overloading can void your warranties.

# HAYMAN REESE

PART No: 03049W

HONDA ODYSSEY 2014 - ON

## INSTALLATION INSTRUCTIONS

PLEASE ENSURE THAT ALL INSTRUCTIONS ARE UNDERSTOOD PRIOR TO FITMENT  
PLACE THESE INSTRUCTIONS IN THE VEHICLES'S GLOVEBOX AFTER INSTALLATION IS COMPLETED

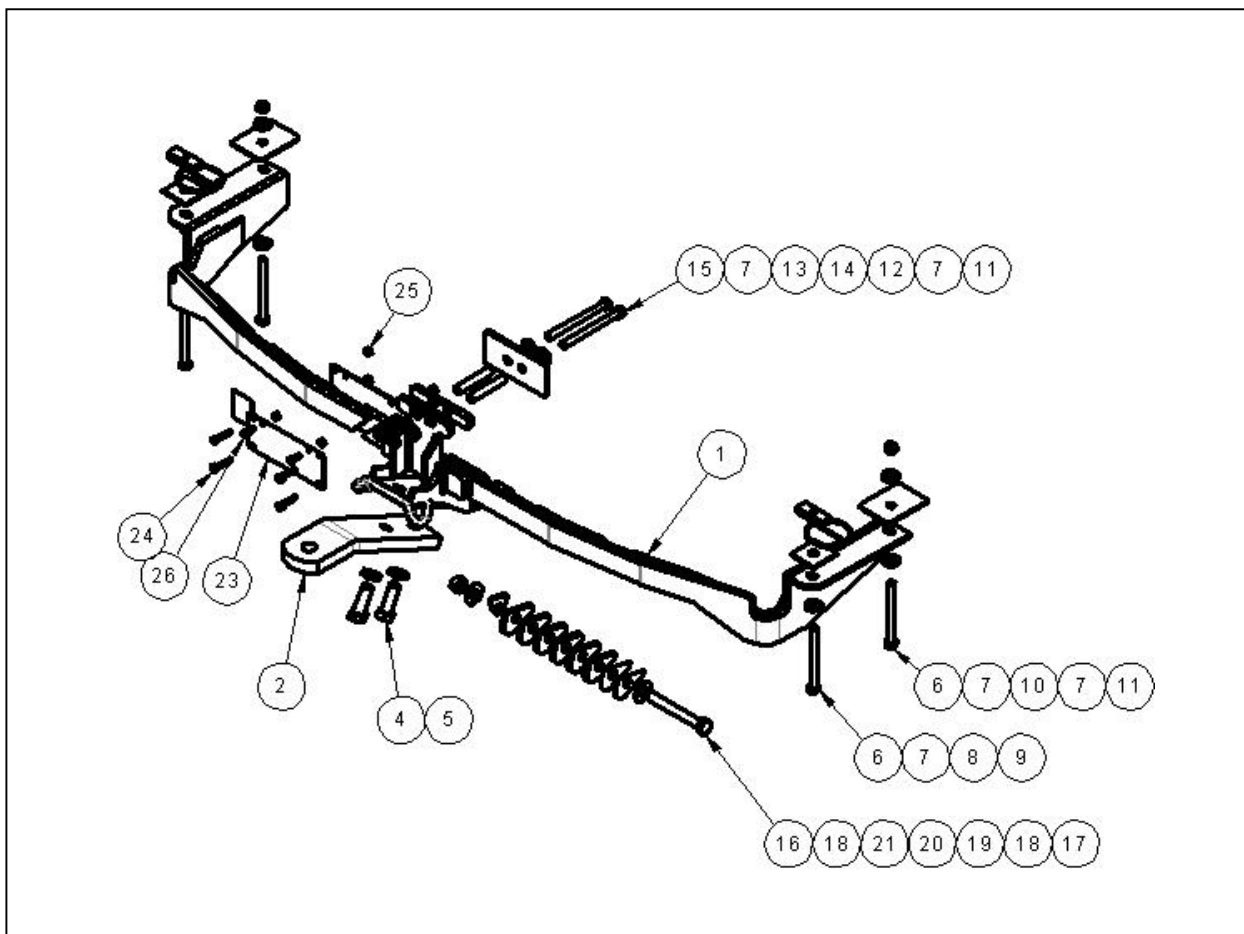

ITEM NO.	DESCRIPTION	QTY.
1	WELDED ASSY	1
2	TONGUE 7229	1
3	H.R STICKER	1
4	M16 x 45 2.0P BOLT	2
5	M16 X 5 X 3.5 SPRING WASHER	2
6	BOLT M10 x 110 1.5P	4
7	WSHR FT M10 X 25.4 X 3	10
8	LOOSE PLATE - COATED	2
9	M10 x 1.5 TAPPED PLATE 300mm	2
10	BRACING PLATE	2
11	HEX NUT M10x1.5	4
12	CENTRE MOUNT SPACER	1
13	INNER PANEL MOUNT	1
14	SPACER TUBE	2
15	M10 - 1.5 x 120mm BOLT	2
16	M14 X 110 BOLT STD THREAD	1
17	M14 x 2.0 HEX NUT PC8	1
18	M14X28X1.6 FLAT WASHER	2
19	CENTRAL HOOK	1
20	HOOK PLATE 8MM	6
21	HOOK PLATE 1.6MM	2
22	RUBBER TAPE 3M 55MM X 40MM	1
23	SENSOR PLATE	2
24	Bolt M6 x 30 GR 8.8 z/p	4
25	NYLOC NUT M6-1.00 Z/P	6
26	SET SCREW M6x16 PC8.8	2

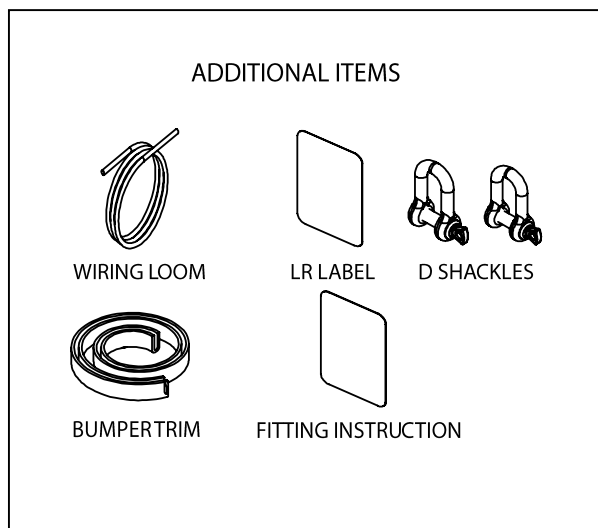

# HAYMAN REESE

PART No: 03049W

HONDA ODYSSEY 2014 - ON

## INSTALLATION INSTRUCTIONS

PLEASE ENSURE THAT ALL INSTRUCTIONS ARE UNDERSTOOD PRIOR TO FITMENT

PLACE THESE INSTRUCTIONS IN THE VEHICLES'S GLOVEBOX AFTER INSTALLATION IS COMPLETED

1. Open Rear Hatch and remove 3x Screws securing Bumper fascia to rear Chassis from Passenger side of car.

Repeat for opposite side of vehicle

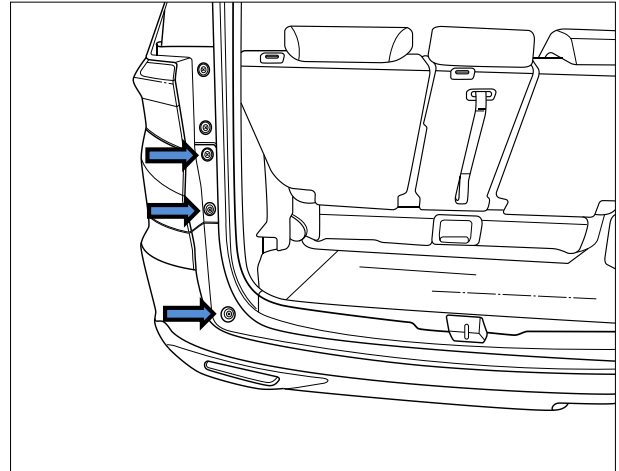

2. Remove the 3x screws attaching the bumper cover to the wheel arch.

Note: The 3<sup>rd</sup> screw is accessed from under the car

Repeat for opposite side of vehicle

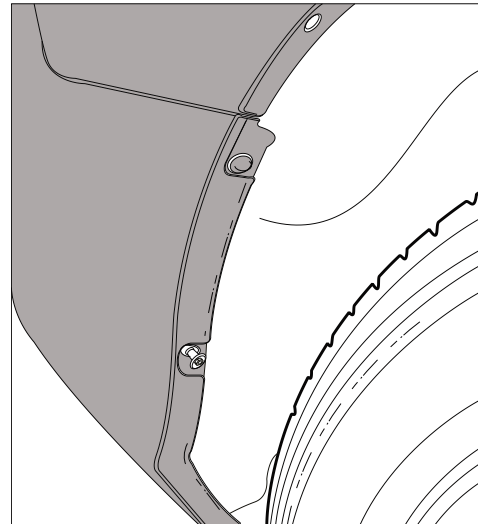

3. Remove the LHS scrivet located under the fog light, repeat for RHS

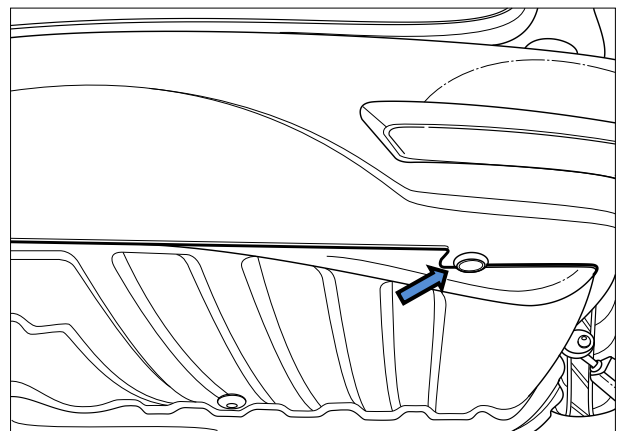

# HAYMAN REESE

PART No: 03049W

HONDA ODYSSEY 2014 - ON

## INSTALLATION INSTRUCTIONS

PLEASE ENSURE THAT ALL INSTRUCTIONS ARE UNDERSTOOD PRIOR TO FITMENT

PLACE THESE INSTRUCTIONS IN THE VEHICLES'S GLOVEBOX AFTER INSTALLATION IS COMPLETED

4. Remove scrivet located next to rear Towing Hook.

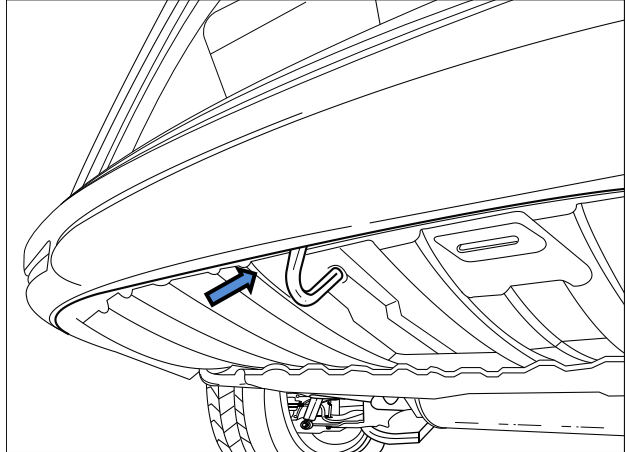

5. Remove the rear Bumper fascia, place to side in a safe area.

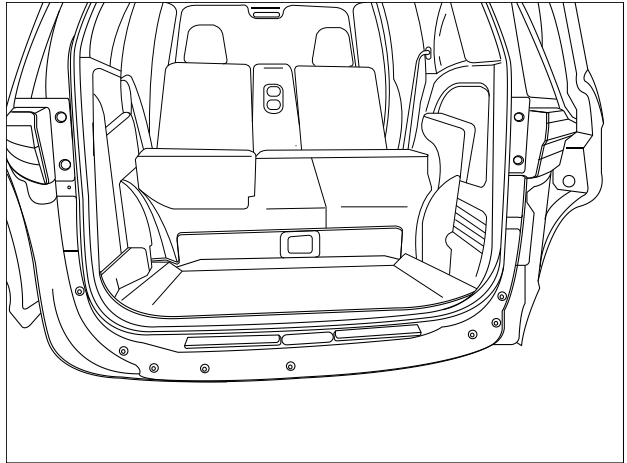

6. From inside Boot, remove vehicle jack cover.

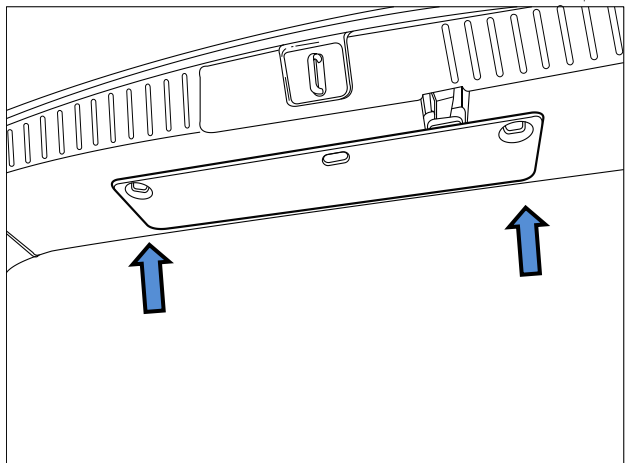

**INSTALLATION INSTRUCTIONS**

PLEASE ENSURE THAT ALL INSTRUCTIONS ARE UNDERSTOOD PRIOR TO FITMENT

PLACE THESE INSTRUCTIONS IN THE VEHICLES'S GLOVEBOX AFTER INSTALLATION IS COMPLETED

7. Remove 'xmas tree' plug [1] securing rearwards internal trim to vehicle, then remove central trim by pulling vertically upwards. [2]

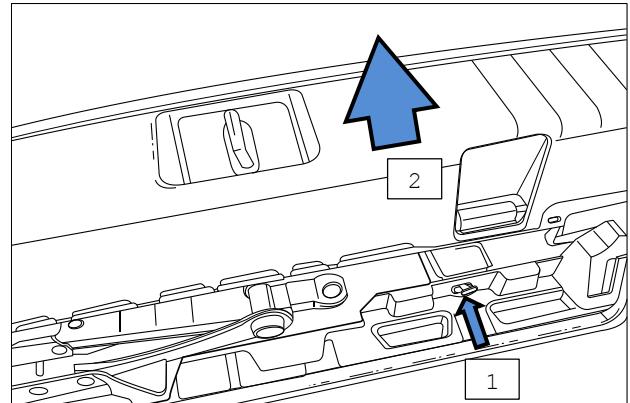

8. Open side doors and remove step trim from vehicle floor. Trims are secured by clips and will pop free by lifting vertically upwards. Drivers side shown in image

Repeat for opposite end of vehicle

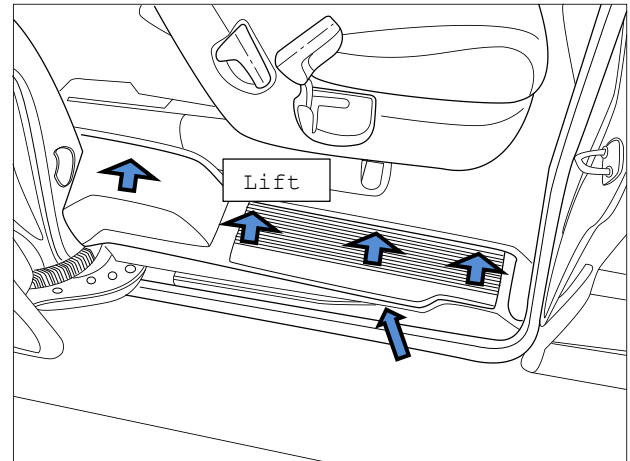

9. Disconnect lower end of seatbelt from vehicle, access Bolt by lifting plastic cover. Passenger side shown

Repeat for opposite side of vehicle

NOTE: Ensure that bolts are kept in a safe location and are not lost.

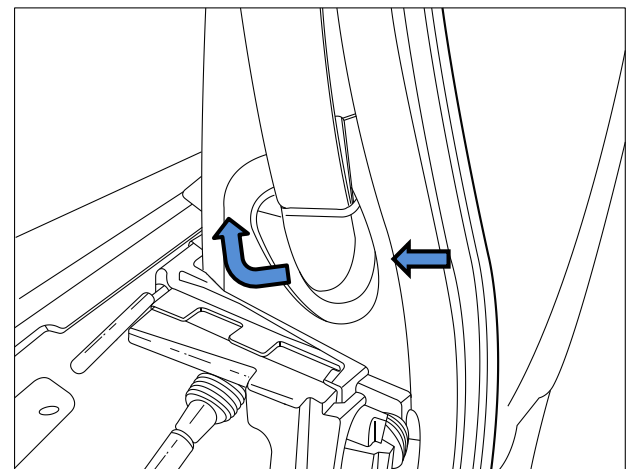

# HAYMAN REESE

PART No: 03049W

HONDA ODYSSEY 2014 - ON

## INSTALLATION INSTRUCTIONS

PLEASE ENSURE THAT ALL INSTRUCTIONS ARE UNDERSTOOD PRIOR TO FITMENT

PLACE THESE INSTRUCTIONS IN THE VEHICLES'S GLOVEBOX AFTER INSTALLATION IS COMPLETED

10. Feed rearmost seatbelts through the small slit in vehicle trim, making that section of seatbelt sit underneath the trim to allow for trim removal later.

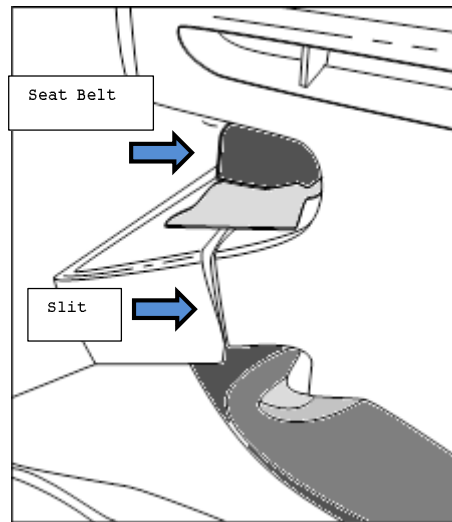

11. Carefully peel Rubber sealing trim from vehicle around areas where inside vehicle trim will be removed.

NOTE: Sealant is used under seal; this sealant can mark trim.

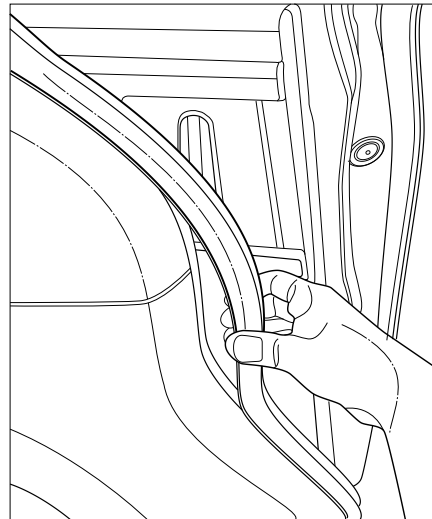

12. Carefully remove inside rearmost vehicle trims, ensure that Passenger side electrical plugs are disconnected during removal.

Trim extends from rearmost end of body to rear doors, reaching from floor of vehicle to below side windows.

Trim is connected with small plugs and will pop free.

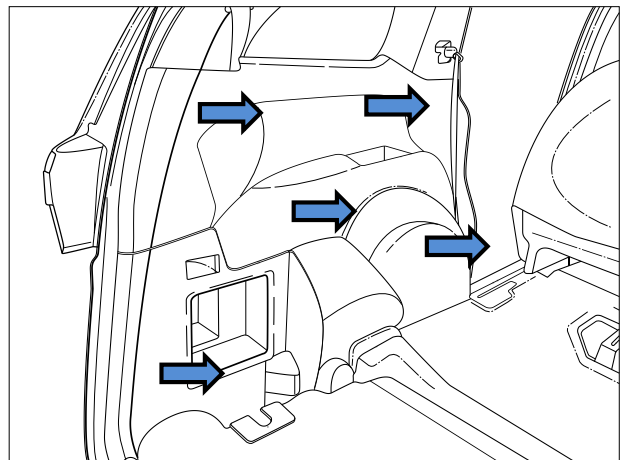



# HAYMAN REESE

PART No: 03049W

HONDA ODYSSEY 2014 - ON

## INSTALLATION INSTRUCTIONS

PLEASE ENSURE THAT ALL INSTRUCTIONS ARE UNDERSTOOD PRIOR TO FITMENT

PLACE THESE INSTRUCTIONS IN THE VEHICLES'S GLOVEBOX AFTER INSTALLATION IS COMPLETED

13. Place rubber tape [21] to forwards facing surface of centre mount on towbar.

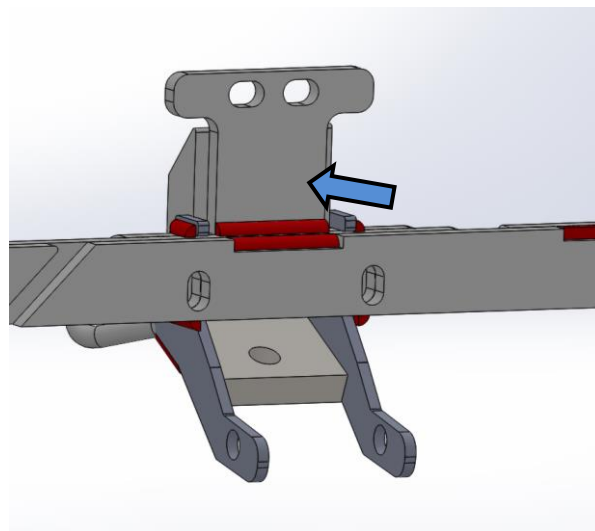

14. Offer Towbar to vehicle, ensuring sidearm holes locate to holes in lower chassis rail

Feed M10 Bolts and Washers through the vertical holes.

Holes in central section of cross-beam of towbar will mount over central studs on chassis rail

NOTE: 2 Person lift required

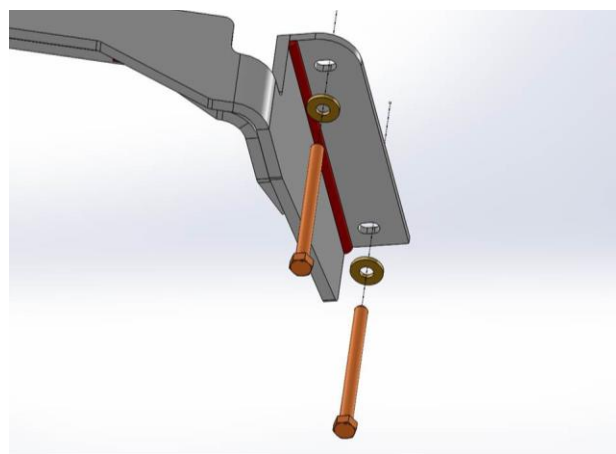

15. Secure M10 Bolts with Plates, Washers and tapped plates on wire to inside of vehicle Chassis

Driver side shown

Refer to page 3 for parts locations

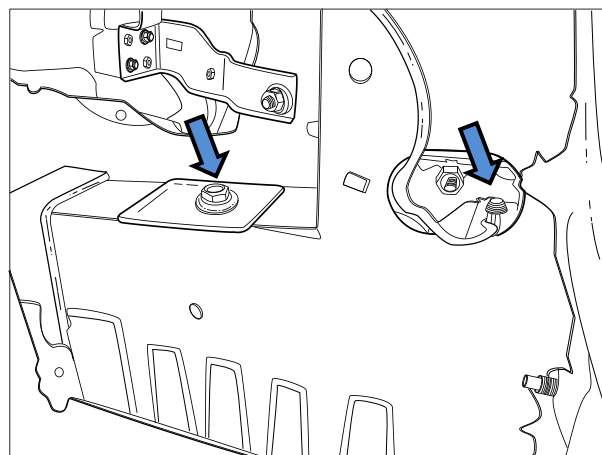



# HAYMAN REESE

PART No: 03049W

HONDA ODYSSEY 2014 - ON

## INSTALLATION INSTRUCTIONS

PLEASE ENSURE THAT ALL INSTRUCTIONS ARE UNDERSTOOD PRIOR TO FITMENT

PLACE THESE INSTRUCTIONS IN THE VEHICLES'S GLOVEBOX AFTER INSTALLATION IS COMPLETED

16. Feed central Bolt through Tow hook mounts, using spacer plates to ensure a connection between Tow hook and Towbar tabs. Secure with Bolt.

**Ensure smallest plate is placed INSIDE Towing Hook loop.**

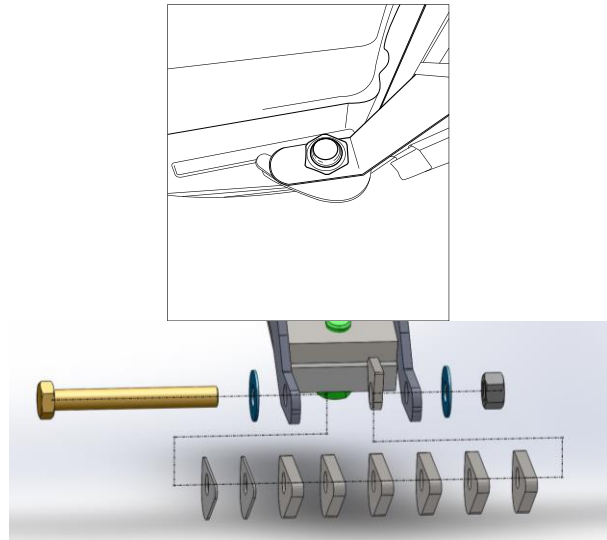

17. Using the towbar centre mounts as a guide, drill 2x 10mm holes into the centre of the rear end of the chassis

Remove towbar from vehicle if required

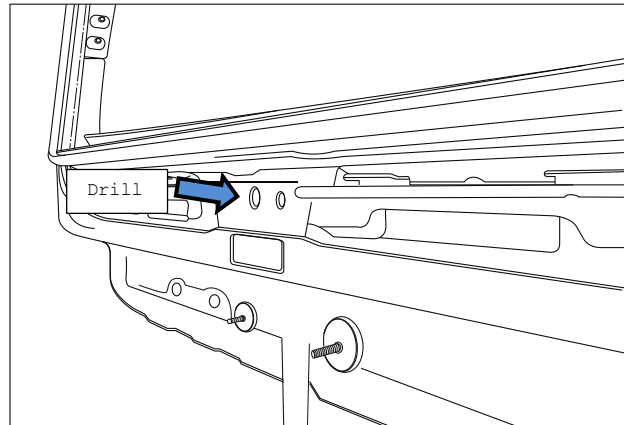

18. Use the supplied Spacer Tubes, Mount plates, Nuts and Bolts to secure centre mount of Towbar to vehicle.

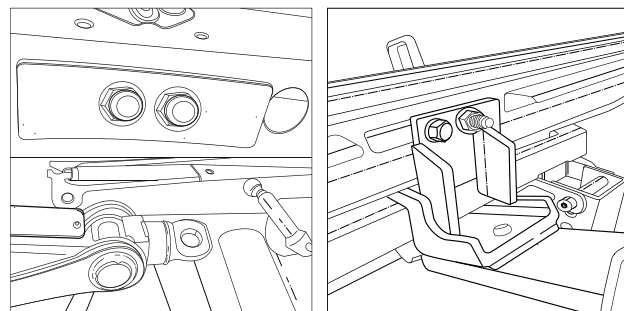

# HAYMAN REESE

PART No: 03049W

HONDA ODYSSEY 2014 - ON

## INSTALLATION INSTRUCTIONS

PLEASE ENSURE THAT ALL INSTRUCTIONS ARE UNDERSTOOD PRIOR TO FITMENT

PLACE THESE INSTRUCTIONS IN THE VEHICLES'S GLOVEBOX AFTER INSTALLATION IS COMPLETED

19. On Vti-L variants of vehicle, mount sensor plates to towbar as **close to centre section as possible** in sandwich style across towbar cross-bar

Use smaller bolts and nyloc nuts to secure sensor to rearmost plate

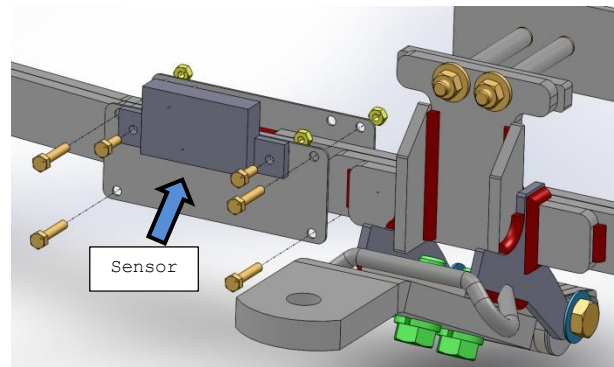

20. On the underside of the central trim, cut away and remove the innermost 3 ribs to allow clearance for the 2x Bolts used in the centre mount of the Towbar.

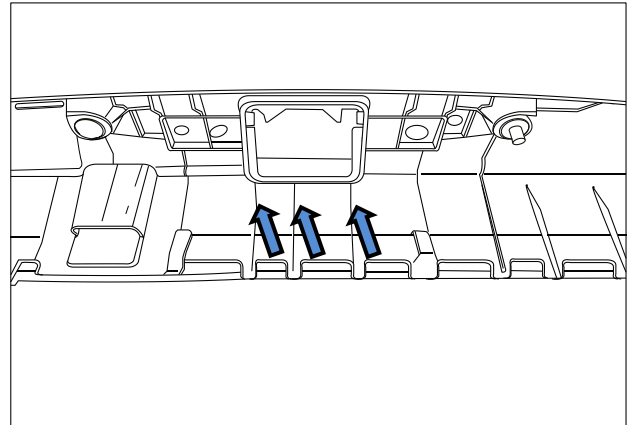

21. Make a cut on the Bumper fascia to allow for fitment over the Towbar. Make a cut from the centre of the fascia and 2 cut-outs to accommodate the side arms of the Towbar.

Refer to cut profiles provided.

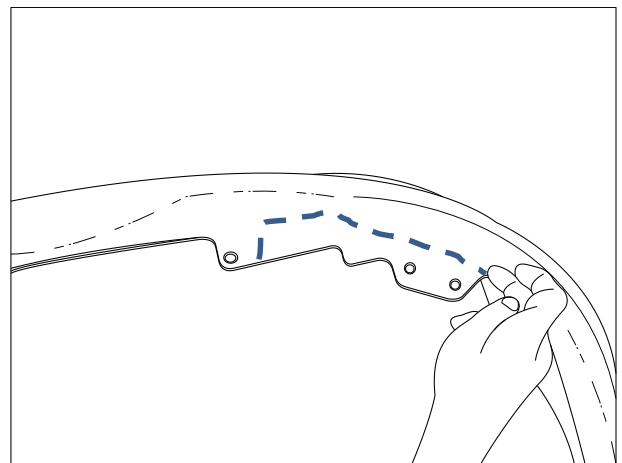

**HAYMAN REESE**

PART No: 03049W

HONDA ODYSSEY 2014 - ON

**INSTALLATION INSTRUCTIONS**

PLEASE ENSURE THAT ALL INSTRUCTIONS ARE UNDERSTOOD PRIOR TO FITMENT

PLACE THESE INSTRUCTIONS IN THE VEHICLES'S GLOVEBOX AFTER INSTALLATION IS COMPLETED

22. Torque all tow bar bolts to recommended torque listed on page 2.

Reassemble Bumper assembly following steps 1 to 12 in reverse.

Ensure all vehicle bolts are correct torques

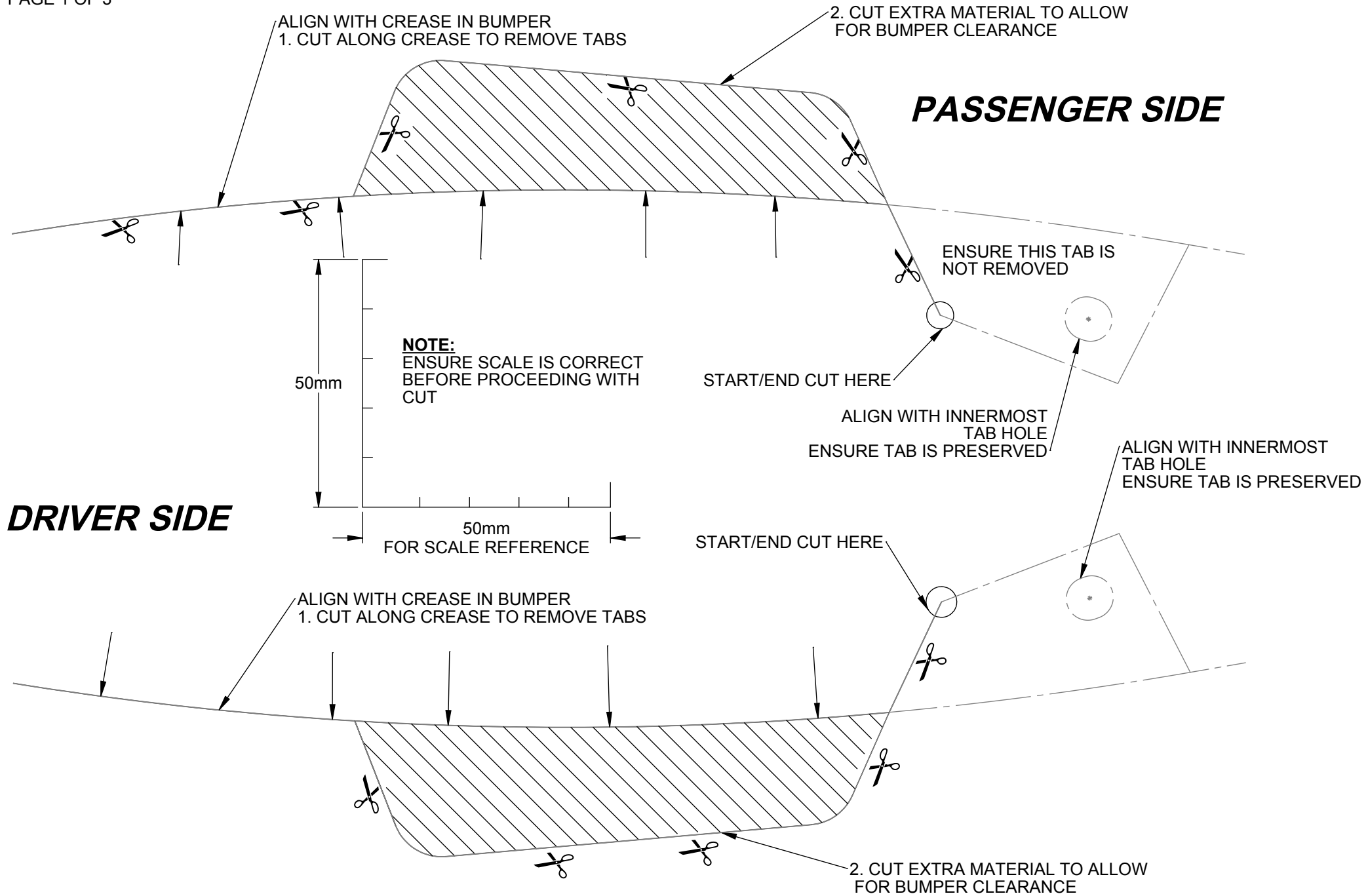



# CENTRAL BUMPER CUT FOR STANDARD VARIANT OF VEHICLE

FOR VTi-L VARIANTS REFER TO PAGE 3 OF CUT TEMPLATES

**⚠ IMPORTANT INFORMATION:**

BEFORE PROCEEDING, ENSURE SCALE IS CORRECT. USE SCALE PROVIDED BELOW.

MARK CENTRELINE OF VEHICLE BUMPER AND ALIGN WITH CENTRELINE OF CUT TEMPLATE.

ENSURE TEMPLATE CONFORMS TO THE EXTERNAL BUMPER CONTOURS. (IE. NO GAPS BETWEEN THE TEMPLATE & BUMPER SURFACES)

DRILL 2X  $\phi$  10MM HOLES AT LOCATIONS INDICATED

USING A JIGSAW CUTTER OR SIMILAR TOOL, CUT ALONG TEMPLATE PROFILE.

USE A FILE OR SIMILAR TOOL TO REMOVE EXCESS BURRS.

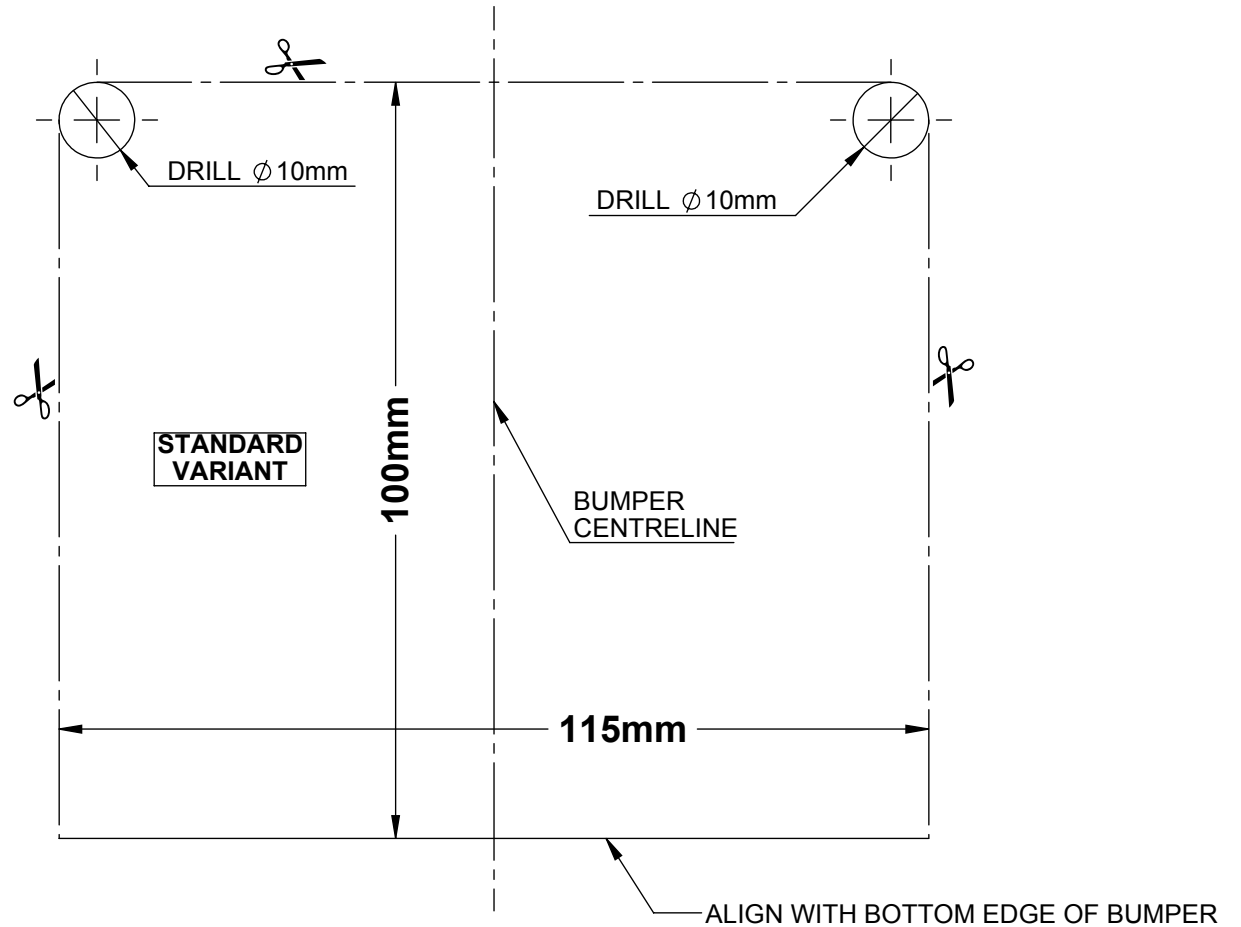
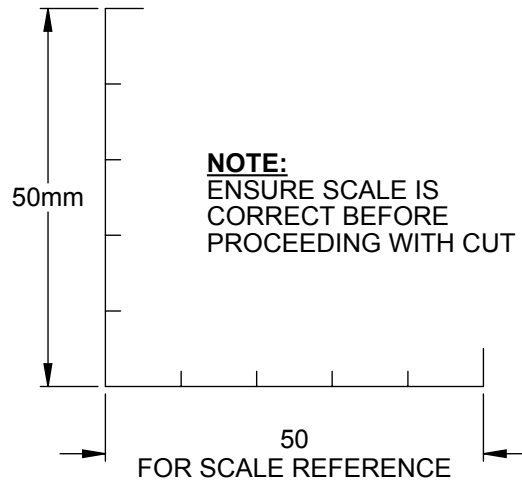





# CENTRAL BUMPER CUT FOR VTi-L VARIANT OF VEHICLE ONLY

FOR STANDARD VARIANTS REFER TO PAGE 2 OF CUT TEMPLATES

**⚠ IMPORTANT INFORMATION:**  
 BEFORE PROCEEDING, ENSURE SCALE IS CORRECT. USE SCALE PROVIDED BELOW.  
 MARK CENTRELINE OF VEHICLE BUMPER AND ALIGN WITH CENTRELINE OF CUT TEMPLATE.  
 ENSURE TEMPLATE CONFORMS TO THE EXTERNAL BUMPER CONTOURS. (IE. NO GAPS BETWEEN THE TEMPLATE & BUMPER SURFACES)  
 DRILL 2X  $\phi$  10MM HOLES AT LOCATIONS INDICATED  
 USING A JIGSAW CUTTER OR SIMILAR TOOL, CUT ALONG TEMPLATE PROFILE.  
 USE A FILE OR SIMILAR TOOL TO REMOVE EXCESS BURRS.

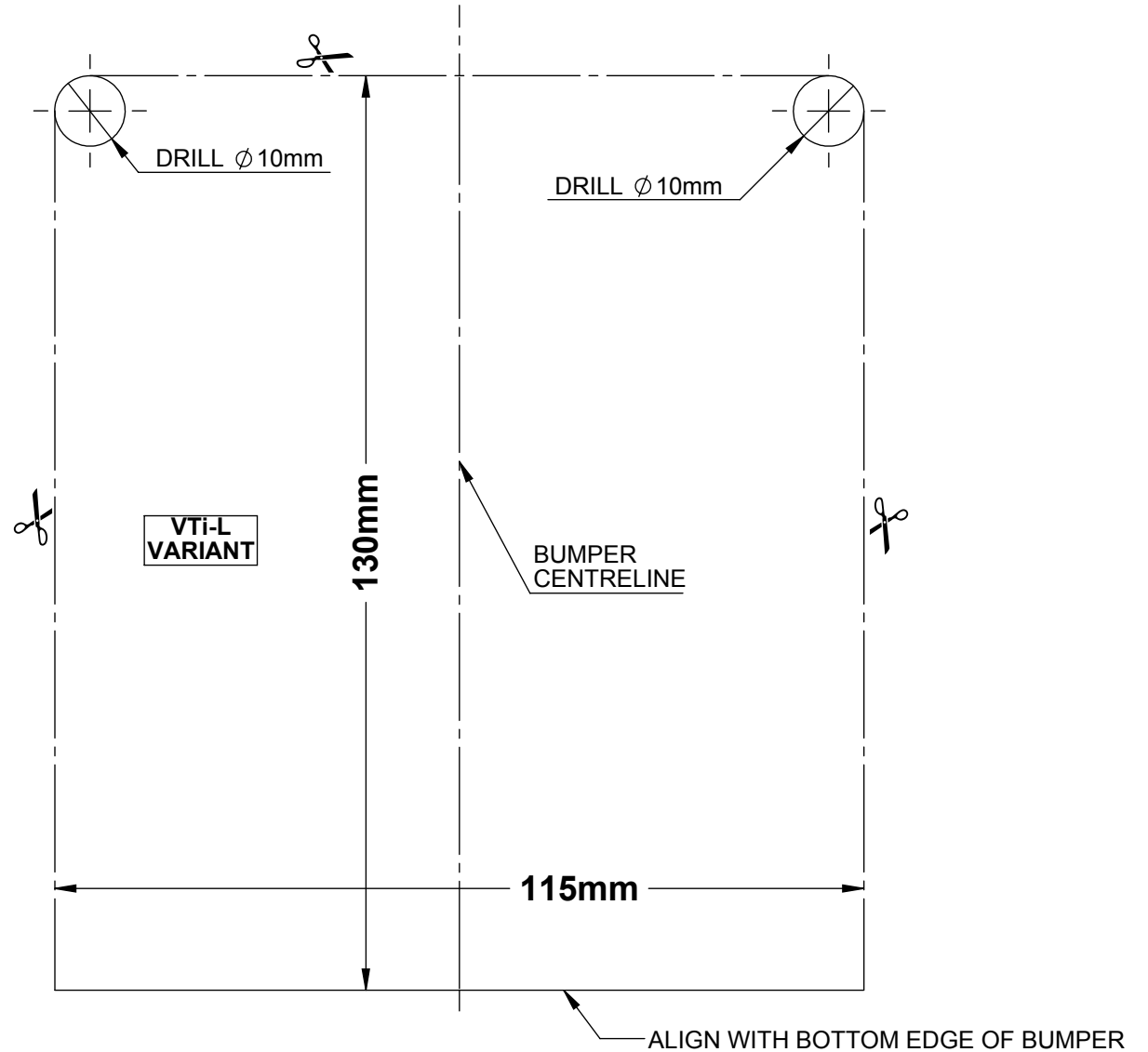
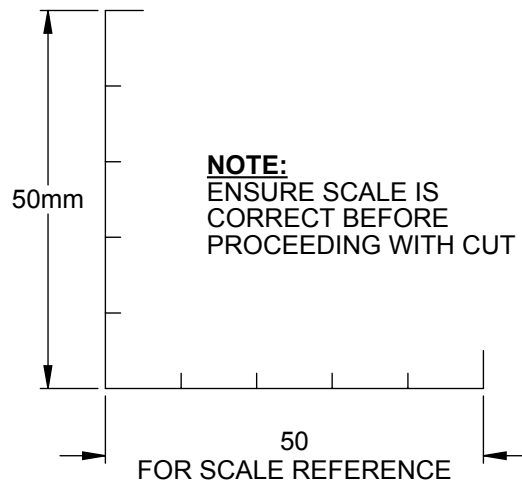



**HAYMAN REESE**  
**PART No: 101025-WL**  
**HONDA ODYSSEY**

**INSTALLATION INSTRUCTIONS**

PLEASE ENSURE THAT INSTRUCTIONS ARE UNDERSTOOD PRIOR TO FITMENT

**Wiring Loom Installation Instructions**

**HONDA ODYSSEY**

**Part No: 101025-WL**

**Tail Harness Length Required: 1800mm**

**Wiring Loom Installation Time: Approx. 20 minutes**

Issue Date 16-12-13

Page 1

Part No: 101025-WL

Hayman Reese (Cequent)  
PO Box 4050, Dandenong South VIC 3164  
Phone 1800 812 017 Email [info@haymanreese.com.au](mailto:info@haymanreese.com.au)

[www.haymanreese.com.au](http://www.haymanreese.com.au)



**HAYMAN REESE**  
**PART No: 101025-WL**  
**HONDA ODYSSEY**

**INSTALLATION INSTRUCTIONS**

PLEASE ENSURE THAT INSTRUCTIONS ARE UNDERSTOOD PRIOR TO FITMENT

1. In the luggage compartment, remove the floor carpet cover (1) and remove the luggage compartment rear trim (2).



2. Dislodge the luggage compartment LHS trim (1) and disconnect the 2-way connector from the trim.  
**Repeat for RHS trim.**



3. Patch the trailer patch LHS 4-way connectors (1) in between the vehicle connectors (2).
4. Expose the vehicle harness wires (3). Use the supplied scotch lock (4) to the vehicle TAN coloured reverse wire (5). Connect the Trailer Patch BLACK / WHITE reverse terminal (6) to the scotch lock (4).

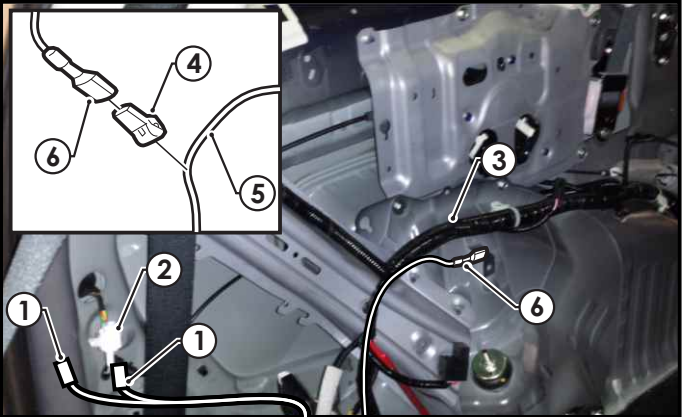

Function	Trailer Patch	Vehicle Connector
REVERSE	BLACK / WHITE	TAN

Issue Date 16-12-13

Page 2

Part No: 101025-WL

Hayman Reese (Cequent)  
 PO Box 4050, Dandenong South VIC 3164  
 Phone 1800 812 017 Email [info@haymanreese.com.au](mailto:info@haymanreese.com.au)



**HAYMAN REESE**  
**PART No: 101025-WL**  
**HONDA ODYSSEY**

**INSTALLATION INSTRUCTIONS**

PLEASE ENSURE THAT INSTRUCTIONS ARE UNDERSTOOD PRIOR TO FITMENT

5. Route the Trailer Patch ground ring terminal (1) to the vehicle grounding location (2) and secure in place using the existing vehicle fastener.
6. Drill out the existing grommet hole (3) to 30mm. If the grommet hole is occupied, drill in an appropriate location nearby. Apply rust inhibitor after drilling.



7. Route the Trailer Patch harness RHS branch (1) across to the RHS and patch in between the vehicle RHS 4-way connectors.



8. Mount the trailer socket (1) to the tow bar mounting bracket using M4 fasteners (not supplied).
9. Route the tail harness (tail length 1800mm) (2) across the tow bar towards the LHS of the vehicle and up through the previously drilled out hole.
10. Ensure the tail harness grommet is seated correctly and secured in place using a cable tie (not supplied).

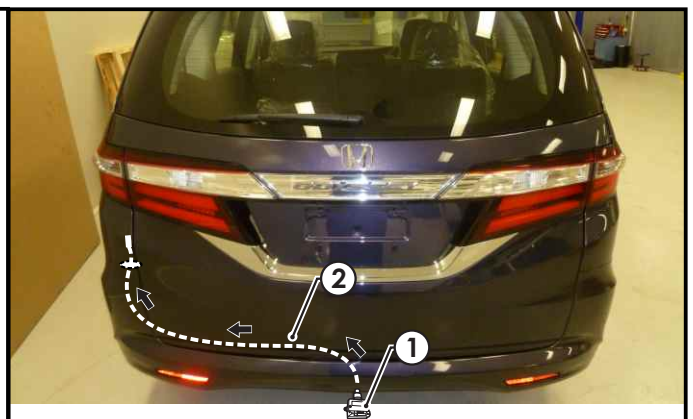

Issue Date 16-12-13

Page 3

Part No: 101025-WL

Hayman Reese (Cequent)  
PO Box 4050, Dandenong South VIC 3164  
Phone 1800 812 017 Email [info@haymanreese.com.au](mailto:info@haymanreese.com.au)

[www.haymanreese.com.au](http://www.haymanreese.com.au)



**HAYMAN REESE**  
**PART No: 101025-WL**  
**HONDA ODYSSEY**

**INSTALLATION INSTRUCTIONS**

PLEASE ENSURE THAT INSTRUCTIONS ARE UNDERSTOOD PRIOR TO FITMENT

11. Connect the tail harness (tail length 1800mm) 8-way connector (1) to the trailer patch mating 8-way connector (2).

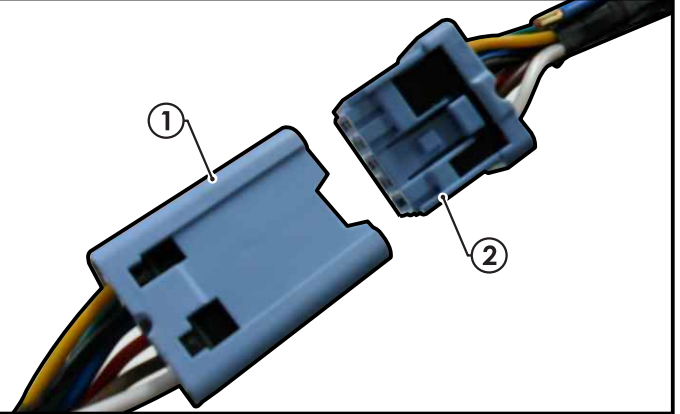

12. Test the trailer wiring harness function using a light board or multi meter.
13. Secure all harnesses using cable ties (not supplied).
14. Re-fit all removed parts and secure all fasteners, ensuring there are no squeaks or rattles.
15. Place the fitting instructions in the glove box after fitment.

Issue Date 16-12-13

Page 4

Part No: 101025-WL

Hayman Reese (Cequent)  
PO Box 4050, Dandenong South VIC 3164  
Phone 1800 812 017 Email [info@haymanreese.com.au](mailto:info@haymanreese.com.au)