

HAYMAN REESE
PART No: **03081W**
RENAULT CLIO 13-ON

INSTALLATION INSTRUCTIONS

PLEASE ENSURE THAT ALL INSTRUCTIONS ARE UNDERSTOOD PRIOR TO FITMENT
PLACE THESE INSTRUCTIONS IN THE VEHICLE'S GLOVEBOX AFTER INSTALLATION IS COMPLETED



Installation Time: Approx **60** Mins

Towbar Installation Instructions

Towbar capacity

RENAULT CLIO 13-ON

Part Number **03081RW**

Max Towing Braked	900 kg
Max Towing Unbraked	580 kg
Max Static Ball Load	75 kg

Hayman Reese (Cequent)
PO Box 4050, Dandenong South VIC 3164
Phone 1800 812 017 Email info@haymanreese.com.au

HAYMAN REESE
PART No: 03081RW
RENAULT CLIO 13-ON

INSTALLATION INSTRUCTIONS

PLEASE ENSURE THAT ALL INSTRUCTIONS ARE UNDERSTOOD PRIOR TO FITMENT
PLACE THESE INSTRUCTIONS IN THE VEHICLES'S GLOVEBOX AFTER INSTALLATION IS COMPLETED

Warning:

1. Do not, drill, cut, weld or otherwise modify the towbar.
2. If you are using electric welding on a motor vehicle, **always** check that the vehicle is not equipped with electronic engine or instrument management equipment. Failure to do so could **destroy** any onboard computers. If in doubt, check with the vehicle's manufacturer.
3. If TBM is used in inverted position tow ball may make contact with rear tailgate when lowered, which could cause damage.

General:

1. Ensure all hardware items have been included refer to assembly diagram.
2. It is recommended that the instructions are read through and completely understood before making any attempt to fit this product.
3. Be wary of any changes to vehicle designs or other accessories that may conflict with the installation of this product.
4. Before drilling ensure that the area is clear of fuel, electrical & other components.
5. All holes drilled into the body panels shall have all burrs & swarf removed then coated with a suitable rust preventative paint.
6. The high tensile fasteners supplied with this product were used to achieve the specified rating. If replacement is required ensure that fasteners of the same rating & quality are used. Contact an authorised **Hayman Reese** dealer if further information is required.
7. Ensure that all hardware is fastened to torque list below check fasteners on regular basis.
8. Towbar load rating sticker provided with this product shall be conspicuously located on inside rear end of the driver's door. **(See diagram below).**
9. Hayman Reese recommends that you check your tow ball to ensure that it complies with the Australian standards **AS 4177.2**.
10. **PLEASE NOTE:** It is advised to remove your lug or tbn when not actually towing so as to produce a clear view of the vehicles registration plate if obscured, and to also provide maximum available departure angle.
11. Pull Pin must be fit in down position.

Tow bar Maintenance and Care.

Hayman Reese recommends that bolt torque's, as listed below, are routinely and regularly inspected and checked for correct tension. Replace any worn or defective parts.

We recommended to remove Tow Ball Mounts (TBM's, tongues or lugs) when not being used for any considerable length of time.

So as to avoid injury, when not towing it is suggested that the tongue, Pull Pin and R-clip are removed then stored in a safe, clean and dry place, away from excessive moisture.

Hitch Pull Pins and spring "R" clips are regularly checked for proper installation. Replace any worn or defective parts.

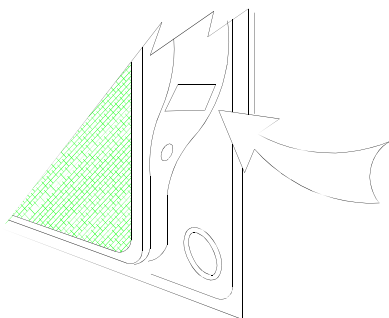

Place load rating sticker
inside driver's door here

RECOMMENDED ASSEMBLY TORQUE LISTING

Diameter Grade 8.8 Bolt

M6	9.5 Nm
M8	21.7 Nm
M10	48.0 Nm
M12	77.3 Nm
M14	146 Nm
M16	189.8 Nm

FOR TOWING PURPOSES ONLY

For towing capacity details please refer to vehicle owner's manual or to the manufacturer. Overloading can void your warranties.

HAYMAN REESE
PART No: 03081RW
RENAULT CLIO 13-ON

INSTALLATION INSTRUCTIONS

PLEASE ENSURE THAT ALL INSTRUCTIONS ARE UNDERSTOOD PRIOR TO FITMENT
 PLACE THESE INSTRUCTIONS IN THE VEHICLES'S GLOVEBOX AFTER INSTALLATION IS COMPLETED

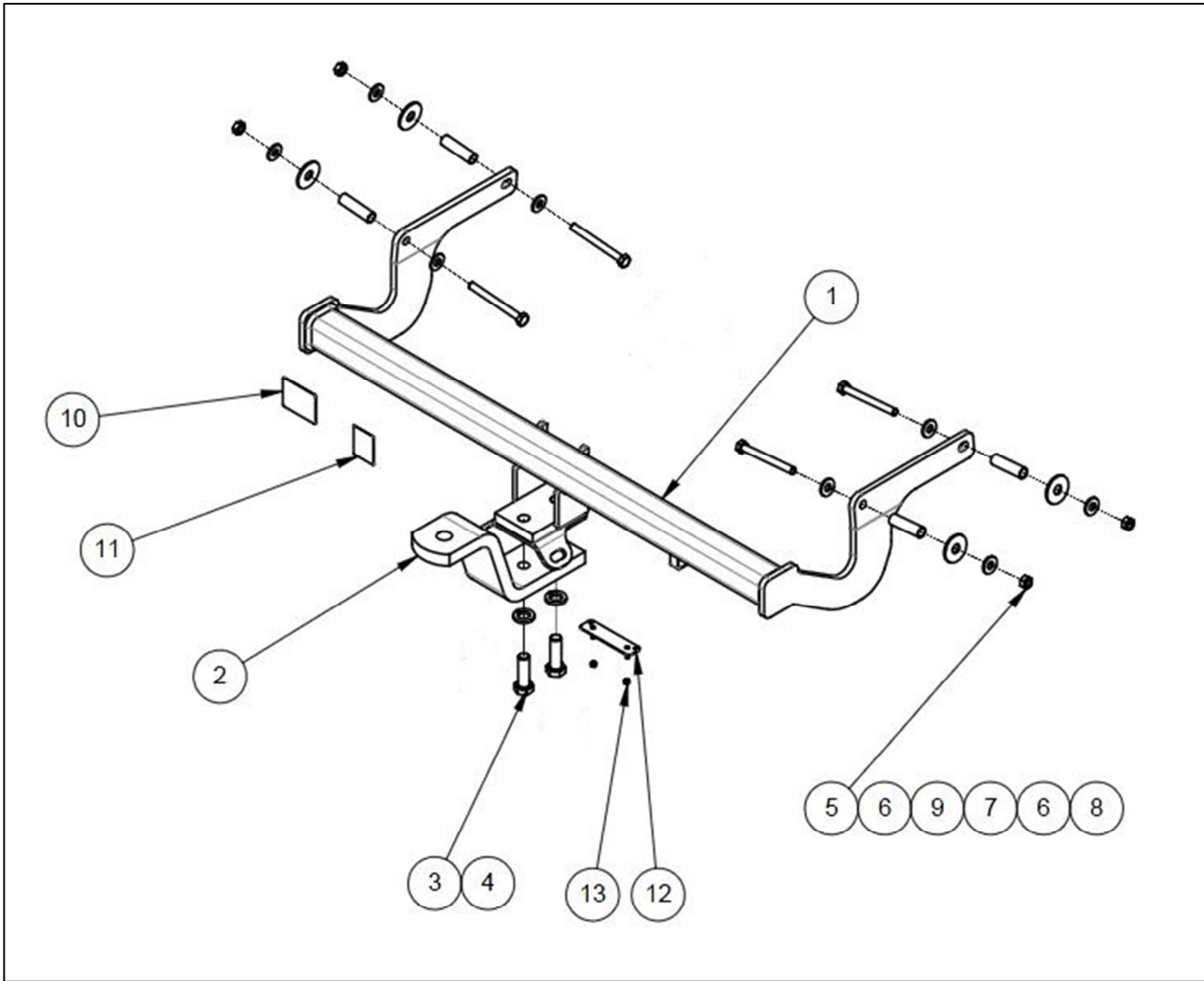

QTY	DESCRIPTION	ITEM NO
1	RENAULT CLIO WELDED ASSY	1
1	LUG ASSEMBLY	2
2	BOLT M16X50	3
2	SPRING WASHER M16X5X3.5	4
4	Bolt M10x100x1.25	5
8	WASHER FT M10X25.4X3	6
4	FITTING PLATE Ø42MM	7
4	NUT HX M10-1.25 Z/P	8
4	SPACER TUBE 16X1.6MM	9
1	ACRYLIC COMPLIANCE PLATE	10
1	H.R STICKER	11
1	PLUG BRACKET	12
2	NUT NYLOC M4-0.7 Z/P	13

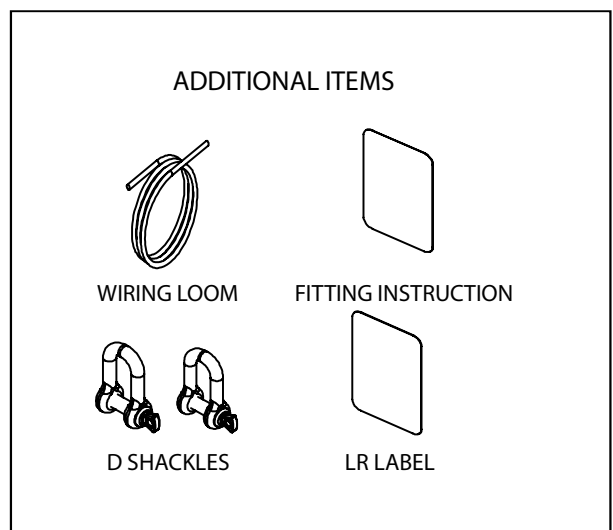

INSTALLATION INSTRUCTIONS

PLEASE ENSURE THAT ALL INSTRUCTIONS ARE UNDERSTOOD PRIOR TO FITMENT
PLACE THESE INSTRUCTIONS IN THE VEHICLES'S GLOVEBOX AFTER INSTALLATION IS COMPLETED

1. Remove Screws securing tail light to vehicle body, then carefully remove tail light by pulling rearwards of vehicle (1).

Remove black plastic trim by unclipping trim from main bumper assembly (2).

Repeat for opposite side of vehicle.

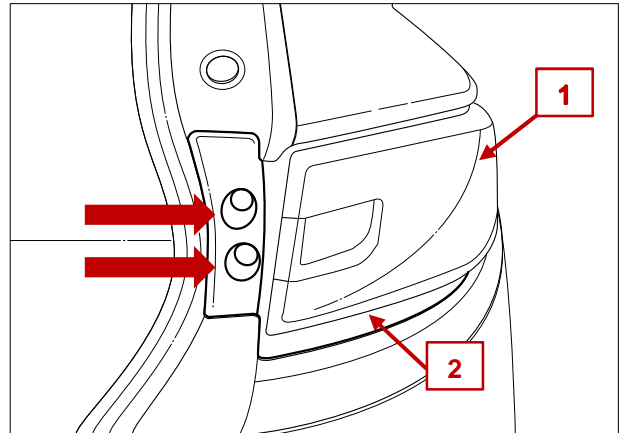

2. Remove Screw located under tail light assembly (1).

Remove small Rubber plug located below tail light assembly (2).

Repeat for opposite side of vehicle.

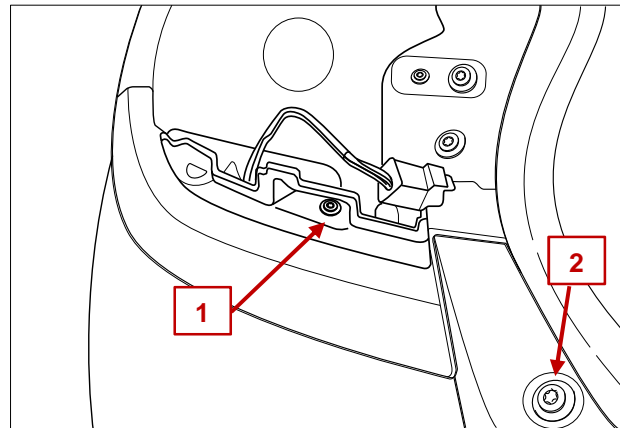

3. Remove 5 fasteners securing the rear Bumper to the vehicle.

Carefully remove rear bumper from vehicle.
Disconnect Rear Parking sensor as required.

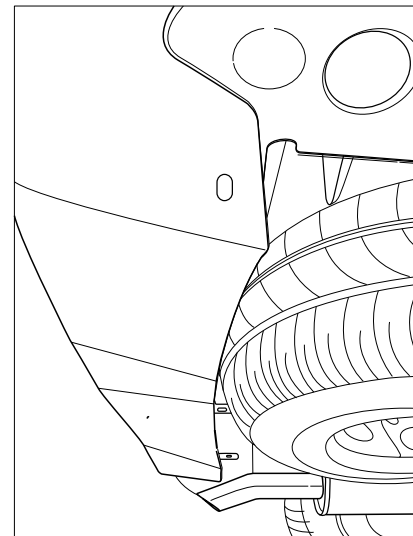

INSTALLATION INSTRUCTIONS

PLEASE ENSURE THAT ALL INSTRUCTIONS ARE UNDERSTOOD PRIOR TO FITMENT
PLACE THESE INSTRUCTIONS IN THE VEHICLES'S GLOVEBOX AFTER INSTALLATION IS COMPLETED

4. Remove and discard 4 impact beam Nuts and Rear impact beam.

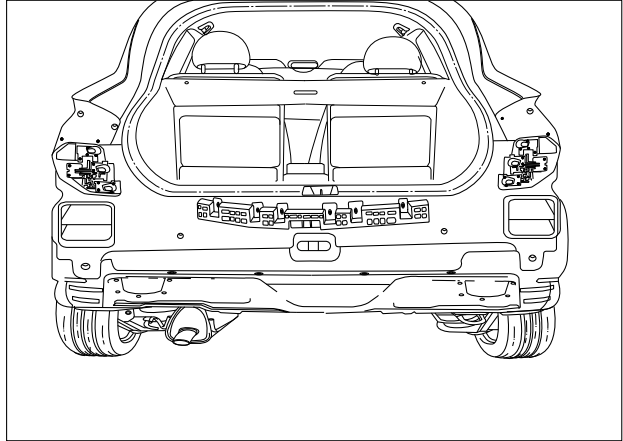

5. Remove Screw from rear side of wheel well cavity.

Repeat for opposite side of vehicle.

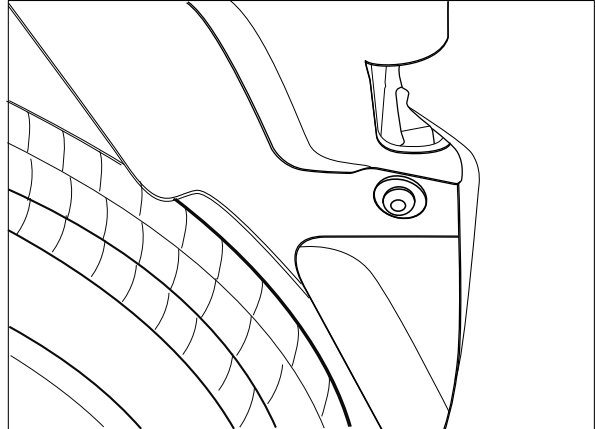

6. Remove wheel well trim by removing 4 of Scrivets and 1 of Nut.

Repeat for Opposite side of vehicle.

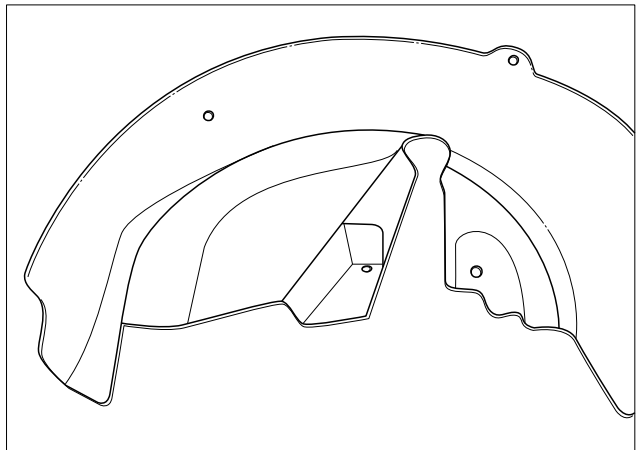

INSTALLATION INSTRUCTIONS

PLEASE ENSURE THAT ALL INSTRUCTIONS ARE UNDERSTOOD PRIOR TO FITMENT
PLACE THESE INSTRUCTIONS IN THE VEHICLES'S GLOVEBOX AFTER INSTALLATION IS COMPLETED

7. Lower spare tyre from vehicle, and move heat shield away from chassis rail.

Lower exhaust by loosening M10 Bolt securing hanger to vehicle (1).

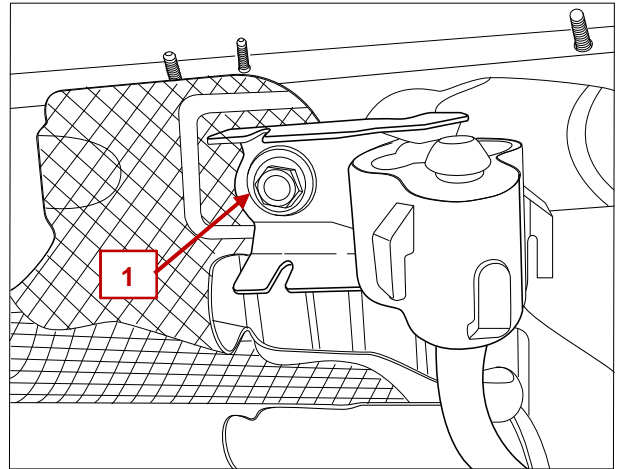

8. Offer Towbar to vehicle.

Loosely secure the Towbar to the vehicle at all 4 mounting points using M10 x 100 Bolt, M10 Washer, Spacer tube, 42mm plate and M10 Nut

9. Feed spacer tube into the Chassis rail from the outside face of the rail as indicated.

Tighten all Bolts to recommended torques specified on page 2.

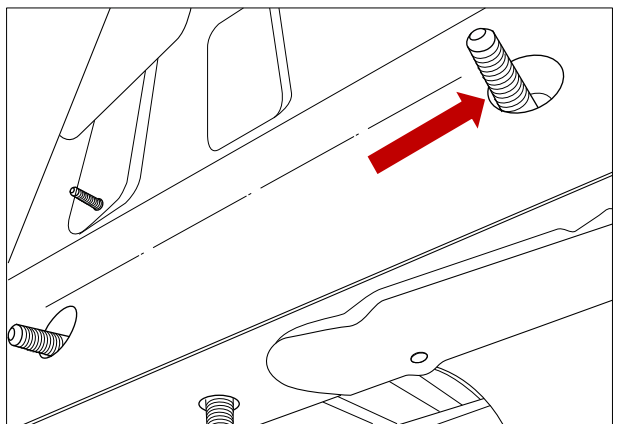
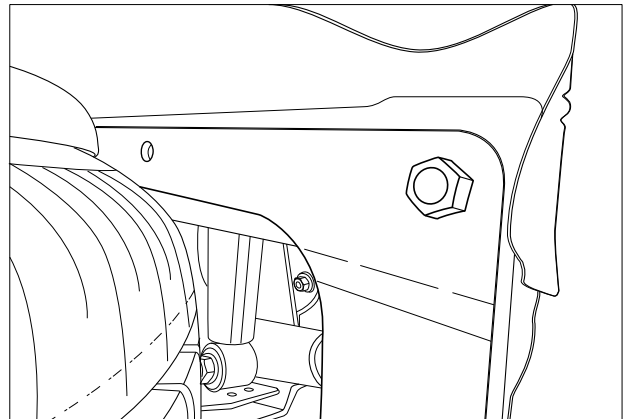

INSTALLATION INSTRUCTIONS

PLEASE ENSURE THAT ALL INSTRUCTIONS ARE UNDERSTOOD PRIOR TO FITMENT
PLACE THESE INSTRUCTIONS IN THE VEHICLE'S GLOVEBOX AFTER INSTALLATION IS COMPLETED

10. Create Bumper cut as per dimensions shown in figure.

11. Drill 2 off Ø6mm holes in lower face of bumper, adjacent to Bumper cut, to suit plug bracket.

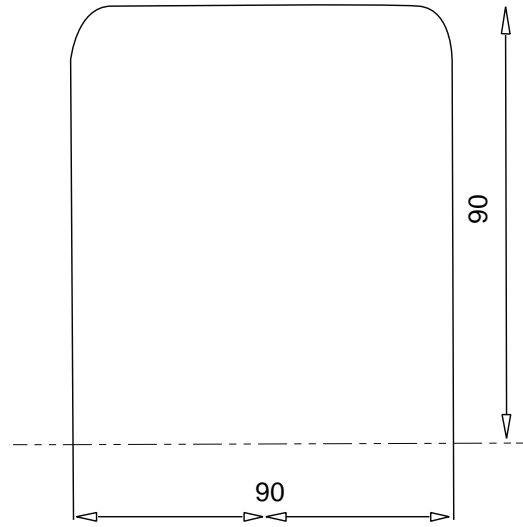

12. Reattach Bumper by following steps 1 to 9 in reverse.

Use plastic Scrivets to secure lower Bumper trim with rear mudguard.

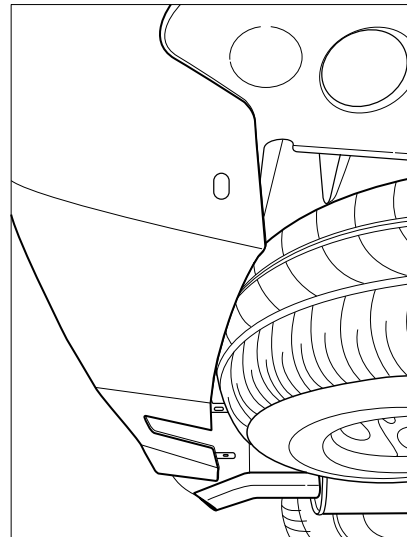

HAYMAN REESE
PART No: 100531-WL
RENAULT X95 MEGANE HATCH
INSTALLATION INSTRUCTIONS

PLEASE ENSURE THAT INSTRUCTIONS ARE UNDERSTOOD PRIOR TO FITMENT

Wiring Loom Installation Instructions

RENAULT X95 MEGANE HATCH
Part No: 100531-WL

ECU Required: 04826
Tail Harness Length Required: 1800mm
RPA Override Switch Part No: 04848 (If Fitted)

Wiring Loom Installation Time: Approx 60 Mins

Issue Date 15-03-11

Page 1

Part No: 100531-WL

Hayman Reese (Cequent)
PO Box 4050, Dandenong South VIC 3164
Phone 1800 812 017 Email info@haymanreese.com.au

www.haymanreese.com.au



HAYMAN REESE
PART No: 100531-WL
RENAULT X95 MEGANE HATCH
INSTALLATION INSTRUCTIONS

PLEASE ENSURE THAT INSTRUCTIONS ARE UNDERSTOOD PRIOR TO FITMENT

1. In the luggage compartment, remove the floor cover carpet by first releasing the two retaining clips.
2. Unclip and remove the parcel shelf from the vehicle.
3. On the RHS of the luggage compartment, remove the jack tool cover and then remove the jack from the vehicle.
4. Remove the three 10mm fasteners holding the jack tray in place and then remove the jack tray from the vehicle.
5. Remove the luggage compartment rear trim.
6. Remove the LHS middle side trim by first removing the fasteners. Repeat step for the RHS.
7. Dislodge the LHS lower side trim by first removing the clip. Repeat step for the RHS.
8. From inside the vehicle cabin, remove the LHS front scuff plate and the LHS kick panel.
9. Remove the LHS rear scuff plate and dislodge the LHS 'B' pillar trim.

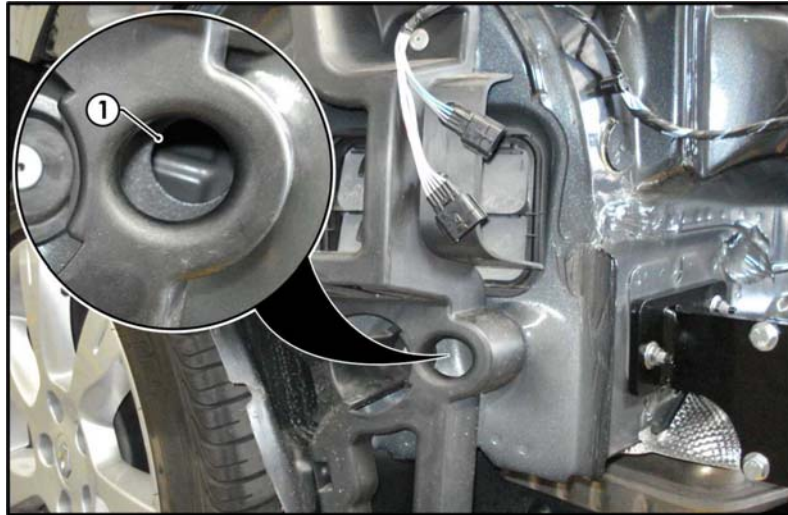

Issue Date 15-03-11

Page 2

Part No: 100531-WL

Hayman Reese (Cequent)
PO Box 4050, Dandenong South VIC 3164
Phone 1800 812 017 Email info@haymanreese.com.au

www.haymanreese.com.au



HAYMAN REESE

PART No: 100531-WL

RENAULT X95 MEGANE HATCH

INSTALLATION INSTRUCTIONS

PLEASE ENSURE THAT INSTRUCTIONS ARE UNDERSTOOD PRIOR TO FITMENT

10. From the outside of the vehicle, drill out the LHS luggage compartment hole (1) to Ø31mm.
11. File any rough or sharp edges and spray on rust inhibitor.
12. From inside the luggage compartment, locate the RHS tail light harness.
13. Following the table below, connect the ezy tap to the corresponding vehicle tail light wire then connect the trailer harness wire terminal to the ezy tap.

Function	Trailer Patch	Vehicle Connector
R.IND	GREEN / BLACK	LIGHT BROWN

14. Route the Trailer Harness (P/No: 100531-WL) along the rear of the luggage compartment and towards the LHS of the vehicle.
15. Using a multi-meter, locate the vehicle tail light signal wires from the LHS tail light harness and the reverse signal wire from the smaller LHS vehicle harness.

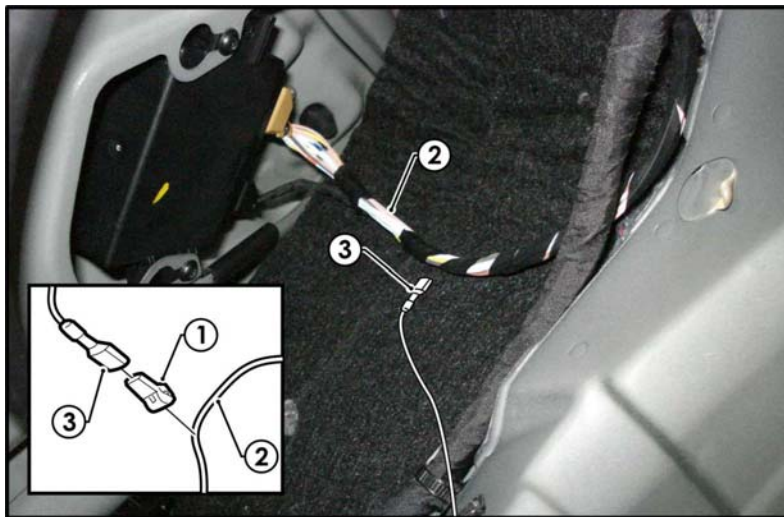

16. Following the table below, connect the ezy tap (1) to the vehicle "REVERSE" signal wire (2) and then connect the trailer harness wire terminal (3) to the ezy tap (1).

Function	Trailer Patch	Vehicle Connector
REVERSE	BLACK / WHITE	WHITE

Issue Date 15-03-11

Page 3

Part No: 100531-WL

Hayman Reese (Cequent)
 PO Box 4050, Dandenong South VIC 3164
 Phone 1800 812 017 Email info@haymanreese.com.au



HAYMAN REESE
PART No: 100531-WL
RENAULT X95 MEGANE HATCH
INSTALLATION INSTRUCTIONS

PLEASE ENSURE THAT INSTRUCTIONS ARE UNDERSTOOD PRIOR TO FITMENT

17. Following the table below, connect the ezy taps to the corresponding vehicle signal wires and then connect the trailer harness wire terminals to the ezy taps.

Function	Trailer Patch	Vehicle Connector
L.IND	GREEN / BLACK	ORANGE
TAIL	BROWN / BLACK	BLUE
BRAKES	RED / BLACK	WHITE

18. Connect the Trailer Harness 12-way connector to the ECU (04826).
19. Apply double sided tape to the ECU and adhere it to the vehicle sheet metal on the LHS of the luggage compartment.
20. Using a self tapping tech screw, secure the Trailer Harness ground ring terminal to the vehicle sheet metal on the LHS of the luggage compartment.
21. Route the Trailer Harness orange power wire along the LHS of the luggage compartment and towards the front of the vehicle.
22. Inside the vehicle cabin, open the glove compartment and remove the fuse panel cover.
23. Route the Trailer Harness orange power wire along the LHS of the vehicle, up along the kick panel area and into the glove compartment fuse panel area.
24. Using a multimeter, find a fuse location with 12v constant power. **Note: If the fuse location is occupied, first remove the vehicle fuse and insert it in the lower slot of the add-a-fuse harness.**
25. Insert the supplied 20-amp fuse into the upper slot of the add-a-fuse harness.
26. Plug the add-a-fuse harness into the fuse slot on the fuse panel.
27. Connect the 'ORANGE' power wire 1-way connector into the add-a-fuse harness mating connector.
28. Mount the trailer socket to the towbar mounting bracket using M4 fasteners (not supplied).
29. Route the tail harness across the towbar towards the LHS of the vehicle and up through the previously drilled out hole

Issue Date 15-03-11

Page 4

Part No: 100531-WL

Hayman Reese (Cequent)
PO Box 4050, Dandenong South VIC 3164
Phone 1800 812 017 Email info@haymanreese.com.au

www.haymanreese.com.au



HAYMAN REESE
PART No: 100531-WL
RENAULT X95 MEGANE HATCH
INSTALLATION INSTRUCTIONS

PLEASE ENSURE THAT INSTRUCTIONS ARE UNDERSTOOD PRIOR TO FITMENT

30. Ensure the tail harness grommet is seated correctly and secure in place using a cable tie (not supplied).
31. Test the Trailer Harness function using a Light Board or multi-meter.
32. Secure all Harnesses using cables ties (not supplied).
33. Re-fit all removed parts and secure all fasteners, ensuring there are no squeaks or rattles.
34. Place the instructions in the glove box after fitment.

Issue Date 15-03-11

Page 5

Part No: 100531-WL

Hayman Reese (Cequent)
PO Box 4050, Dandenong South VIC 3164
Phone 1800 812 017 Email info@haymanreese.com.au

www.haymanreese.com.au

