

MAZDA 3 (BM)

5-Door 10/13 - 07/16

4-Door 10/13 - 07/16

Mazda 3 (BN)

08/16 >>

08/16 >>

Part No. 750005

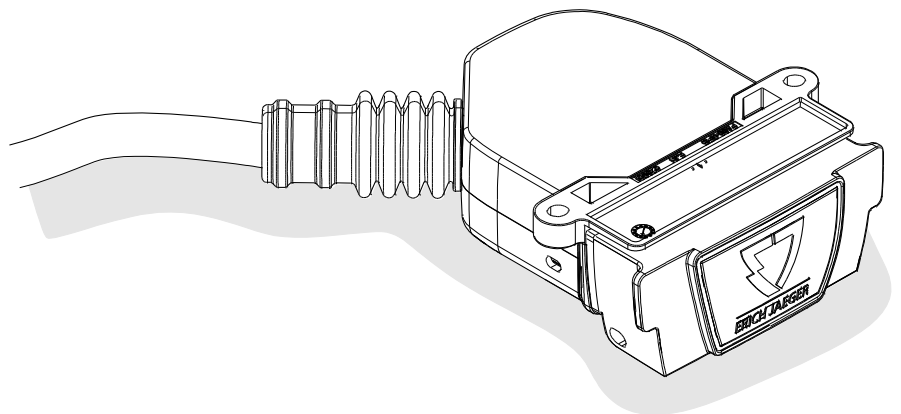

Installation instructions

Reference:

The following information must be reviewed before beginning the assembly:

The installation instructions are to be thoroughly read.

The installation should be carried out by qualified personnel with the relevant technical knowledge. The vehicle manufacturers' current technical notices and information on retrofitting must be followed. The removal and replacement instructions found in the current repair manuals must be followed.

It must be ensured that the vehicle is technically suitable for the installation of a trailer hitch.

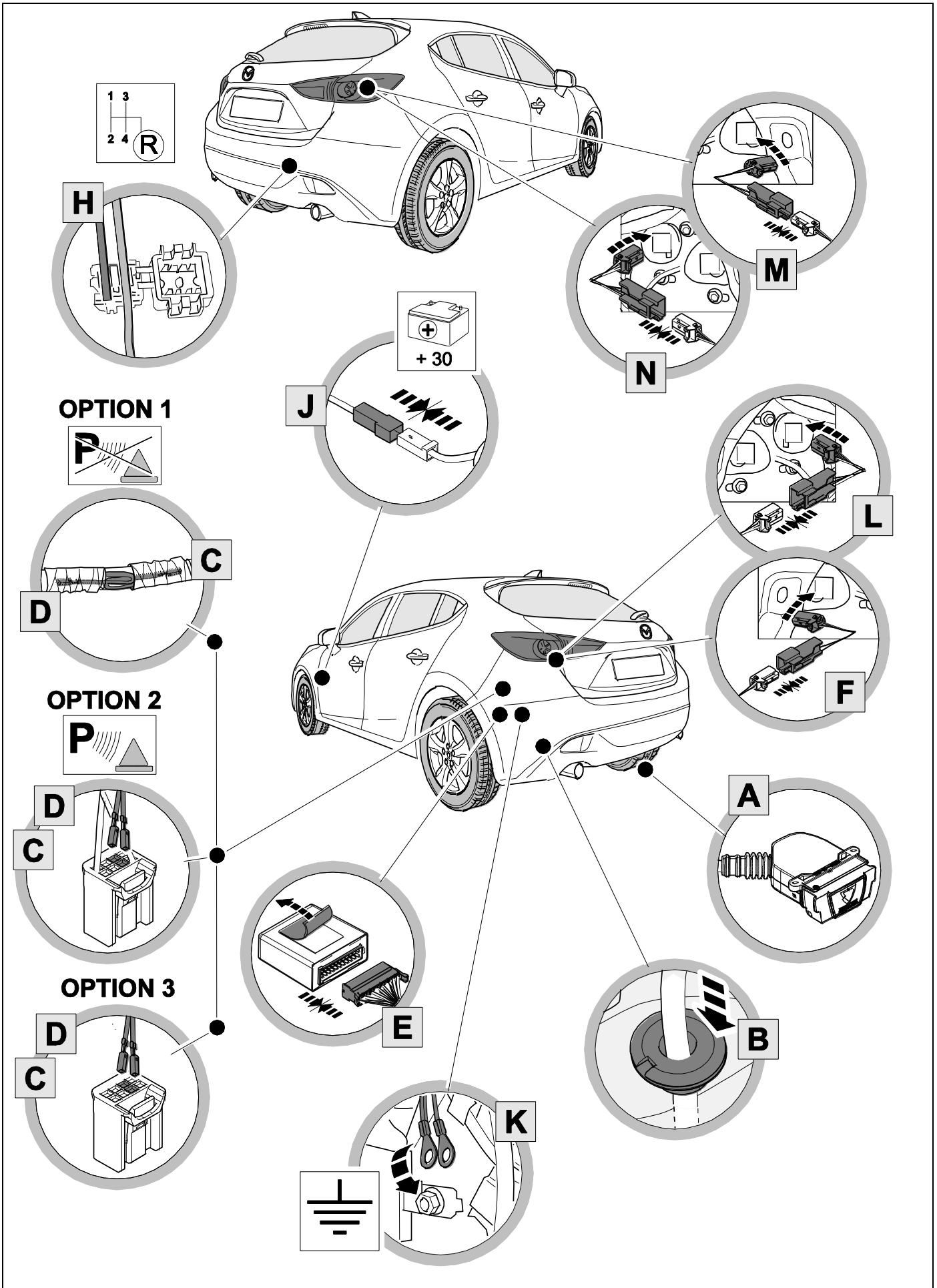

KIT

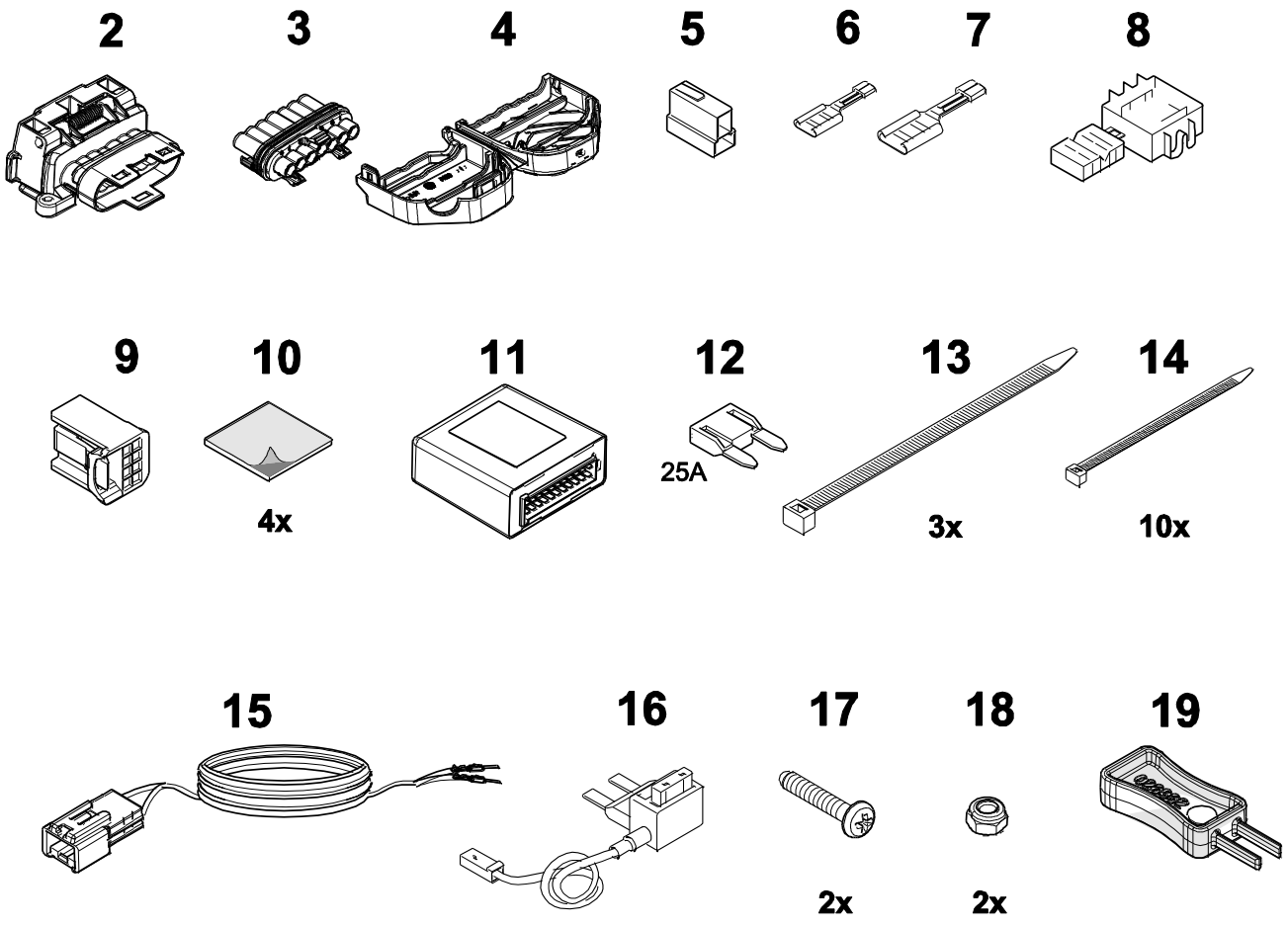
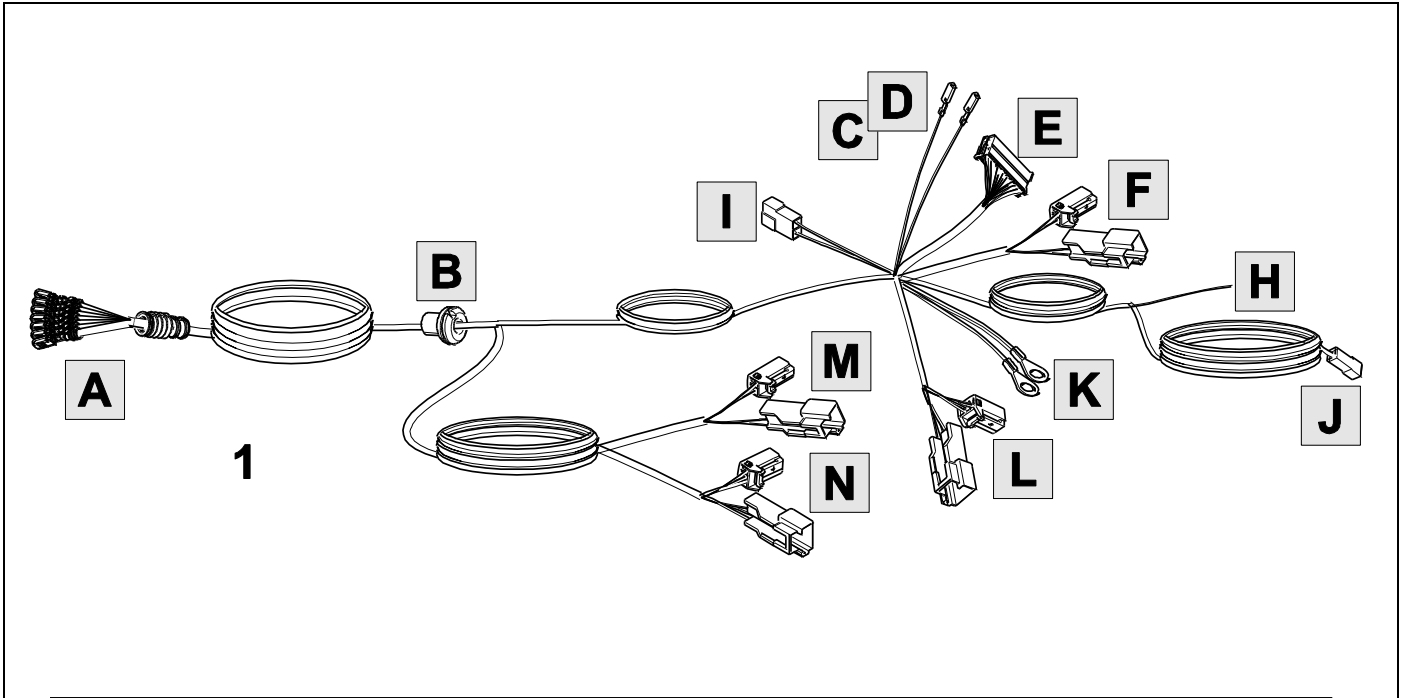

TOOLS

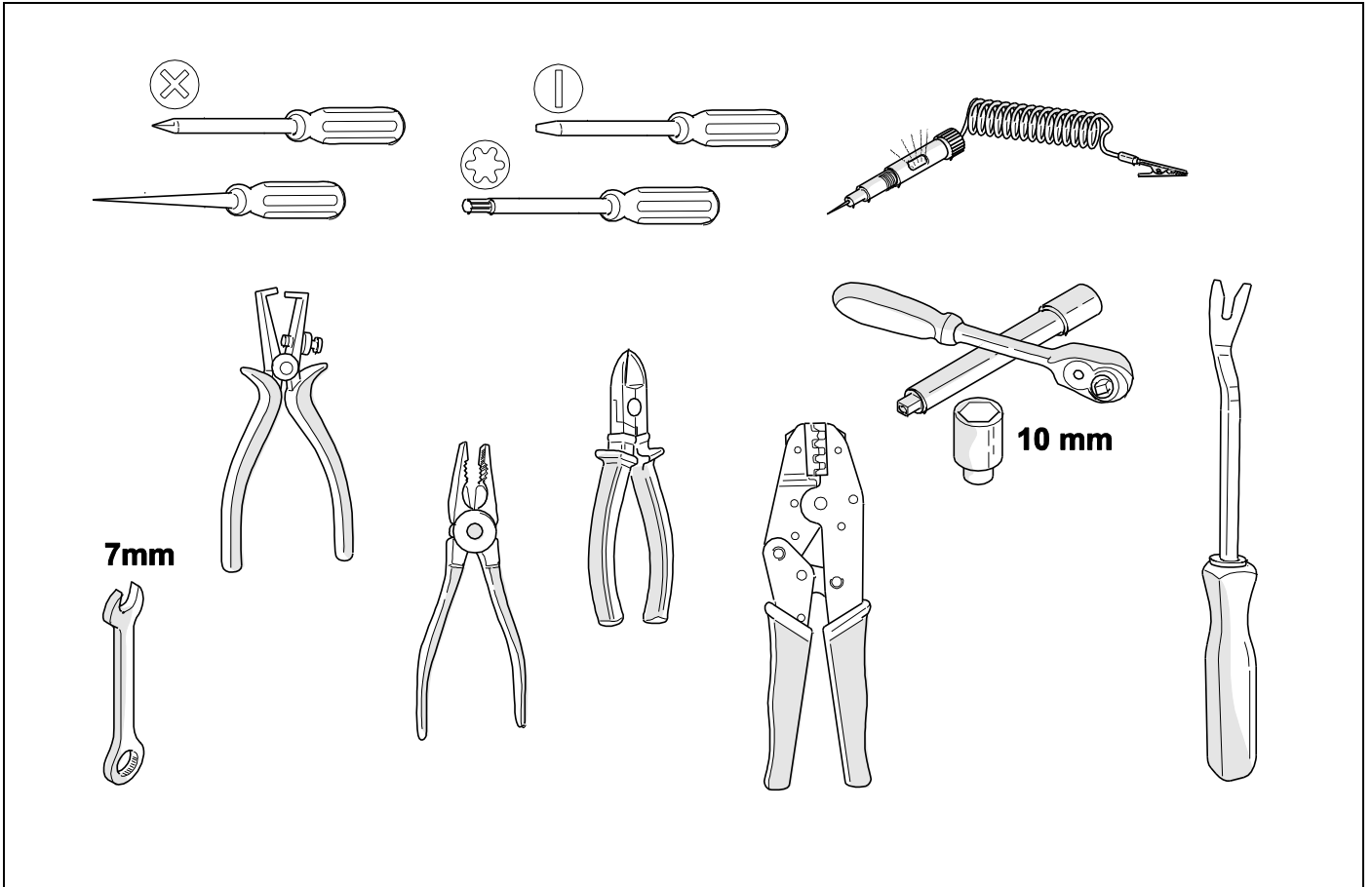

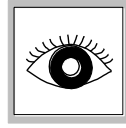
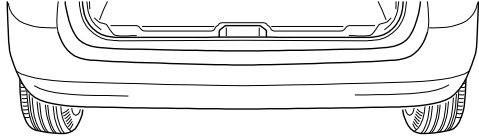
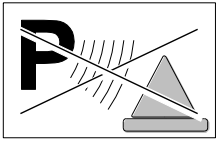
(BM) Vehicle without PDC (10/13-07/16)**OPTION 1**

1 - 13

21 - 34

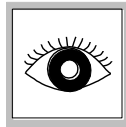
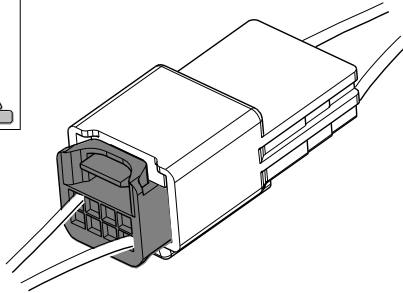
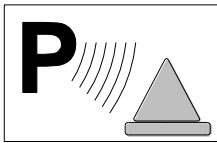
(BM) Higher Spec Vehicles (10/13-07/16)**OPTION2**

1 - 12

14 + 15

21 - 34

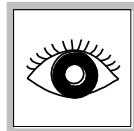
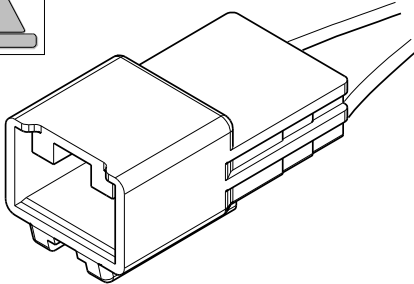
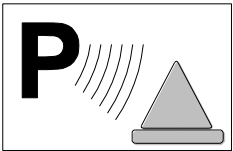
(BM) Base Models (10/13-07/16)**OPTION3**

1 - 12

16 + 17

21 - 34

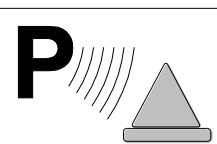
(BN) Models (08/16 >>)

15

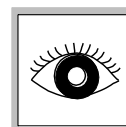
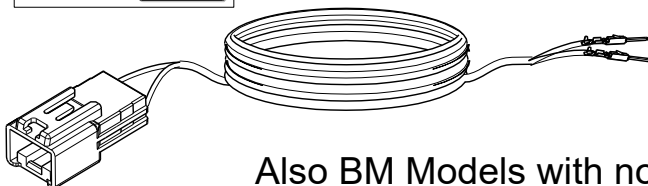
**OPTION 4**

1 - 12

18 - 34

Also BM Models with no matching connections in the connector on the vehicle side.

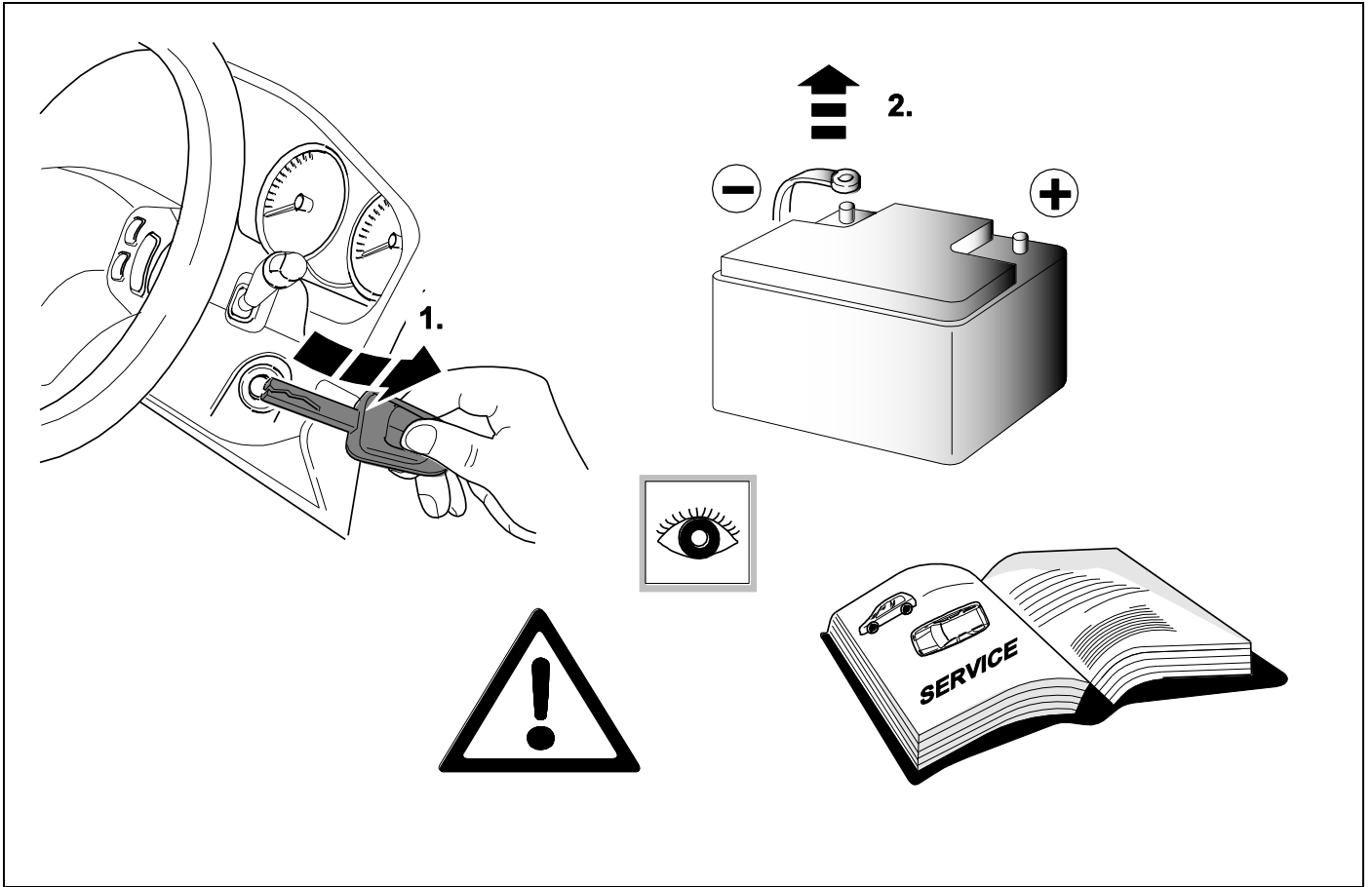

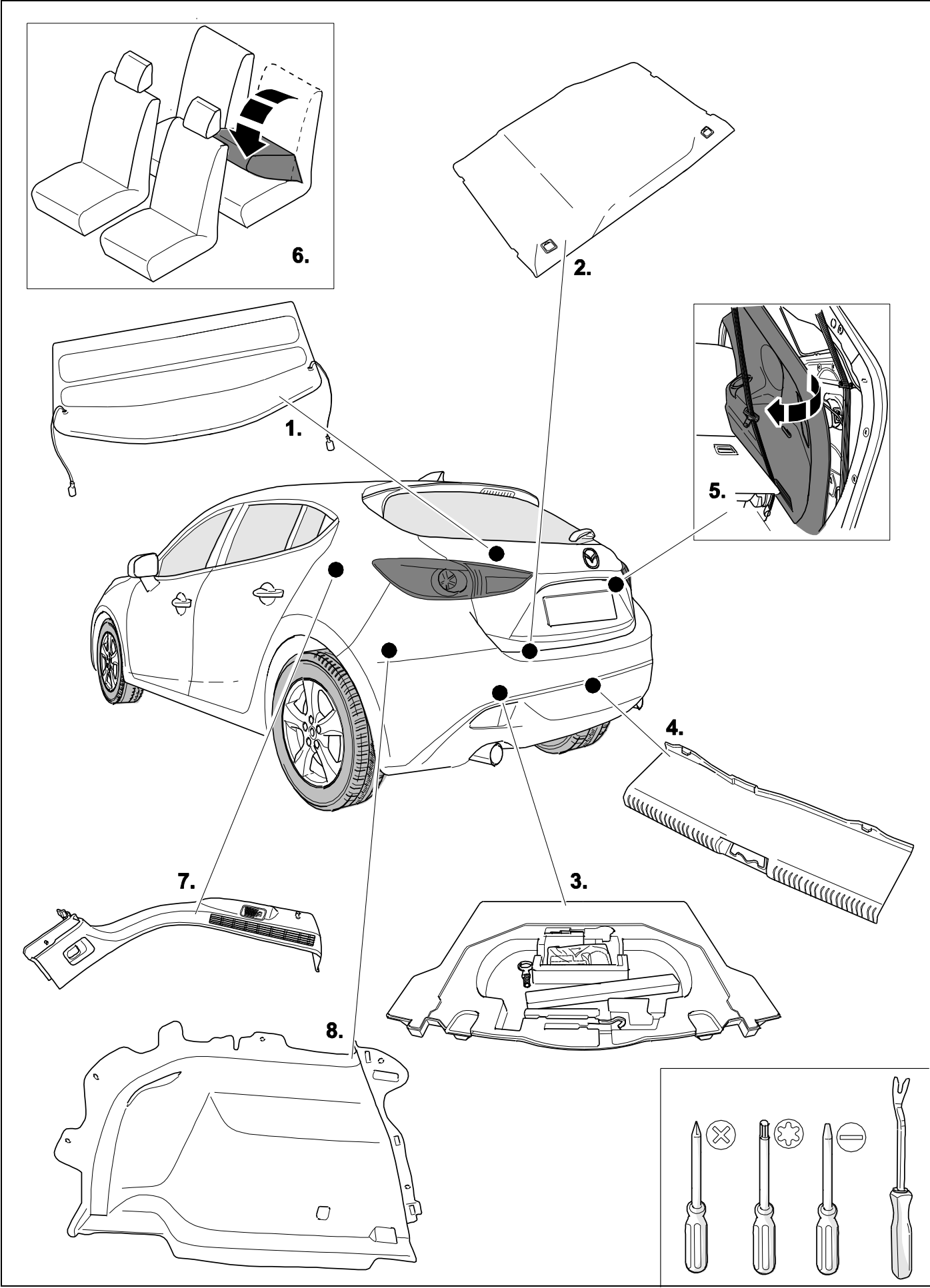

4

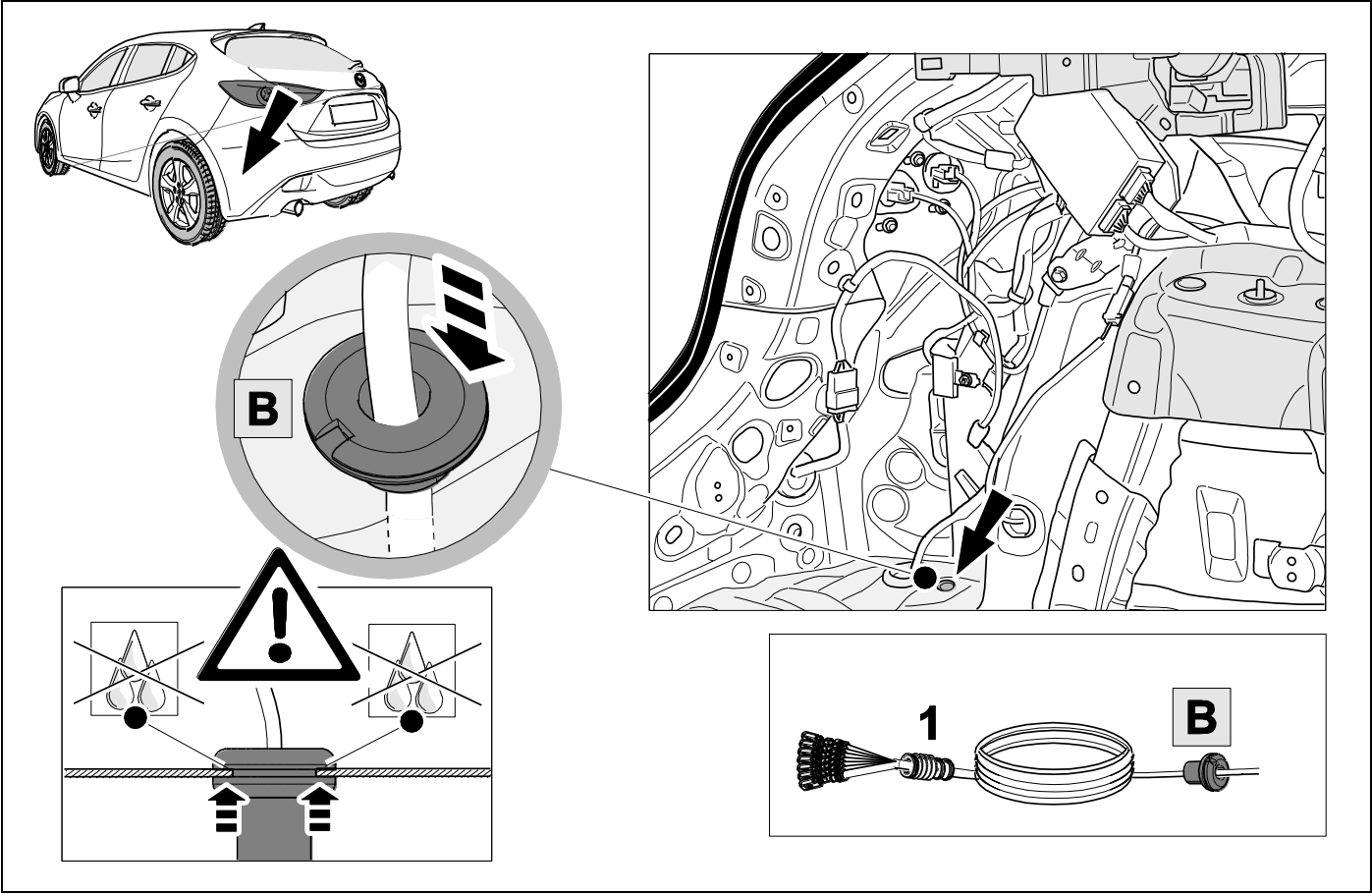

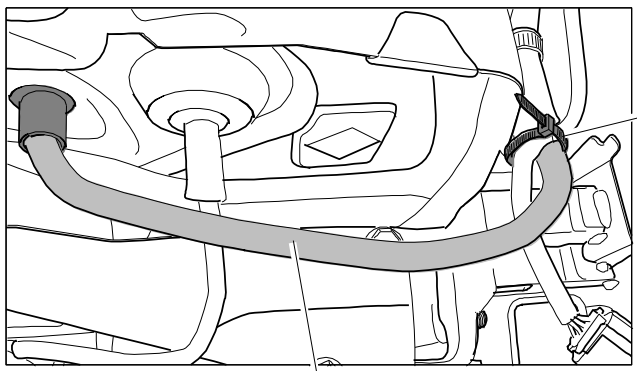
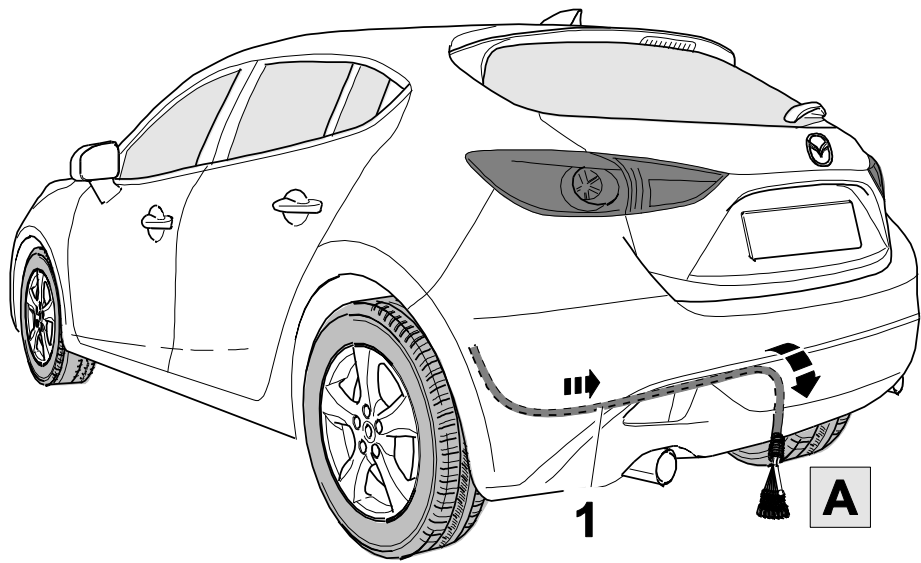

13

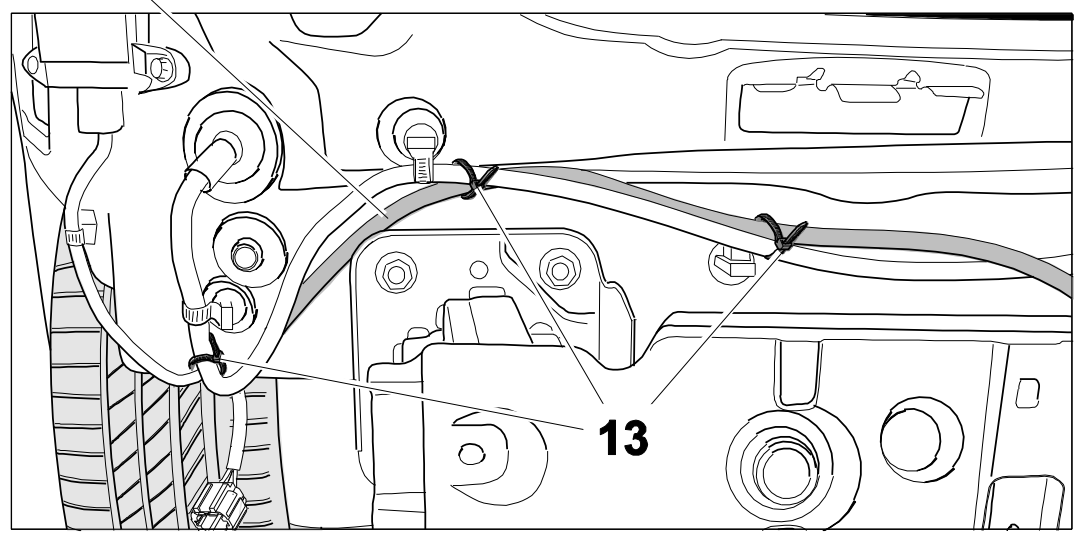
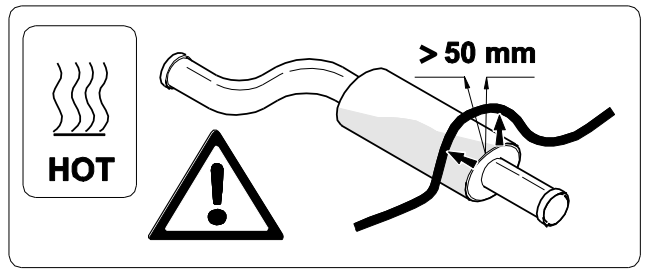

13

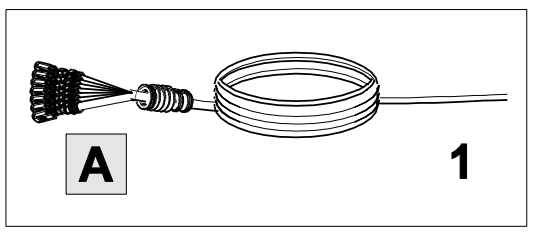
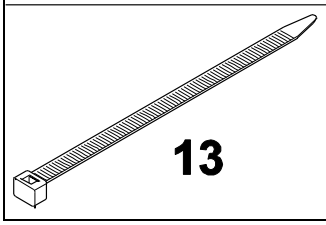

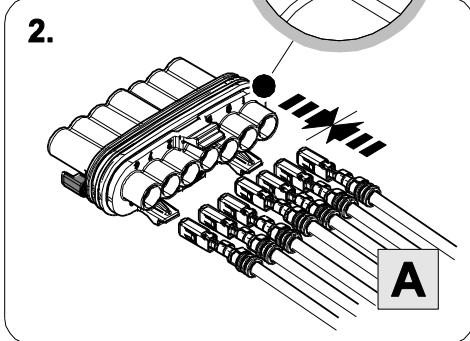
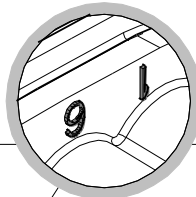
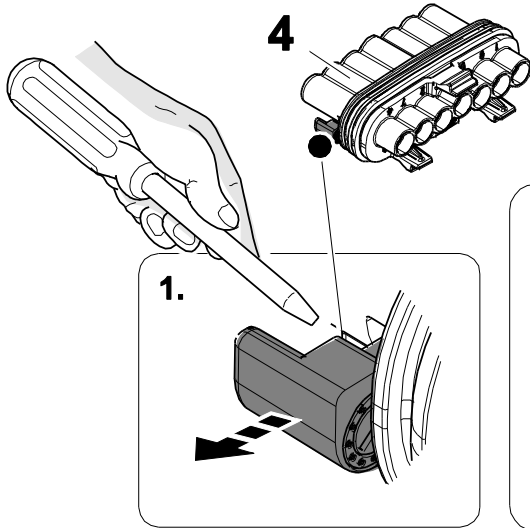

ye	1	
rd	6	
bu	5	
wh	3	
bk	2	
bn	7	
gn	4	

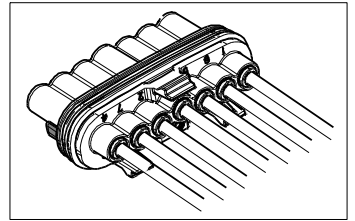
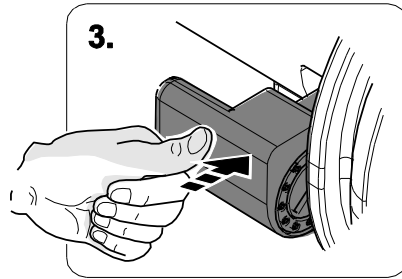
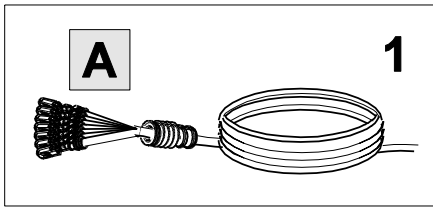

In case of wrong pin insert:

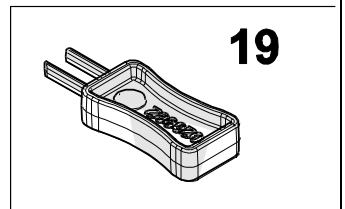
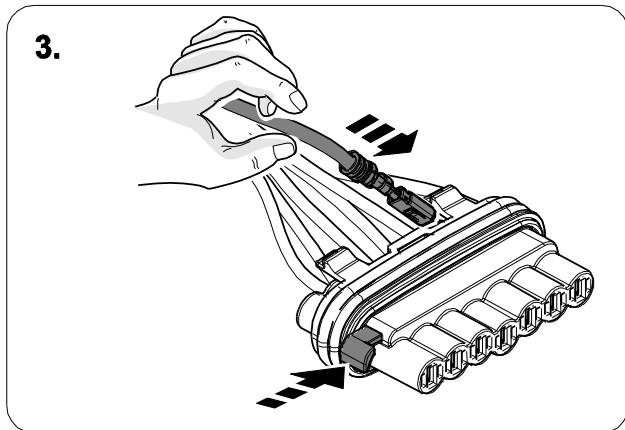
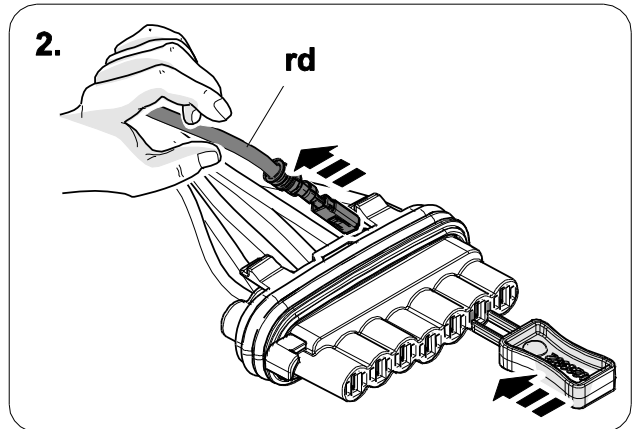
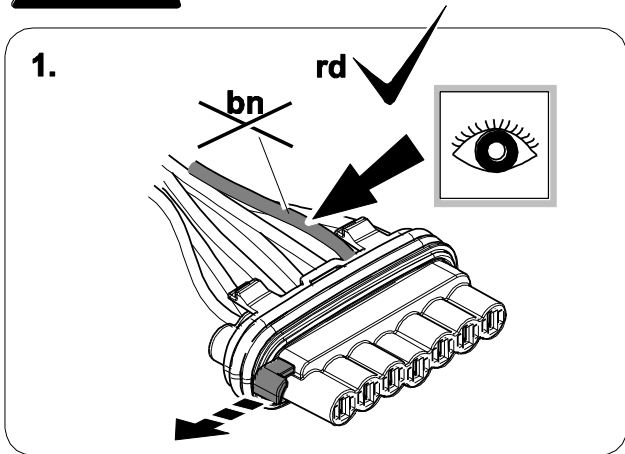

7



8

1.

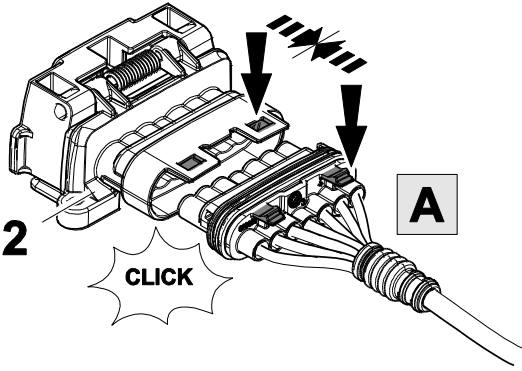

2.

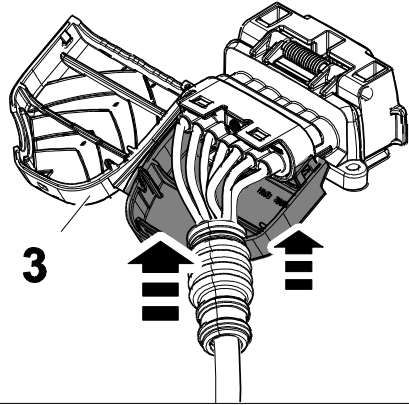

3.

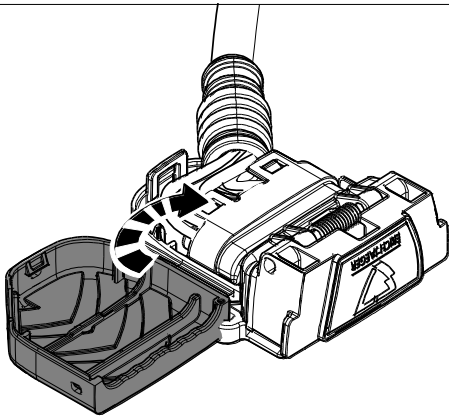

4.

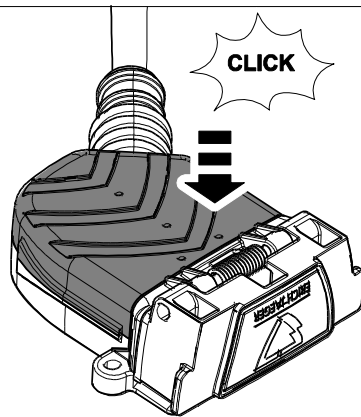

2

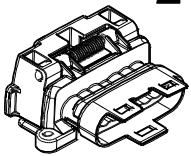

3

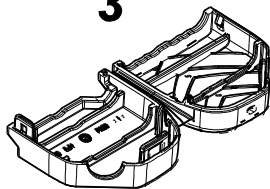

SCAN to WATCH



8



9

1

ye



2

bk



3

wh



4

gn



5

bu

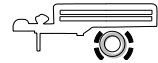

6

rd



7

bn



9	bk	wh	gy	gn	rd	bu	ye	bn	pu	or	no
----------	-----------	-----------	-----------	-----------	-----------	-----------	-----------	-----------	-----------	-----------	-----------

GB	black	white	grey	green	red	blue	yellow	brown	purple	orange	not occupied
-----------	-------	-------	------	-------	-----	------	--------	-------	--------	--------	--------------

10

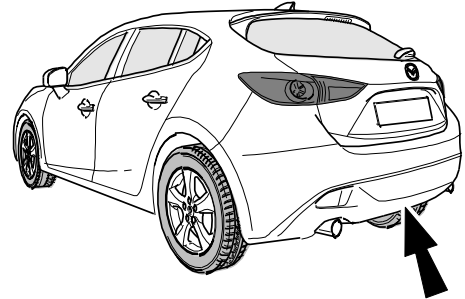
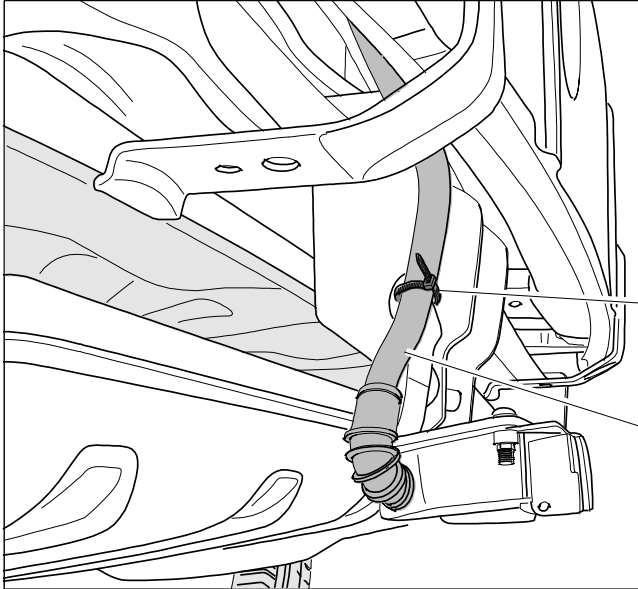

13
1

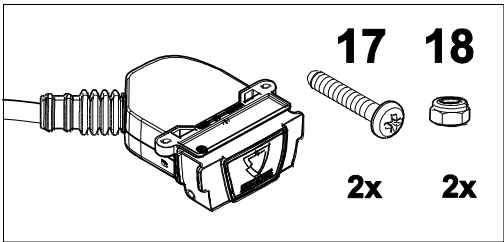
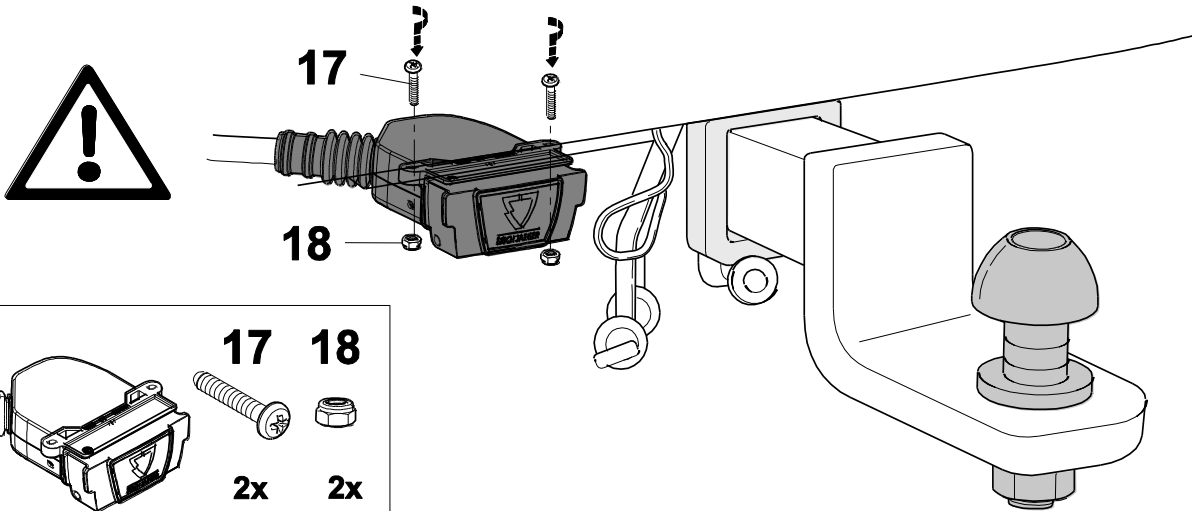

11

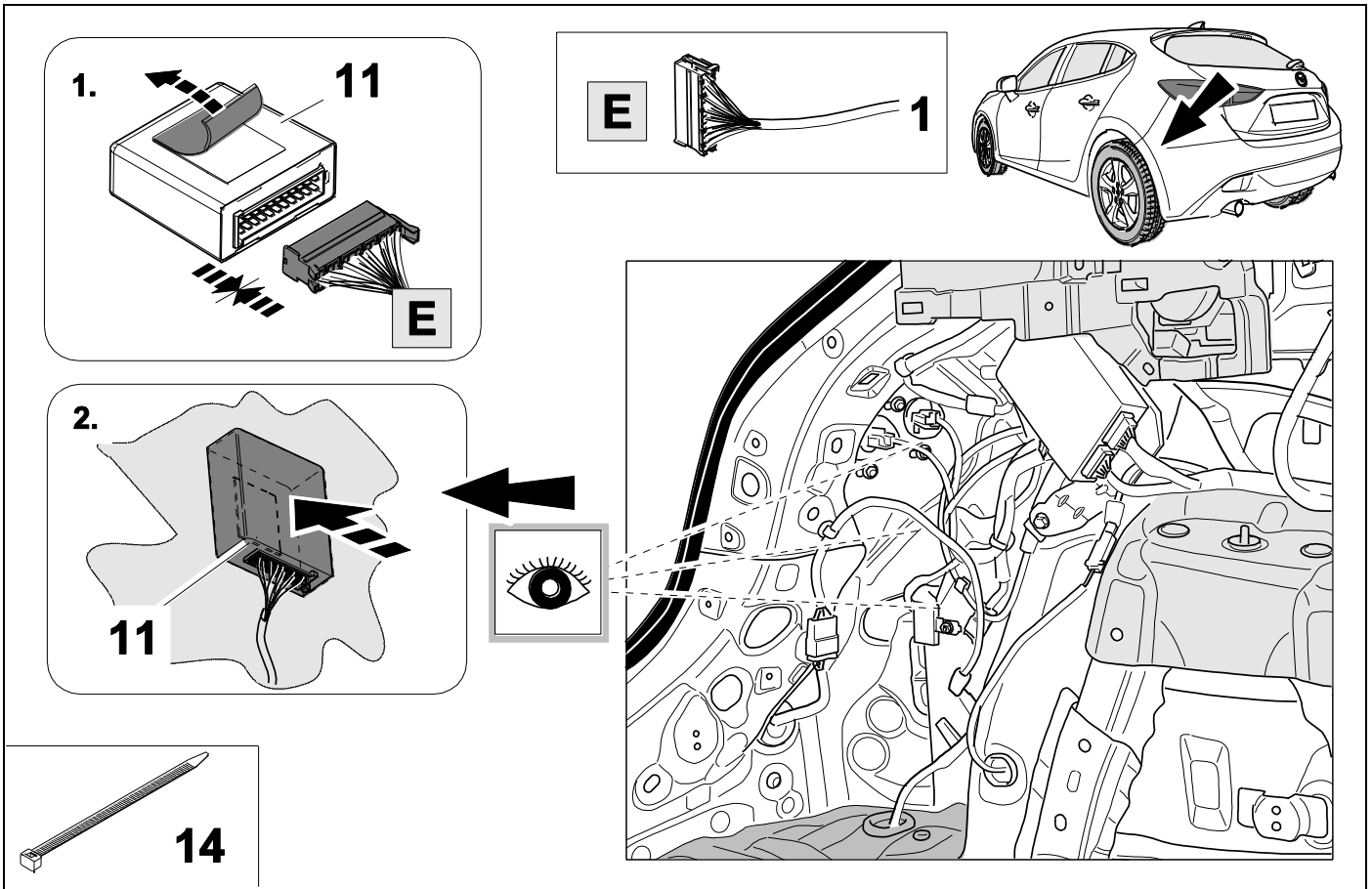

12

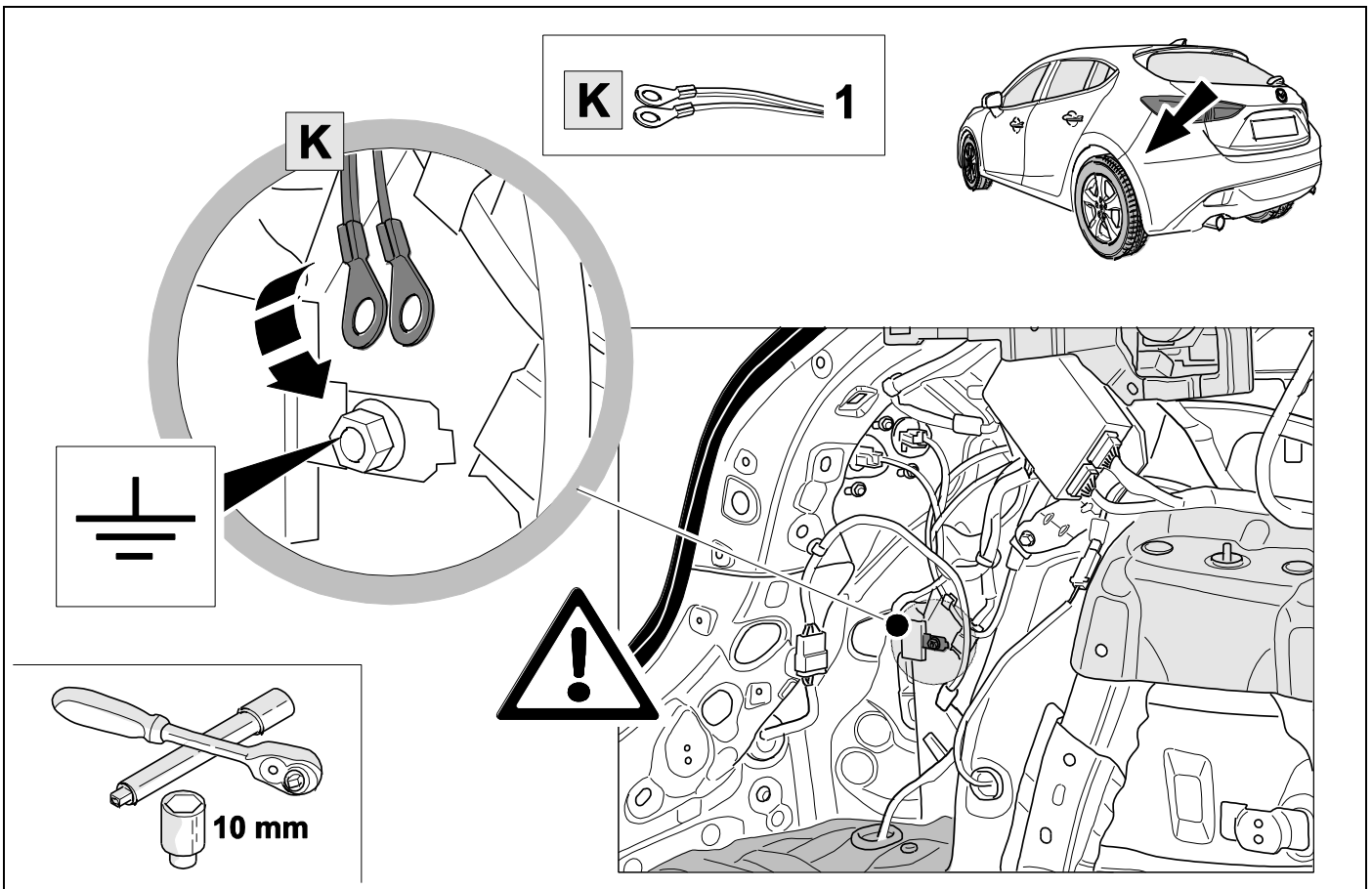

13 OPTION 1 – Vehicles without PDC

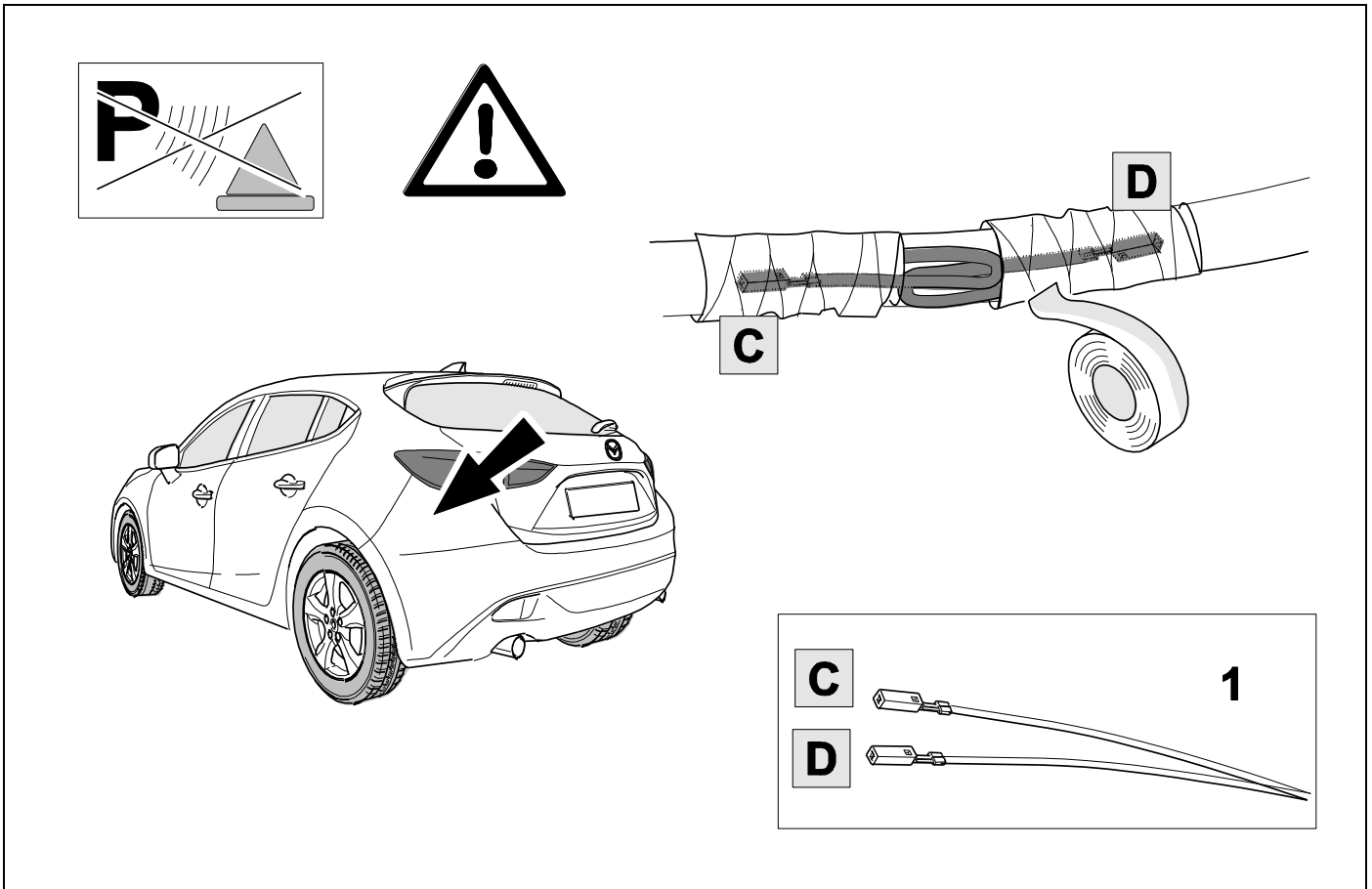

14 OPTION 2 – (BM) Higher Spec. Vehicles (10/13 – 07/16)

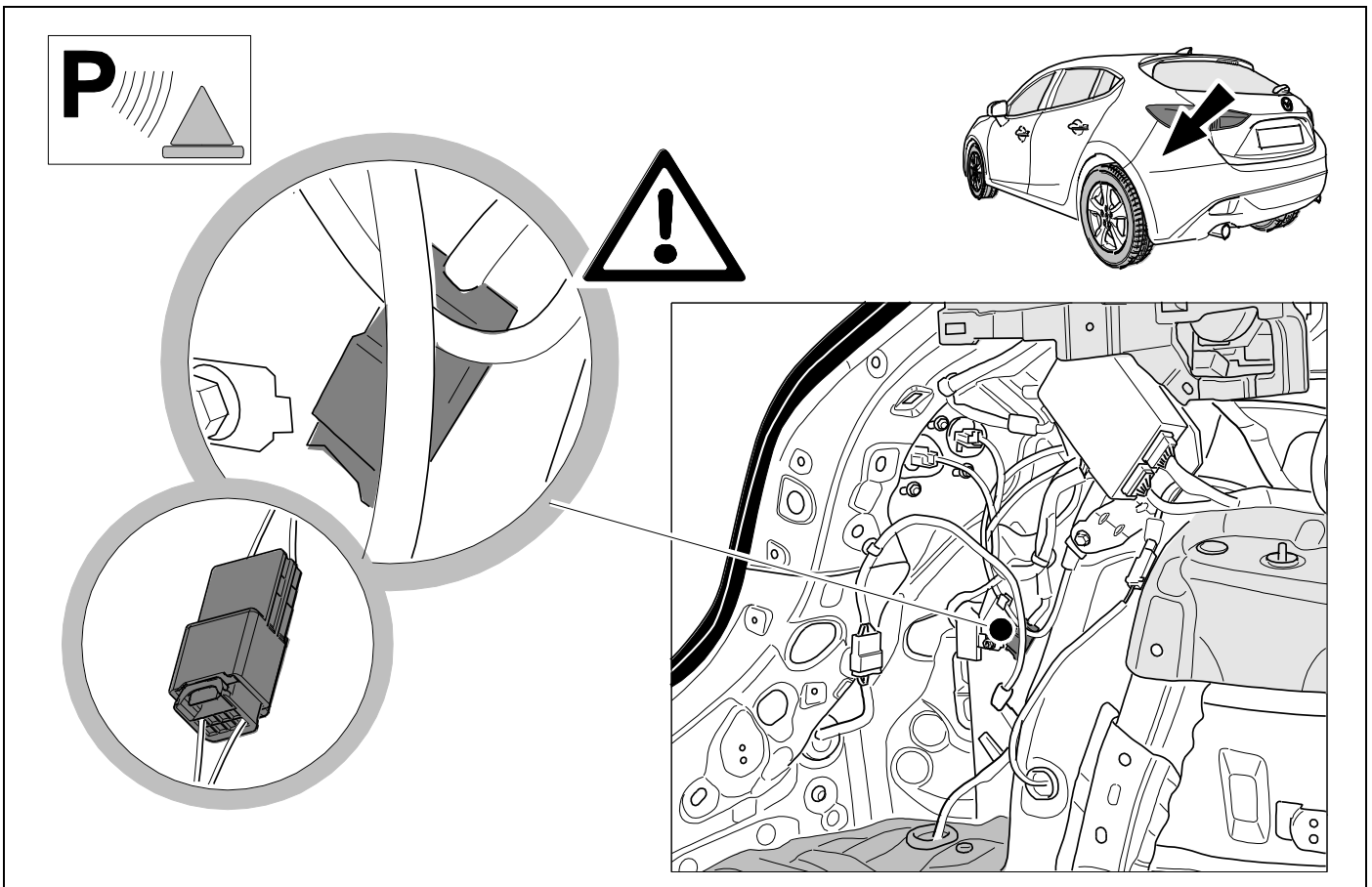

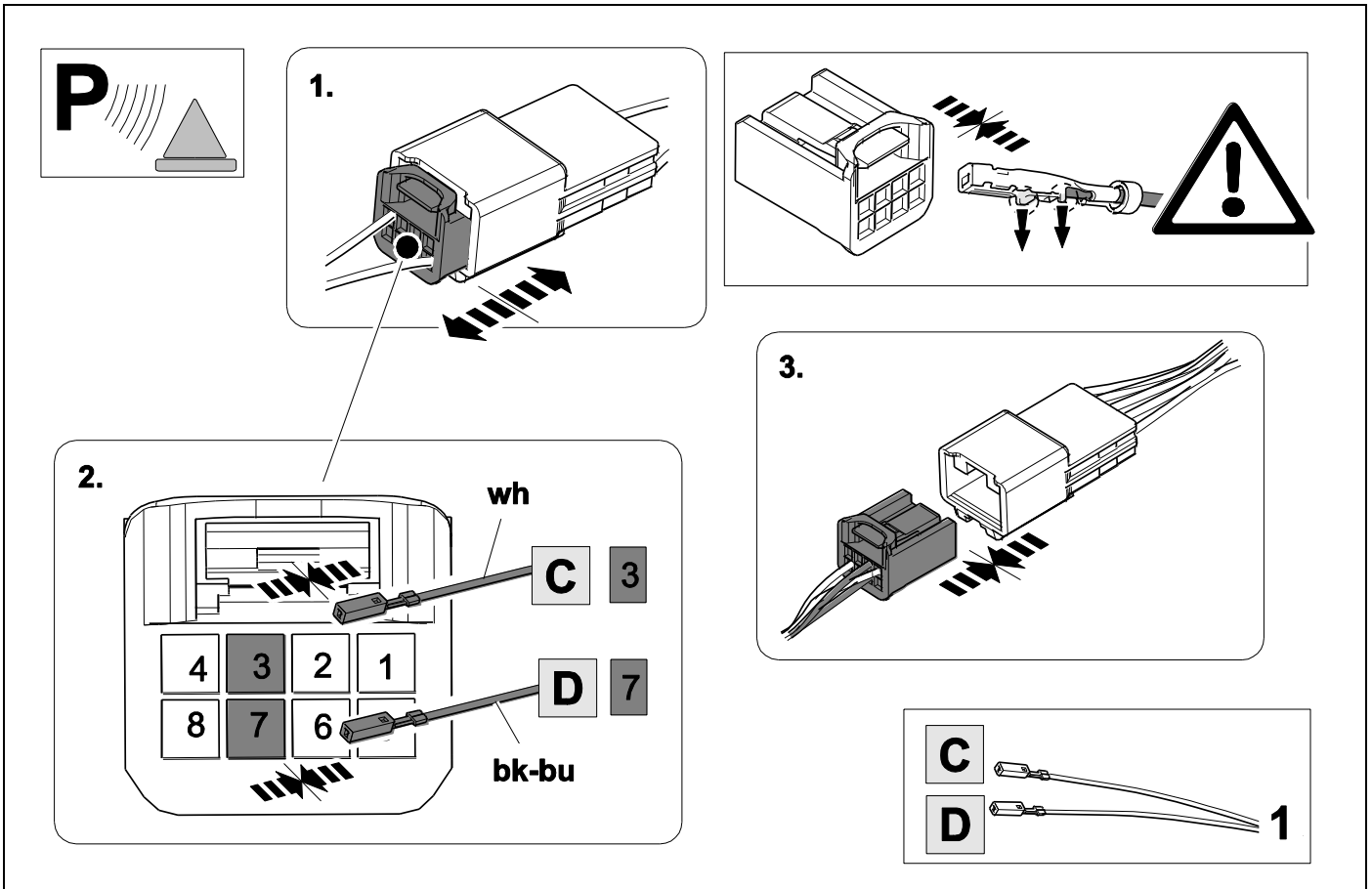

16 OPTION 3 – (BM) Base Models (10/13 – 07/16)

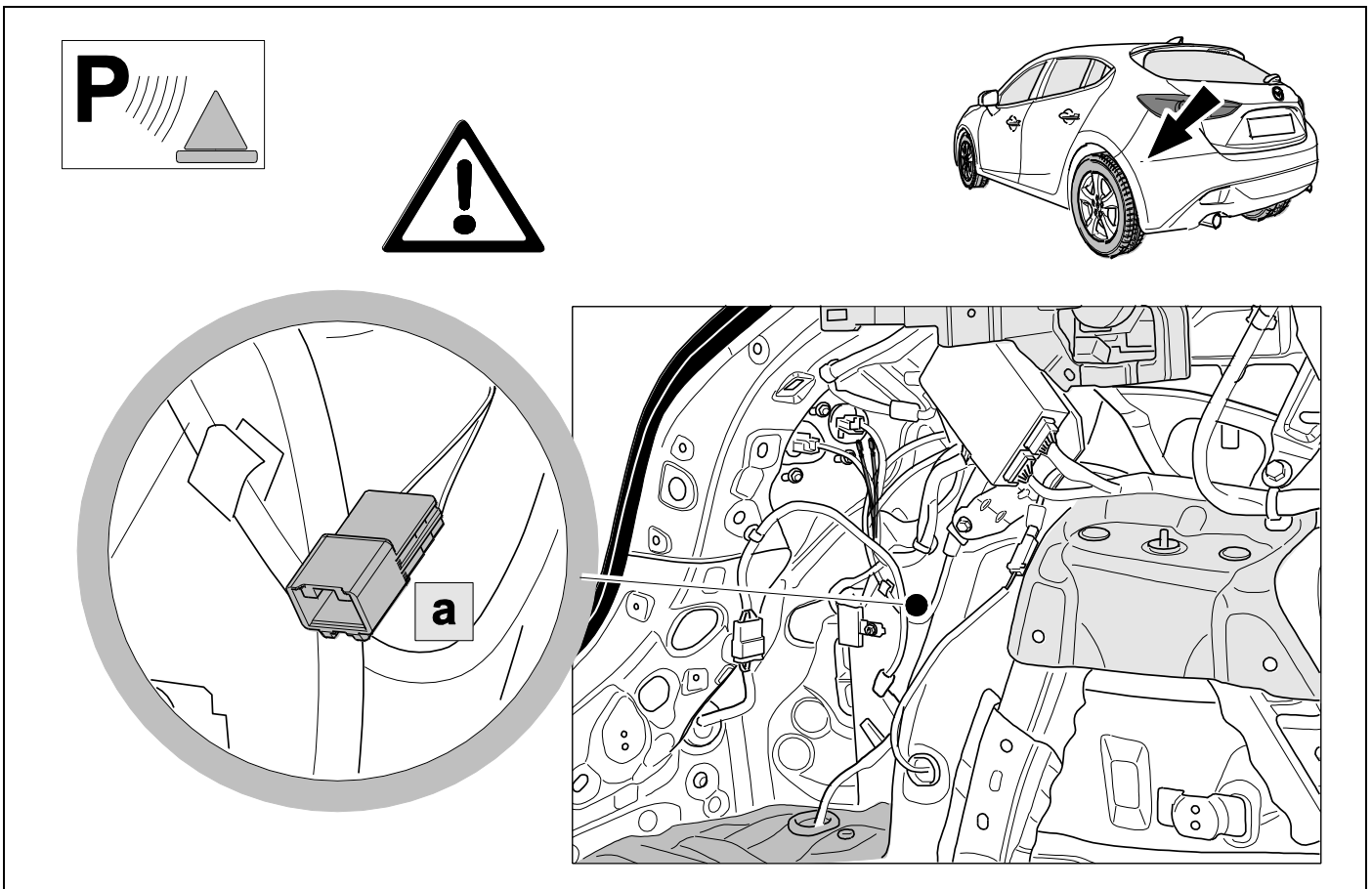

17 OPTION 3



9

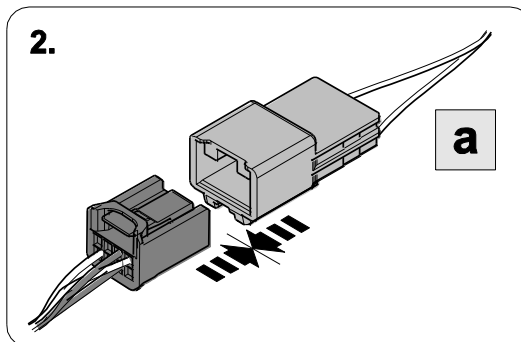
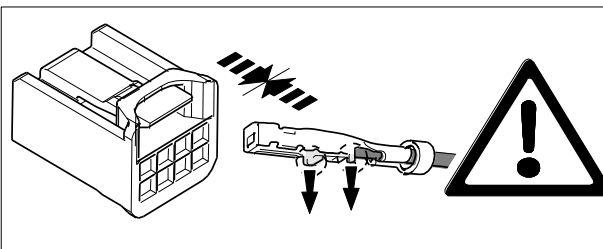
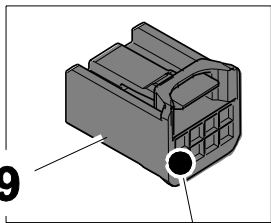
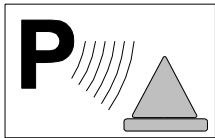

1.

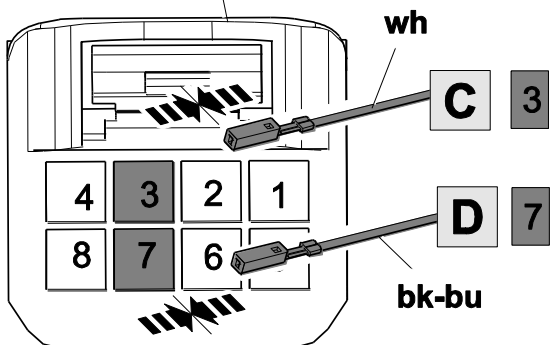

Use white connector included in kit.

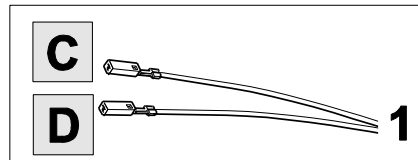

18 OPTION 4



9

(BN) Models 08/16 >>

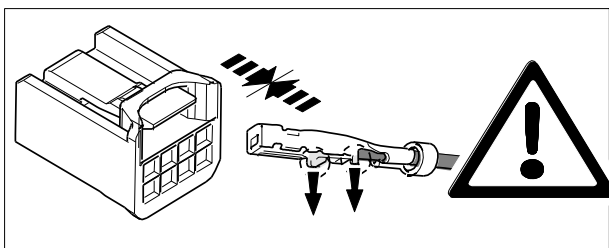
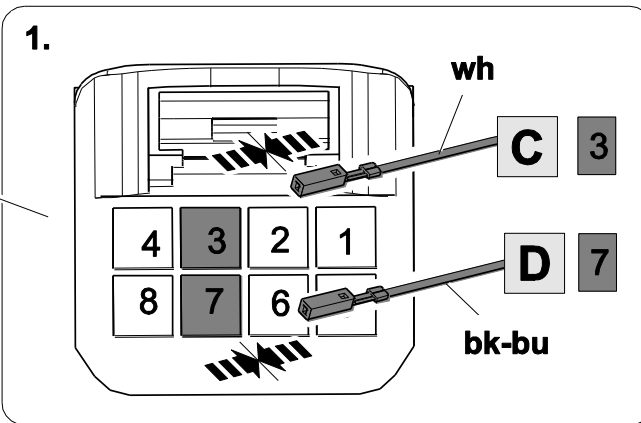
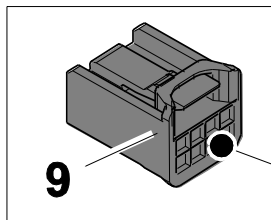
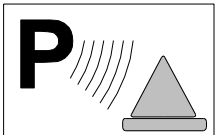

Use white connector included in kit.

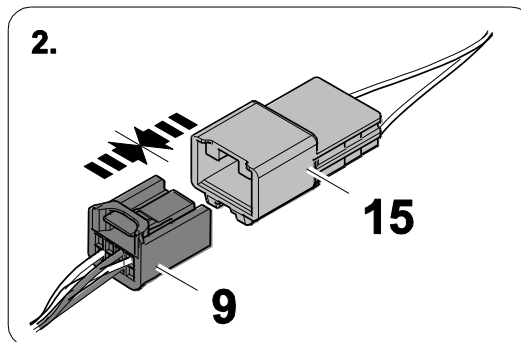
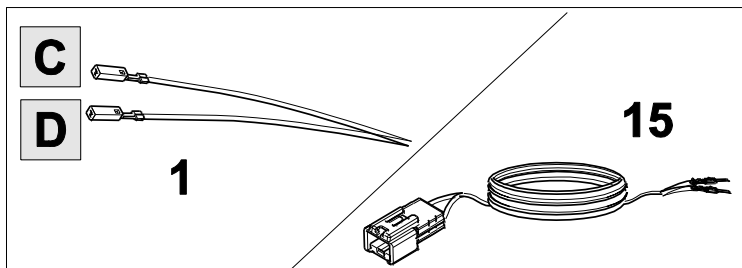

19 OPTION 4

(BN) Models 08/16 >>

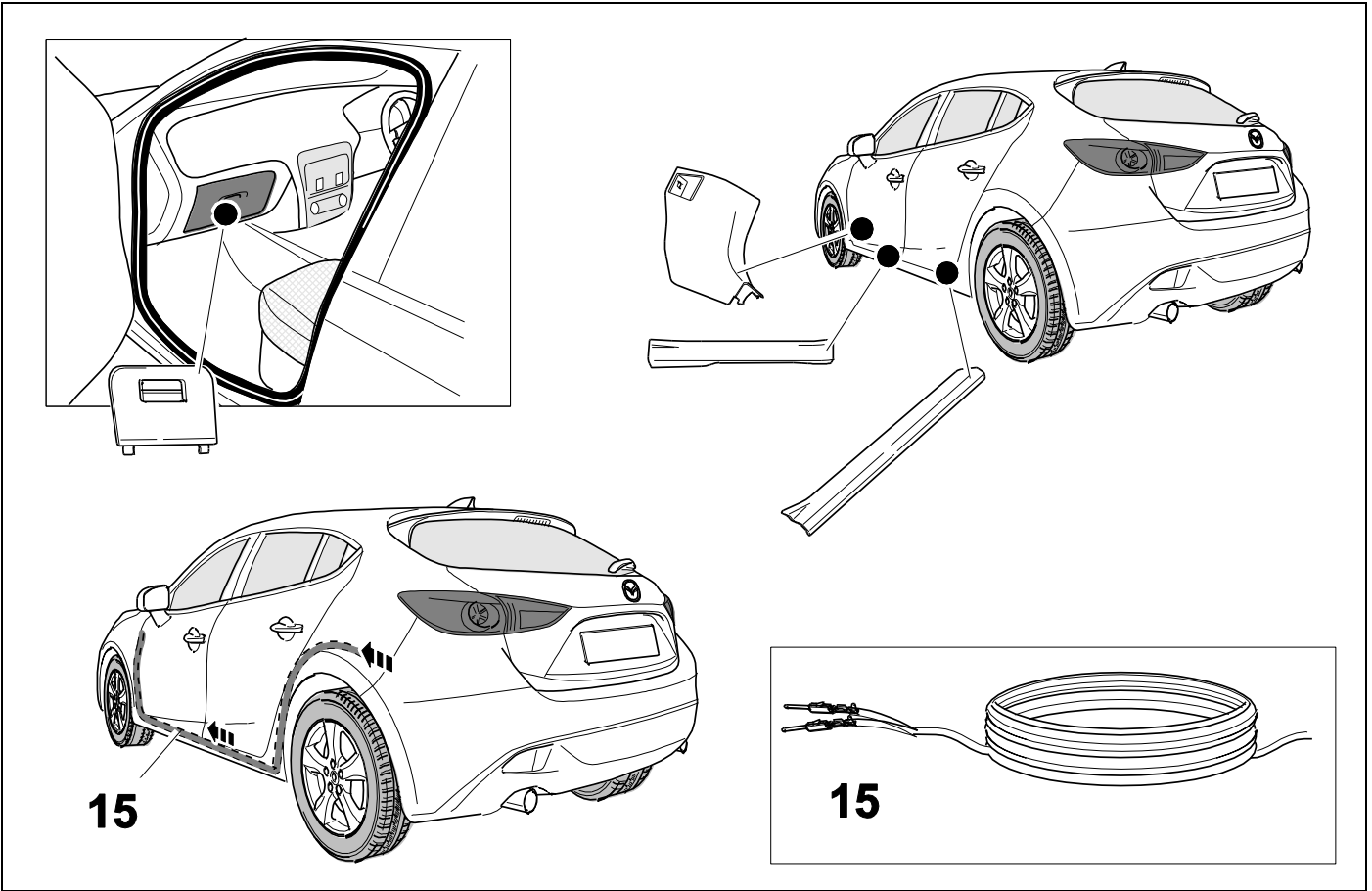

20 OPTION 4



(BN) Models 08/16 >>

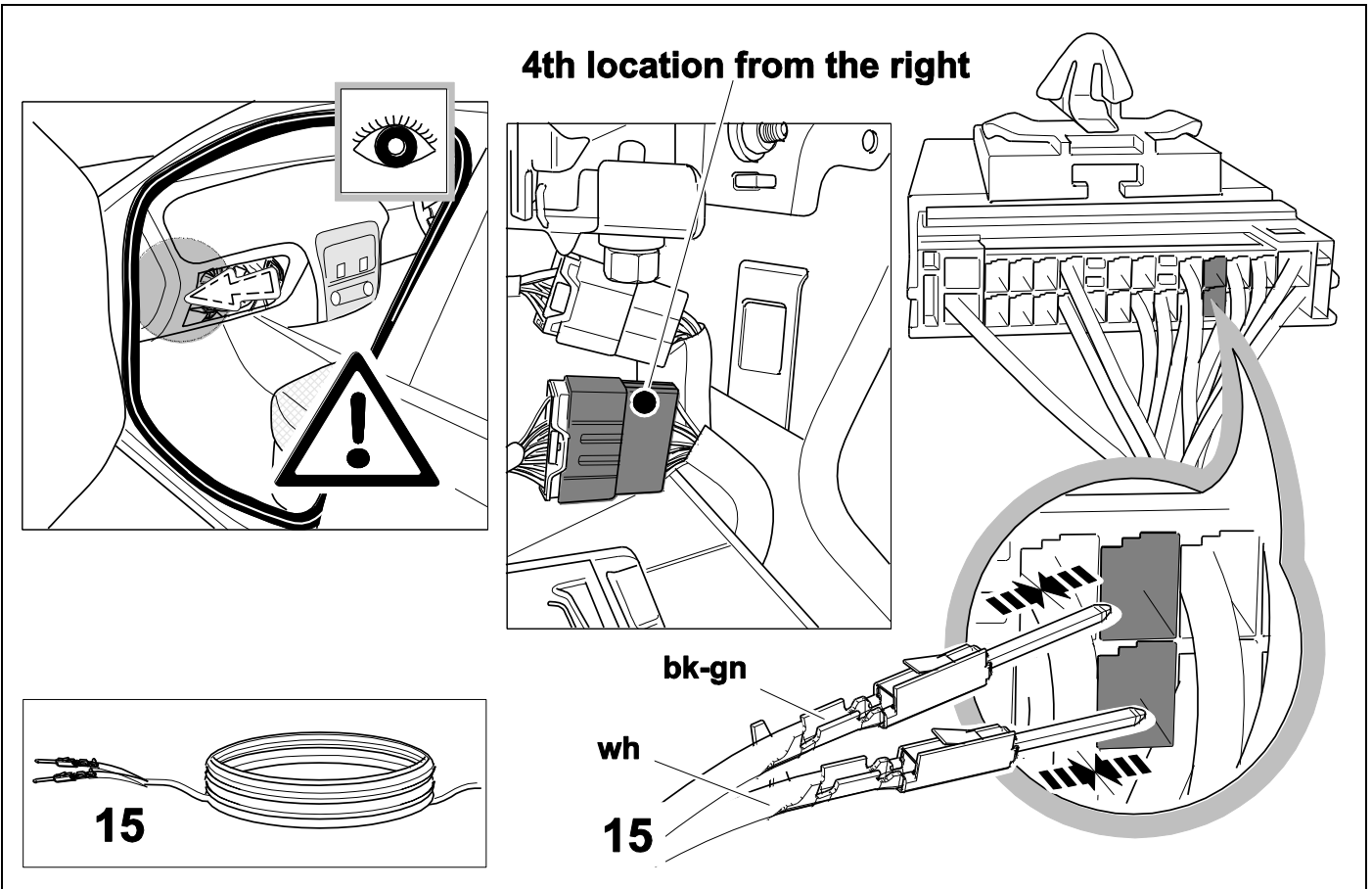

21

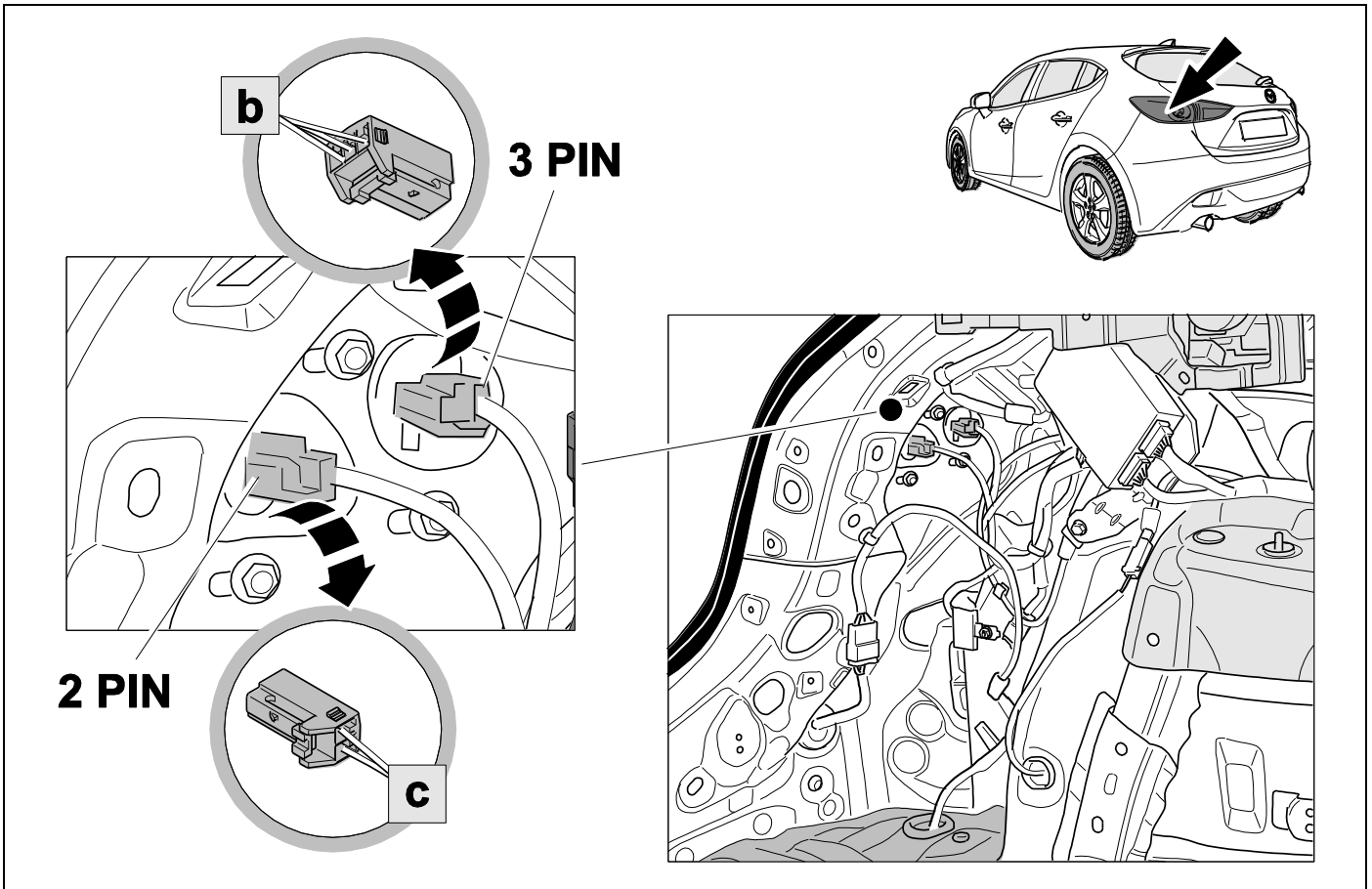

22

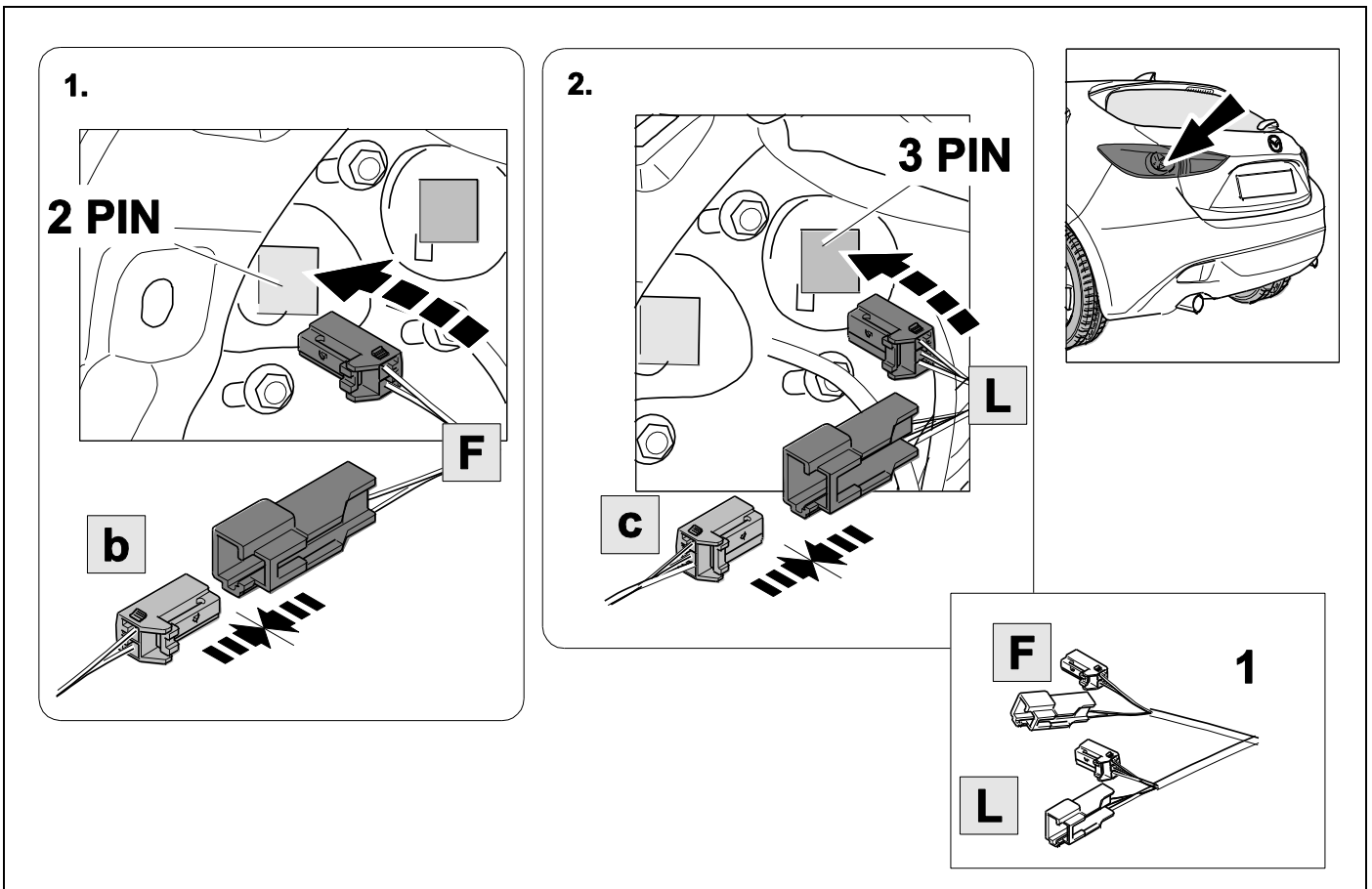

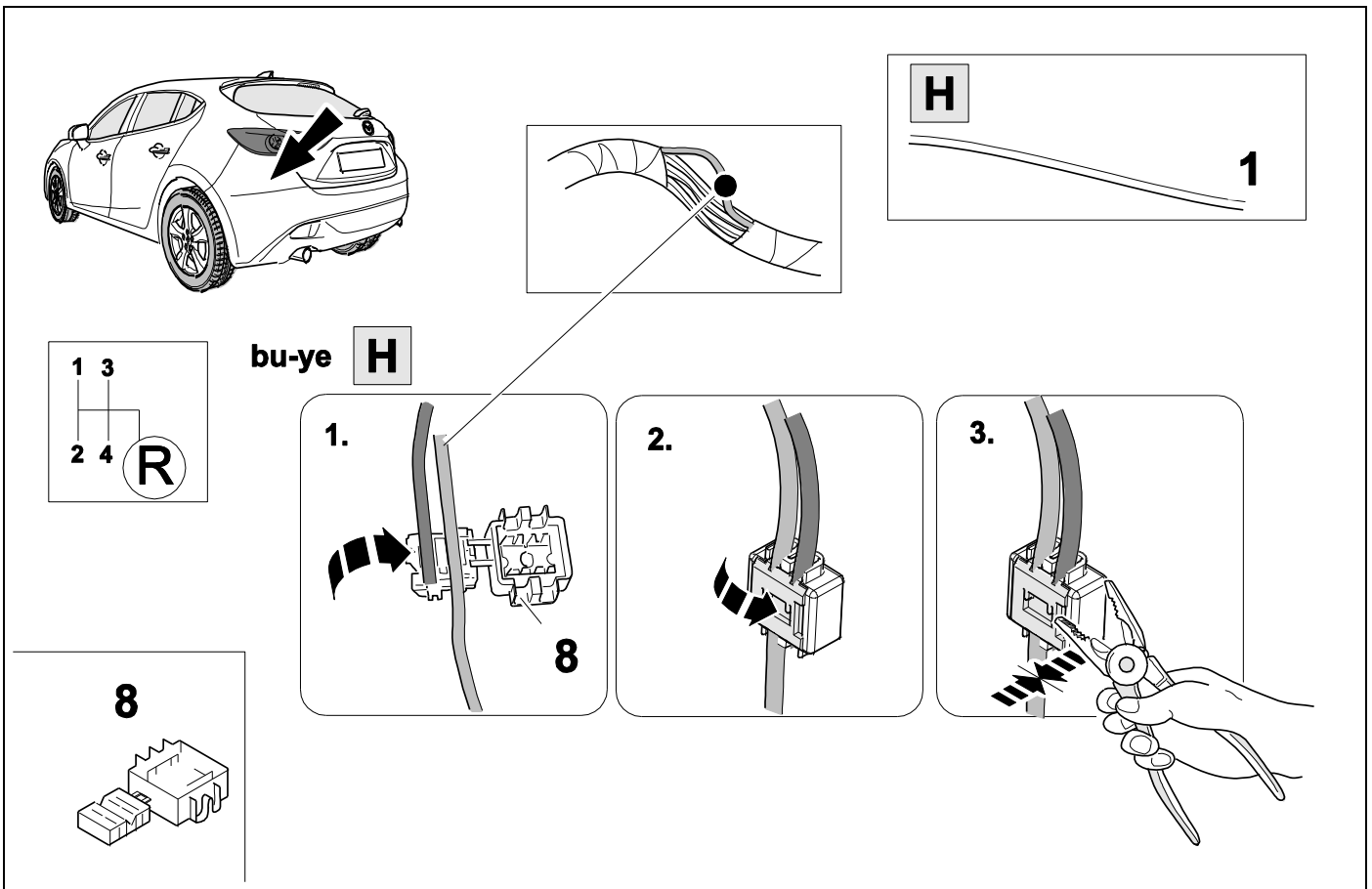
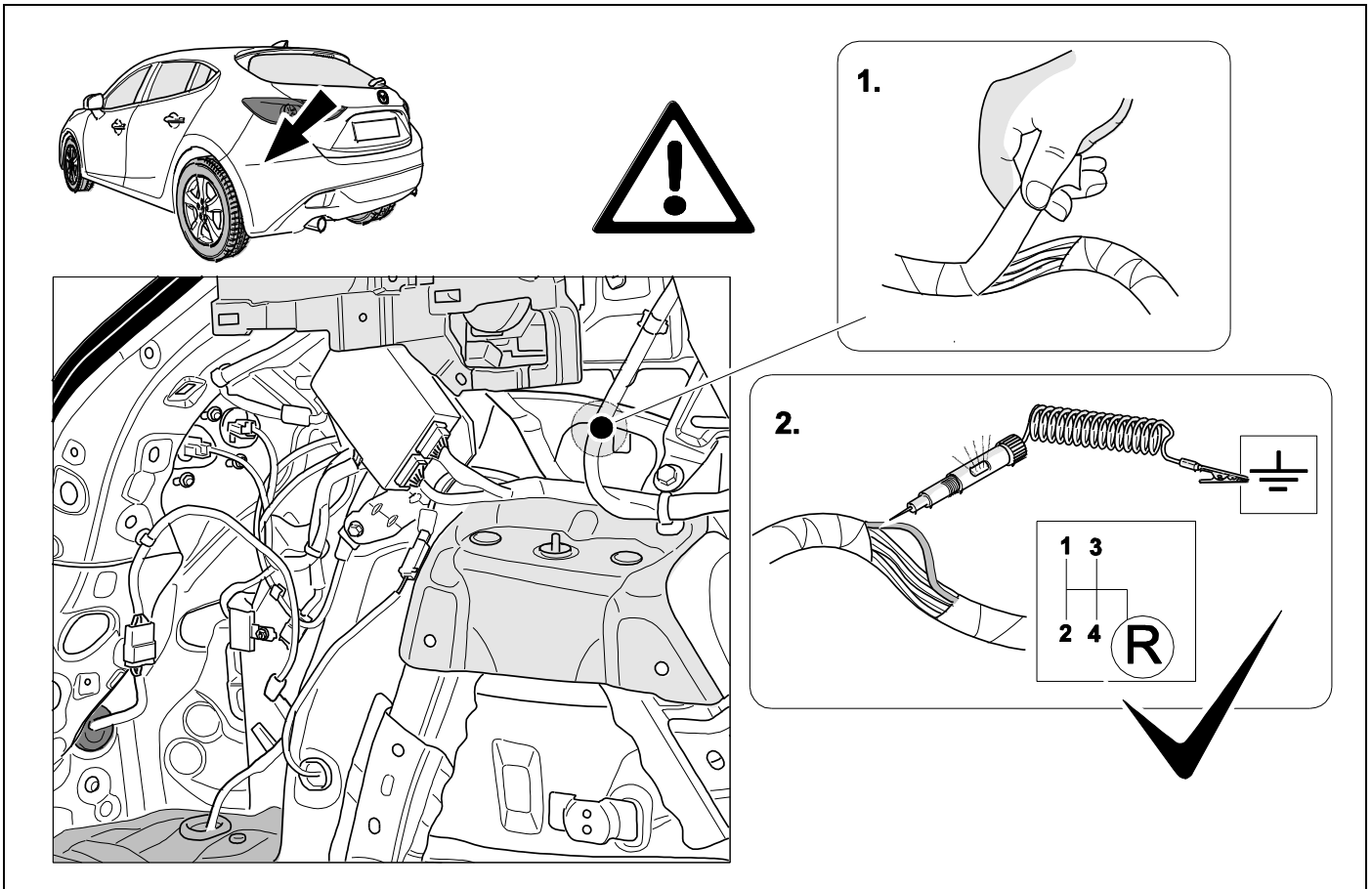

25

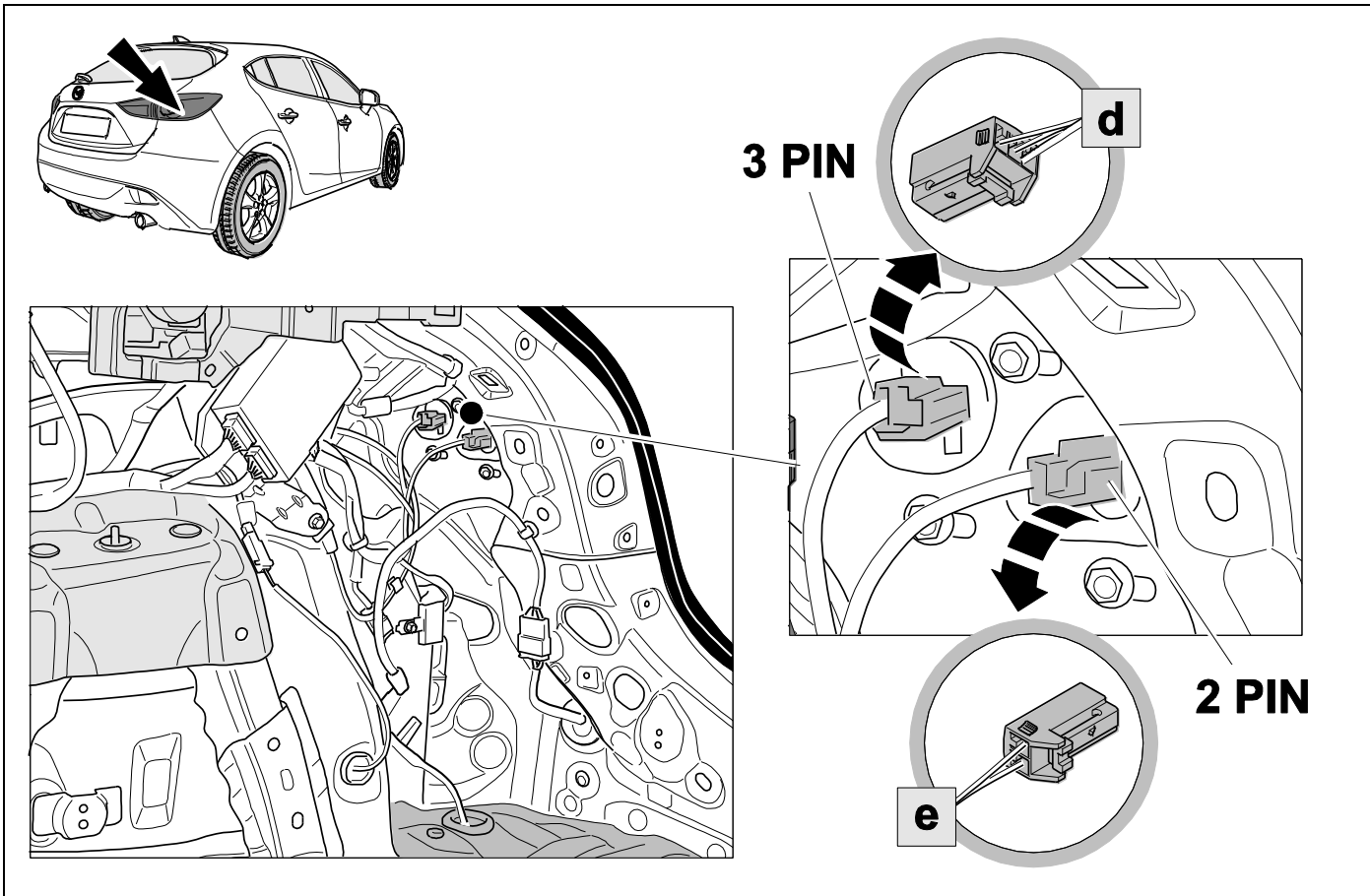

26

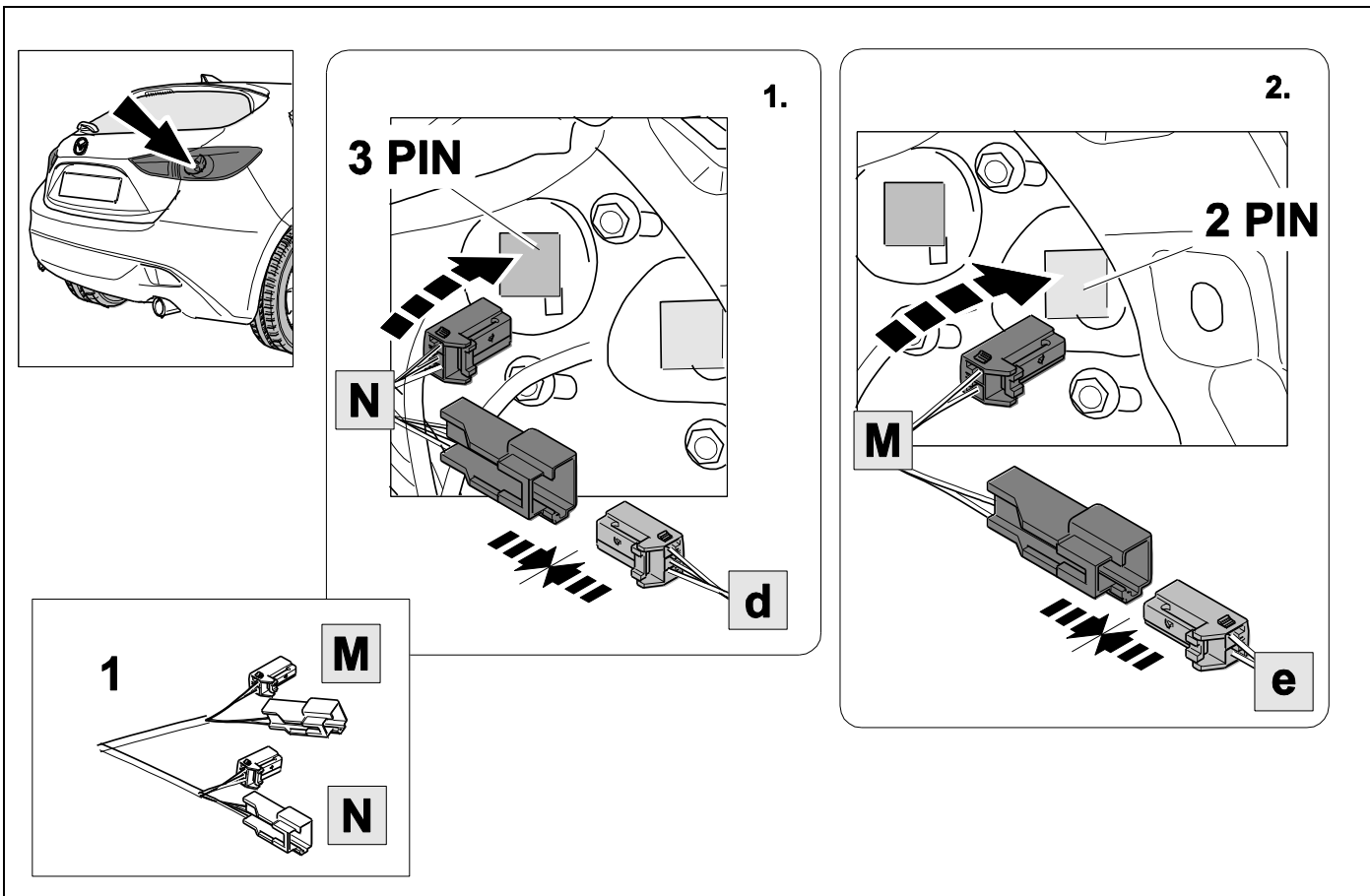

27

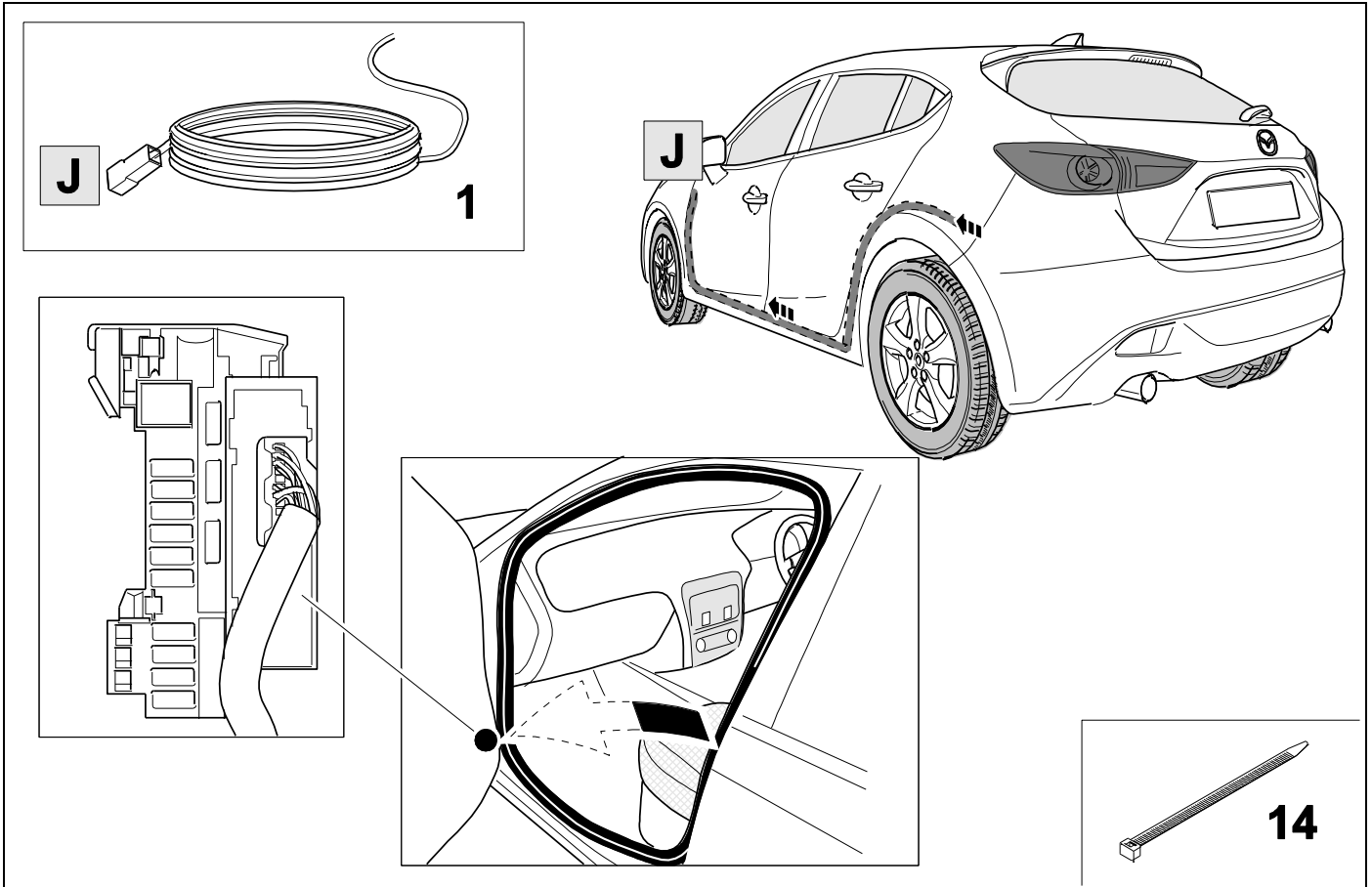

28

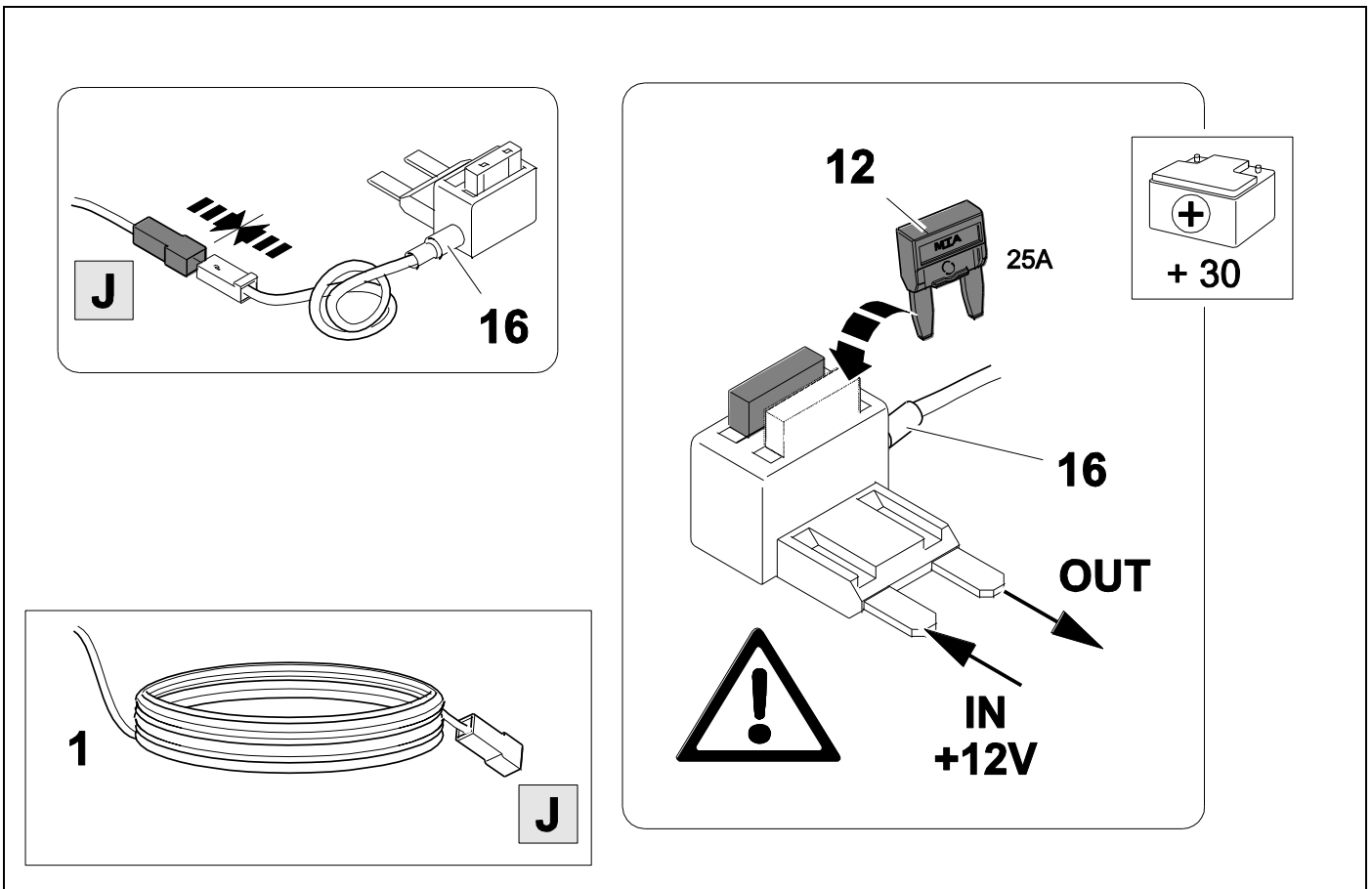

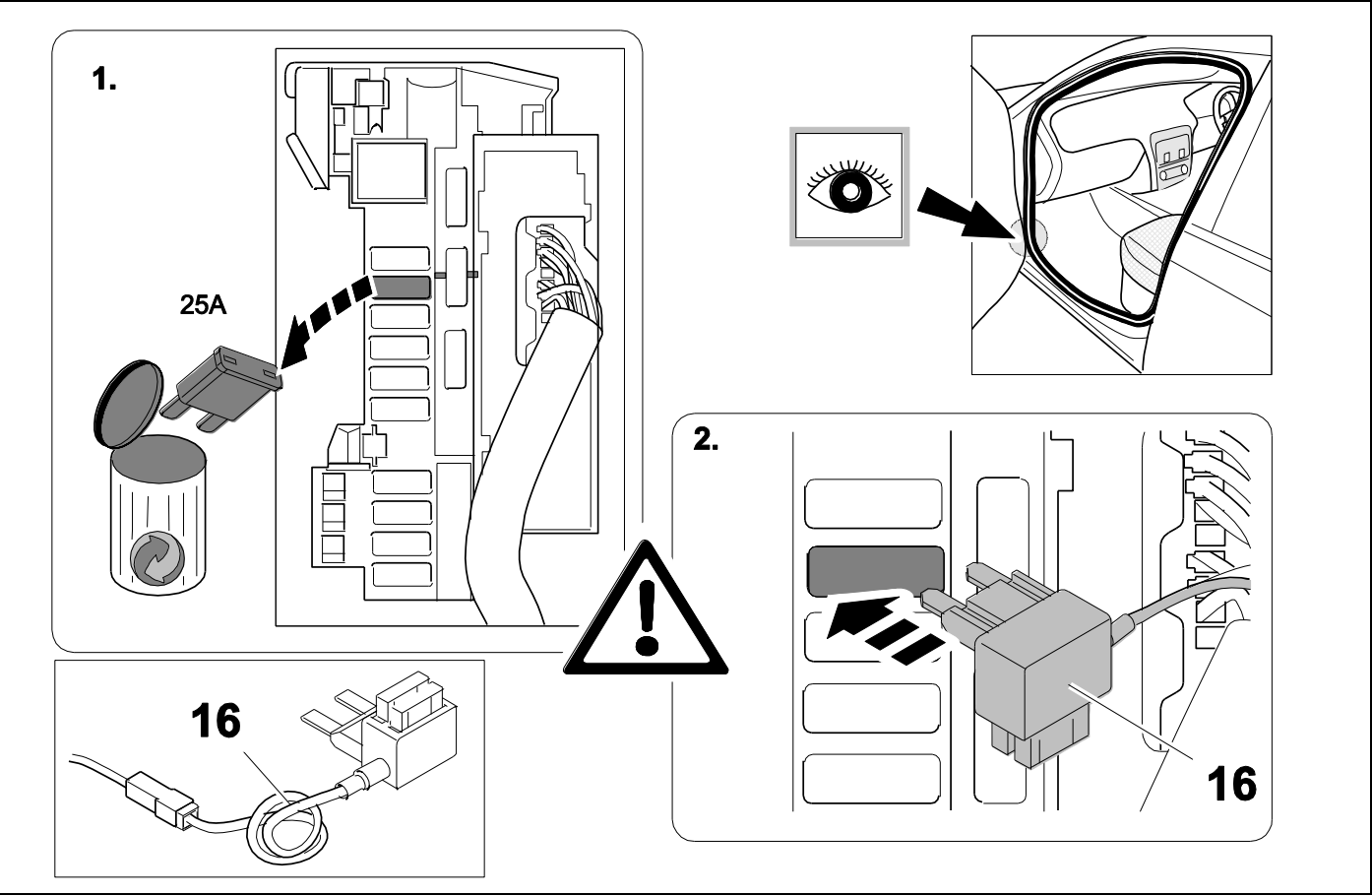



**BRAKE
CONTROLLER
PREPARED**

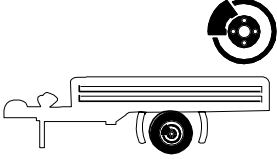

Trailer Brake Preparation

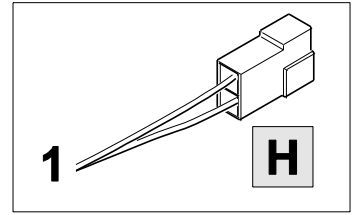

1.

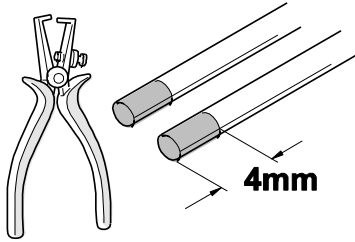

2.

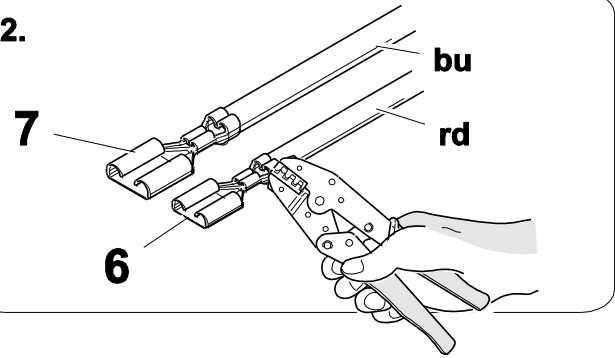

3.

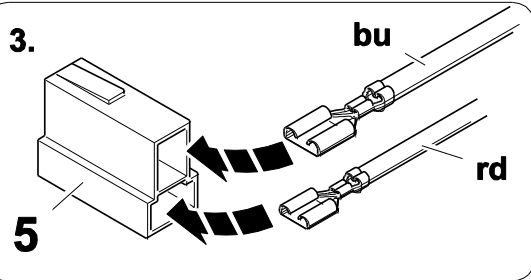

4.

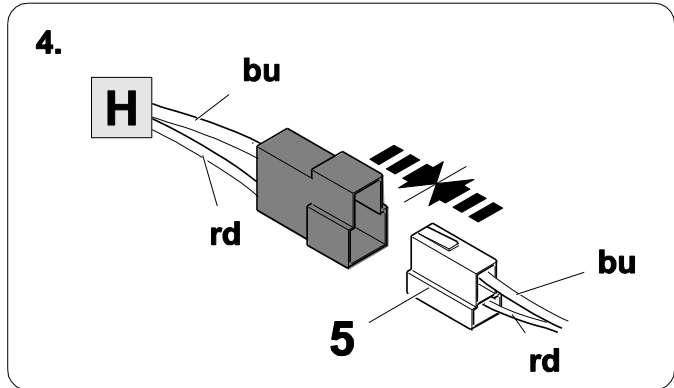

5

6

7

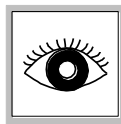
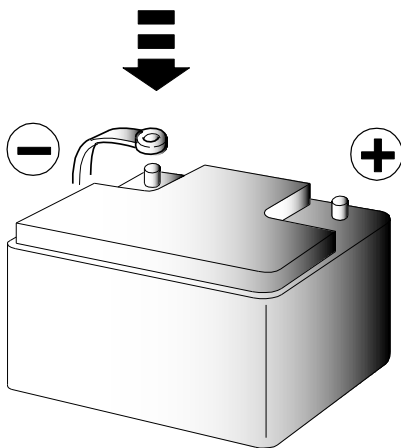
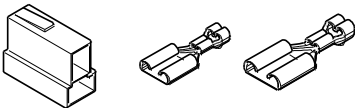

32

CHECK ALL LIGHTING FUNCTIONS

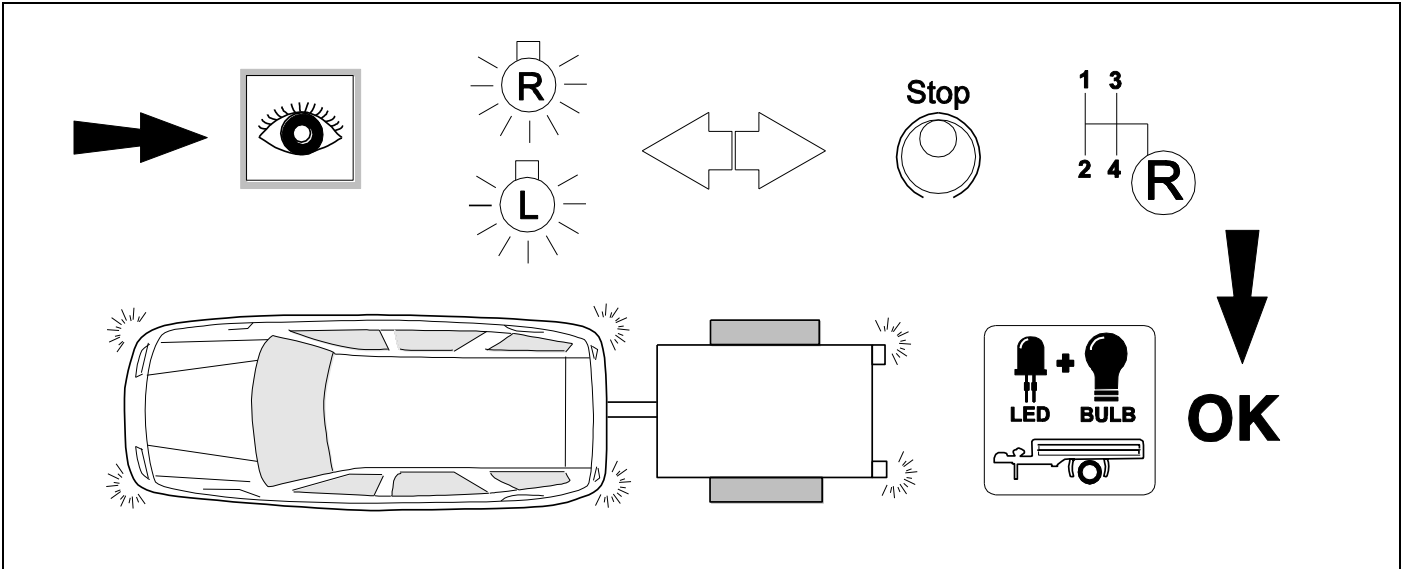

33

CHECK BULB OUT DETECTION

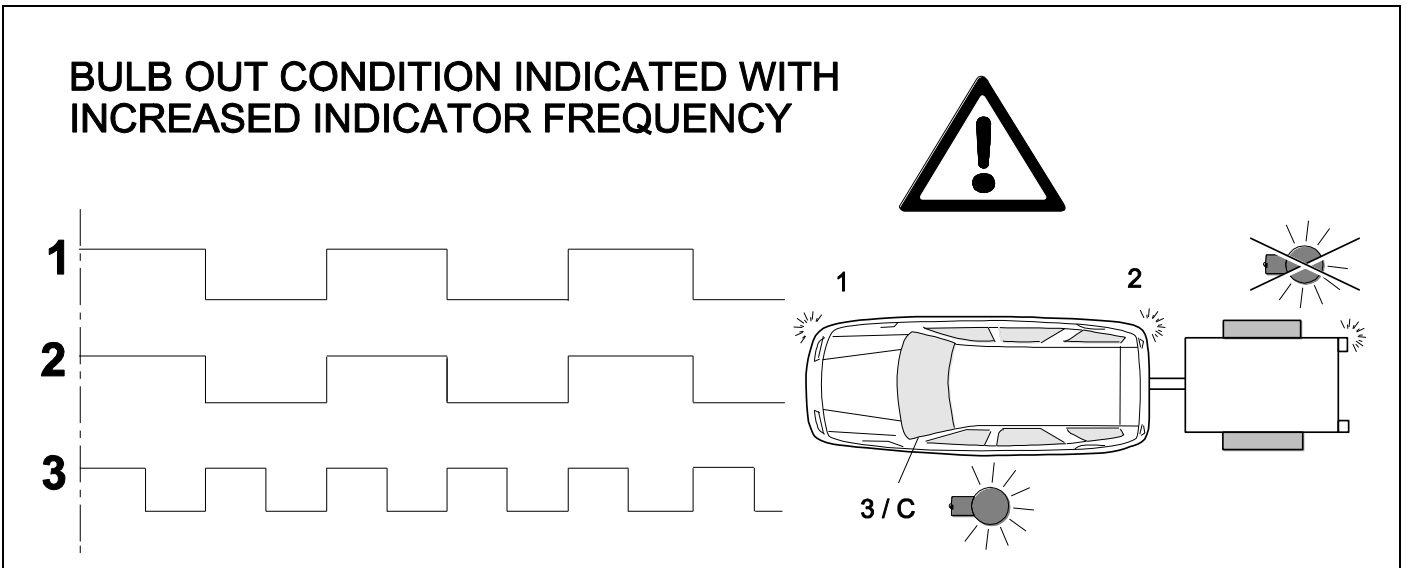

34

👁️ ⇒ 29

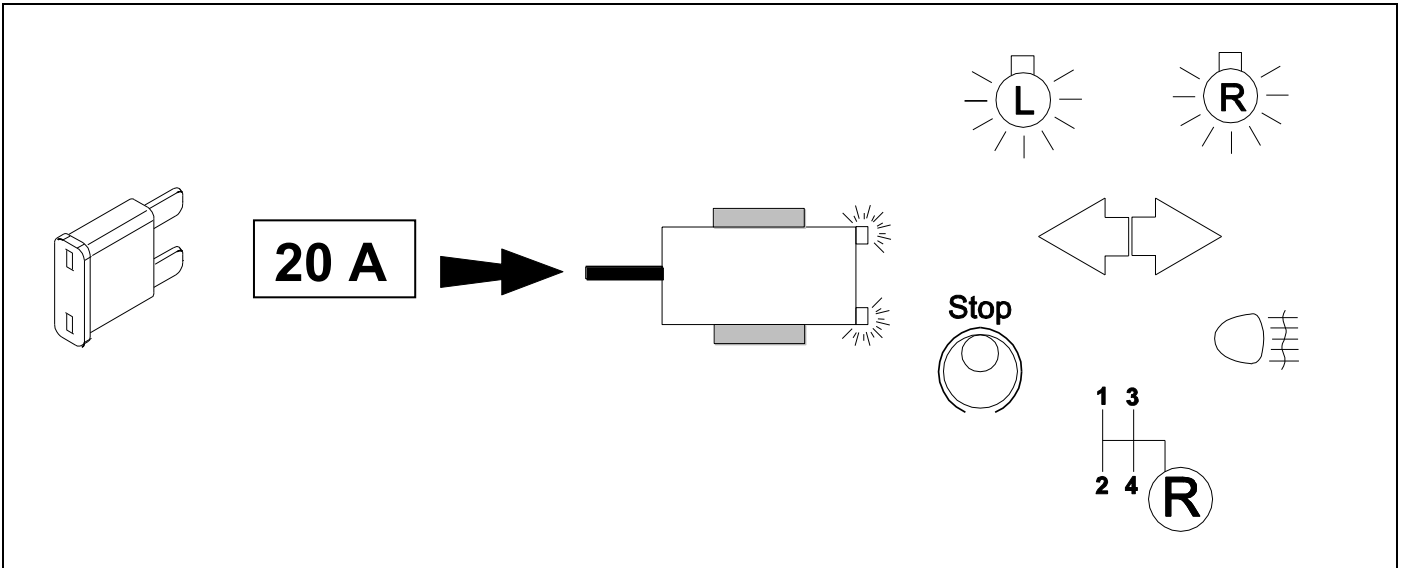

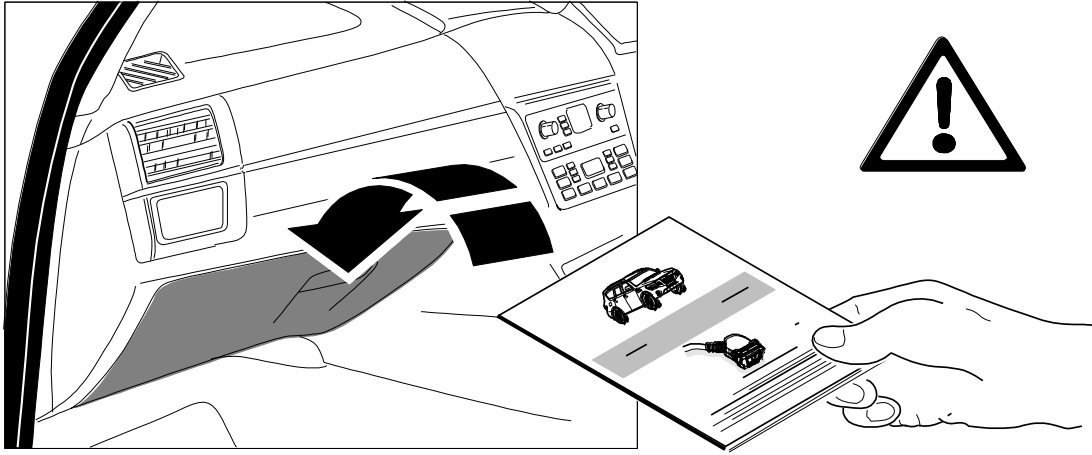

Subject to change in terms of construction, equipment and colour, and may contain errors.
The information and illustrations are non-binding.