

TRAILBOSS

Towbar Fitting Instructions
To Suit **FORD FOCUS SEDAN 2013 ON**
Part Number **FD136L**
Rating **1500/150 kg**

PLACE THESE INSTRUCTIONS IN THE VEHICLE'S GLOVEBOX AFTER INSTALLATION IS COMPLETED

WARNING:

1. Do not, drill, cut, weld or otherwise modify the tow bar.
2. If you are using electric welding on a motor vehicle, **always** check that the vehicle is not equipped with electronic engine or instrument management equipment. Failure to do so could **destroy** any onboard computers. If in doubt, check with the vehicle's manufacturer.
3. The high tensile fasteners supplied with this product were used to achieve the specified rating. If replacement is required ensure that fasteners of the same rating & quality are used. Contact an authorised **Trailboss** dealer if further information is required.

General:

1. Ensure all hardware items have been included refer to assembly diagram.
2. It is recommended that the instructions are read through and completely understood before making any attempt to fit this product.
3. Be wary of any changes to vehicle designs or other accessories that may conflict with the installation of this product.
4. Before drilling ensure that the area is clear of fuel, electrical & other components.
5. All holes drilled into the body panels shall have all burrs & swarf removed then coated with a suitable rust preventative paint.
6. For vehicles that require the bumper to be cut. Ensure cut out area is in correct position on the vehicle prior to cutting the bumper.
7. The high tensile fasteners supplied with this product were used to achieve the specified rating. If replacement is required ensure that fasteners of the same rating & quality are used. Contact an authorized **Trailboss** dealer if further information is required.
8. Ensure that all hardware is fastened to torque list below check fasteners on regular basis.
9. Tow bar load rating sticker provided with this product shall be conspicuously located on inside rear end of the driver's door. **(See diagram below).**
10. Trailboss recommends that you check your tow ball to ensure that it complies with the Australian standards **AS 4177.2**.
11. **PLEASE NOTE:** It is advised to remove your lug or tbn when not actually towing so as to produce a clear view of the vehicles registration plate if obscured, and to also provide maximum available departure angle
12. Pull Pin must be fit in down position.

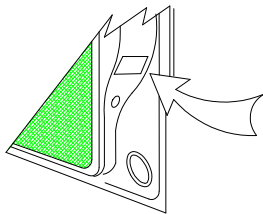

Place load rating sticker
inside driver's door here

FOR TRAILER TOWING PURPOSES ONLY
For towing capacity details please refer to vehicle owner's manual or to the manufacturer. Overloading can void your warranties.

RECOMMENDED ASSEMBLY TORQUE LISTING

Diameter	Grade 8.8 Bolt
M6	9.5 Nm
M8	21.7 Nm
M10	43.4 Nm
M12	77.3Nm
M14	146 Nm
M16	189.8 Nm

Tow bar Maintenance and Care.

Trailboss recommends that bolt torque's, as listed below, are routinely and regularly inspected and checked for correct tension. Replace any worn or defective parts.

We recommended to remove Tow Ball Mounts (TBM's, tongues or lugs) when not being used for any considerable length of time.

So as to avoid injury, when not towing it is suggested that the tongue, Pull Pin and R-clip are removed then stored in a safe, clean and dry place, away from excessive moisture.

Hitch Pull Pins and spring "R" clips are regularly checked for proper installation. Replace any worn or defective parts.

TRAILBOSS

Towbar Fitting Instructions
To Suit **FORD FOCUS SEDAN 2013 ON**
Part Number **FD136L**
Rating **1500/150 kg**

PLACE THESE INSTRUCTIONS IN THE VEHICLE'S GLOVEBOX AFTER INSTALLATION IS COMPLETED

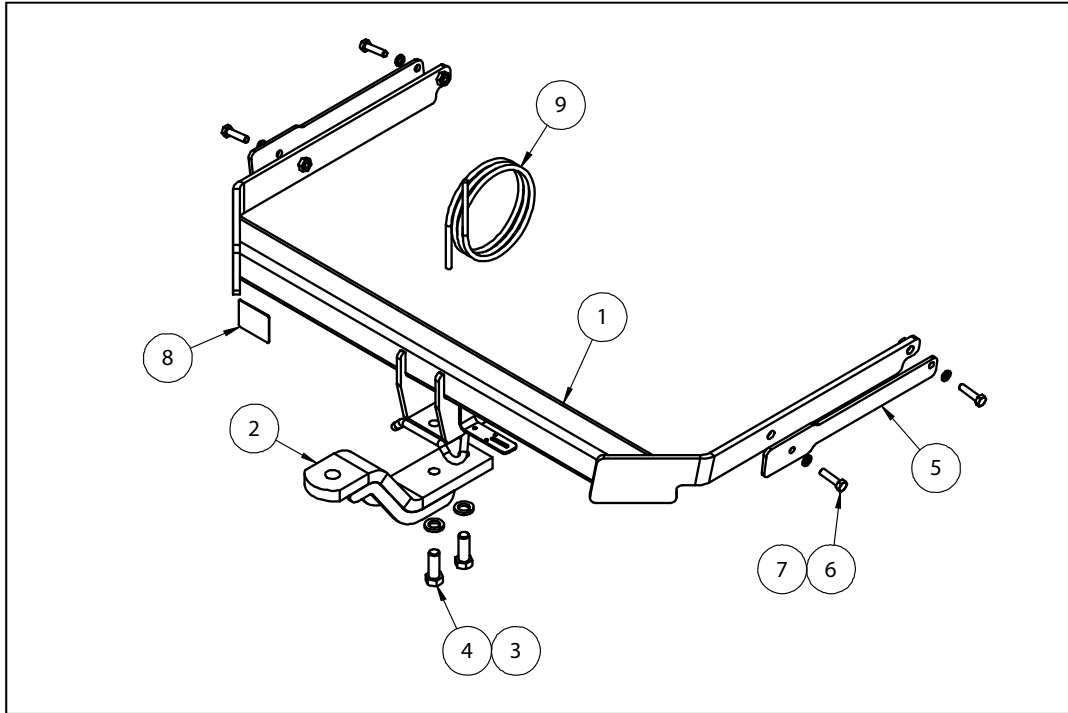

QTY	DESCRIPTION	ITEM
1	WELDED ASSEMBLY	1
1	LUG ASSEMBLY	2
2	SPRING WASHER M16X5X3.5	3
2	BOLT M16X45 2.0P	4
2	LOOSE PLATE	5
4	BOLT M10-1.5X40MM	6
4	SPRING WSHR M10X3.5X2.2	7
1	ACRYLIC COMPLIANCE PLATE	8
1	WIRING LOOM	9



Towbar Fitting Instructions
To Suit **FORD FOCUS SEDAN 2013 ON**
Part Number **FD136L**
Rating **1500/150 kg**

PLACE THESE INSTRUCTIONS IN THE VEHICLE'S GLOVEBOX AFTER INSTALLATION IS COMPLETED

INSTRUCTION:

1. Remove Mud Flap from inside rear wheel well by removing 3x Screws. Repeat for opposite side of vehicle.
2. Move Wheel well cover to side to reveal Screw securing Bumper to the vehicle. Remove Screw and repeat for opposite side of vehicle

Remove 2 scrivets from bottom of Bumper, connecting the Bumper to Bumper tabs.
3. Remove Screw beneath Taillight on side of vehicle. Repeat for opposite side of vehicle.

Accessing from underneath vehicle; remove 6x Nuts securing crash barrier and Bumper to vehicle.

Carefully remove Bumper from vehicle and store in safe place, Ensure rear parking sensors are disconnected.
4. Offer Towbar to vehicle, ensuring Sidearms are mounted inside the Chassis Inserts.

Mount Loose Plates to outside of Chassis Rails and secure with Bolts.
5. If vehicle is 5 Door variant, use appropriate tooling to make a Bumper cut 55mm long, measured from the Lower Lip, and 120mm wide.

A small Bumper Cut can be made on the Sedan variant if required.
6. Secure all Bolts to recommended torques and reassemble Bumper following steps 1 to 3 in reverse.



Wiring Loom Fitting Instructions
To Suit Ford Focus Sedan
Part Number 101284-WL

Wiring Loom Installation Instructions

Ford Focus Sedan
Part No: 101284-WL

Tail Harness Length Required: 1200mm

Wiring Loom Installation Time: Approx 30 Mins

Important



Due to possible vehicle variations, always confirm any noted vehicle colour wires with a multi-meter to ensure the correct function is identified before soldering or scotch locking.



Wiring Loom Fitting Instructions
To Suit Ford Focus Sedan
Part Number 101284-WL

1. In the luggage compartment, remove the floor carpet cover.
2. Remove the storage compartments.
3. Remove the rear trim by first removing the two clips.
4. Remove the rear LHS trim by first removing the one clip.

Repeat for RHS.

5. On the LHS of the luggage compartment, dislodge the rear LHS trim by first removing the one clip.

Repeat for RHS.

6. Drill a Ø30mm hole into the sheet metal on the LHS luggage compartment.
7. File any rough or sharp edges and spray on rust inhibitor.
8. On the LHS of the luggage compartment, disconnect the 4-way tail light connectors and connect the 4-way trailer patch (P/No 101284-WL) connectors in between.
9. Secure the trailer patch ground ring terminal to the vehicle grounding point using the existing fastener located at the LHS rear quarter area.
10. Connect the trailer patch ECU connector to the ECU.
11. Route the trailer patch along the rear of the vehicle and towards the RHS luggage compartment. Locate and expose the wrapped up vehicle connector located next to the fuse panel assembly. Scotch lock the trailer patch ORANGE power wire to the vehicle RED/ORANGE wire.

Function	Trailer Patch	Vehicle Connector
POWER	ORANGE	RED/ORANGE

12. Route the trailer patch along the rear of the vehicle and towards the RHS luggage compartment.
13. Locate and disconnect the RHS tail light 4-way connector and patch in the 4-way trailer patch connectors in between.
14. On the RHS of the luggage compartment, using a multimeter, locate the vehicle's 'GREEN/BLACK' reverse signal wire.
15. Following the table below, connect the ezy-tap to the vehicle 'GREEN/BLACK' reverse signal wire. Connect the trailer patch terminal to the ezy-tap.

Function	Trailer Patch	Vehicle Connector
REVERSE	BLACK / WHITE	GREEN / BLACK



Wiring Loom Fitting Instructions
To Suit Ford Focus Sedan
Part Number 101284-WL

16. Mount the trailer socket to the towbar mounting bracket using M4 fasteners (Not supplied).
17. Route the tail harness (tail length 1200mm) towards and up through the previously drilled out hole.
18. Ensure the tail harness grommet is seated correctly and makes a good seal.
19. Secure the grommet in place using a cable tie (not supplied).
20. Secure the grommet in place using a cable tie (not supplied).
21. Connect the Tail Harness 8-way connector to the Trailer Patch 8-way mating connector.
22. Test the Trailer Harness function using a light board or multimeter.
23. Secure all harnesses using cable ties (Not supplied).
24. Re-fit all removed parts and secure all fasteners, ensuring there are no squeaks or rattles.
25. Place the instructions in the glove box after fitment.