



Towbar Fitting Instructions
To Suit VX Commodore
Sedan & Wagon 10/00 TO 07-06.
Part Number HD60AL
Rating 1600Kg

1. Remove the bumper bar, the bumper stiffener and stiffener brackets. Retain the four M12 nuts from the stiffener brackets.
2. From under the vehicle remove the rear nut securing the centre fuel tank bracket and discard nut. Offer the forward mounting bracket to the vehicle, loosely secure using M10 x 1.5p nuts and spring washers (Items 1, 2 and 3) forward most, ensure the fuel tank bracket is returned to its original position
3. Loosely secure using M10 x 1.5p nuts, spring washers and flat washers (Items 1, 2, 3 and 4) rear most.
4. Offer towbar to vehicle, refit bumper stiffener brackets and loosely secure using, 12mm spring washer (Item 5), and existing M12 nuts.
5. Secure forward mounting bracket to towbar with ½" x 1 ¼" unc bolt, flat washer, spring washer and ½" unc nut (Items 6, 7, 8 and 9).
6. Tighten all bolts to the correct settings as listed below.
7. Refit bumper stiffener and bumper bar.
8. Attach the tongue (item 12) to the towbar using (items 10 & 11). Torque the bolts to the correct setting.

COMPONENT KIT

| ITEM No. | DESCRIPTION | QTY | TORQUE Nm |
|-----------------|--------------------------|------------|------------------|
| 1 | Forward Mounting Bracket | 1 | |
| 2 | M10 x 1.5p nut | 3 | 44 |
| 3 | 10mm spring washer | 3 | |
| 4 | 3/8" flat washer | 2 | |
| 5 | 12mm spring washer | 4 | |
| 6 | ½" x 1 ¼" unc bolt | 1** | 125 |
| 7 | ½" flat washer | 1 | |
| 8 | ½" spring washer | 1 | |
| 9 | ½" unc nut | 1** | |
| 10 | 5/8" x 1 ¾" unc bolt | 2* | 249 |
| 11 | 5/8" spring washer | 2* | |
| 12 | Tongue, PHD60 | 1 | |

Note: * One of each item 10 and 11 is used to secure the tongue to the towbar during transit. Note: ** Item 6 and 9 is used to secure the Forward Mounting Bracket to the towbar during transit.

Towbar Fitting Instructions
To Suit VX Commodore
Sedan & Wagon 10/00 TO 07-06.
Part Number HD60AL
Rating 1600Kg

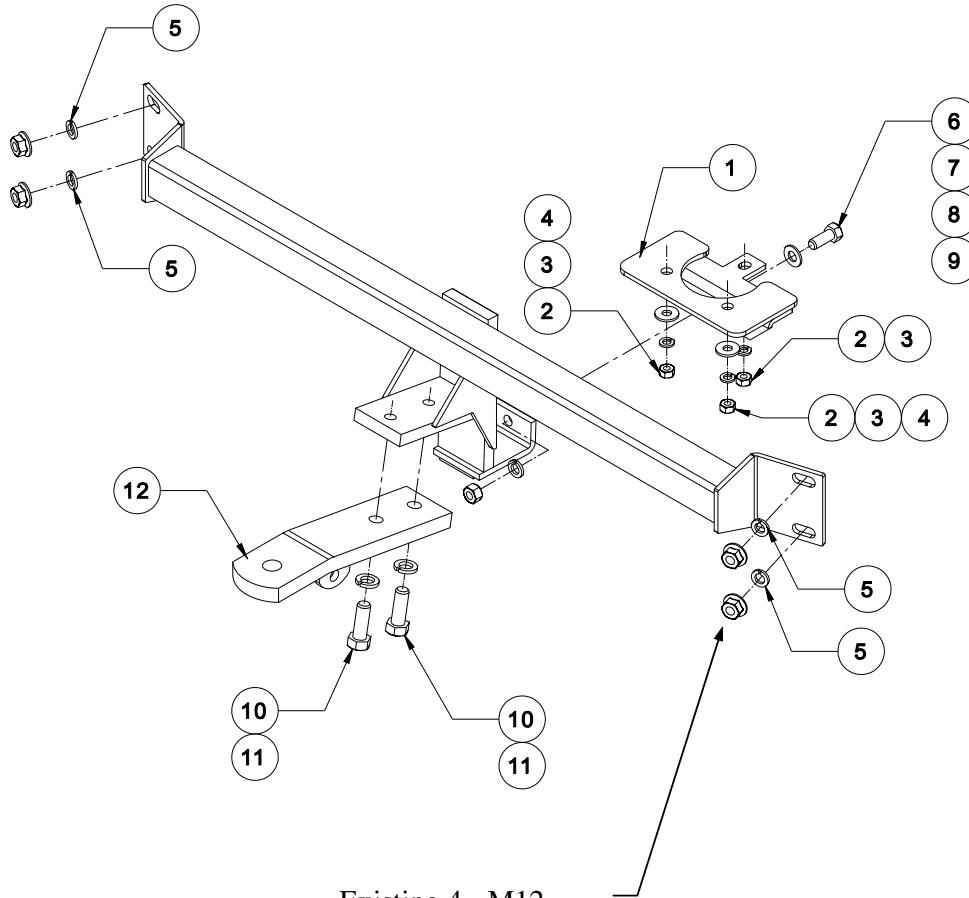

Existing 4 - M12
nuts removed in
Step 1



Towbar Fitting Instructions
To Suit VX Commodore
Sedan & Wagon 10/00 TO 07-06.
Part Number HD60AL
Rating 1600Kg

Wiring Loom Installation Instructions

Holden VY Commodore Sedan & Wagon
Holden Statesman Sedan & Wagon

Part No: 100044-WL

Tail Harness Length Required: 1200mm
RPA Override Switch Part No: 04848 (If Fitted)

Wiring Loom Installation Time: Approx 20 Mins

Note: For Wagon models, go to step 13.

Towbar Fitting Instructions
To Suit VX Commodore
Sedan & Wagon 10/00 TO 07-06.
Part Number HD60AL
Rating 1600Kg

For VT, VX, VY and VZ sedan models, continue:

1. In the luggage compartment, remove all trims required to gain access to the tail lights.
2. Remove the rear bumper fascia fasteners and then remove the rear bumper fascia (1).
3. Drill a Ø30mm grommet hole into the location shown (2). File down any rough edges and spray on rust inhibitor.

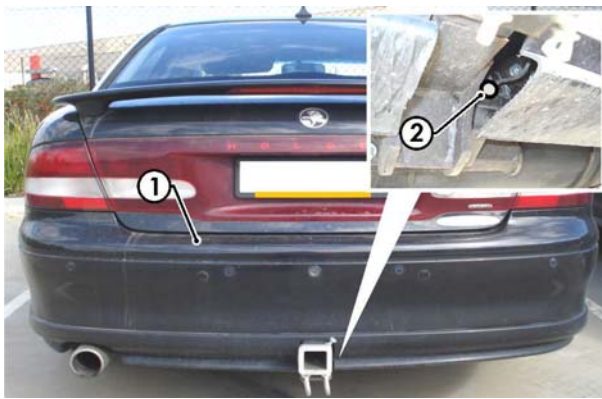

4. Mount the Tail Harness socket (Tail length 1200mm) to the towbar mounting bracket using M4 fasteners.
5. Route the harness along the towbar and into the grommet hole.
6. In the luggage compartment, retrieve the Tail Harness.
7. Adjust the harness grommet to the desired position, ensuring that it is seated correctly into the vehicle grommet hole. Secure the vehicle grommet using a cable tie (not supplied).
8. On the outside of the vehicle, secure the harness to the towbar using cable ties (not supplied).
9. Disconnect the RHS tail light connectors and the 1-way indicator connector. Connect the Trailer Patch Harness (P/No: 100044-WL) in between the tail light connectors and the 1-way indicator connector.
10. Refit the rear bumper fascia.
11. Test the Trailer socket using a light board or multi-meter.
12. Secure the all harnesses using cables ties (not supplied). Refit all removed parts and secure all fasteners. Place instructions in glove box after fitment.



Towbar Fitting Instructions
To Suit VX Commodore
Sedan & Wagon 10/00 TO 07-06.
Part Number HD60AL
Rating 1600Kg

The following steps for Wagon models only

13. Remove the rear bumper fascia.
14. Gain access to the tail lights.
15. Remove the tail light assembly.
16. Drill a Ø30mm hole into the rear tail gate, below the RHS tail light cavity opening. File down any rough edges and spray on rust inhibitor.
17. Mount the Tail Harness socket (Tail length 1200mm) to the towbar mounting bracket using M4 fasteners.
18. Route the Tail Harness along the towbar and into the grommet hole
19. Adjust the harness grommet to the desired position, ensuring that it is seated correctly into the vehicle grommet hole. Secure the vehicle grommet using a cable tie (not supplied).
20. Secure the harness to the towbar using cable ties (not supplied).
21. Disconnect the RHS tail light connectors and the 1-way indicator connector. Connect the Trailer Patch Harness (P/No: 100044-WL) in between the tail light connectors and the 1-way indicator connector
22. Connect the Tail Harness 8-way male connector to the Trailer Patch Harness 8-way female connector.
23. Test the Trailer Harness function using a Light Board or multimeter.
24. Secure the Trailer Patch Harness using cable ties (not supplied).
25. Refit all removed parts and secure all fasteners ensuring there are no squeaks or rattles.
26. Place instructions in glove box after fitment.