

TRAILBOSS

Towbar Fitting Instructions
To Suit **HOLDEN CRUZE WAGON 07-12 ON**
Part Number **HD97L**
Rating **1200/120 kg**

PLACE THESE INSTRUCTIONS IN THE VEHICLE'S GLOVEBOX AFTER INSTALLATION IS COMPLETED

WARNING:

1. Do not, drill, cut, weld or otherwise modify the tow bar.
2. If you are using electric welding on a motor vehicle, **always** check that the vehicle is not equipped with electronic engine or instrument management equipment. Failure to do so could **destroy** any onboard computers. If in doubt, check with the vehicle's manufacturer.
3. The high tensile fasteners supplied with this product were used to achieve the specified rating. If replacement is required ensure that fasteners of the same rating & quality are used. Contact an authorised **Trailboss** dealer if further information is required.
4. If TBM is used in inverted position tow ball may make contact with rear tailgate when lowered, which could cause damage.

General:

1. Ensure all hardware items have been included refer to assembly diagram.
2. It is recommended that the instructions are read through and completely understood before making any attempt to fit this product.
3. Be wary of any changes to vehicle designs or other accessories that may conflict with the installation of this product.
4. Before drilling ensure that the area is clear of fuel, electrical & other components.
5. All holes drilled into the body panels shall have all burrs & swarf removed then coated with a suitable rust preventative paint.
6. For vehicles that require the bumper to be cut. Ensure cut out area is in correct position on the vehicle prior to cutting the bumper.
7. The high tensile fasteners supplied with this product were used to achieve the specified rating. If replacement is required ensure that fasteners of the same rating & quality are used. Contact an authorized **Trailboss** dealer if further information is required.
8. Ensure that all hardware is fastened to torque list below check fasteners on regular basis.
9. Tow bar load rating sticker provided with this product shall be conspicuously located on inside rear end of the driver's door. **(See diagram below).**
10. Trailboss recommends that you check your tow ball to ensure that it complies with the Australian standards **AS 4177.2**.
11. **PLEASE NOTE:** It is advised to remove your lug or tbm when not actually towing so as to produce a clear view of the vehicles registration plate if obscured, and to also provide maximum available departure angle
12. Pull Pin must be fit in down position.

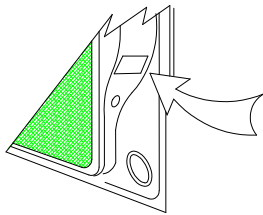

Place load rating sticker
inside driver's door here

FOR TRAILER TOWING PURPOSES ONLY
For towing capacity details please refer to vehicle owner's manual or to the manufacturer. Overloading can void your warranties.

RECOMMENDED ASSEMBLY TORQUE LISTING

Diameter	Grade 8.8 Bolt
M6	9.5 Nm
M8	21.7 Nm
M10	43.4 Nm
M12	77.3Nm
M14	146 Nm
M16	189.8 Nm

Tow bar Maintenance and Care.

Trailboss recommends that bolt torque's, as listed below, are routinely and regularly inspected and checked for correct tension. Replace any worn or defective parts.

We recommended to remove Tow Ball Mounts (TBM's, tongues or lugs) when not being used for any considerable length of time.

So as to avoid injury, when not towing it is suggested that the tongue, Pull Pin and R-clip are removed then stored in a safe, clean and dry place, away from excessive moisture.

Hitch Pull Pins and spring "R" clips are regularly checked for proper installation. Replace any worn or defective parts.

TRAILBOSS

Towbar Fitting Instructions
 To Suit **HOLDEN CRUZE WAGON 07-12 ON**
 Part Number **HD97L**
 Rating **1200/120 kg**

PLACE THESE INSTRUCTIONS IN THE VEHICLE'S GLOVEBOX AFTER INSTALLATION IS COMPLETED

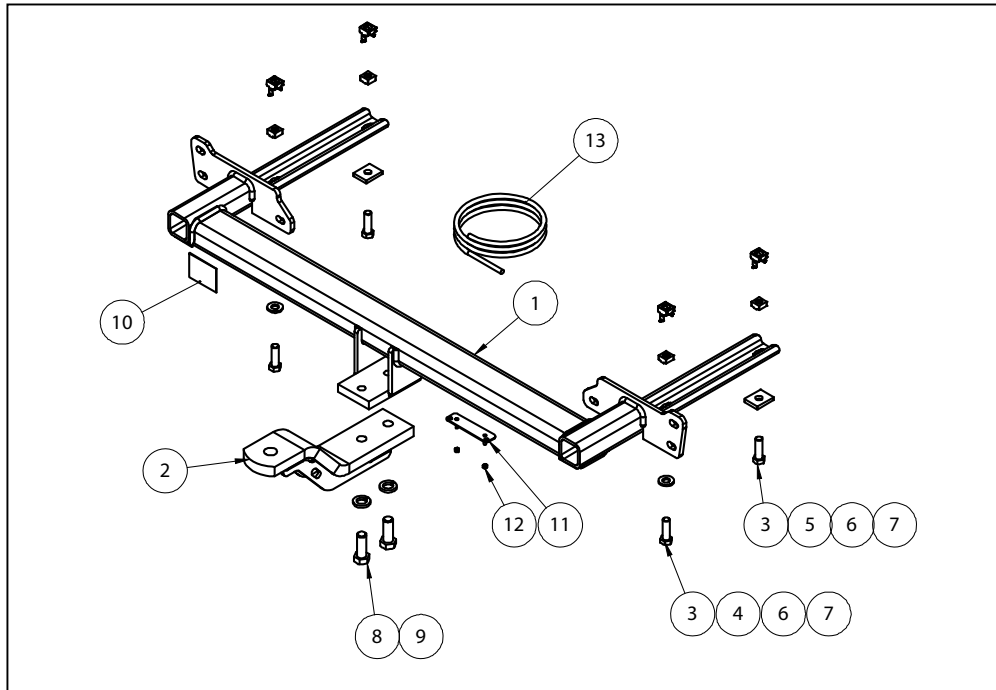

QTY	DESCRIPTION	ITEM NO
1	WELDED ASSEMBLY	1
1	LUG ASSEMBLY	2
4	SET SCREW M12X40X1.75P	3
2	WASHER FLAT 1/2" X1 1/8"X1/8"	4
2	LOOSE PLATE 32X6X40Ø13	5
4	CAGE NUT M12X1.75P	6
4	CAGE NUT RETAINER	7
2	BOLT M16X45 2.0P	8
2	SPRING WASHER M16X5X3.5	9
1	ACRYLIC CP	10
1	PLUG BRACKET	11
2	NUT NYLOC M4-0.7 Z/P	12
1	WIRING LOOM	13



Towbar Fitting Instructions
To Suit **HOLDEN CRUZE WAGON 07-12 ON**
Part Number **HD97L**
Rating **1200/120 kg**

PLACE THESE INSTRUCTIONS IN THE VEHICLE'S GLOVEBOX AFTER INSTALLATION IS COMPLETED

INSTRUCTION:

1. Remove 3 x Screws from inside rear wheel arch. Remove 1 x Screw from underside of bumper adjacent to rear wheel arch. Repeat for opposite side of vehicle.
2. Remove 2 x Caps concealing Screws on tail light assembly within boot cavity. Remove 2 x Screws securing tail light assembly. Repeat for opposite side of vehicle.
3. Remove tail light assembly and remove tail light globes. Protect globes from any risks of damage.
4. Remove 2x Push Rivets from underside of bumper.
5. Disconnect parking sensor cable and carefully remove bumper bar.
6. Remove and retain 6 x flanged Nuts securing impact beam. Remove and discard impact beam.
7. Assemble 4 x Cage Nuts and insert into top side of side arm profiled holes.
8. Slide Towbar welded assembly into chassis rails and loosely secure with 6 x Impact beam flanged Nuts.
9. Loosely secure Towbar to bottom of vehicle chassis rails with 4 x supplied M12 Set Screws; use Washers for rearward Screws and Washer Plates for forward screws.

Tighten the 4 Set Screws and 6 Flanged Nuts to the torques specified on Page 2 of this document.

10. Establish centre of bumper. Create a cut out, starting from the bottom edge of the bumper, of 85mm width x 140mm height.

Drill 2 x $\phi 6$ holes to suit plug bracket.

Refit rear bumper following steps 1 – 5 in reverse order.

11. Secure Tongue to Towbar using 2 xM16 Bolts provided, complete with Spring Washers; tighten to torque specified on Page 1 of this document.



Wiring Loom Fitting Instructions
To Suit Holden Cruze Wagon MY14
Part Number 101261-WL

Wiring Loom Installation Instructions

Holden Cruze Wagon
Part No: 101261-WL

Tail Harness Length Require: 1200mm

Wiring Loom Installation Time: Approx 45 Mins



Wiring Loom Fitting Instructions
To Suit Holden Cruze Wagon MY14
Part Number 101261-WL

1. Remove the following trims and its fasteners (if any) from the luggage compartment area: rear parcel shelf, spare wheel floor cover, rear trim and all tool trays from the spare wheel well area.
2. Remove the LHS rear passenger 'D' pillar trim fasteners and then remove the 'D' pillar trim.
3. Remove the LHS luggage compartment trim fasteners and then dislodge the LHS trim.
4. Remove the LHS door scuff trim and dislodge the front of the luggage compartment LHS trim. **Repeat Steps 2, 3 and 4 for the RHS.**
5. In the luggage compartment spare wheel well, drill a Ø30mm hole at the rear lower centre of the sheet metal area (centre of the circular embossed sheet metal area). File down any rough or sharp edges and apply rust inhibitor (not supplied) after drilling.
6. Disconnect the RHS tail light connectors and connect the trailer patch (P/No: 101261-WL) connectors in between. Route the trailer patch harness across the interior rear of the vehicle and towards the LHS.
7. Disconnect the LHS tail light connectors and connect the trailer patch connectors in between.
8. At the LHS rear quarter of the vehicle, secure the trailer patch ground ring terminal to the vehicle grounding point.
9. At the rear exterior of the vehicle, mount the tail harness socket to the towbar mounting bracket using M4 fasteners (not supplied).
10. Route the Tail Harness (tail length: 1200mm) up into the drilled hole. Adjust the trailer patch harness grommet so that it is seated correctly and secure the harness grommet in place using a cable tie (not supplied).
11. Connect the Trailer Patch Harness 8-way female connector to the Tail Harness 8-way male connector.
12. Test the Trailer socket using a light board or multi-meter.
13. Secure the all harnesses using cables ties.
14. Refit all removed parts and secure all fasteners.
15. Place instructions in glove box after fitment.