



Towbar Fitting Instructions
To Suit HONDA ACCORD EURO 6/03-ON
Part Number HN56
Rating 1200Kg

WARNING:

1. Do not, drill, cut weld or otherwise modify the towbar.
2. If you are using electric welding on a motor vehicle, always check that the vehicle is not equipped with electronic engine or instrument management equipment. Failure to do so could destroy any onboard computers. If in doubt, check with the vehicle's manufacturer.

INSTRUCTIONS

1. Ensure all hardware items have been included.
2. Remove Spare wheel.
3. Remove Plastic spare wheel guard from under vehicle and cut as per diagram.
4. Remove Rear bumper.
 - a. 3 x Self tapping screws.
 - b. 2 x 4mm Bolts from behind boot lid when open.
 - c. Pull outward and back from wheel arch to unclip bumper.
5. Cut bumper as per diagram. Fig 1
6. Remove and discard impact beam.
7. Hold towbar in position against vehicle and take note of which hole aligns with hole in tail, then remove towbar.
8. Open out hole found in step 7 to take spacer tube. Fig 2 (NOTE: - BOTTOM PANEL ONLY).
9. Refit towbar with bolts supplied and spacer tube in place between tail and hole drilled previously.
10. Using tail as a guide, drill top panel of wheel well $\varnothing 11\text{mm}$.
11. Fit coach bolt, loose plate and tighten all bolts to torque listing below.
12. Refit parts remove in steps 2-4 in reverse order.

RECOMMENDED ASSEMBLY TORQUE LISTING

<u>Diameter</u>	<u>Grade 8.8 Bolt</u>
	Nm
M6	9.5
M8	21.7
M10	43.4
M12	77.3
M14	121.0
M16	189.8

TRAILBOSS

Towbar Fitting Instructions
To Suit HONDA ACCORD EURO 6/03-ON
Part Number HN56
Rating 1200Kg

FOR TOWING PURPOSES ONLY

For towing capacity details please refer to vehicle owner's manual or to the manufacturer. Overloading can void your warranties.

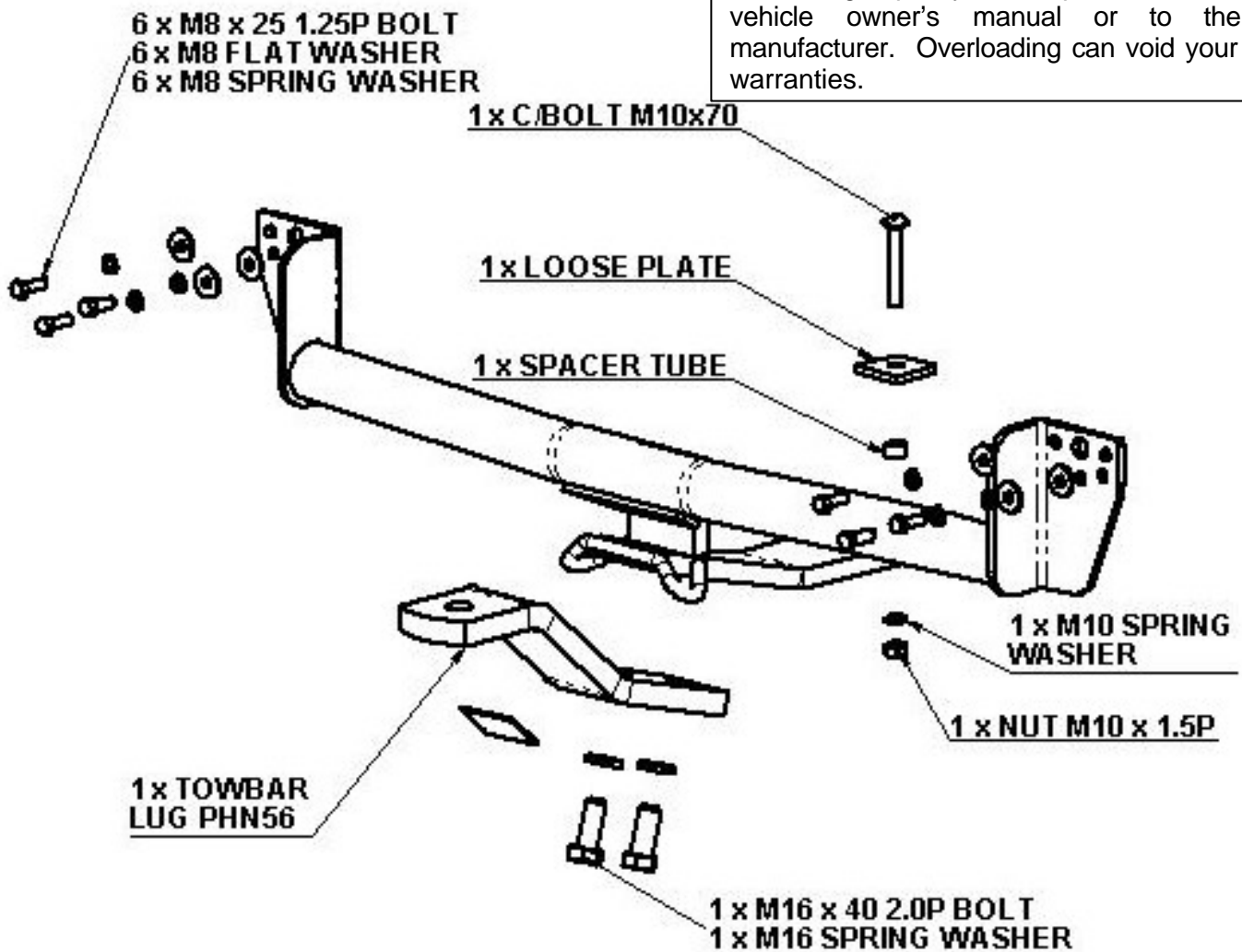

PLEASE NOTE: You must remove the lug unless you are actually towing if it obscures your number plate. Failure to do so may result in a fine.

IMPORTANT: Please see over for safety chain hook-up procedure.

Towbar Fitting Instructions
To Suit HONDA ACCORD EURO 6/03-ON
Part Number HN56
Rating 1200Kg

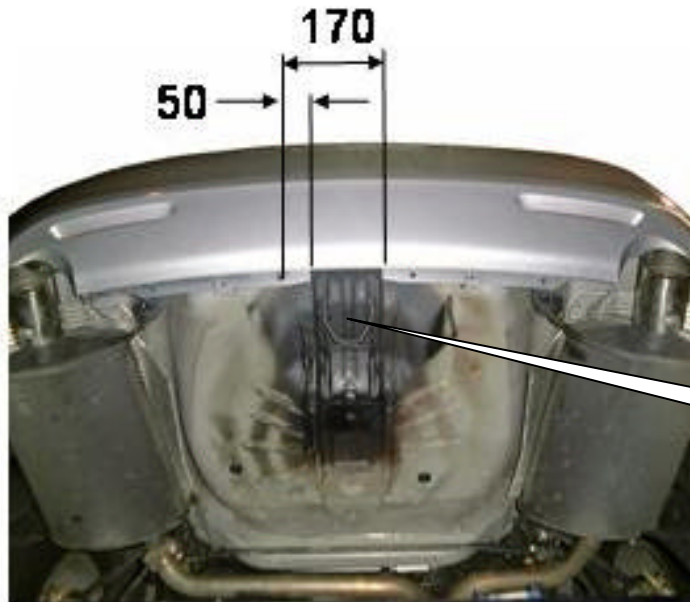

Fig 1

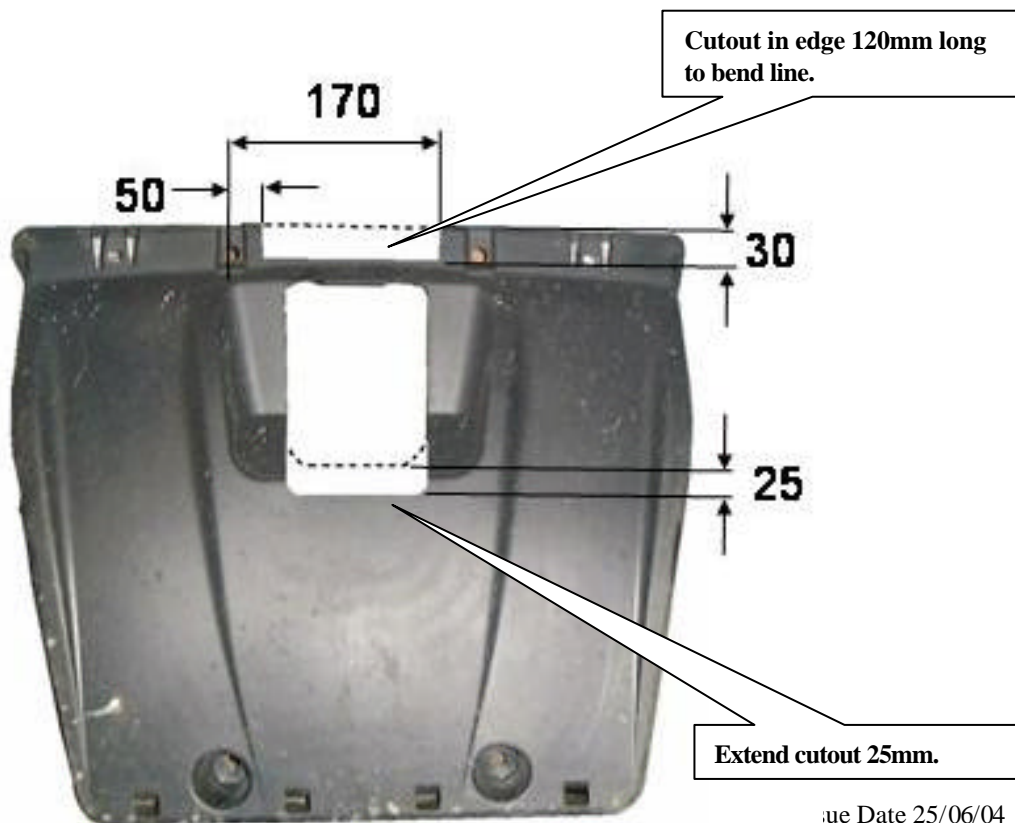

Fig 2