

# TRAILBOSS

## Towbar Fitting Instructions To Suit **HONDA CIVIC HATCH 06-2012** on Part Number **HN65L** Rating **1400/140 kg**

PLACE THESE INSTRUCTIONS IN THE VEHICLE'S GLOVEBOX AFTER INSTALLATION IS COMPLETED

### **WARNING:**

1. Do not, drill, cut, weld or otherwise modify the tow bar.
2. If you are using electric welding on a motor vehicle, **always** check that the vehicle is not equipped with electronic engine or instrument management equipment. Failure to do so could **destroy** any onboard computers. If in doubt, check with the vehicle's manufacturer.
3. The high tensile fasteners supplied with this product were used to achieve the specified rating. If replacement is required ensure that fasteners of the same rating & quality are used. Contact an authorised **Trailboss** dealer if further information is required.

### **General:**

1. Ensure all hardware items have been included refer to assembly diagram.
2. It is recommended that the instructions are read through and completely understood before making any attempt to fit this product.
3. Be wary of any changes to vehicle designs or other accessories that may conflict with the installation of this product.
4. Before drilling ensure that the area is clear of fuel, electrical & other components.
5. All holes drilled into the body panels shall have all burrs & swarf removed then coated with a suitable rust preventative paint.
6. For vehicles that require the bumper to be cut. Ensure cut out area is in correct position on the vehicle prior to cutting the bumper.
7. The high tensile fasteners supplied with this product were used to achieve the specified rating. If replacement is required ensure that fasteners of the same rating & quality are used. Contact an authorized **Trailboss** dealer if further information is required.
8. Ensure that all hardware is fastened to torque list below check fasteners on regular basis.
9. Tow bar load rating sticker provided with this product shall be conspicuously located on inside rear end of the driver's door. **(See diagram below)**.
10. Trailboss recommends that you check your tow ball to ensure that it complies with the Australian standards **AS 4177.2**.
11. **PLEASE NOTE:** It is advised to remove your lug or tbm when not actually towing so as to produce a clear view of the vehicles registration plate if obscured, and to also provide maximum available departure angle
12. Pull Pin must be fit in down position.

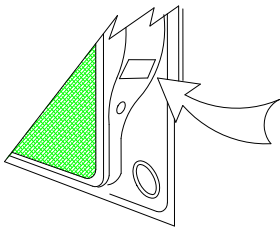

Place load rating sticker  
inside driver's door here

**FOR TRAILER TOWING PURPOSES ONLY**  
For towing capacity details please refer to vehicle owner's manual or to the manufacturer. Overloading can void your warranties.

#### **RECOMMENDED ASSEMBLY TORQUE LISTING**

<u>Diameter</u>	<u>Grade 8.8 Bolt</u>
M6	9.5 Nm
M8	21.7 Nm
M10	43.4 Nm
M12	77.3Nm
M14	146 Nm
M16	189.8 Nm

### **Tow bar Maintenance and Care.**

Trailboss recommends that bolt torque's, as listed below, are routinely and regularly inspected and checked for correct tension. Replace any worn or defective parts.

We recommended to remove Tow Ball Mounts (TBM's, tongues or lugs) when not being used for any considerable length of time.

So as to avoid injury, when not towing it is suggested that the tongue, Pull Pin and R-clip are removed then stored in a safe, clean and dry place, away from excessive moisture.

Hitch Pull Pins and spring "R" clips are regularly checked for proper installation. Replace any worn or defective parts.

# TRAILBOSS

Towbar Fitting Instructions  
 To Suit **HONDA CIVIC HATCH 06-2012** on  
 Part Number **HN65L**  
 Rating **1400/140 kg**

PLACE THESE INSTRUCTIONS IN THE VEHICLE'S GLOVEBOX AFTER INSTALLATION IS COMPLETED

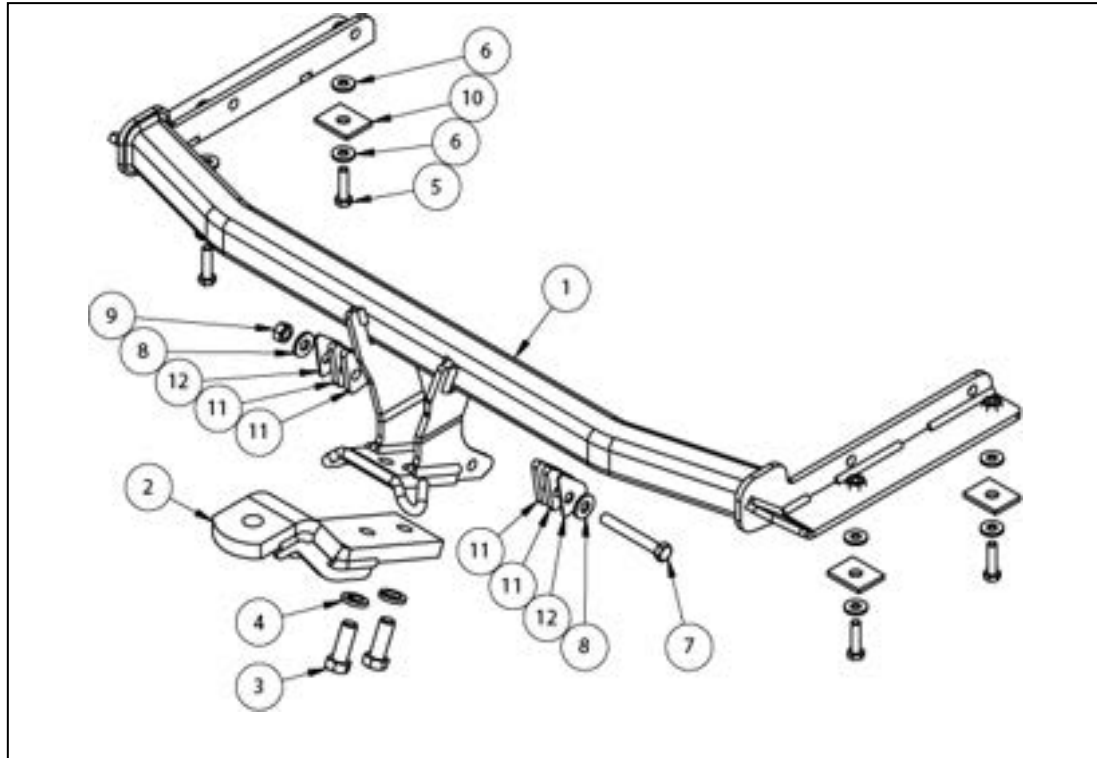

QTY	DESCRIPTION	ITEM NO.
1	WELDED ASSEMBLY	1
1	LUG W-REINF	2
2	M16 x 45 2.0P BOLT	3
2	M16 x 5 x 3.5 SPRING WASHER	4
4	BOLT M10 – 1.5 x 40 mm	5
8	WSHR FT M10 x 25.4 x 3	6
1	BOLT M12-1.25 x 28 x 90	7
2	WASHER M12 x 28.8 x 3 mm	8
1	M12 x 1.25 HEX NUT PC8	9
4	SPACER PLATE	10
4	HOOK PLATE	11
2	2 mm SPACER TOW HOOK	12

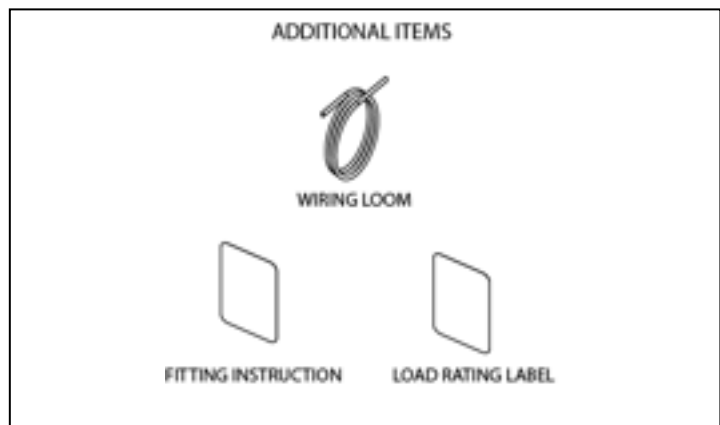



Towbar Fitting Instructions  
To Suit **HONDA CIVIC HATCH 06-2012** on  
Part Number **HN65L**  
Rating **1400/140 kg**

PLACE THESE INSTRUCTIONS IN THE VEHICLE'S GLOVEBOX AFTER INSTALLATION IS COMPLETED

**INSTRUCTION:**

1. Remove Spare Tyre , Trunk Rear Trim Panel, Inner lid and then inner pocket fold the right rear seat, Remove the right Trunk Side trim panel, Remove Speaker (if fitted).
2. Remove Bumper Caps and Bolts, Remove short and long Clips from under Bumper.
3. Remove self – taped Screws and long Clips on LHS of vehicle from inside of Wheel Arch and release the Hook and Clips, Repeat all for RHS of vehicle.
4. Release the Bumper by retaining tabs and remove Bumper from vehicle, place on stand, Remove grommet on RHS rear quarter panel and discard.
5. Remove Impact Beam Bolts and remove Impact Beam from vehicle.
6. Assembly Towbar to vehicle, loosely insert the fasteners. Refer to page 3 diagram.
7. Tighten all fasteners to the torque specifications listed on Page 2.
8. Refer to Bumper cut out pictures, to cut bumper and tray. Re-install at parts to vehicle in reverse order of removal.



Towbar Fitting Instructions  
To Suit **HONDA CIVIC HATCH 06 -2012** on  
Part Number **HN65L**  
Rating **1400/140kg**

PLACE THESE INSTRUCTIONS IN THE VEHICLE'S GLOVEBOX AFTER INSTALLATION IS COMPLETE

D

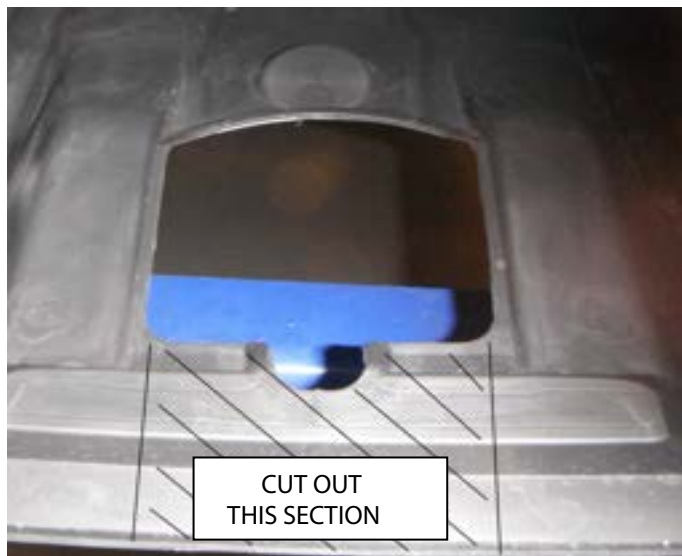
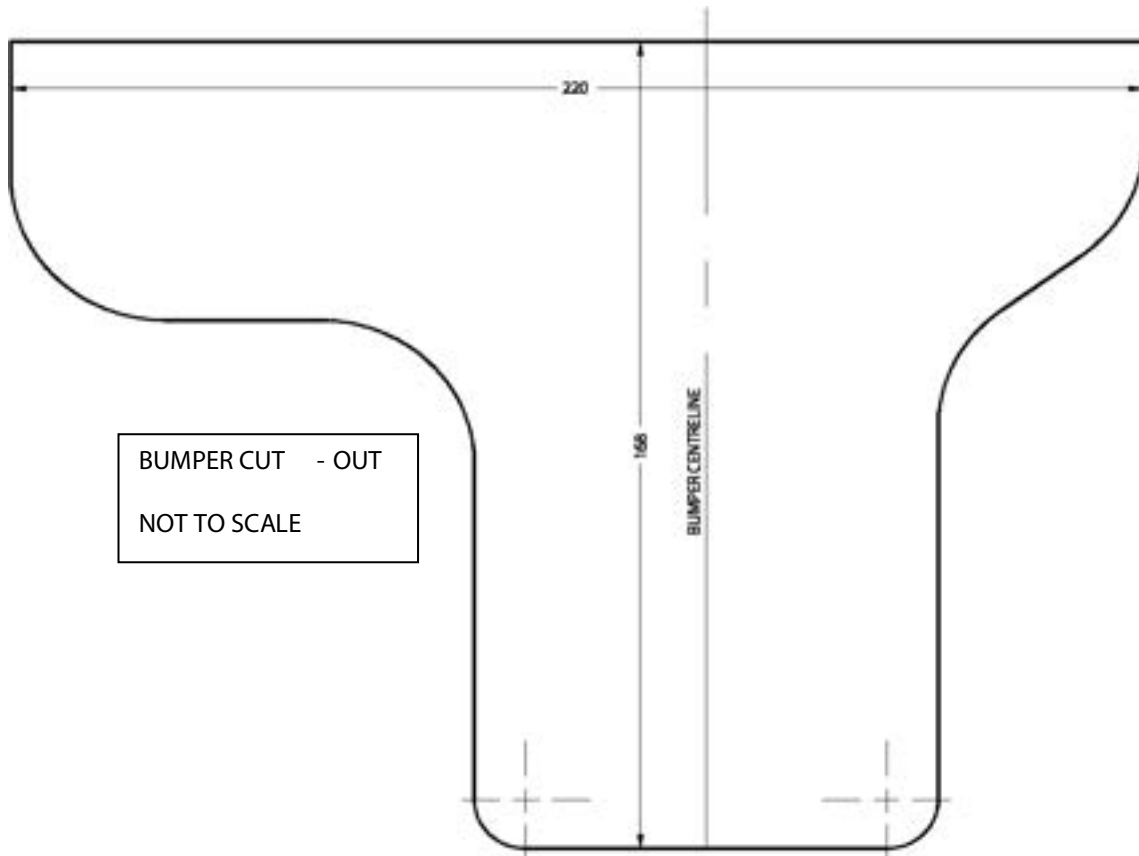

UNDER -SIDE COVER TRAY



Wiring Loom Fitting Instructions  
To Suit Honda Civic Hatch MY12  
Part Number 100822-WL

Wiring Loom Installation Instructions

Honda Civic Hatch MY12  
Part No: 100822-WL

Tail Harness Length Required: 1200mm

Wiring Loom Installation Time: Approx 30 Mins



Wiring Loom Fitting Instructions  
To Suit Honda Civic Hatch MY12  
Part Number 100822-WL

1. Gain access to the luggage compartment and fold down the rear passenger seats.
2. Remove the floor carpet.
3. Remove the spare wheel by removing the spare wheel fastener.
4. Remove the luggage compartment rear trim by pulling the upwards.
5. Remove the centre tray cover.
6. Remove the centre tray.
7. In the wheel well below the centre divider, open the fastener covers on the LHS & RHS and remove the two fasteners from underneath.
8. Remove the centre divider by removing the two fasteners.
9. Carefully dislodge the back section of the RHS luggage compartment rear trim.
10. From behind the trim, disconnect the RHS luggage trim light connector.
11. Dislodge the RHS door trim along with the front section of the RHS luggage compartment trim and then remove the luggage compartment trim.
12. Carefully dislodge the back section of the LHS luggage compartment rear trim.
13. Dislodge the LHS door trim along with the front section of the LHS luggage compartment trim and remove the luggage compartment trim.
14. If the LHS vehicle grommet is not in use by another accessory, remove the vehicle grommet from the vehicle (go to Step 16).
15. If the vehicle grommet is in use by another accessory, drill a Ø30mm hole using a step drill next to the existing vehicle grommet. Spray on rust inhibitor after drilling.
16. Route the trailer patch (P/No: 100822-WL) up along the LHS vehicle harness towards the tail light connectors.
17. Disconnect the LHS vehicle tail light connectors and patch the trailer patch (P/No: 100822-WL) connectors in between.

## Wiring Loom Fitting Instructions To Suit Honda Civic Hatch MY12 Part Number 100822-WL

18. Tap into the vehicle connector PINK reverse wire (1) using a supplied ezy-tap (2).  
Connect the trailer patch ezy-tap terminal (3) onto the ezy-tap (2).
19. Secure the trailer patch ground ring terminal (4) to the vehicle grounding point (5).

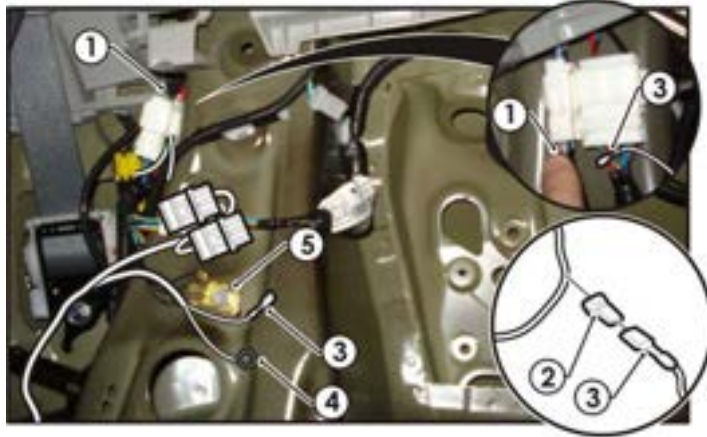

Function	Trailer Patch	Vehicle Connector
REVERSE	BLACK	PINK

20. Route the trailer patch (P/No: 100822-WL) along the rear of the luggage compartment area towards the RHS tail light connector area.
21. Disconnect the RHS tail light connectors and connect the trailer patch (P/No: 100822-WL) in between.
22. Mount the trailer socket to the towbar mounting bracket using M4 fasteners (not supplied).
23. Route the tail harness (tail length 1200mm) along the towbar and up through the previously drilled out hole.
24. Connect the tail harness to the trailer patch connector.
25. Ensure the tail harness grommet is seated correctly and makes a good seal.
26. Secure the grommet in place using a cable tie (not supplied).