



Towbar Fitting Instructions  
To Suit HYUNDAI ELANTRA SEDAN & HATCH 1/01-ON  
Part Number HY17  
Rating 850Kg

1. Ensure all hardware items have been included.
2. Remove rear bumper bar.
3. Remove rear and quarter trim panels.
  - 3a. Remove rear quarter and trim panels.
  - 3b. Remove left & right hand tail assemblies.
  - 3c. Remove two bolts holding bumper bar to rear quarter panels from inside luggage area.
  - 3d. Remove three self-tapping screws from each wheel arch.
  - 3e. Remove four plastic trim buttons from bottom rear flange of bumper.
  - 3f. Remove four plastic trim buttons from under rubber boot lip hatch seal.
  - 3g. Remove outer bumper skin and cut as per diagram.
4. Remove two bolts each side holding impact beam arm to sub frame and discard.
5. Hold towbar up to vehicle and align side arms with captive nuts from impact beam arms.
6. Fit bolts supplied as per drawing.
7. Fit M12 bolt and tapped loose plate to shipping hook.
8. Tighten all bolts to torque listing below.
9. Refer to diagram for bumper cut out.
10. Refit bumper bar in reverse of step 3.

**RECOMMENDED ASSEMBLY TORQUE LISTING**

<u>Diameter</u>	<u>Grade 8.8 Bolt</u>
	<u>Nm</u>
M6	9.5
M8	21.7
M10	43.4
M12	77.3
M14	121.0
M16	189.8

Towbar Fitting Instructions  
 To Suit HYUNDAI ELANTRA SEDAN & HATCH 1/01-ON  
 Part Number HY17  
 Rating 850Kg

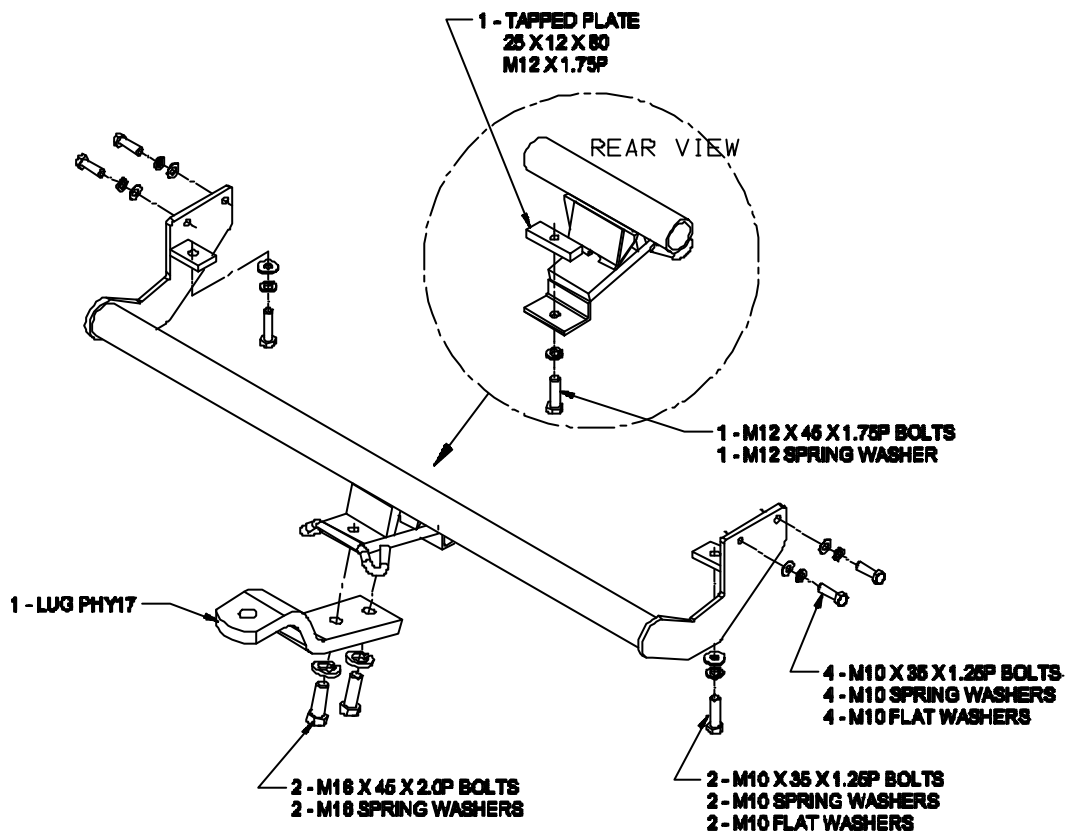

REAR BUMPER BAR  
 CUT OUT DIAGRAM

