

# TRAILBOSS

## Towbar Fitting Instructions To Suit PEUGEOT 208 Part Number PG18L Rating 1150/46 kg

PLACE THESE INSTRUCTIONS IN THE VEHICLE'S GLOVEBOX AFTER INSTALLATION IS COMPLETED

### **WARNING:**

1. Do not, drill, cut, weld or otherwise modify the tow bar.
2. If you are using electric welding on a motor vehicle, **always** check that the vehicle is not equipped with electronic engine or instrument management equipment. Failure to do so could **destroy** any onboard computers. If in doubt, check with the vehicle's manufacturer.
3. The high tensile fasteners supplied with this product were used to achieve the specified rating. If replacement is required ensure that fasteners of the same rating & quality are used. Contact an authorised **Trailboss** dealer if further information is required.
4. If TBM is used in inverted position tow ball may make contact with rear tailgate when lowered, which could cause damage.

### **General:**

1. Ensure all hardware items have been included refer to assembly diagram.
2. It is recommended that the instructions are read through and completely understood before making any attempt to fit this product.
3. Be wary of any changes to vehicle designs or other accessories that may conflict with the installation of this product.
4. Before drilling ensure that the area is clear of fuel, electrical & other components.
5. All holes drilled into the body panels shall have all burrs & swarf removed then coated with a suitable rust preventative paint.
6. For vehicles that require the bumper to be cut. Ensure cut out area is in correct position on the vehicle prior to cutting the bumper.
7. The high tensile fasteners supplied with this product were used to achieve the specified rating. If replacement is required ensure that fasteners of the same rating & quality are used. Contact an authorized **Trailboss** dealer if further information is required.
8. Ensure that all hardware is fastened to torque list below check fasteners on regular basis.
9. Tow bar load rating sticker provided with this product shall be conspicuously located on inside rear end of the driver's door. **(See diagram below).**
10. Trailboss recommends that you check your tow ball to ensure that it complies with the Australian standards **AS 4177.2.**
11. **PLEASE NOTE:** It is advised to remove your lug or tbm when not actually towing so as to produce a clear view of the vehicles registration plate if obscured, and to also provide maximum available departure angle
12. Pull Pin must be fit in down position.

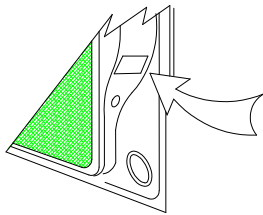

Place load rating sticker  
inside driver's door here

**FOR TRAILER TOWING PURPOSES ONLY**  
For towing capacity details please refer to vehicle owner's manual or to the manufacturer. Overloading can void your warranties.

### **RECOMMENDED ASSEMBLY TORQUE LISTING**

Diameter	Grade 8.8 Bolt
M6	9.5 Nm
M8	21.7 Nm
M10	43.4 Nm
M12	77.3Nm
M14	146 Nm
M16	189.8 Nm

### **Tow bar Maintenance and Care.**

Trailboss recommends that bolt torque's, as listed below, are routinely and regularly inspected and checked for correct tension. Replace any worn or defective parts.

We recommended to remove Tow Ball Mounts (TBM's, tongues or lugs) when not being used for any considerable length of time.

So as to avoid injury, when not towing it is suggested that the tongue, Pull Pin and R-clip are removed then stored in a safe, clean and dry place, away from excessive moisture.

Hitch Pull Pins and spring "R" clips are regularly checked for proper installation. Replace any worn or defective parts.

# TRAILBOSS

Towbar Fitting Instructions  
 To Suit PEUGEOT 208  
 Part Number PG18L  
 Rating 1150/46 kg

PLACE THESE INSTRUCTIONS IN THE VEHICLE'S GLOVEBOX AFTER INSTALLATION IS COMPLETED

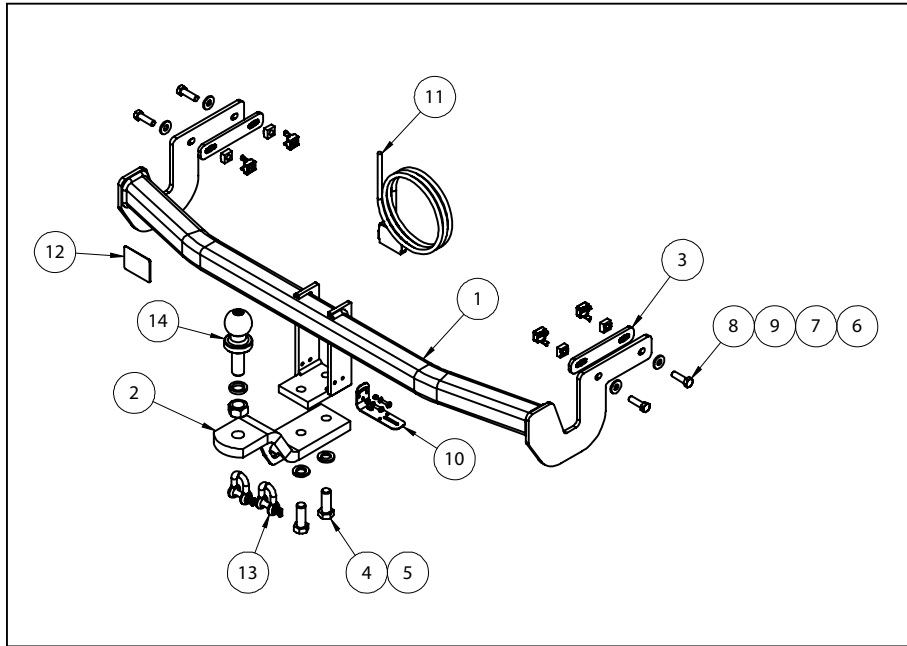

QTY.	DESCRIPTION	ITEM NO.
1	WELDED ASSY	1
1	CL2 TONGUE ASSY	2
2	CAGE NUT PLATE	3
2	BOLT M16x45 2.0P	4
2	SPRING WASHER M16x5x3.5	5
4	CAGE NUT RETAINER	6
4	CAGE NUT M10x1.5	7
4	SET SCREW M10-1.5x35mm	8
4	WASHER FT M10x25.4x3	9
1	UNIVERSAL PLUG BRACKET KIT	10
1	WIRING LOOM	11
1	ACRYLIC COMPLIANCE PLATE	12
2	10mm "D" SHACKLE	13
1	50mm TOWBALL	14



Towbar Fitting Instructions  
To Suit PEUGEOT 208  
Part Number PG18L  
Rating 1150/46 kg

PLACE THESE INSTRUCTIONS IN THE VEHICLE'S GLOVEBOX AFTER INSTALLATION IS COMPLETED

**INSTRUCTION:**

1. Remove Screw in wheel well.
2. Remove 2x Scrivets under bumper.
3. Remove tail lights.  
  
Loosen nut behind side panel in boot cavity, pull tail light rearwards.  
  
Disconnect wiring plugs.
4. Remove Screw in tail light cavity.  
  
Both sides.
5. Remove 2x Screws below bumper.
6. Remove 1x Screw behind wheel well trim on both sides.  
  
Pull white plastic tab downwards to loosen bumper trim.
7. Remove rear bumper.
8. Remove impact beam.
9. Cut rear vehicle panel to gain access to inner chassis rail.  
  
Using template provided.  
  
Apply anti-rust grease to exposed metal.
10. Insert Cage Nuts into loose plates provided.
11. Remove stickers concealing chassis rail holes.
12. Install Towbar to vehicle.
13. Reinstall bumper following steps 1 to 7 in reverse.

### **ⓘ CUTTING INFORMATION:**

- BEFORE PROCEEDING, ENSURE SCALE IS CORRECT.
- CUT OUT TEMPLATES FOLLOWING PATTERN PROVIDED.
- ATTACH CUTOUTS TO VEHICLE CHASSIS, ALIGNING HOLES WITH THOSE OF THE CHASSIS RAIL.
- USE A DRILL TO INITIATE HOLES IN SECTION.
- CUT OUT, THEN USE AN AIR SAW OR SIMILAR TOOL TO REMOVE SECTION.
- REMOVE ANY BURRS OR SHARP EDGES WITH A FILE.

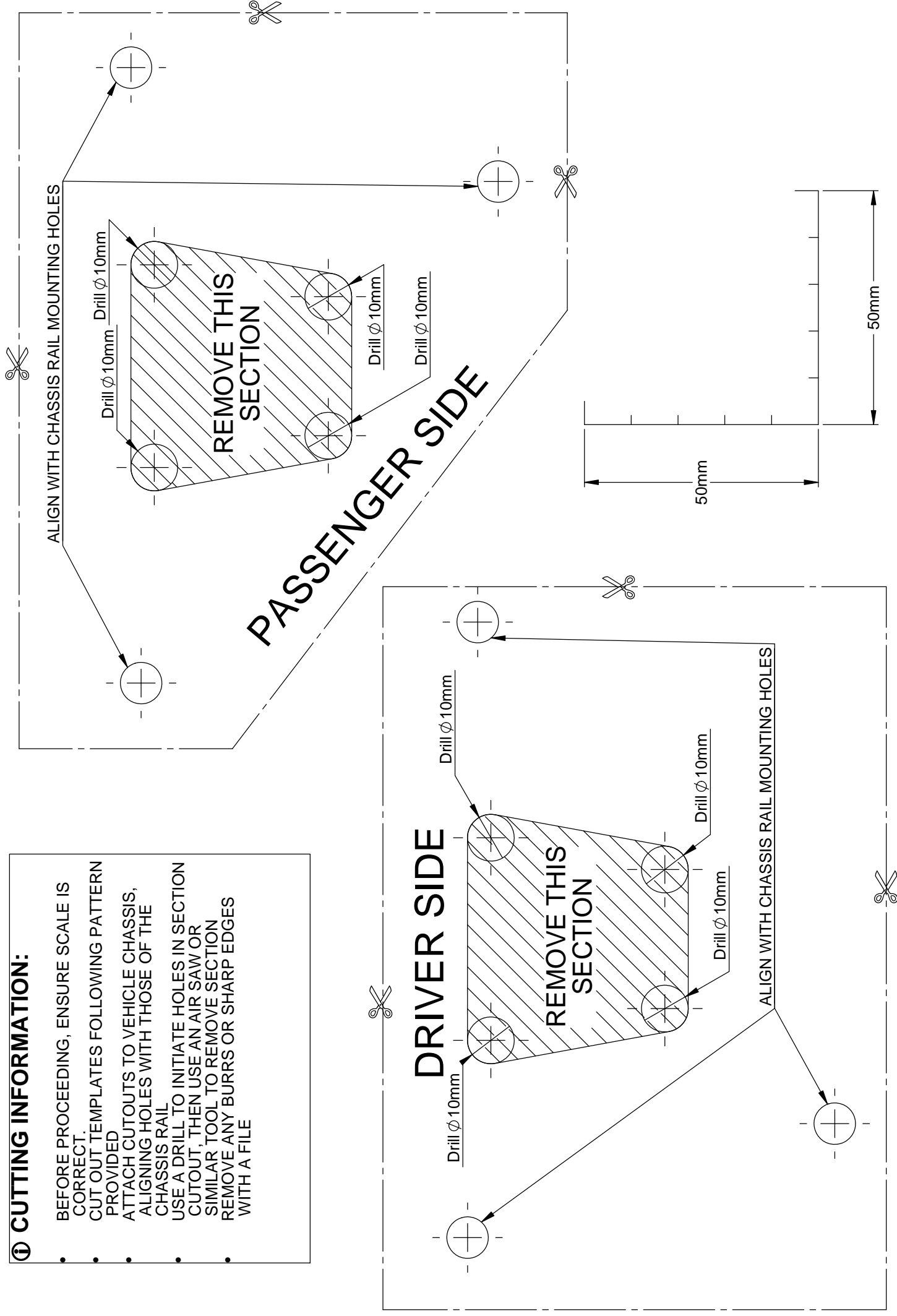



Wiring Loom Fitting Instructions  
To Suit Peugeot 208 Hatch  
Part Number 101314-WL

Wiring Loom Installation Instructions

Peugeot 208 Hatch  
Part No: 101314-WL  
ECU Required: 04826

Tail Harness Length Required: 1200mm

Wiring Loom Installation Time: Approx 40 Mins



Wiring Loom Fitting Instructions  
To Suit Peugeot 208 Hatch  
Part Number 101314-WL

1. In the luggage compartment, remove the floor carpet and centre tool tray.
2. Remove the rear luggage compartment trim by removing the one fastener on each side.
3. Dislodge the luggage compartment RHS trim by removing the three fasteners. Remove the RHS access panel to expose the tail light connectors.
4. Disconnect the tail light connector. **Repeat for the LHS.**
5. Patch the trailer patch connectors (P/No: 101314-WL) in between the LHS tail light connectors.
6. Route the trailer patch harness inside the trim cavities and across the rear of the vehicle and towards the RHS tail light connectors.
7. Route the trailer patch connectors to the RHS tail light connectors and connect them in between the RHS tail light connectors.
8. Near the tail light area, peel away areas of the RHS vehicle foam to gain access to the sheet metal surface to adhere the ECU onto.
9. Connect the trailer patch ECU connector to the ECU. Remove the backing from the back of the ECU and mount the ECU onto the sheet metal area. **Ensure ECU connector is pointing downwards.**
10. Secure the trailer patch ground ring terminal to the vehicle grounding point nearby.
11. Dislodge the LHS 'B' pillar trim to allow for harness routing along the vehicle harness.
12. Open the glove compartment.
13. Open the glove compartment fuse panel lid.
14. Route the trailer patch power wire branch into the glove compartment fuse panel area by routing along the LHS of the vehicle following the vehicle harness.

## Wiring Loom Fitting Instructions To Suit Peugeot 208 Hatch Part Number 101314-WL

15. Remove the indicated vehicle 20A fuse (1). Insert the vehicle fuse 20A fuse (1) and the supplied 15A fuse (2) to the add-a-fuse harness (3). Connect the trailer patch 1-way connector (4) to the add-a-fuse harness (3). Insert the add-a-fuse harness to the previously removed fuse location (1). **Ensure add-a-fuse harness is inserted with the harness branch pointing towards the RHS of the vehicle.**

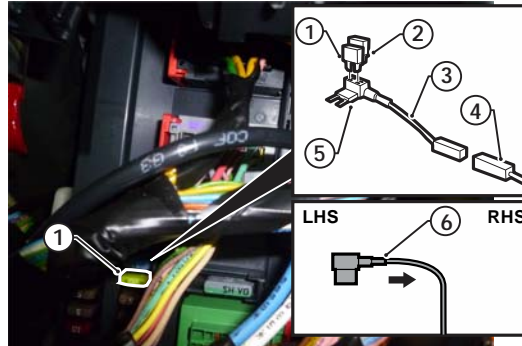

16. At the RHS rear quarter of the vehicle, find a suitable location to drill into the vehicle sheet metal area (located between the rear of the vehicle and the rear wheel arch guard). Drill a  $\varnothing 30\text{mm}$  hole into the sheet metal. **Ensure the area being drilled into is clear of any obstructions.**
17. File down any rough or sharp edges and apply rust inhibitor (not supplied).
18. Mount the tail harness socket to the towbar mounting bracket using M4 fasteners (not supplied).
19. Route the tail harness towards the RHS, up through the previously drilled hole.
20. Ensure the tail harness grommet is seated correctly and secure in place using a cable tie (not supplied).
21. Connect the tail harness (tail length 1200mm) 8-way connector to the trailer harness mating 8-way connector.
22. Test the trailer harness function using a light board or multi-meter.
23. Secure all harness using cable ties (not supplied).
24. Re-fit all removed parts and secure all fasteners, ensuring there are no squeaks or rattles.
25. Place instructions in glove box after fitment.