

TRAILBOSS

Towbar Fitting Instructions
To Suit **FOTON TUNLAND DUAL CAB P201**
Part Number **QTFT2L**
Rating **2500/250 kg**

PLACE THESE INSTRUCTIONS IN THE VEHICLE'S GLOVEBOX AFTER INSTALLATION IS COMPLETED

WARNING:

1. Do not, drill, cut, weld or otherwise modify the tow bar.
2. If you are using electric welding on a motor vehicle, **always** check that the vehicle is not equipped with electronic engine or instrument management equipment. Failure to do so could **destroy** any onboard computers. If in doubt, check with the vehicle's manufacturer.
3. The high tensile fasteners supplied with this product were used to achieve the specified rating. If replacement is required ensure that fasteners of the same rating & quality are used. Contact an authorised **Trailboss** dealer if further information is required.
4. If TBM is used in inverted position tow ball may make contact with rear tailgate when lowered, which could cause damage.

General:

1. Ensure all hardware items have been included refer to assembly diagram.
2. It is recommended that the instructions are read through and completely understood before making any attempt to fit this product.
3. Be wary of any changes to vehicle designs or other accessories that may conflict with the installation of this product.
4. Before drilling ensure that the area is clear of fuel, electrical & other components.
5. All holes drilled into the body panels shall have all burrs & swarf removed then coated with a suitable rust preventative paint.
6. For vehicles that require the bumper to be cut. Ensure cut out area is in correct position on the vehicle prior to cutting the bumper.
7. The high tensile fasteners supplied with this product were used to achieve the specified rating. If replacement is required ensure that fasteners of the same rating & quality are used. Contact an authorized **Trailboss** dealer if further information is required.
8. Ensure that all hardware is fastened to torque list below check fasteners on regular basis.
9. Tow bar load rating sticker provided with this product shall be conspicuously located on inside rear end of the driver's door. **(See diagram below).**
10. Trailboss recommends that you check your tow ball to ensure that it complies with the Australian standards **AS 4177.2**.
11. **PLEASE NOTE:** It is advised to remove your lug or tbm when not actually towing so as to produce a clear view of the vehicles registration plate if obscured, and to also provide maximum available departure angle
12. Pull Pin must be fit in down position.

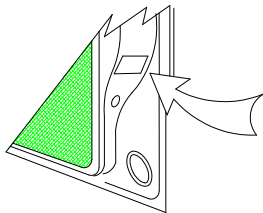

Place load rating sticker
inside driver's door here

FOR TRAILER TOWING PURPOSES ONLY
For towing capacity details please refer to vehicle owner's manual or to the manufacturer. Overloading can void your warranties.

RECOMMENDED ASSEMBLY TORQUE LISTING

Diameter	Grade 8.8 Bolt
M6	9.5 Nm
M8	21.7 Nm
M10	43.4 Nm
M12	77.3Nm
M14	146 Nm
M16	189.8 Nm

Tow bar Maintenance and Care.

Trailboss recommends that bolt torque's, as listed below, are routinely and regularly inspected and checked for correct tension. Replace any worn or defective parts.

We recommended to remove Tow Ball Mounts (TBM's, tongues or lugs) when not being used for any considerable length of time.

So as to avoid injury, when not towing it is suggested that the tongue, Pull Pin and R-clip are removed then stored in a safe, clean and dry place, away from excessive moisture.

Hitch Pull Pins and spring "R" clips are regularly checked for proper installation. Replace any worn or defective parts.

TRAILBOSS

Towbar Fitting Instructions
 To Suit **FOTON TUNLAND DUAL CAB P201**
 Part Number **QTFT2L**
 Rating **2500/250 kg**

PLACE THESE INSTRUCTIONS IN THE VEHICLE'S GLOVEBOX AFTER INSTALLATION IS COMPLETED

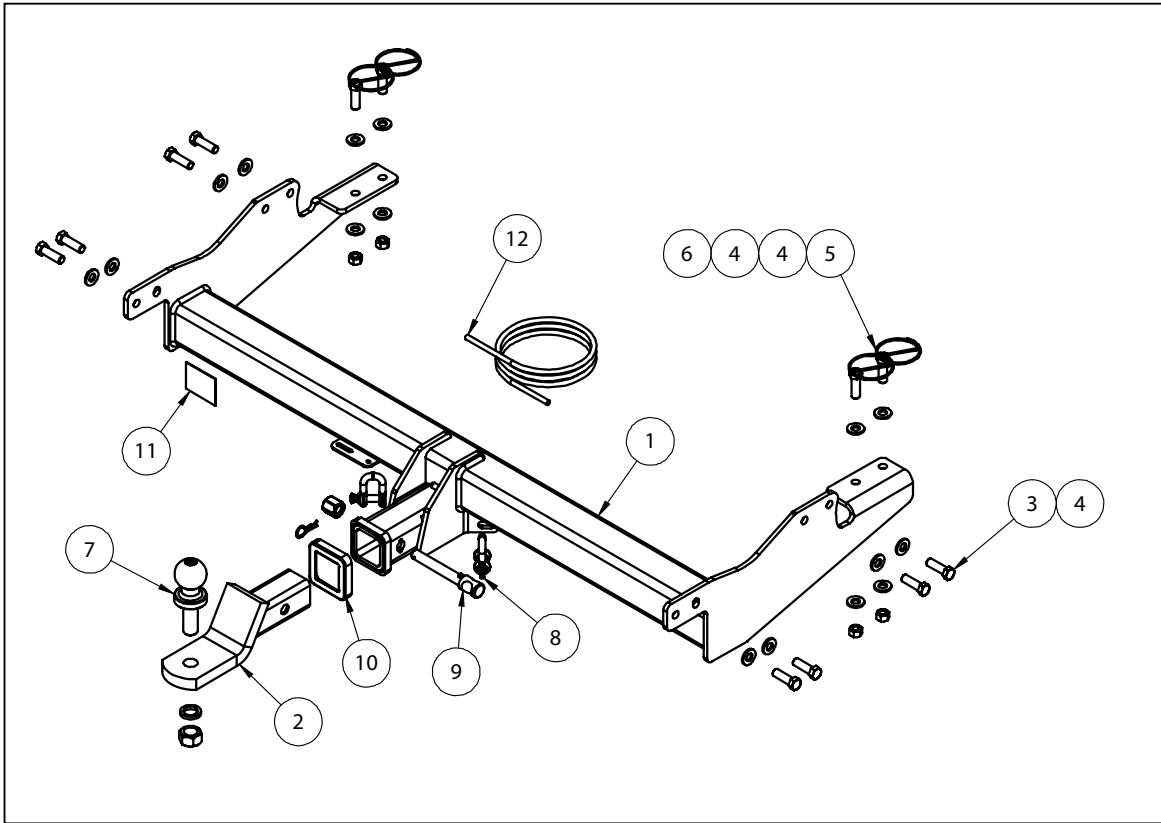

QTY.	DESCRIPTION	ITEM NO.
1	WELDED ASSEMBLY	1
1	CLASS 4 TBM ASSY	2
8	SET SCREW M12x40x1.75P	3
16	WASHER FLAT 1/2"x1 1/8"x1/8"	4
4	BOLT WASHER WIRE M12x40x1.75x300	5
4	HEX NUT M12x1.75 PC8	6
1	50mm TOWBALL	7
2	10mm "D" SHACKLE	8
1	ANTI-RATTLE PULL PIN ASSY	9
1	HITCH BOX COLLAR COVER	10
1	ACRYLIC CP	11
1	16 STRANDx0.3mm 7 CORE CABLE	12



Towbar Fitting Instructions
To Suit **FOTON TUNLAND DUAL CAB P201**
Part Number **QTFT2L**
Rating **2500/250 kg**

PLACE THESE INSTRUCTIONS IN THE VEHICLE'S GLOVEBOX AFTER INSTALLATION IS COMPLETED

INSTRUCTION:

1. Disconnect plugs for fog lights, rear parking sensors and number plate lights.
2. Unclip wiring from rear step and left hand rear step support bracket.
3. Remove and discard 4x Set Screws (2 per side) securing rear step to rear step bracket.
4. Remove rear step and store in safe place.
5. Remove and discard 2x Set Screws securing rear step support bracket to chassis rail. Repeat for opposite side of the vehicle. Discard rear step support brackets.
6. Loosely secure Towbar to outside face of chassis rails using 4x M12 Set Screws (2 per side arm), complete with 1x M12 Flat Washer per Set Screw.
7. Loosely secure Towbar to bottom face of chassis rail using 4 x M12 Bolts on wires (2 per side arm), complete with 2x M12 Flat Washers and 1x M12 Nut per side Bolt.
8. Tighten the 4x Set Screws and 4x Nuts to torque specified on page 1 of this document.
9. Loosely secure rear step to Towbar side arms using 4x Set Screws (2 per side arm), complete with 1x Flat Washer per Set Screw.
10. Align step to level with ground; tighten 4x Set Screws to torque specified on page 1 of this document.
11. Reconnect plugs that were disconnected in step 1 of these fitting instructions. Reclip wire to rear step.



Wiring Loom Fitting Instructions
To Suit Foton Tunland
Part Number 101313-WL

Wiring Loom Installation Instructions

Foton Tunland
Part No: 101313-WL

ECU Required: 04826
Tail Harness Length Required: 400mm
Power Harness Required: 04825

Wiring Loom Installation Time: Approx 20 Mins



Wiring Loom Fitting Instructions To Suit Foton Tunland Part Number 101313-WL

1. Disconnect the engine bay battery negative terminal and wait for 90 seconds before starting.
2. At the rear of the vehicle, remove the LHS tail light by removing the two hex bolts. Repeat this step for the RHS of the vehicle.
3. Patch the trailer patch (P/No: 101313-WL) connectors in between the tail light connectors.
4. Route the trailer patch harness LHS connectors branch underneath the vehicle and towards the LHS of the vehicle. Patch the LHS connectors by repeating Step 3.
5. Using alcohol wipes (not supplied), clean the inner RHS sheet metal area in the RHS tail light interior cavity. This is where the ECU (04826) will be mounted. **Ensure the mounting area does not interfere with the re-fitment of the tail light assembly.**
6. Connect the trailer patch ECU connector to the ECU. Apply electrical grease to the back of the ECU connector.
7. Remove the adhesive backing from the ECU and adhere the ECU into place on the cleaned sheet metal area. **Ensure the ECU is mounted with the connector pointing downwards.**
8. Using a tek screw (not supplied), secure the trailer patch ground ring terminal onto the RHS tail light cavity sheet metal area next to the vehicle grommet hole.
9. At the rear exterior of the vehicle, mount the tail harness (tail length 400mm) socket to the towbar mounting bracket using M4 fasteners (not supplied). Route the tail harness up the centre LHS of the vehicle.
10. Underneath the vehicle, connect the tail harness 8-way connector to the trailer patch 8-way mating connector. **Water proof the trailer patch 8-way connector and tail harness 8-way mating connector using silicone or electrical grease (not supplied).**
11. In the engine bay, secure the power harness (P/No: 04825) ring terminal to the engine bay positive terminal. Drop the power harness down the engine bay towards the LHS chassis rail.
12. Route the power harness along the LHS chassis rail, all the way to the rear of the vehicle.
13. Connect the power harness 1-way connector to the trailer patch 1-way connector on the trailer patch harness.
14. Re-fit the negative battery terminal.
15. Test the Trailer Harness function using a light board or multi-meter.
16. Secure all harnesses using cables ties (not supplied).
17. Re-fit all removed parts and secure all fasteners, ensuring there are no squeaks or rattles.
18. Place the instructions in the glove box after fitment.



FITTING INSTRUCTIONS

Silent Anti-Rattle Hitch Pin (PR0001)

• These fitting instructions are supplied to ensure understanding of how the HITCH PIN should be fitted and used correctly.

• Once installed, we recommend **ALL** instructions are kept and placed in the vehicle glove box.

NOTE: Routine maintenance and inspection of the towbar & HITCH PIN is required. Regularly inspect for wear and check the tightness of the Hitch Pin. Follow instructions below to retighten the nut when necessary.

***Do not tow with your vehicle if the R CLIP or the HITCH PIN is loose or missing. Replacement parts are available from your Pro Series Distributor.**

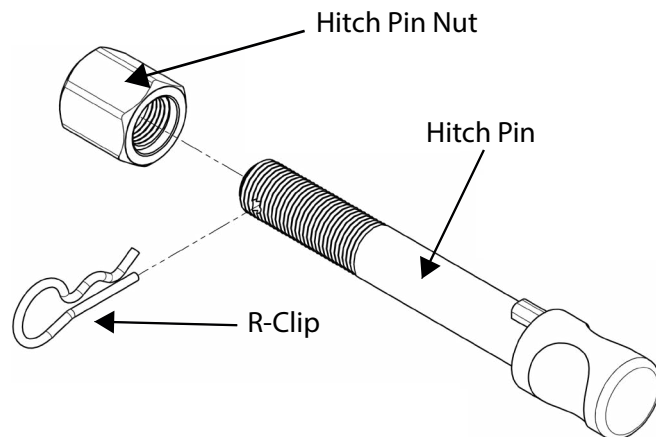

Fig 1. Silent Anti-Rattle Hitch Pin assembly

STEP 1

Insert Trailer Ball Mount (TBM) into towbar HITCHBOX, aligning hole in TBM SHANK with hole in HITCHBOX (Fig 2).

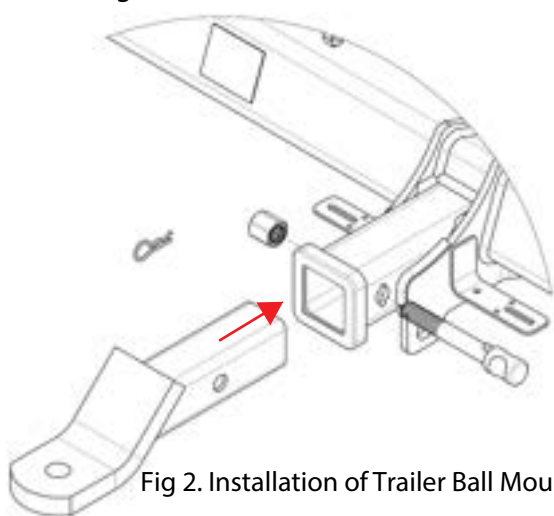

Fig 2. Installation of Trailer Ball Mount

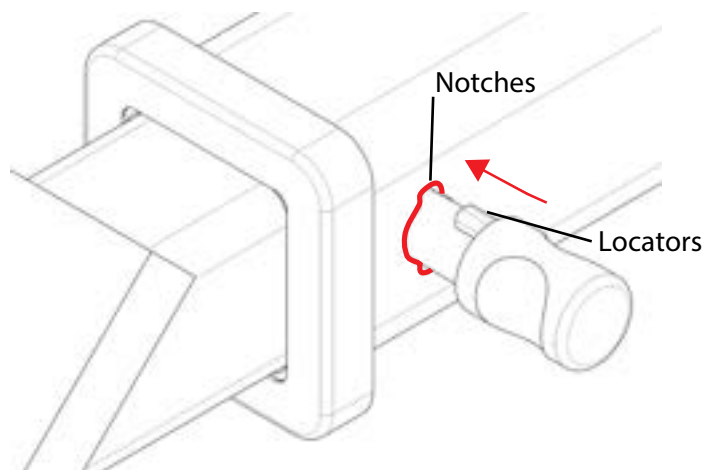

Fig 3. Silent Anti-Rattle Hitch Pin orientation

STEP 2

Insert HITCH PIN through hole in HITCHBOX and hole in TBM SHANK; ensure the LOCATORS are inserted into the NOTCHES in the HITCHBOX (Fig. 3).

STEP 3

Screw HITCH PIN NUT onto HITCH PIN; tighten HITCH PIN NUT until finger tight, ensuring TBM is restrained from movement.

STEP 4

Tighten HITCH PIN NUT by turning nut a further 1/8th of a turn in the clockwise direction using a 24mm spanner (Fig. 4).

STEP 5

Install HITCH PIN R CLIP through the hole on the HITCH PIN (Fig. 1).

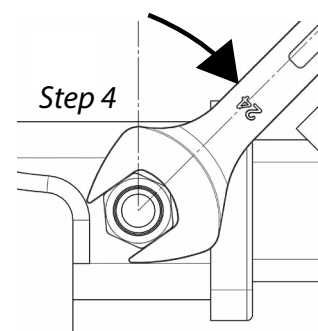

Fig 4. Tightening of Silent Anti-Rattle Hitch Pin Nut