



Towbar Fitting Instructions
To Suit Holden Commodore Ute VU 1/01 - ON
Part Number QTHD488L
Rating 1600Kg

1. Ensure all hardware items have been included.
2. From inside tub body using pop marks as guides, (three drivers' side, two passenger side) drill through the top panel only of each pop mark with a 22mm hole saw.
3. From underneath the vehicle and on the driver's side, place fitting plate on wire (item 18) through the forward most slot in chassis to align with forward most holes.
4. Fit bolts (items 7 & 11), fitting plates (items 1 & 2) and spacer tubes (items 8, 12, 13 & 14) as per drawing, insuring that bolts and spacer tubes align with fitting plates on wire (item 18).
5. Lift towbar into position and fit spring washers (item 9) and nuts (item 10) as per drawing.
6. Fit 2- M10 x 25 – 1.5p bolts, spring washer and nuts (items 15, 16 & 17) to centre mounting plate.
7. Tighten all bolts to torque listing below.
8. Attach the plastic hitch box collar cover (item 6) by applying firm even pressure.
9. Insert the tongue (item 5) into the hitchbox and secure with "R" clip and pull pin (items 3 & 4)

COMPONENT KIT

ITEM No.	DESCRIPTION	QTY	TORQUE Nm
1	FITTING PLATE PASSENGER 6 x 160 x 125 (Z/PLT)	1	
2	FITTING PLATE DRIVER 6 x 250 x 150 (Z/PLT)	1	
3	PULL PIN (PIN_04)	1*	
4	"R" CLIP (PIN_01)	1*	
5	TONGUE (5196)	1	
6	COLLAR COVER (COL_04)	1	
7	M12 x 120 – 1.75P COACH BOLT	2	77
8	SPACER TUBE Ø21.3 x 3.2 x 72	2	
9	M12 SPRING WASHER	5	
10	M12 x 1.75P NUT	5**	
11	M12 x 110 – 1.75P COACH BOLT	3	77
12	SPACER TUBE Ø21.3 x 3.2 x 54	1	
13	SPACER TUBE Ø21.3 x 3.2 x 59	1	
14	SPACER TUBE Ø21.3 x 3.2 x 68	1	
15	M10 x 25 – 1.5P BOLT	2	44
16	M10 SPRING WASHER	2	
17	M10 x 1.5P NUT	2	
18	FITTING PLATE & WIRE	2	
19	M12 x 30 – 1.75P BOLT (NOT SHOWN FOR TRANSIT ONLY)	2**	

Note: * One of each item 3 and 4 is used to secure the tongue to the towbar during transit.

**Two of each item 10 and 20 is used to secure item 1 and 2 to the towbar during transit

Towbar Fitting Instructions
To Suit Holden Commodore Ute VU 1/01 - ON
Part Number QTHD488L
Rating 1600Kg

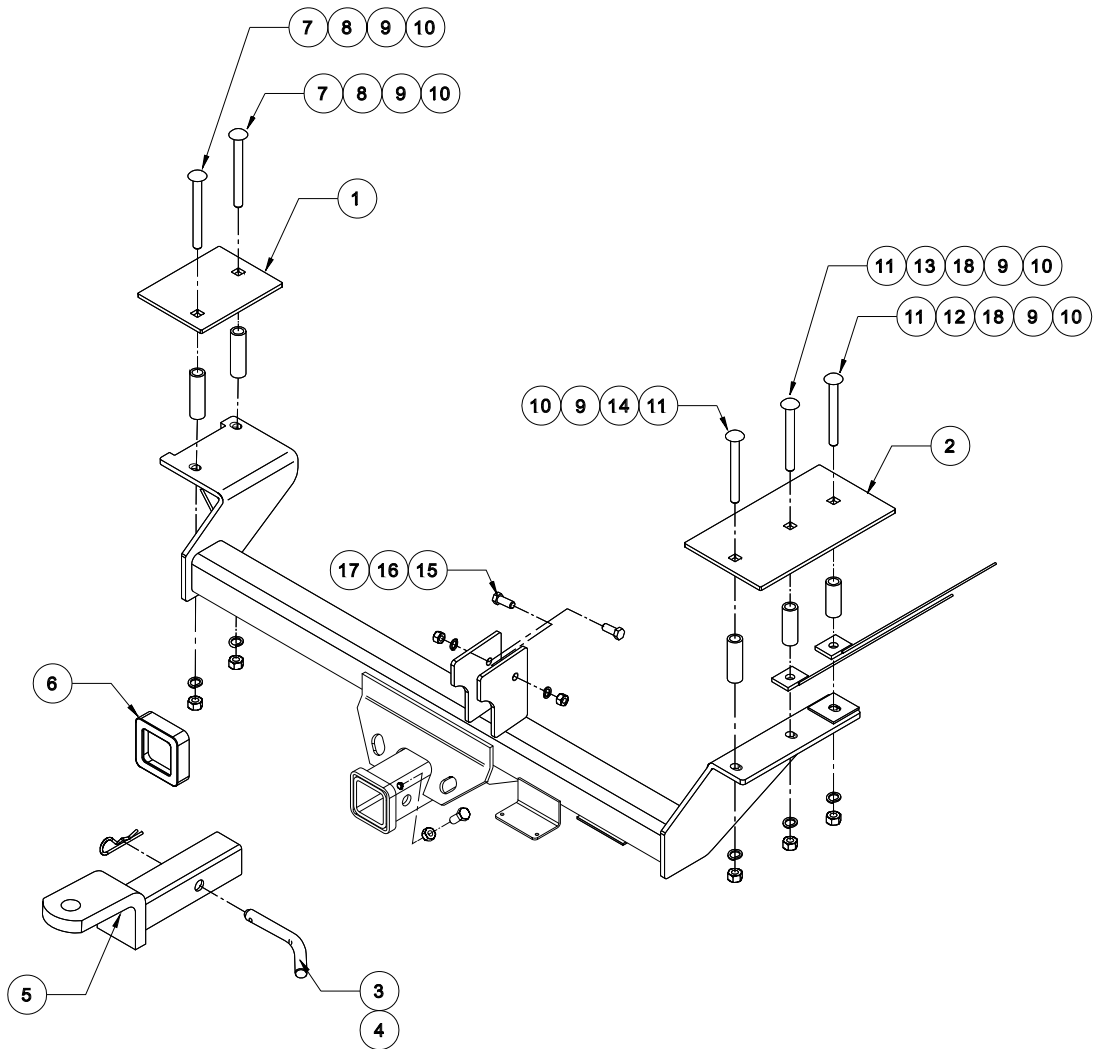



Towbar Fitting Instructions
To Suit Holden Commodore Ute VU 1/01 - ON
Part Number QTHD488L
Rating 1600Kg

Wiring Loom Installation Instructions

Holden VY Commodore Sedan & Wagon
Holden Statesman Sedan & Wagon

Part No: 100044-WL
Tail Harness Length Required: 1200mm
RPA Override Switch Part No: 04848 (If Fitted)

Wiring Loom Installation Time: Approx 20 Mins



Towbar Fitting Instructions
To Suit Holden Commodore Ute VU 1/01 - ON
Part Number QTHD488L
Rating 1600Kg

Note: For Wagon models, go to step 13.

For VT, VX, VY and VZ sedan models, continue:

1. In the luggage compartment, remove all trims required to gain access to the tail lights.
2. Remove the rear bumper fascia fasteners and then remove the rear bumper fascia (1).
3. Drill a Ø30mm grommet hole into the location shown (2). File down any rough edges and spray on rust inhibitor.
4. Mount the Tail Harness socket (Tail length 1200mm) to the towbar mounting bracket using M4 fasteners.
5. Route the harness along the towbar and into the grommet hole.
6. In the luggage compartment, retrieve the Tail Harness.
7. Adjust the harness grommet to the desired position, ensuring that it is seated correctly into the vehicle grommet hole. Secure the vehicle grommet using a cable tie (not supplied).
8. On the outside of the vehicle, secure the harness to the towbar using cable ties (not supplied).
9. Disconnect the RHS tail light connectors and the 1-way indicator connector. Connect the Trailer Patch Harness (P/No: 100044-WL) in between the tail light connectors and the 1-way indicator connector.
10. Refit the rear bumper fascia.
11. Test the Trailer socket using a light board or multi-meter.
12. Secure the all harnesses using cables ties (not supplied). Refit all removed parts and secure all fasteners. Place instructions in glove box after fitment.



Towbar Fitting Instructions
To Suit Holden Commodore Ute VU 1/01 - ON
Part Number QTHD488L
Rating 1600Kg

The following steps for Wagon models only

13. Remove the rear bumper fascia.
14. Gain access to the tail lights.
15. Remove the tail light assembly.
16. Drill a Ø30mm hole into the rear tail gate, below the RHS tail light cavity opening. File down any rough edges and spray on rust inhibitor.
17. Mount the Tail Harness socket (Tail length 1200mm) to the towbar mounting bracket using M4 fasteners.
18. Route the Tail Harness along the towbar and into the grommet hole
19. Adjust the harness grommet to the desired position, ensuring that it is seated correctly into the vehicle grommet hole. Secure the vehicle grommet using a cable tie (not supplied).
20. Secure the harness to the towbar using cable ties (not supplied).
21. Disconnect the RHS tail light connectors and the 1-way indicator connector. Connect the Trailer Patch Harness (P/No: 100044-WL) in between the tail light connectors and the 1-way indicator connector
22. Connect the Tail Harness 8-way male connector to the Trailer Patch Harness 8-way female connector.
23. Test the Trailer Harness function using a Light Board or multimeter.
24. Secure the Trailer Patch Harness using cable ties (not supplied).
25. Refit all removed parts and secure all fasteners ensuring there are no squeaks or rattles.
26. Place instructions in glove box after fitment.