

TRAILBOSS

Towbar Fitting Instructions To Suit HOLDEN SPORTWAGON Jul-08 on Part Number QTHD512L Rating 2100 kg, Ball load 210 kg.

WARNING:

1. Do not, drill, cut, weld or otherwise modify the tow bar.
2. If you are using electric welding on a motor vehicle, **always** check that the vehicle is not equipped with electronic engine or instrument management equipment. Failure to do so could **destroy** any onboard computers. If in doubt, check with the vehicle's manufacturer.

General:

1. Ensure all hardware items have been included refer to assembly diagram.
2. It is recommended that the instructions are read through and completely understood before making any attempt to fit this product.
3. Be wary of any changes to vehicle designs or other accessories that may conflict with the installation of this product.
4. Before drilling ensure that the area is clear of fuel, electrical & other components.
5. All holes drilled into the body panels shall have all burrs & swarf removed then coated with a suitable rust preventative paint.
6. The high tensile fasteners supplied with this product were used to achieve the specified rating. If replacement is required ensure that fasteners of the same rating & quality are used. Contact an authorized **Trailboss** dealer if further information is required.
7. Ensure that all hardware is fastened to torque list below check fasteners on regular basis.
8. Tow bar load rating sticker provided with this product shall be conspicuously located on inside rear end of the driver's door. **(See diagram below).**
9. Trailboss recommends that you check your tow ball to ensure that it complies with the Australian standards **AS 4177.2**.
10. **PLEASE NOTE:** It is advised to remove your lug or tbn when not actually towing so as to produce a clear view of the vehicles registration plate if obscured, and to also provide maximum available departure angle

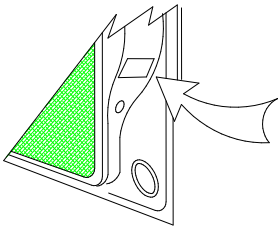

Place load rating sticker
inside driver's door here

FOR TOWING PURPOSES ONLY
For towing capacity details please refer to vehicle owner's manual or to the manufacturer. Overloading can void your warranties.

RECOMMENDED ASSEMBLY TORQUE LISTING

<u>Diameter</u>	<u>Grade 8.8 Bolt</u>
M6	9.5 Nm
M8	21.7 Nm
M10	43.4 Nm
M12	77.3Nm
M14	146 Nm
M16	189.8 Nm

Tow bar Maintenance and Care.

Trailboss recommends that bolt torque's, as listed below, are routinely and regularly inspected and checked for correct tension. Replace any worn or defective parts.

We recommended to remove Tow Ball Mounts (TBM's, tongues or lugs) when not being used for any considerable length of time.

So as to avoid injury, when not towing it is suggested that the tongue, Pull Pin and R-clip are removed then stored in a safe, clean and dry place, away from excessive moisture.

Hitch Pull Pins and spring "R" clips are regularly checked for proper installation. Replace any worn or defective parts.

TRAILBOSS

Towbar Fitting Instructions
To Suit HOLDEN SPORTWAGON Jul-08 on
Part Number QTHD512L
Rating 2100 kg, Ball load 210 kg.

11. Remove two scrivets and one screw retaining the bumper fascia from the inside rear wheel arch.
12. Remove three scrivets from under the bumper fascia.
13. Remove bumper fascia from the vehicle
14. Disconnect any parking sensor devices to free the bumper fascia.
15. Remove spare wheel cover.
16. Remove the rear luggage tie down points.
17. Remove floor covering and foam support to gain access to two M10 bolts securing tie down brackets on both sides.
18. Remove four M10 bolts from both sides. Retain M10x100 bolts for refit.
19. Slide rear impact beam rearward and discard.
20. Insert towbar assembly into vehicle chassis. Align mounting holes to luggage tie down points.
21. Using two existing M10x100 bolts and two M10X100 bolts and four spring washers supplied, reinstall luggage tie down points.
22. Tighten the bolts to recommended torque.
23. From inside rear bumper cut the opening from the top position indent shown "WAGON ONLY CUTOUT" down to 50mm above bottom indent.
24. Refit bumper bar.

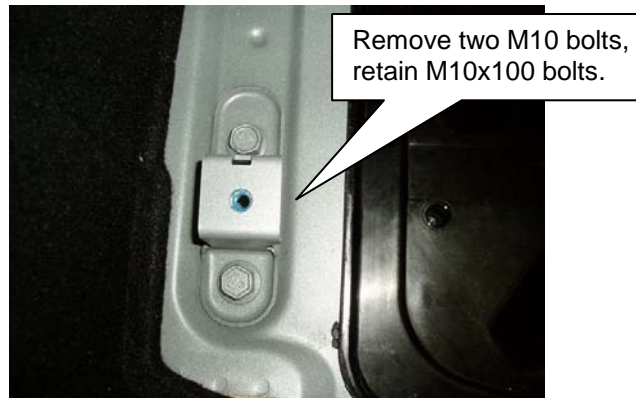
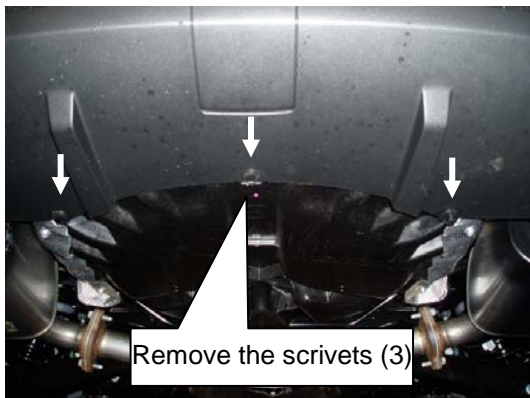

TRAILBOSS

Towbar Fitting Instructions
 To Suit HOLDEN SPORTWAGON Jul-08 on
 Part Number QTHD512L
 Rating 2100 kg, Ball load 210 kg.

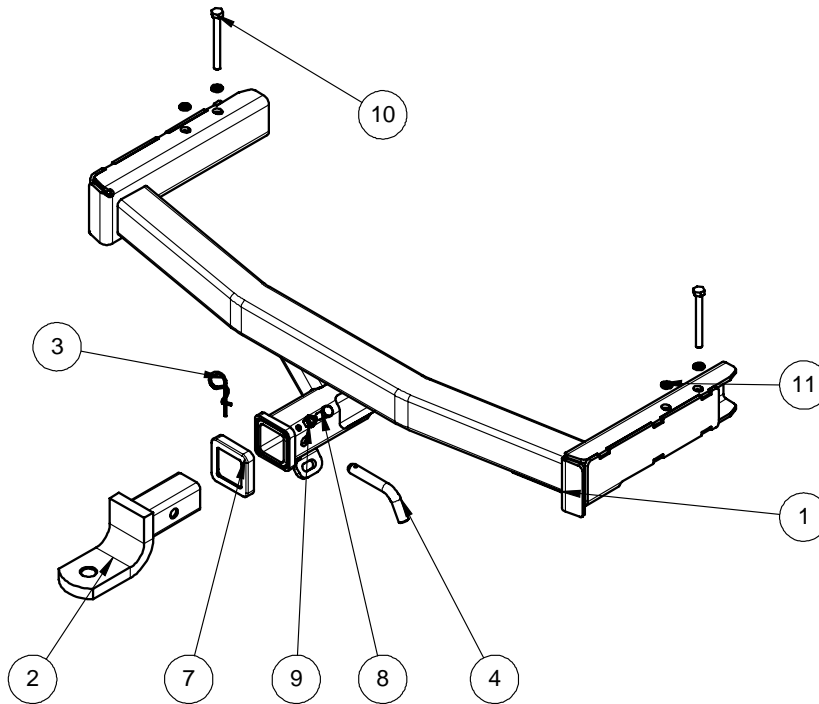
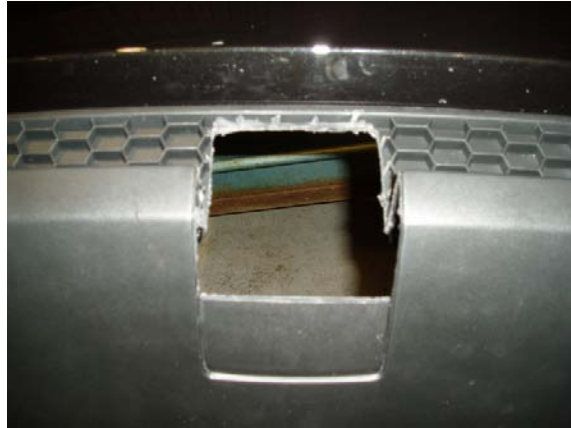
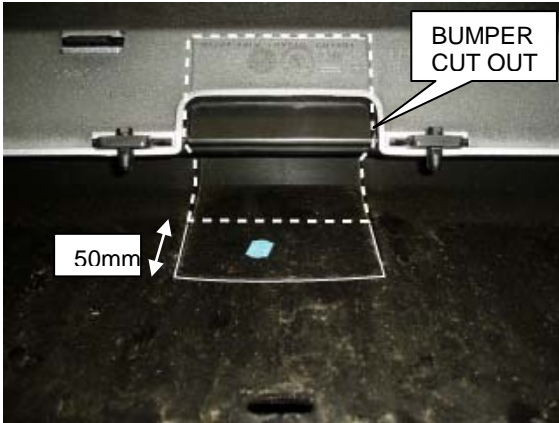

Items 5 & 6 are not shown

ITEM NO.	DESCRIPTION	QTY.
1	VE SPORT WAGON WELDED ASSEM	1
2	T.B.MOUNT	1
3	CLIP (SPRING COTTER PIN)	1
4	PULL PIN	1
5	FITTING INSTRUCTION	1
6	DOOR RATING STICKER	1
7	HITCH BOX COLLAR COVER	1
8	M10 x 25 1.5P BOLT	1
9	NUT M10 x 1.5P	1
10	M10 x 100 1.5P BOLT	2
11	M10 SPRING WASHER	4



Wiring Loom Fitting Instructions
To Suit Holden VE / WM Commodore Sedan & Wagon
Part Number 100007-WL

Wiring Loom Installation Instructions

Holden VE / WM Commodore Sedan & Wagon

Part No: 100007-WL

Tail Harness Length Required: 1800mm

ECU Required: 04826

RPA Override Switch Part No: 04848

(If Aftermarket RPA's Fitted)

Wiring Loom Installation Time: Approx 30 Mins

Sedan – Page 2

Wagon – Page 3



Wiring Loom Fitting Instructions
To Suit Holden VE / WM Commodore Sedan & Wagon
Part Number 100007-WL

This section is for Sedan vehicles only. For Wagon vehicles please refer to Page 3.

1. In the luggage compartment, remove all trims required to gain access to the tail lights.
2. Locate the RHS 12-way tail light connectors. Disconnect the tail light connectors and patch the Trailer Patch Harness (P/No: 100007-WL) connectors in between the tail light connectors.
3. Secure the Trailer Patch Harness ground ring terminal located near the RHS rear wheel arch area using a tech screw (not supplied).
4. Connect the Trailer Patch Harness (P/No: 100007-WL) 12-way female ECU connector into the ECU (P/No: 04826) and secure the ECU onto the vehicle harness at the wheel arch area using cable ties (not supplied).
5. Drill out a Ø31mm hole into the rear RHS area of the spare tyre well.
6. From outside of the vehicle, route the Tail Harness (tail length 1800mm) into the bumper towbar cut out and into the spare wheel well via the drilled out hole.
7. Mount the trailer socket on to the towbar socket mounting plate using M4 fasteners (not supplied).
8. Inside the spare wheel well, route the Tail Harness all the way through and adjust the Tail Harness grommet into position. Secure the Tail Harness grommet into place with a cable tie (not supplied).
9. Connect the 8-way male Tail Harness connector to the 8-way female Trailer Patch Harness connector.
10. Test the Trailer socket using a light board or multi-meter.
11. Secure all harnesses using cables ties (not supplied).
12. Re-fit all removed parts and secure all fasteners.
13. Place the instructions in the glove box after fitment.



Wiring Loom Fitting Instructions
To Suit Holden VE / WM Commodore Sedan & Wagon
Part Number 100007-WL

This section is for Wagon vehicles only. For Sedan vehicles please refer to Page 2.

1. In the luggage compartment, remove the floor carpet.
2. Remove the rear trim.
3. Remove the luggage compartment RHS rear side trim by removing the cargo strap hooks and the lower clip.
4. Remove the RHS foam spacer.
5. Dislodge the RHS rear side trim by first removing any clips or fasteners.
6. Locate the 12-way tail light connectors.
7. Disconnect the tail light connectors and patch the Trailer Patch Harness (P/No: 100007-WL) connectors in between the tail light connectors.
8. Secure the Trailer Patch Harness ground ring terminal using a tech screw as shown.
9. Connect the Trailer Patch Harness 12-way female ECU connector into the ECU (04826).
10. Apply double sided tape to the ECU and adhere it to the vehicle sheet metal on the RHS of the luggage compartment wheel arch.
11. Using a drill and a Ø31mm hole saw/step drill, drill a hole into the spare tyre well.
12. File any rough or sharp edges and spray on rust inhibitor.
13. From outside of the vehicle, route the Tail Harness (tail length 1800mm) into the bumper towbar cut out and into the spare wheel well via the drilled out hole.
14. Mount the trailer socket onto the towbar socket mounting plate using M4 fasteners (not supplied).
15. Inside the spare wheel well, route the Tail Harness all the way through and adjust the Tail Harness grommet into position.
16. Secure the Tail Harness grommet into place with a cable tie (not supplied).
17. Connect the tail harness 8-way connector to the trailer harness mating 8-way connector.
18. Test the trailer harness function using a light board or multi-meter.
19. Secure all harnesses using cables ties (not supplied).
20. Re-fit all removed parts and secure all fasteners, ensuring there are no squeaks or rattles.
21. Place the instructions in the glove box after fitment.