

PRODUCT DETAILS:

Part Number:	QTHV02L	Maximum Towing Braked:	1200	kg
ECU Number:	04835	Maximum Towing Unbraked:	750	kg
Tail Harness Length Required:	See Note.	Maximum Static Ball Load:	120	kg
TBM/Lug Part Number:	21379			

FITTING DETAILS:

Towbar Installation Time:	80 Mins.	RPA Disable/Other:	YES
Total Installation Time:	100 Mins.		
Bumper Cut Required:	Yes		

Note:

- 400mm tail is required if no RPA is fitted.
- Use 04936 tail for RPA disable.

TRAILBOSS RECOMMENDS THAT INSTRUCTIONS ARE READ AND UNDERSTOOD COMPLETELY PRIOR TO FITMENT.

BEFORE YOU START:

Check all hardware items have been included refer to assembly diagram.
Please ensure this towbar is only fitted to vehicle models as per Trailboss application guide.

Bumper Cuts

Vehicle and bumper variations can and do occur during vehicle manufacture after initial towbar design. Fitment of towbar to vehicle and accuracy of bumper cut must be assessed prior to any bumper modifications made. Incorrect bumper cuts are not covered under Trailboss warranty.

NOTE: Bumper cuts need to be approached with care, refer to notes below.

- Bumper centreline – where the centreline of the bumper needs to be determined, the installer must assess centre point by measurement of bumper width or determining two symmetrical reference points to give centreline.
- Bumper edge – To assist with accurate bumper cut measurement, reference to the start of the bumper edge is now being commonly used.
 - Measure from bottom edge along bumper and around corner to the 70 mm point (Figure 1).
 - Do not measure from visible bumper front of corner, upwards (Figure 2).

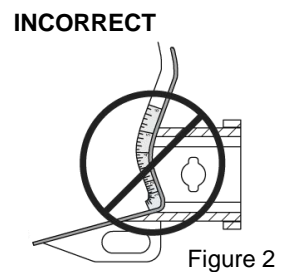
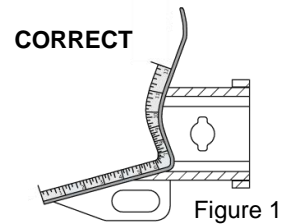

Drilling

- For any required drilling during installation, ensure that the area is clear of fuel, electrical & other components that may be damaged.
- All holes drilled into metal body panels shall have all burrs & swarf removed then coated with a suitable rust preventative paint.

Bolts/Fasteners

- Ensure that all hardware is fastened to correct torque as specified in this fitting instruction.
- All fasteners supplied with this product are used to achieve a specified clamp loading. If replacement is required ensure that fasteners of the same grade and class are used.

NOTE: Achieving correct torque is critical to proper installation and responsibility of the installer. Towbar failures attributed to tension issues from over tightening or under tightening are not covered by Trailboss warranty.

Product Labels

- a. Towbar load rating sticker provided with this product shall be conspicuously located on inside rear end of the driver's door.

WARNING:

Do not, drill, cut, weld or otherwise modify the towbar.

FOR TOWING PURPOSES ONLY - This towbar is designed and tested by Trailboss to adhere to ADR 62/02 which provides only for the expected load demands of towing.

i TOWBAR ASSEMBLY DIAGRAM

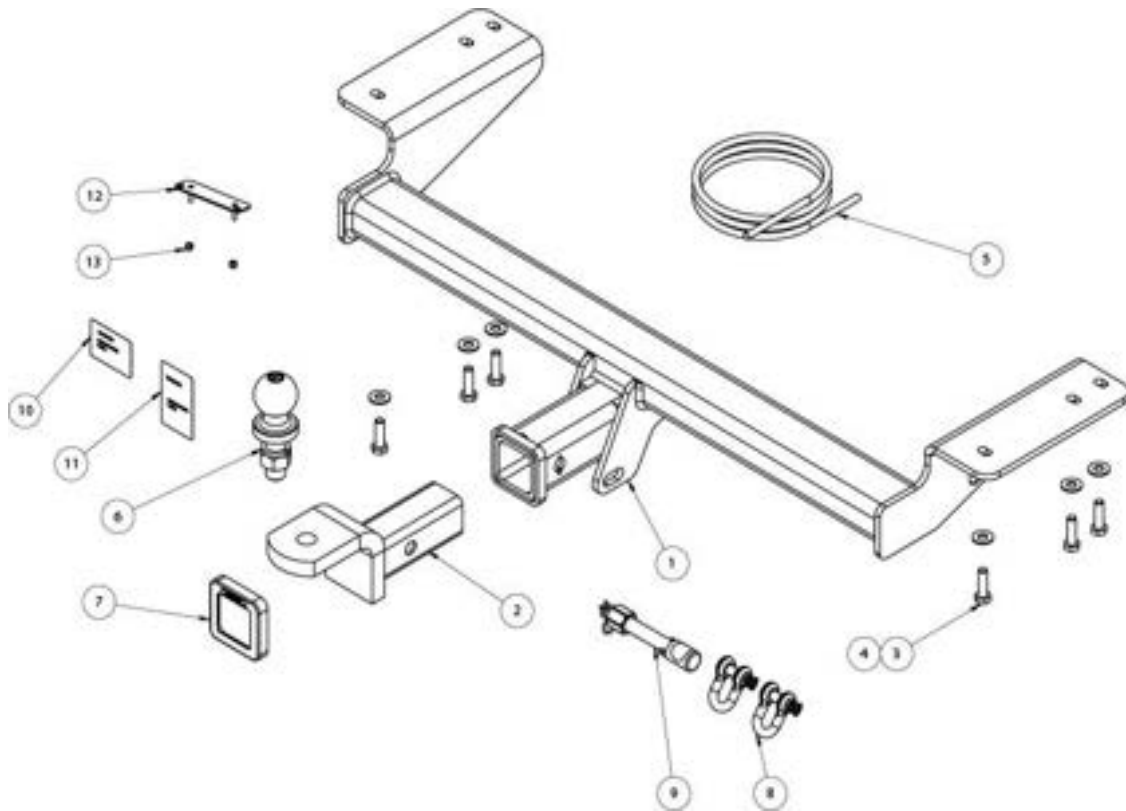

ITEM	DESCRIPTION	QTY
1	HAVAL H2 WELDED ASSEMBLY	1
2	TRAILER BALL MOUNT	1
3	BOLT HEX HD M10x35x1.25P	6
4	WASHER FLAT M10x23x2	6
5	WIRING LOOM	1
6	TOWBALL 50mm	1
7	HITCH BOX COLLAR COVER	1
8	"D" SHACKLE 10mm	2
9	SMART PIN SILVER	1
10	COMPLIANCE LABEL	1
11	LOAD RATING LABEL	1
12	PLUG BRACKET	1
13	NUT NYLOC HEX M4x0.7P	2

1. Remove the rear left tail lamp only, by removing the 2x caps and 2x screws below.
2. Remove 3x screws on the bumper fascia.

Repeat for other side

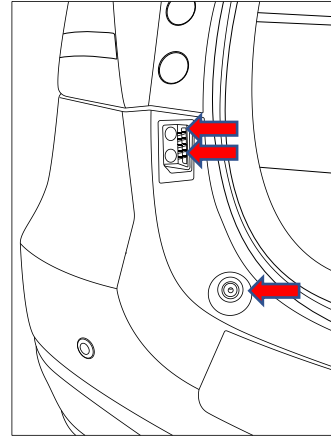

3. Remove 4x screws under the wheel arch

Repeat for other side

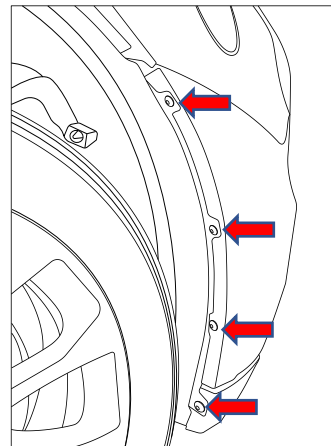

4. Remove 3x screws under side of the bumper.

Repeat for the other side

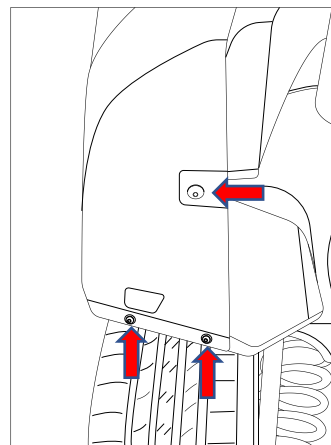

-
5. Remove 4x screws underneath the bumper.

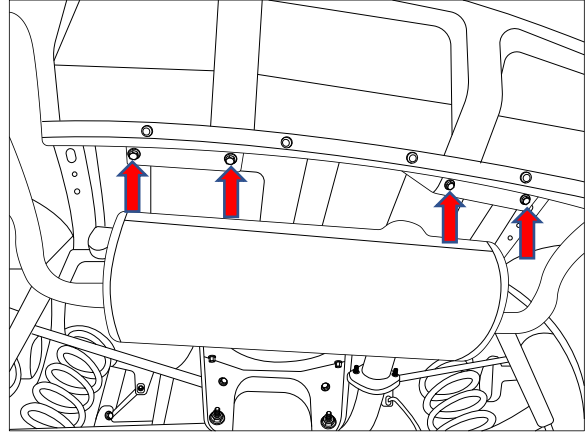

-
6. Unclip the bumper partially.
Disconnect the sensor connector on the LHS
Unclip the bumper completely and remove from the vehicle.

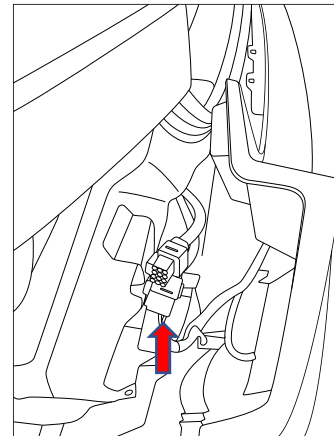

-
7. Fit the towbar into place and Secure with 3x M10 bolts and 3x washer on each side.

TORQUE M10 = 48 Nm

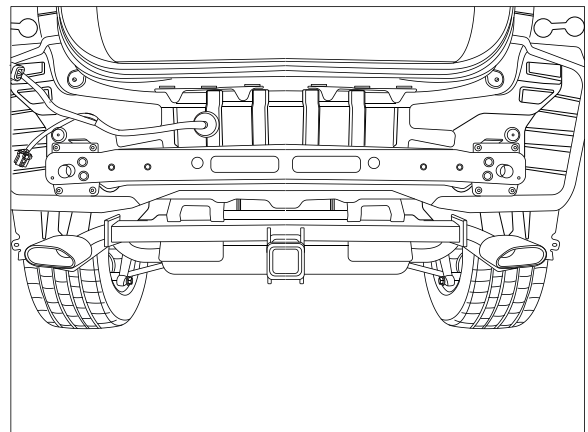

8. Mark and cut an area at the centre line of the bumper 95mm wide and 155mm long from the bumper edge.

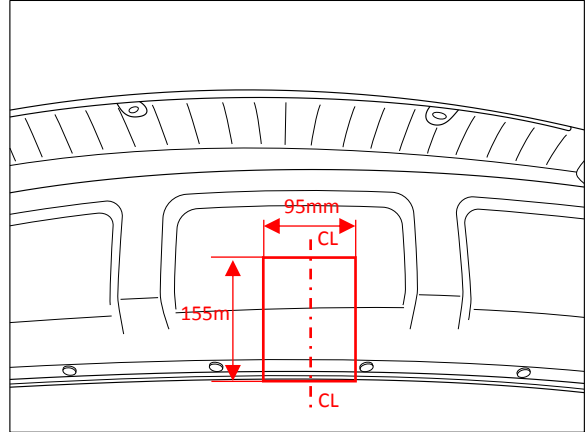

9. Drill 2x holes 69mm apart.
Remove 1x Scrivet clips and slide the plug bracket between the outer and inner skin of the bumper.
Insert the plug bracket in the holes.

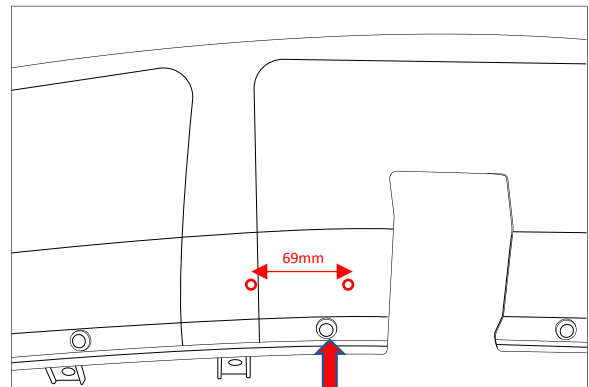



IMPORTANT

Due to possible vehicle variations, always confirm any noted vehicle colour wires with a multi-meter to ensure the correct function is identified before soldering or scotch locking. For vehicle wires denoted with two colours (example; RED/GREEN) the first colour will always be the main wire colour while the second colour is the thinner trace colour on the wire.

10. Locate the vehicle pre-wire 12-way connector (1).

11. Remove the blanking plug from the vehicle harness and connect the mating 12-way connector on the trailer patch (102327-WL) to the vehicle pre-wire connector.

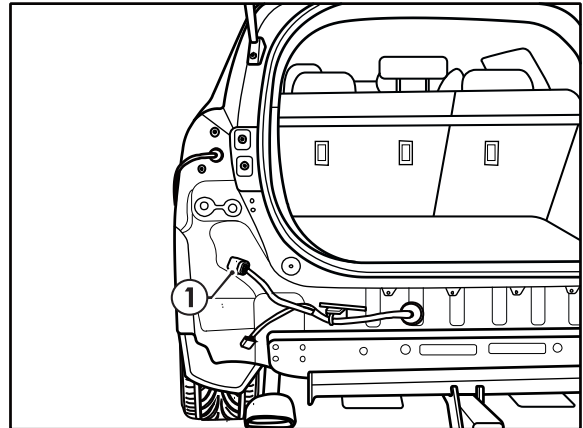

12. Route the small 4-way connector branch (1) up to the LHS vehicle tail lamp.

13. Patch in the 4-way connectors (1) in between the vehicle wiring and the tail lamp.

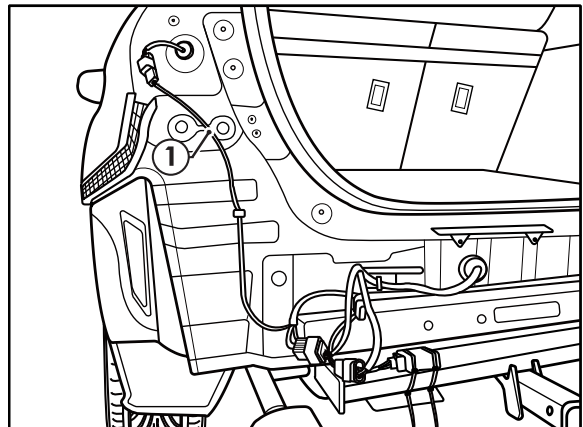

14. Locate a suitable area to mount the waterproof ECU (1) (04835).
15. Connect the trailer patch 24-way connector (2) to the ECU.
16. Secure the ECU to the vehicle using cable ties or other suitable method.

Note: Mount the ECU, ensuring the connector is orientated downwards.

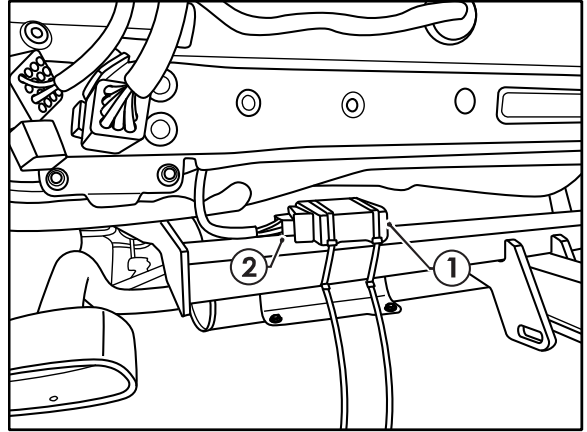

17. For Automatic RPA disable, patch in the 16-way connectors (1) on the patch harness in between the vehicle bumper harness and the vehicle body harness.

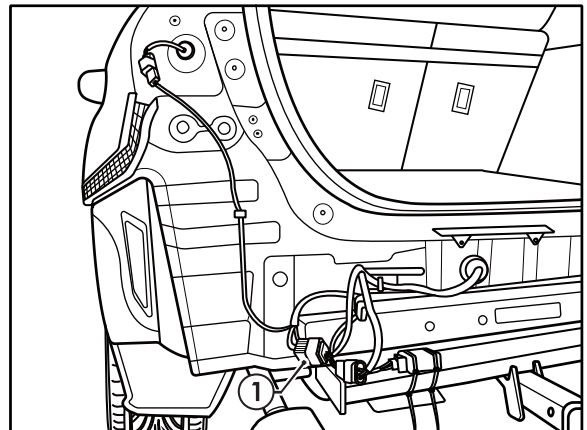

18. Secure tail harness (400mm) to towbar.
19. Route tail harness towards blue connector on patch loom.

Note: Keep harness routing clear of all sharp edges, moving parts and places of extreme heat.

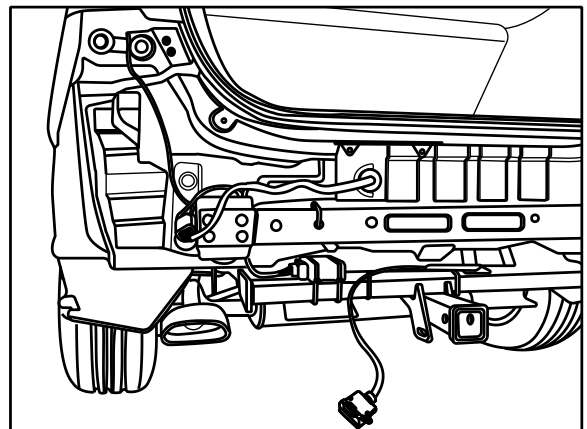

20. Connect the tail harness (tail length 400mm) 8-way connector (1) to the trailer patch mating 8-way connector (2).

21. Secure all harness using supplied Cable Ties.
NOTE: THIS STEP IS FOR RPA DISABLE.

22. Strip and crimp, GREY (3) and GREY/BLACK (4) wires to the RPA patch matching GREY (5) and GREY/BLACK (6) wires and insulate connections.

23. Apply silicone grease (7) (not provided) to the blue connectors to prevent water ingress.

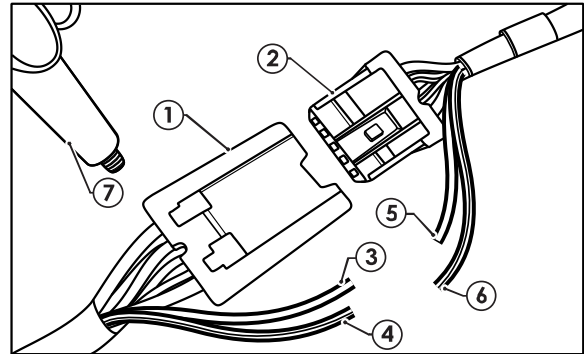

24. Test the trailer patch function using a light board or multi-meter.

25. Re-fit all removed parts and secure all fasteners, ensuring there are no squeaks or rattles.

26. Place the fitting instructions in the glove box after fitment.

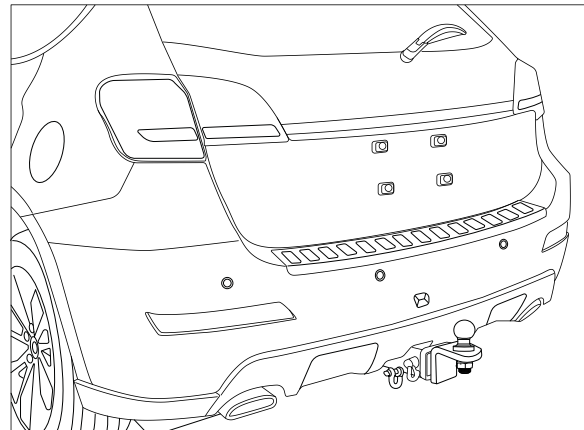



CUSTOMER INFORMATION

PLACE THESE INSTRUCTIONS IN THE
VEHICLE'S GLOVEBOX AFTER INSTALLATION

**THANK YOU FOR PURCHASING TRAILBOSS. WITH CORRECT MAINTENANCE AND CARE
THIS PRODUCT WILL PROVIDE A LIFETIME OF TROUBLE-FREE OPERATION.**

TOWBAR MAINTENANCE AND CARE:

1. Trailboss recommend that the towbar LUG or TBM (Trailer Ball Mount) Pull Pin and R-clip are removed and stored when not in use. Removal of LUG or TBM (Trailer Ball Mount) is advisable when not in use to assist with any of the following.
 - Ensure rear number plate is not obscured.
 - Allow maximum available departure angle and prevent any potential interference.
 - Prevent possible interference with vehicles reverse sensors or camera detecting a tow ball mount as an obstruction during reversing.
 - Removes towball mount as an obstruction for when moving around the rear of the vehicle.
2. Trailboss recommends routine inspection of your towbar to ensure trouble free towing.
 - Bolt security and tension should be regularly inspected and checked for correct tension. Replace any worn or defective parts with suitable grade & class fasteners. Inspection should be requested to coincide with vehicle major services.
3. It is the owner's responsibility to ensure towing and down ball weight capacities of the towing vehicle are not exceeded.
 - Towing and down ball weights allowable may differ according to model variations. Please refer to owner's manual or vehicle dealer to confirm exact rating for your vehicle model variant.
 - It is not uncommon for the vehicle tow rating to differ from the towbar rating. When this occurs, the lesser rating must be adhered to.
 - For vehicles fitted with enhanced vehicle functions that may be altered/changed when towing i.e Trailer sway mitigation, blind spot detection, adaptive cruise control etc. Please consult owner's manual to understand changes enabled when towing and after towing.

WARRANTY INFORMATION:

Trailboss Towbars are covered by a Lifetime Warranty.

Our goods come with guarantees that cannot be excluded under the Australian Consumer Law. You are entitled to a replacement or refund for a major failure and for compensation for any other reasonably foreseeable loss or damage. You are also entitled to have the goods repaired or replaced if the goods fail to be of acceptable quality and the failure does not amount to a major failure.

For further details please contact customer service on 1800 812 017.

PRO SERIES SILENT ANTI-RATTLE HITCH PIN

Your Trailboss towbar is equipped with a Pro Series Silent Anti-Rattle Hitch Pin technology to help reduce towbar tongue rattle in most driving conditions. Please ensure below instructions are understood and routine maintenance is carried out to ensure best towing experience.

Regularly inspect for wear and check the tightness of the Silent Anti-Rattle Hitch Pin. Follow instructions below to re-tighten the nut as necessary when movement and noise in the tow ball mount is noted.

- Before towing, ensure R-Clip is properly installed and hitch pin nut is installed and tensioned. Replacement parts are available from your Pro Series Distributor.

TOWBALL MOUNT REMOVAL/INSTALLATION

STEP 1

Insert Trailer Ball Mount (TBM) (a) into towbar hitchbox (b), aligning hole in TBM shank (c) with hole in hitchbox (d) (Fig. 1)

STEP 2

Insert Silent Anti-Rattle Hitch Pin (e) through hole in hitchbox and hole in TBM shank (g); ensure the locators are inserted into the notches in the hitchbox (Fig. 2)

STEP 3

Screw Silent Anti-Rattle Hitch Pin Nut (f) onto Smart Pin (g); tighten Smart Pin Nut until finger tight, ensuring TBM is restrained from up and down movement.

STEP 4

Tighten Silent Anti-Rattle Hitch Pin Nut by turning nut a further 1/8th of a turn in the clockwise direction using a 24mm spanner (Fig. 4).

STEP 5

Install Silent Anti-Rattle Hitch Pin R-Clip through the hole that provides best clearance or easiest access. (Fig. 5)

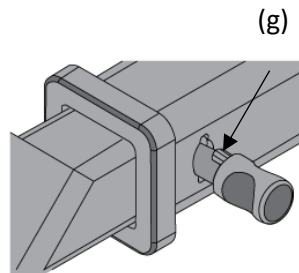
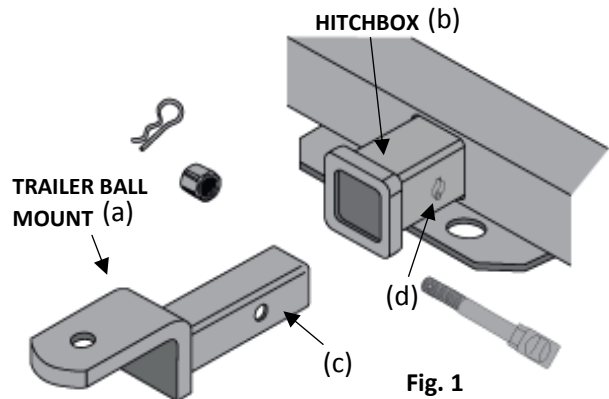

Fig. 2

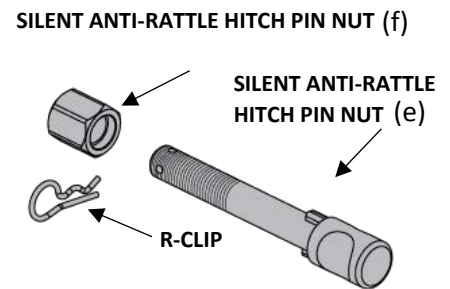

Fig. 3

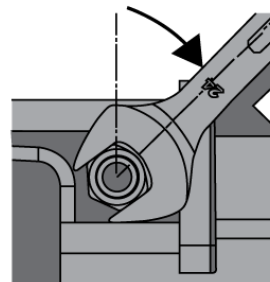

Fig. 4

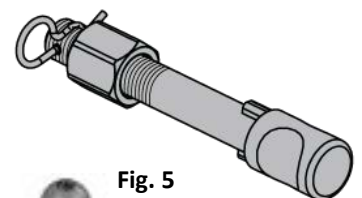

Fig. 5

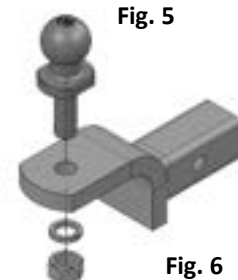

Fig. 6