

TRAILBOSS

Towbar Fitting Instructions To Suit **RENAULT MASTER 2011-ON** Part Number **QTRE13L** Rating **2500/200 kg**

PLACE THESE INSTRUCTIONS IN THE VEHICLE'S GLOVEBOX AFTER INSTALLATION IS COMPLETE

WARNING:

1. Do not, drill, cut, weld or otherwise modify the tow bar.
2. If you are using electric welding on a motor vehicle, **always** check that the vehicle is not equipped with electronic engine or instrument management equipment. Failure to do so could **destroy** any onboard computers. If in doubt, check with the vehicle's manufacturer.
3. The high tensile fasteners supplied with this product were used to achieve the specified rating. If replacement is required ensure that fasteners of the same rating & quality are used. Contact an authorised **Trailboss** dealer if further information is required.

General:

1. Ensure all hardware items have been included refer to assembly diagram.
2. It is recommended that the instructions are read through and completely understood before making any attempt to fit this product.
3. Be wary of any changes to vehicle designs or other accessories that may conflict with the installation of this product.
4. Before drilling ensure that the area is clear of fuel, electrical & other components.
5. All holes drilled into the body panels shall have all burrs & swarf removed then coated with a suitable rust preventative paint.
6. For vehicles that require the bumper to be cut. Ensure cut out area is in correct position on the vehicle prior to cutting the bumper.
7. The high tensile fasteners supplied with this product were used to achieve the specified rating. If replacement is required ensure that fasteners of the same rating & quality are used. Contact an authorized **Trailboss** dealer if further information is required.
8. Ensure that all hardware is fastened to torque list below check fasteners on regular basis.
9. Tow bar load rating sticker provided with this product shall be conspicuously located on inside rear end of the driver's door. **(See diagram below)**.
10. Trailboss recommends that you check your tow ball to ensure that it complies with the Australian standards **AS 4177.2**.
11. **PLEASE NOTE:** It is advised to remove your lug or tbm when not actually towing so as to produce a clear view of the vehicles registration plate if obscured, and to also provide maximum available departure angle
12. Pull Pin must be fit in down position.

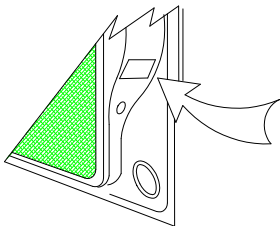

Place load rating sticker
inside driver's door here

FOR TRAILER TOWING PURPOSES ONLY
For towing capacity details please refer to vehicle owner's manual or to the manufacturer. Overloading can void your warranties.

RECOMMENDED ASSEMBLY TORQUE LISTING	
Diameter	Grade 8.8 Bolt
M6	9.5 Nm
M8	21.7 Nm
M10	43.4 Nm
M12	77.3Nm
M14	146 Nm
M16	189.8 Nm

Tow bar Maintenance and Care.

Trailboss recommends that bolt torque's, as listed below, are routinely and regularly inspected and checked for correct tension. Replace any worn or defective parts.

We recommended to remove Tow Ball Mounts (TBM's, tongues or lugs) when not being used for any considerable length of time.

So as to avoid injury, when not towing it is suggested that the tongue, Pull Pin and R-clip are removed then stored in a safe, clean and dry place, away from excessive moisture.

Hitch Pull Pins and spring "R" clips are regularly checked for proper installation. Replace any worn or defective parts.

TRAILBOSS

Towbar Fitting Instructions
 To Suit **RENAULT MASTER 2011-ON**
 Part Number **QTRE13L**
 Rating **2500/200 kg**

PLACE THESE INSTRUCTIONS IN THE VEHICLE'S GLOVEBOX AFTER INSTALLATION IS COMPLETE

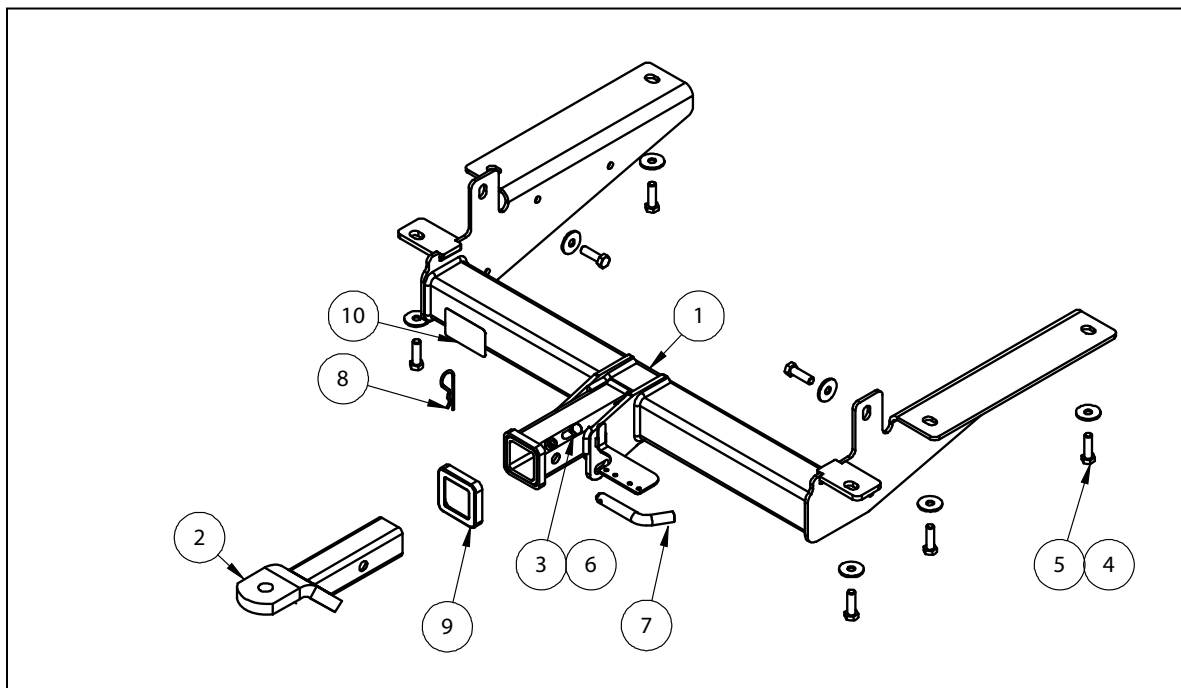

QTY.	DESCRIPTION	ITEM NO.
1	RENAULT MASTER TOWBAR	1
1	T.B.MOUNT	2
1	SET SCREW HEX HD M10x30x1.5P	3
8	WASHER FT M12x37x3mm	4
8	BOLT M12-1.75x40	5
1	HEX NUT M10x1.5	6
1	PULL PIN	7
1	R CLIP	8
1	HITCH BOX COLLAR COVER	9
1	ACRYLIC CP LABEL	10

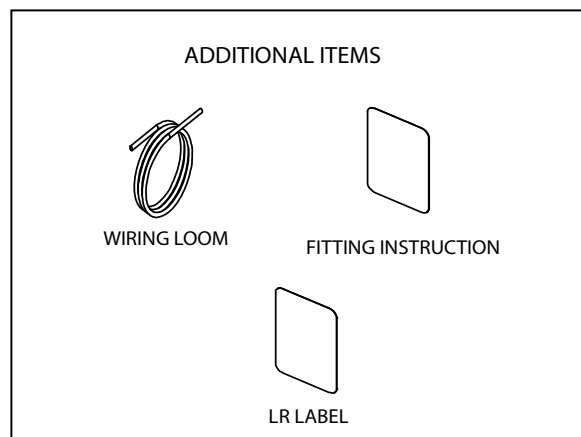



Towbar Fitting Instructions
To Suit **RENAULT MASTER 2011-ON**
Part Number **QTRE13L**
Rating **2500/200 kg**

PLACE THESE INSTRUCTIONS IN THE VEHICLE'S GLOVEBOX AFTER INSTALLATION IS COMPLETE

INSTRUCTION:

1. Using Bumper Cut Out template provided and cut the Rear Bumper Bar.
2. Attach Bumper Trim to cut edges of Bumper Bar.
3. Remove 4x Bolts from rear Tow-Hooks for both the LHS & RHS side.
4. Offer Towbar to vehicle and loosely fasten all Bolts to vehicle.
5. Tighten all Bolts to Torque Specifications provided.

NOT TO SCALE

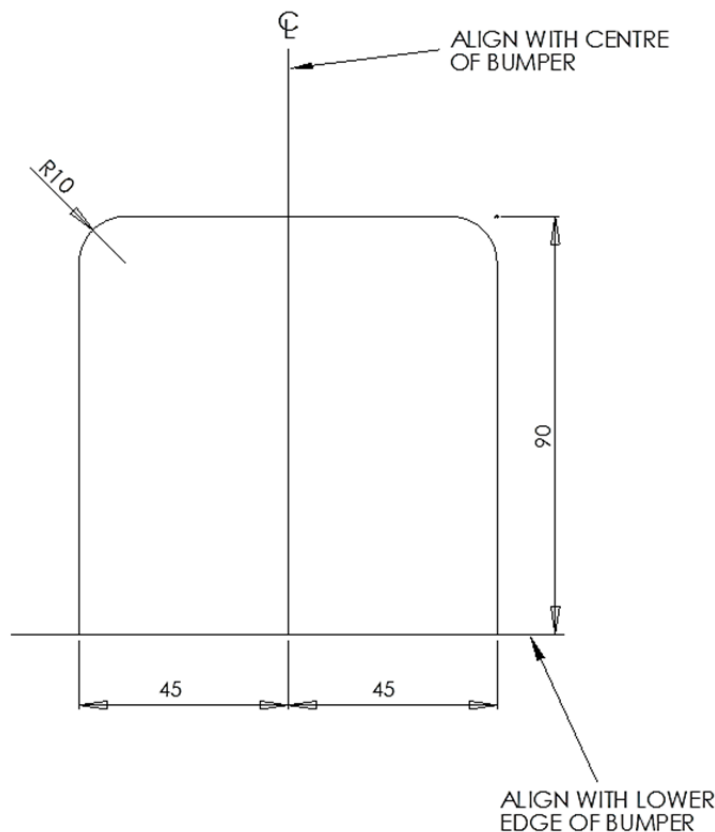

Bumper cutout template for standard rear bumper.



Wiring Loom Fitting Instructions
To Suit Renault Master
(MY2010 – Onwards)
Part Number 100925-WL

Wiring Loom Installation Instructions

Renault Master
(MY10 – Onwards)
Part No: 100925-WL
ECU Required: 04826

Tail Harness Length Required: 1800mm

Wiring Loom Installation Time: Approx 30 Mins



Wiring Loom Fitting Instructions
To Suit Renault Master
(MY2010 – Onwards)
Part Number 100925-WL

1. Inside the rear cargo hold, on the LHS rear pillar, remove the lower panel.
2. On LHS of the rear pillar, dislodge the upper panel enough to expose the 12V connector.
3. Disconnect the 12V connector and remove the upper panel.
4. Inside the cargo hold, remove the upper LHS side trim.
5. On the LHS of the vehicle cabin, remove the door rubber sill.
6. In the front of the vehicle cabin, on the LHS of the passenger's side, remove the door rubber sill.
7. Underneath the rear vehicle, feed the trailer patch through the cover panel and up towards the tail light connectors.
8. Inside the rear LHS pillar, locate the vehicle breakout connector.
9. Connect the trailer patch T-piece to the breakout connector.

Note: If the breakout connector is occupied, disconnect and patch in between.

10. Route the power harness along the LHS rear pillar cavity and up towards the previously removed upper LHS trim.
11. Continue routing power harness along the previously removed upper LHS trim, towards the front of the vehicle cabin.
12. Continue routing the power harness along the existing vehicle harness past the cargo barrier and towards the front of vehicle cabin.
13. Continue routing the power harness along the previously removed door sill.
14. Route the power harness, down towards lower dash, along the previously removed door sill.
15. On the lower passenger's side dash, remove the fuse panel cover.
16. Continue routing the power harness down the previously removed door sill and into the fuse panel.

Wiring Loom Fitting Instructions To Suit Renault Master (MY2010 – Onwards) Part Number 100925-WL

17. Inside the fuse box, locate the 25-amp fuse (1).
18. Insert the previously removed 25-amp fuse (1) into the lower slot of the add-a-fuse (2).
19. Plug the add-a-fuse (2) into the vacant fuse slot on the fuse panel.
20. Connect the 'ORANGE' power harness 1-way connector (3) into the add-a-fuse mating connector (4).

Note: Ensure that the add-a-fuse is placed in the correct position with the wire facing upwards.

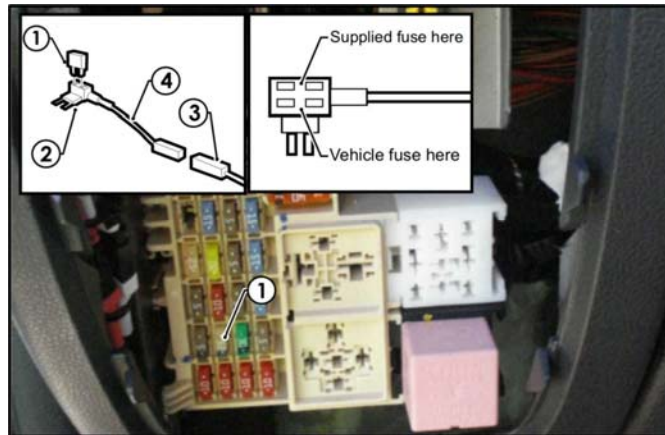

21. Mount the trailer socket to the towbar mounting bracket using M4 fasteners (not supplied).
22. Route the tail harness (tail length 1800mm) across the towbar, towards the RHS of the vehicle and up through the previously drilled out hole.
23. Ensure the tail harness grommet is seated correctly and secure it in place using a cable tie (not supplied).
24. Connect the tail harness (tail length 1800mm) 8-way connector to the trailer patch mating 8-way connector.
25. Test the trailer patch function using a light board or multimeter.
26. Secure all harnesses using cables ties (not supplied).
27. Re-fit all removed parts and secure all fasteners, ensuring there are no squeaks or rattles.
28. Place the instructions in the glove box after fitment.